

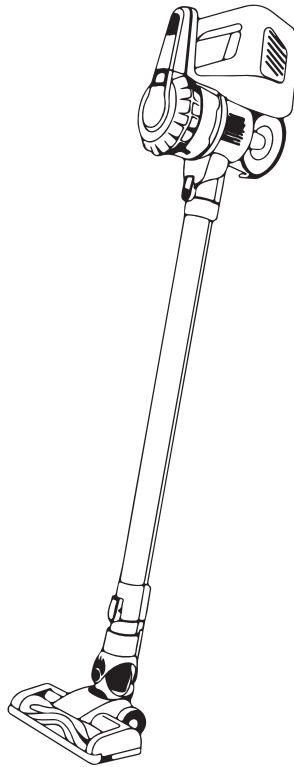

X15 CORDLESS HANDHELD VACUUM



Instruction Manual - Version 1.0 -

Please keep in a safe place for reference.

*** FULLY CHARGE BATTERY BEFORE FIRST USE! ***

Important Safety Instructions



**IMPORTANT: READ ALL INSTRUCTIONS BEFORE USE.
RETAIN INSTRUCTIONS FOR FUTURE REFERENCE.**



Do not use in rain or leave outdoors while raining.

WARNING: Basic safety precautions should always be observed when using an electrical appliance, including the following to reduce the risk of fire, electrical shock, or injury.

Personal Safety:

1. Store indoors in a dry place out of the reach of children.
2. Always use responsibly. This appliance can be used by children age 10 years and older. Persons with reduced physical, sensory or mental capabilities, or lack of experience and knowledge may use this appliance if they have been given supervision or instruction concerning the safe use of the appliance and understand the hazards involved.
3. Don't let children play with the appliance; supervise children using or maintaining the appliance.
4. Use only manufacturer's recommended attachments as described in this manual; misuse or use of any accessory or attachment other than those recommended, may present a risk of personal injury.
5. Take extra care when cleaning stairs.
6. Keep the appliance and accessories away from hot surface.
7. Do not block the appliances openings or hinder air flow, keep openings free of any objects including clothing and fingers (and all parts of the body).

Electrical Safety:

1. Only use batteries and chargers supplied by the manufacturer.
2. Never modify the charger in any way.
3. The charger has been designed for a specific voltage. Always check that the mains voltage is the same as that stated on the rating plate.
4. A charger that is suitable for one type of battery pack may create a risk of fire when used with another battery pack.
5. Before use, check the charger cord for signs of damage or ageing. A damaged or entangled charger cord increases the risk of fire and electric shock.
6. Do not abuse the charger cord.
7. Never carry the charger by the cord.
8. Do not pull the cord to disconnect from a socket, grasp the plug and pull to disconnect.
9. Don't wrap the cord around the charger when storing.
10. Keep the charger cord away from hot surfaces and sharp edges.
11. The supply cord cannot be replaced. If the cord is damaged the charger should be discarded and replaced.
12. Do not handle the charger or the appliance with wet hands.
13. Do not store or charge the appliance outdoors.
14. The charger must be removed from the socket before removing the battery, cleaning or maintaining the appliance.

Important Safety Instructions

Battery safety:

1. This appliance includes Li-ion batteries, **do not incinerate batteries or expose to high temperatures**, as they may explode.
2. Liquid ejected from the battery may cause irritation or burns.
3. In an emergency situation contact professional help immediately.
4. Leaks from the battery cells can occur under extreme conditions. Do not touch any liquid that leaks from the battery. If the liquid gets on skin wash immediately with soap and water. If the liquid gets into the eyes, flush them immediately with clean water for a minimum of 10 minutes and seek medical attention. Wear gloves to handle the battery and dispose of immediately in accordance with local regulations.
5. Shorting the battery terminals may cause burns or fire.
6. When the battery pack is not in use, keep it away from paper clips, coins, keys, nails, screws or other small metal objects that could make a connection from one terminal to another.
7. When you dispose of the appliance remove the battery and dispose of the battery safely in accordance with local regulations.

Service:

1. Before using the appliance and after any impact, check for signs of wear or damage and repair as necessary.
2. Do not use the appliance if any part is damaged or defective.
3. Repairs should be carried out by a service agent or a suitably qualified person in accordance with relevant safety regulations. Repairs by unqualified persons could be dangerous.
4. Never modify the appliance in any way as this may increase the risk of personal injury.
5. Only use replacement parts or accessories provided or recommended by manufacturer.

Intended use:

1. This appliance has been designed for domestic dry vacuum cleaning only.
2. Do not pick up liquids or use on wet surfaces.
3. Do not pick up anything that is flammable, burning, or smoking.
4. Use only as described in this manual.
5. Don't use on concrete, asphalt, or other rough surfaces.

WARNING:

1. Do not use water, solvents, or polishes to clean the outside of the appliance; wipe clean with a dry cloth.
2. Never immerse the unit in water and do not clean in a dish washer.

Components

Vacuum

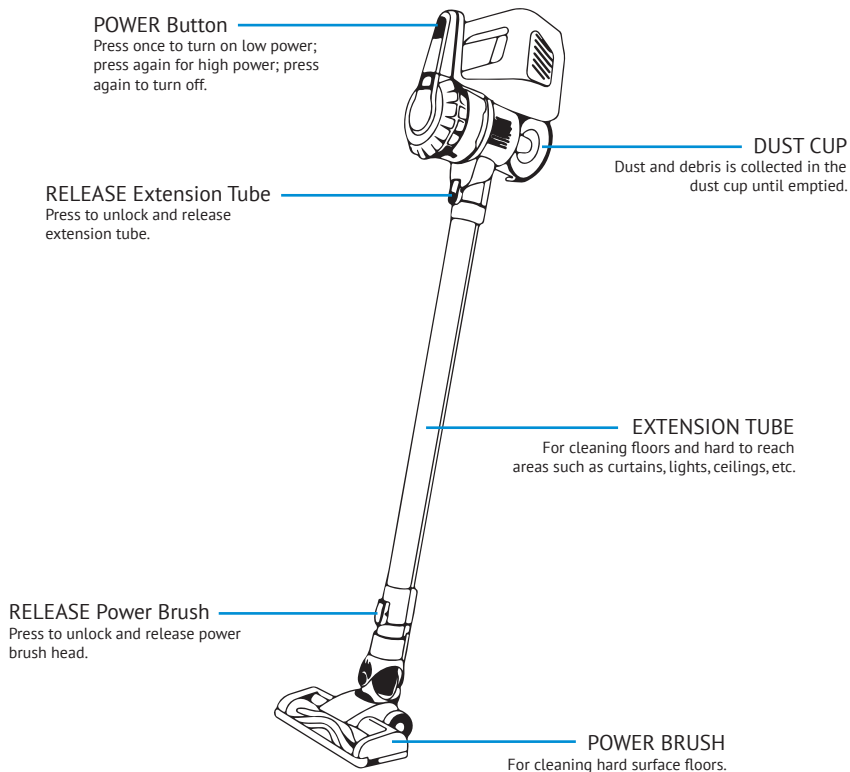

Accessories

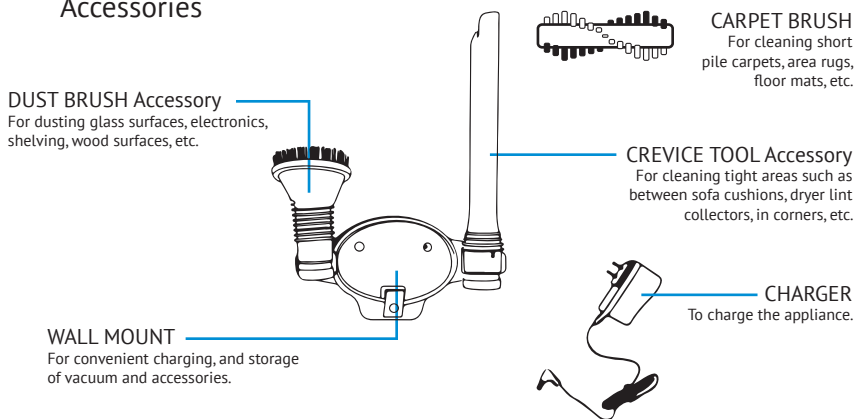

1 UNPACK & CHARGE

Unbox vacuum and accessories, and remove protective plastic wrap and shipping materials.

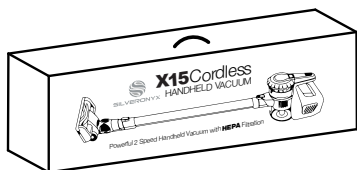

2

Insert power adapter into power input on back of unit and then plug into electrical outlet.

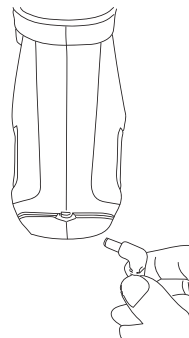

3

When the battery is low, the power light will blink red indicating charging is in progress.

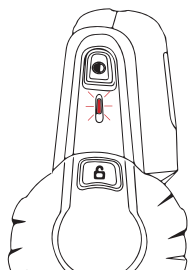

4

When the battery is fully charged, the light will turn solid green.

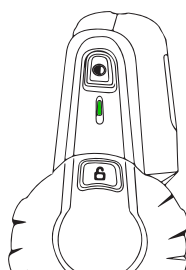

1 WALL MOUNT

A wall mount is included for convenient storage and access to your vacuum and accessories. Use the provided screws (and wall anchors, if necessary) to hang.

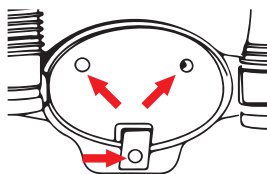

2

To hang, align the notch in the back of the vacuum battery with the hook in the wall mount.

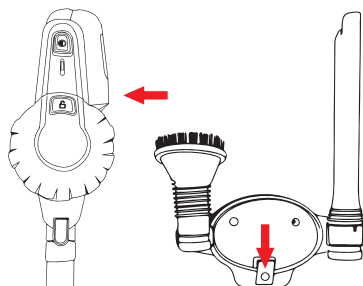

Cleaning Floors

1

Connect the dust cup assembly and handle together.



2

Insert the metal extension tube into the body and push until you hear a 'click' sound.

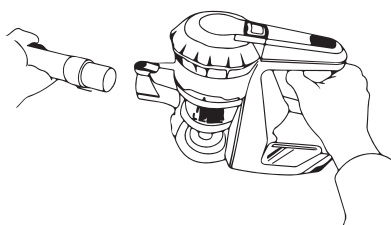

3

Attach the power brush to the extension tube and push until you hear the 'click'.

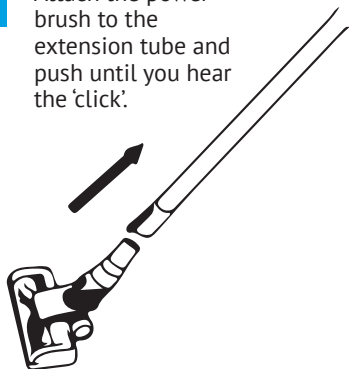

4a

Press the POWER button to turn on the appliance.

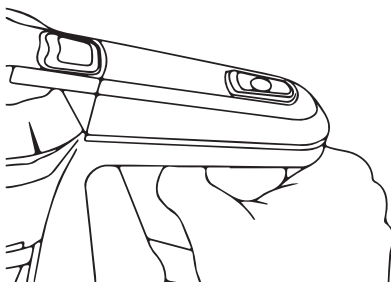

4b

The appliance will turn on to LOW power. Press the button again to switch to HIGH power. Press a 3rd time to power off.



Cleaning Stairs & Other Surfaces

1

Connect the dust cup assembly and handle together.

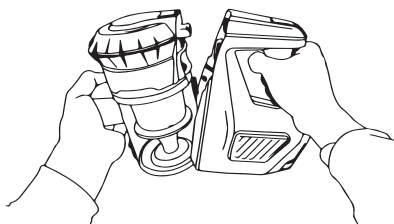

2a

Insert the power brush head into the body and push until you hear the 'click'.

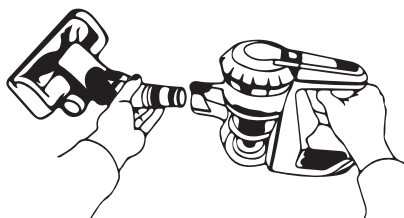

2b

Insert the dust brush tool into the body and push until you hear the 'click'.

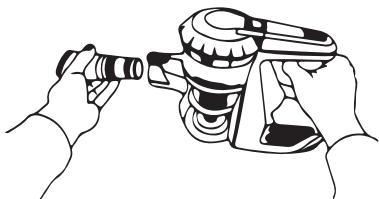

2c

Insert the crevice tool into the body and push until you hear a 'click' sound.

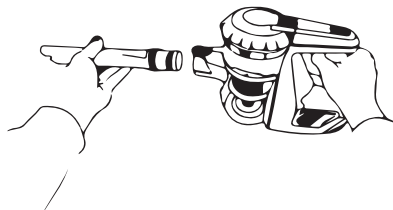

3a

Press the POWER button to turn on the appliance.

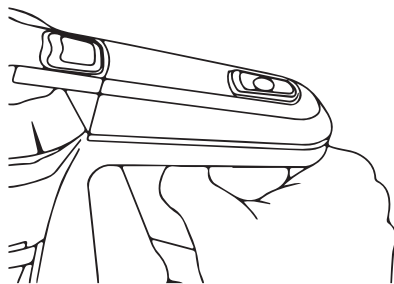

3b

The appliance will turn on to LOW power. Press the button again to switch to HIGH power. Press a 3rd time to power off.

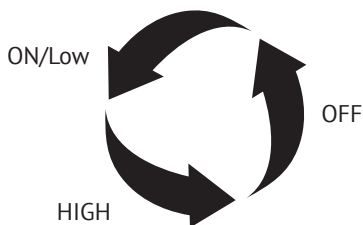

Care & Maintenance

1 EMPTY DUST CUP

Press the lock release button to remove the extension tube or accessory tool.

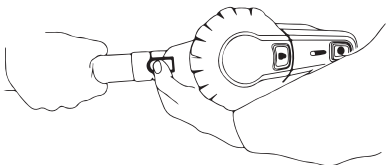

2 Pull on the dust cup latch with your thumb.
Note: hold over trash bin/bag to catch debris after opening dust cup.

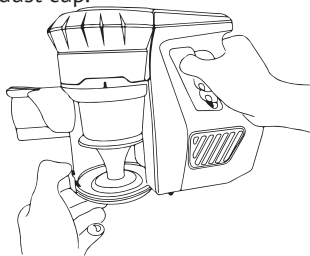

3 Shake body to empty dust cup.

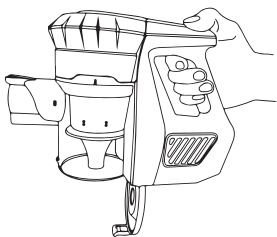

4 Push dust cup cover up until the latch 'clicks' in place to ensure it is fully closed.

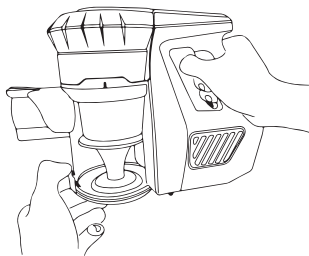

1 FILTER MAINTENANCE

Press the battery release button to detach the battery from the dust cup.



2 Grasp the dust cup firmly and twist the top counter-clockwise to open.

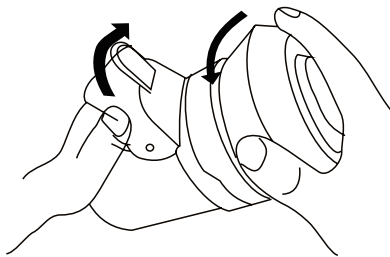

Care & Maintenance

3

Remove filter case from dust cup and twist counter-clockwise to remove filter from it's holder.

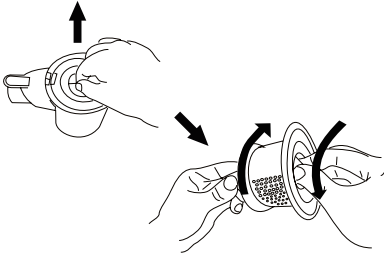

4

Wash/rinse the filter case and HEPA filter with water ONLY.

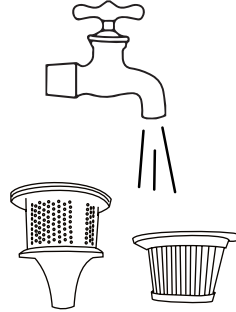

5

Allow the filter case and HEPA filter time to dry completely before re-assembly.

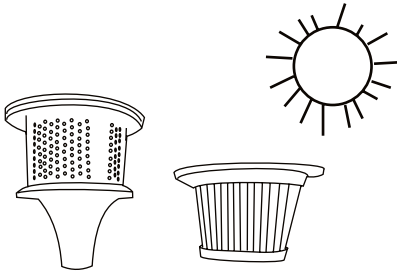

6

After drying, place the filter back in its holder and twist to secure.

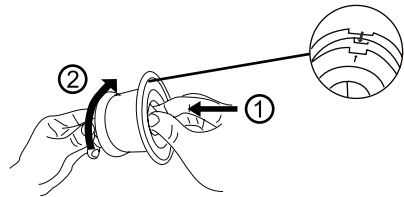

7

Place the filter assembly back into the dust cup. Align with the markings shown below.

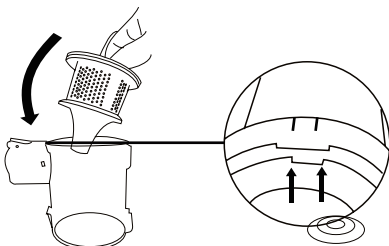

8

Place dust cup cover back onto dust cup and turn clockwise while pushing down to lock in place.

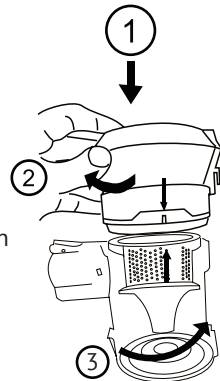

Troubleshooting

Problem	Battery Indicator	Possible Cause	Solution
Appliance cannot be recharged.	Battery indicator does not flash.	1. The charging plug may be loose in the socket. 2. Power adapter is not securely attached to the appliance.	Attach the power adapter securely to the appliance.
	Battery indicator keeps flashing after charging for very long time.	The internal PCB board may be defective or damaged.	This problem can only be fixed by a professionally trained person. Please send or take appliance to an after-service depot.
Brush does not work, and main unit does not work either.	Battery indicator flashes red when pressing the POWER button.	1. Power is off. 2. Brush is totally blocked by hair or other debris. 3. There may be a short on the circuit inside the brush.	1. Recharge the appliance. 2. Remove blockage from brush. 3. This problem can only be fixed by a professionally trained person. Please send or take appliance to an after-service depot.
Brush does not work, but main unit works normally.	Battery indicator is normal.	1. Low battery. 2. Power connection is interrupted. 3. The rubber belt inside the brush head may be loose.	1. Recharge the appliance. 2. Make sure dust cup cover is seated properly on dust cup, and check all connections between attachments. 3. This problem can only be fixed by a professionally trained person. Please send or take appliance to an after-service depot.
Appliance does not pick up debris / suction power is weak.	Batter indicator is normal.	1. Dust cup is full. 2. Dust cup filter needs to be cleaned or replaced. 3. Brush is blocked by hair or other debris.	1. Clean the dust cup. 2. Clean the filter according to the instructions. 3. Remove blockage from brush.

Technical Specifications

Model	X15-LI-BLK
Battery	22.2V/2,200mAh
Charging Time	4 hours
Battery Charger Output	26V/500mAh
Net Weight	2.6Kg
Usage Time	40min (low); 20min (high)
Power	160W
Suction Power	15Kpa
Airflow	35m ³ /s



SILVERONYX

SilverOnyx LLC
14807 S Heritagecrest Way, Ste B
Bluffdale, UT 84065
801-341-2845
support@silveronyx.com

