

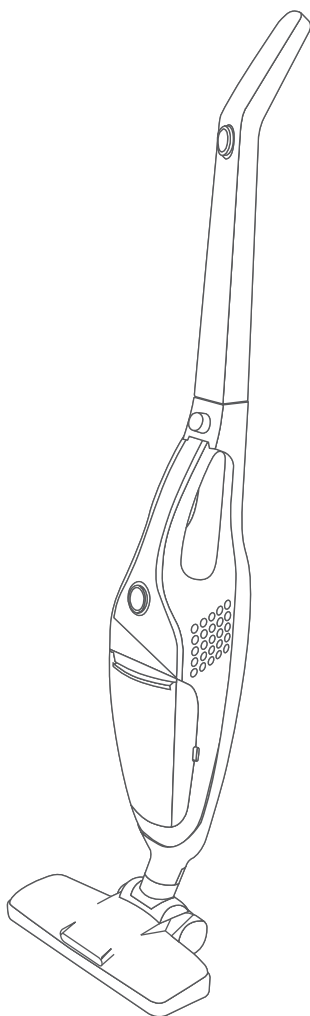

SILVERONYX

S7 CORDLESS STICK VACUUM



Instruction Manual

- Version 1.0 -

Please keep in a safe place for reference.

Important Safety Instructions



**IMPORTANT: READ ALL INSTRUCTIONS BEFORE USE.
RETAIN INSTRUCTIONS FOR FUTURE REFERENCE.**



Do not use in rain or leave outdoors while raining.

WARNING: Basic safety precautions should always be observed when using an electrical appliance, including the following to reduce the risk of fire, electrical shock, or injury.

Personal Safety:

1. Store indoors in a dry place out of the reach of children.
2. Always use responsibly. This appliance can be used by children age 10 years and older. Persons with reduced physical, sensory or mental capabilities, or lack of experience and knowledge may use this appliance if they have been given supervision or instruction concerning the safe use of the appliance and understand the hazards involved.
3. Don't let children play with the appliance; supervise children using or maintaining the appliance.
4. Use only manufacturer's recommended attachments as described in this manual; misuse or use of any accessory or attachment other than those recommended, may present a risk of personal injury.
5. Take extra care when cleaning stairs.
6. Keep the appliance and accessories away from hot surface.
7. Do not block the appliances openings or hinder air flow, keep openings free of any objects including clothing and fingers (and all parts of the body).

Electrical Safety:

1. Only use batteries and chargers supplied by the manufacturer.
2. Never modify the charger in any way.
3. The charger has been designed for a specific voltage. Always check that the mains voltage is the same as that stated on the rating plate.
4. A charger that is suitable for one type of battery pack may create a risk of fire when used with another battery pack.
5. Before use, check the charger cord for signs of damage or ageing. A damaged or entangled charger cord increases the risk of fire and electric shock.
6. Do not abuse the charger cord.
7. Never carry the charger by the cord.
8. Do not pull the cord to disconnect from a socket, grasp the plug and pull to disconnect.
9. Don't wrap the cord around the charger when storing.
10. Keep the charger cord away from hot surfaces and sharp edges.
11. The supply cord cannot be replaced. If the cord is damaged the charger should be discarded and replaced.
12. Do not handle the charger or the appliance with wet hands.
13. Do not store or charge the appliance outdoors.
14. The charger must be removed from the socket before removing the battery, cleaning or maintaining the appliance.

Important Safety Instructions

Battery safety:

1. This appliance includes Li-ion batteries, **do not incinerate batteries or expose to high temperatures**, as they may explode.
2. Liquid ejected from the battery may cause irritation or burns.
3. In an emergency situation contact professional help immediately.
4. Leaks from the battery cells can occur under extreme conditions. Do not touch any liquid that leaks from the battery. If the liquid gets on skin wash immediately with soap and water. If the liquid gets into the eyes, flush them immediately with clean water for a minimum of 10 minutes and seek medical attention. Wear gloves to handle the battery and dispose of immediately in accordance with local regulations.
5. Shorting the battery terminals may cause burns or fire.
6. When the battery pack is not in use, keep it away from paper clips, coins, keys, nails, screws or other small metal objects that could make a connection from one terminal to another.
7. When you dispose of the appliance remove the battery and dispose of the battery safely in accordance with local regulations.

Service:

1. Before using the appliance and after any impact, check for signs of wear or damage and repair as necessary.
2. Do not use the appliance if any part is damaged or defective.
3. Repairs should be carried out by a service agent or a suitably qualified person in accordance with relevant safety regulations. Repairs by unqualified persons could be dangerous.
4. Never modify the appliance in any way as this may increase the risk of personal injury.
5. Only use replacement parts or accessories provided or recommended by manufacturer.

Intended use:

1. This appliance has been designed for domestic dry vacuum cleaning only.
2. Do not pick up liquids or use on wet surfaces.
3. Do not pick up anything that is flammable, burning, or smoking.
4. Use only as described in this manual.
5. Don't use on concrete, asphalt, or other rough surfaces.

WARNING:

1. Do not use water, solvents, or polishes to clean the outside of the appliance; wipe clean with a dry cloth.
2. Never immerse the unit in water and do not clean in a dish washer.

Components

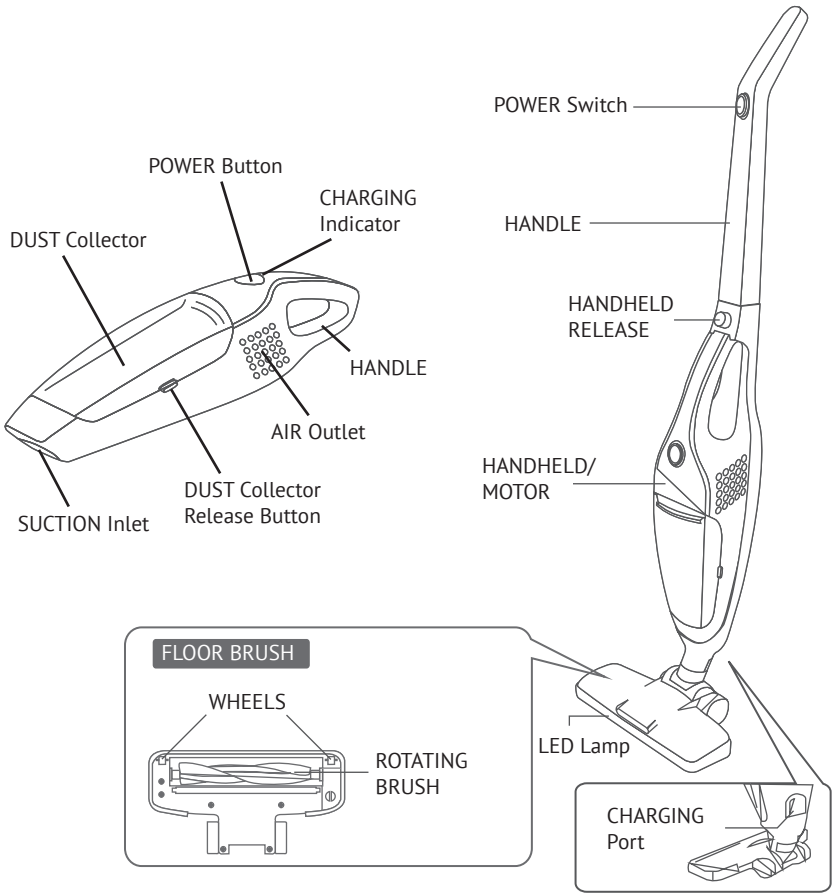

ACCESSORIES



CHARGING SEAT BASE

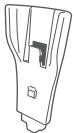

CHARGING SEAT BACK



BRUSH Accessory

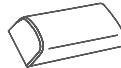

CREVICE TOOL

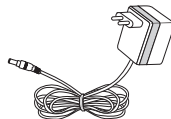

CHARGER

1 ASSEMBLE CHARGER

Slide charging back into charging base and snap into place.

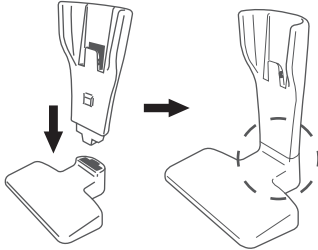

2 Insert power adapter into power input on bottom of charging base, then feed through groove in base.

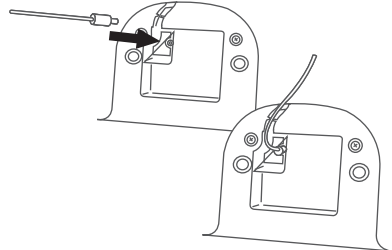

1 ASSEMBLE HANDLE

- 1) Remove screw from back of handle;
- 2) Slide handle over base;
- 3) Insert and tighten screw to secure handle to base.

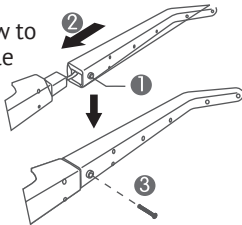

2 Place nose of handheld unit in groove on base, and push handle until it snaps in place.

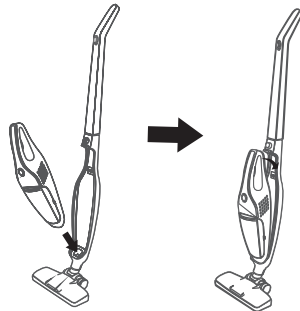

1 CHARGING

Place vacuum on charging base, aligning the charging port with the adapter on the base.

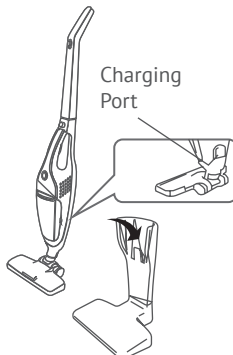

2

Plug power supply adapter into wall outlet. When charging begins the indicator will turn red. Charging will be complete in about 5 hours, at which time the indicator will turn off.

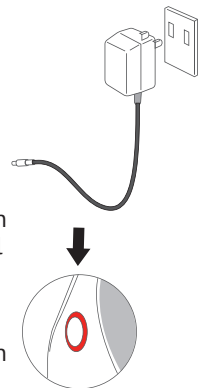

Operating the Vacuum

1

Slide the POWER switch down once to turn on the appliance in low speed. Slide again for high speed, and slide up to turn off.

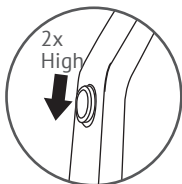
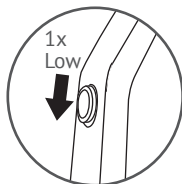

2

When in operation, the charging indicator will be solid green.

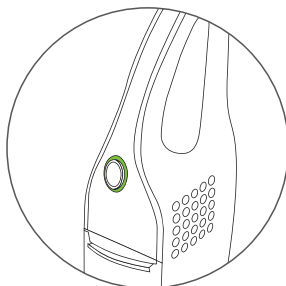

3

The vacuum is equipped with an LED lamp to see dark corners, under furniture, etc.

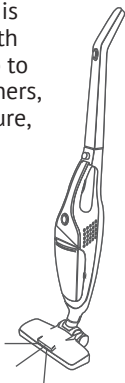

4

Press the RELEASE lock button to remove the handheld unit from the vacuum.

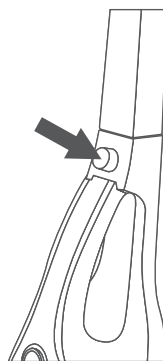

5

Insert CREVICE tool into suction end of handheld unit for cleaning in tight areas.



6

Insert BRUSH tool into suction end of handheld unit for cleaning of fabrics, glass, electronics, etc.



1 EMPTY DUST CUP

Press the dust collector release button to remove from the body of the handheld unit.



2 Lift off dust collector and remove the filter.

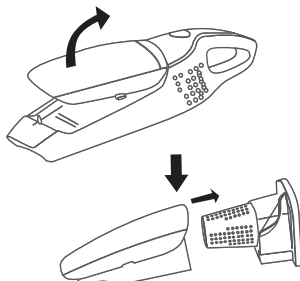

3 Empty dust collector into trash bin.

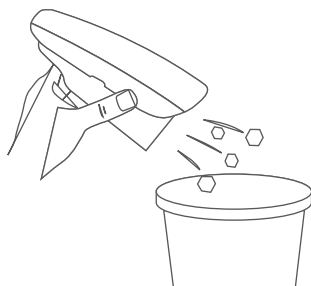

4 Remove filter element from filter screen.

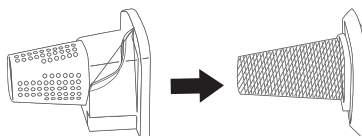

5 Gently knock debris and dust from the filter element and filter screen.

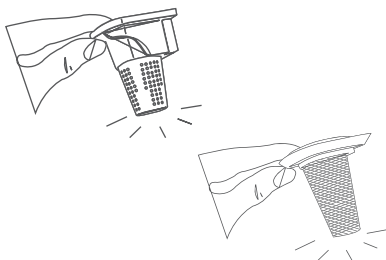

6 Reassemble filter and dust collector, then attach to body (see diagram below) - you will hear a click sound when connected properly.

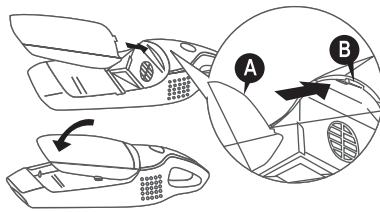

Care & Maintenance

1 CLEAN BRUSH HEAD

Use a coin to unlock the brush compartment on the underside of the brush head as shown here.

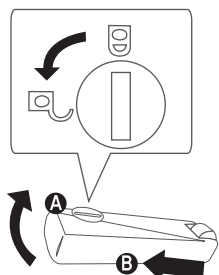

2 Remove the driving belt from the brush.

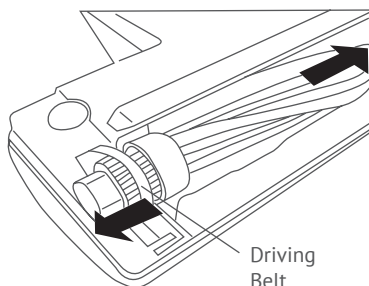

3 Pull brush to remove from brush head.

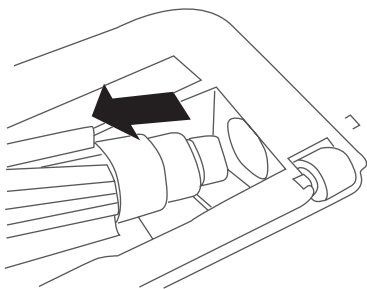

4 Carefully cut away any hair, yarn, or other debris entangled in the brush.

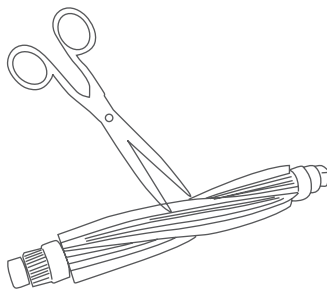

5 Clean the brush by running under water. NOTE: be sure to let the brush dry thoroughly before replacing.

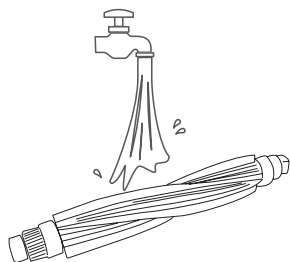

6 Remove any trapped debris from the underside of the brush head, and wipe down with a damp cloth.

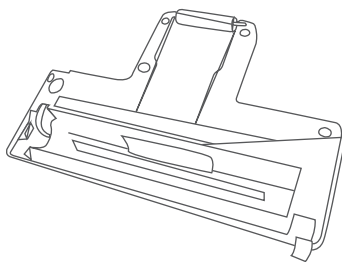

1 CLEAN DUST CUP

After removing the dust collector from the body, remove the filter screen and filter element. The dust collector may then be washed with a mild soap and soft cloth/sponge.



1 CLEAN FILTER

Before washing the filter screen and filter element, carefully knock out any dust or debris.

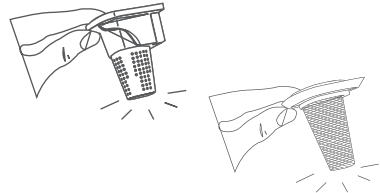

2

Filter screen and filter element may be washed with a mild soap and soft brush/cloth.

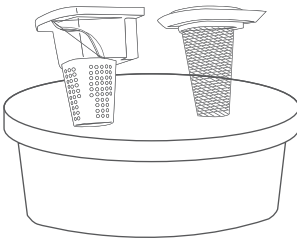

3

Rinse filter element under running water to remove any pollutants.
NOTE: be sure to let all parts dry thoroughly before reassembly.



1 REPLACE BATTERY

Use a screwdriver to access the battery on the underside of the handheld unit.

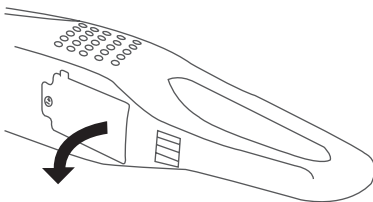

2

Pull battery to remove, then while pressing down on the tab, pull the battery connector apart to disconnect. Insert new battery in reverse order.

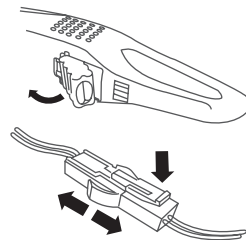

Troubleshooting

Problem	Battery Indicator	Possible Cause	Solution
Appliance cannot be recharged.	Charging indicator does not light.	1. The charging plug may be loose in the socket. 2. Power adapter is not securely attached to the appliance.	Attach the power adapter securely to the appliance.
	Battery indicator stays on longer than 6 hours.	The internal PCB board may be defective or damaged.	This problem can only be fixed by a professionally trained person. Please send or take appliance to an after-service depot.
Floor brush does not work, and handheld unit does not work either.	Battery indicator does not light up.	1. Power is off. 2. Brush is totally blocked by hair or other debris. 3. There may be a short on the circuit inside the brush.	1. Recharge the appliance. 2. Remove blockage from brush. 3. This problem can only be fixed by a professionally trained person. Please send or take appliance to an after-service depot.
Brush does not work, but handheld unit works normally.	Battery indicator is normal.	The rubber belt inside the brush head may be loose.	Check the drive belt (see cleaning instructions on Page 7). If belt is connected properly, please send or take appliance to an after-service depot.
Appliance does not pick up debris / suction power is weak.	Batter indicator is normal.	1. Dust cup is full. 2. Dust cup filter needs to be cleaned or replaced. 3. Brush is blocked by hair or other debris.	1. Clean the dust cup. 2. Clean the filter according to the instructions. 3. Remove blockage from brush.

Technical Specifications

Model	S7-LI-BLK
Battery	18.5V/2,200mAh
Charging Time	5-6 hours
Battery Charger Output	15V/800mAh
Net Weight	3.1Kg
Usage Time	40 min (low); 25 min (high)
Power	120W
Suction Power	4Kpa
Airflow	20m ³ /s



SilverOnyx LLC
14807 S Heritagecrest Way, Ste B
Bluffdale, UT 84065
801-341-2845
support@silveronyx.com



Go to shop.silveronyx.com for replacement parts.