



SERVICE DOCUMENT: GOCYCLECONNECT APP

DOWNLOAD & REGISTRATION FOR ANDROID & IOS DEVICES

Version 3.0



Download & Registration of the GocycleConnect App
for Android & IOS Devices



CONTENTS

1

Contentsi

Overview1

To Get Started	1
1. Downloading the Gocycle Connect App.....	2
2. Registering your Gocycle Connect App	5
3. How To: Firmware Update.....	12
4. Registering Multiple Gocycles.....	15



OVERVIEW

This document details the download and registration of the GocycleConnect App when using Android devices with a Gocycle operating firmware version v72 or higher.

CAUTION: OPERATION OF THE GOCYCLE MAY DIFFER BETWEEN FIRMWARE REVISIONS. IF UPDATING, CHECK THE RELEVANT OPERATION INSTRUCTIONS BEFORE RIDING, AVAILABLE AT WWW.GOCYCLE.COM/SUPPORT/FIRMWARE.

If you have any questions, or require any further assistance, please contact your local reseller.

TO GET STARTED

To successfully complete the procedure ensure the following;

- Your device has Android 4.4 or later installed
- You have an internet connection (3G or Wi-Fi)
- Your Gocycle is switched "ON"
- You are not more than 2m away from your Gocycle

1. DOWNLOADING THE GOCYCLE CONNECT APP



Note: Before continuing, ensure you have an internet connection.

1.1 Enter the Android Play Store by selecting the "Play Store" icon on your Android device.

Enter the iOS App Store by selecting the "App Store" icon on your IOS device.

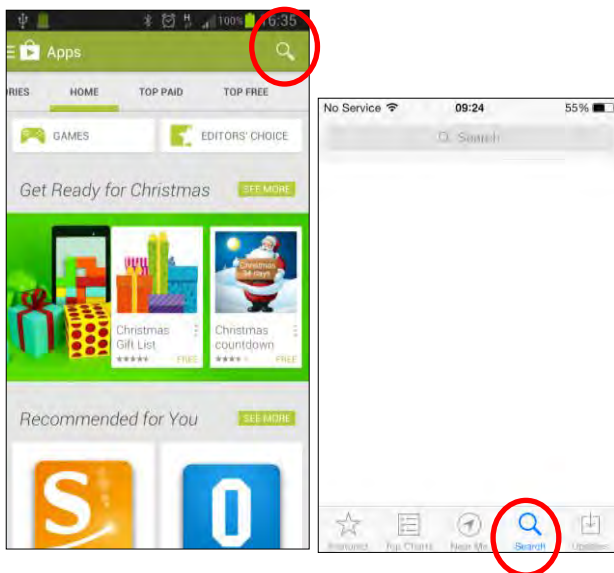

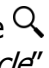
1.2 Open the Search function by clicking on the  symbol and type in "Gocycle".

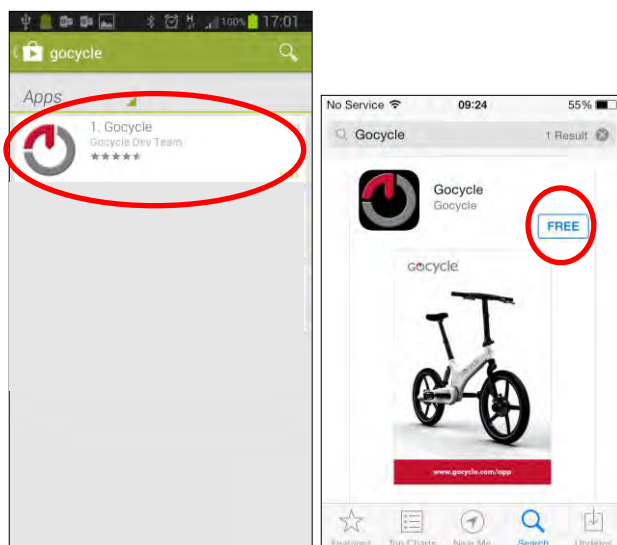

1.3 Download the Gocycle Connect App by clicking on the "Gocycle" app tab on Android, or by clicking "Free" on iOS.

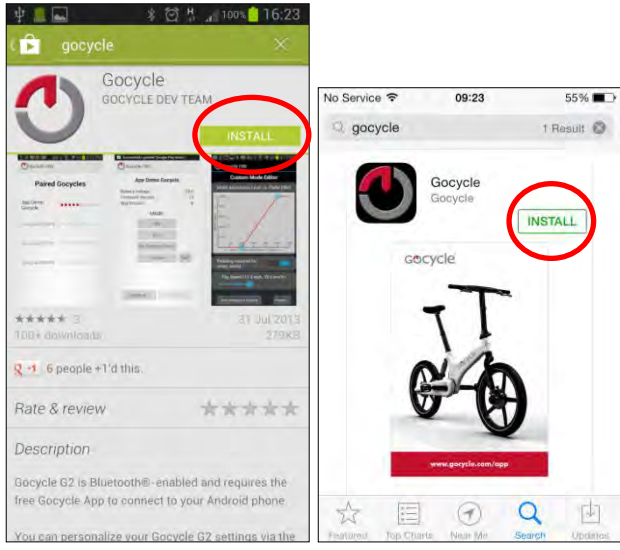

1.4 Click on "INSTALL".

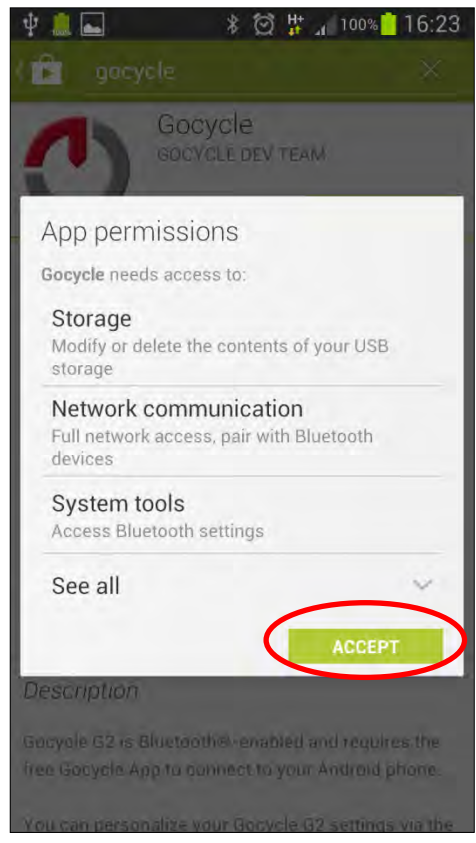

1.5 **Android Only.** The "App permissions" window will appear. After agreeing to the permissions, click "ACCEPT".

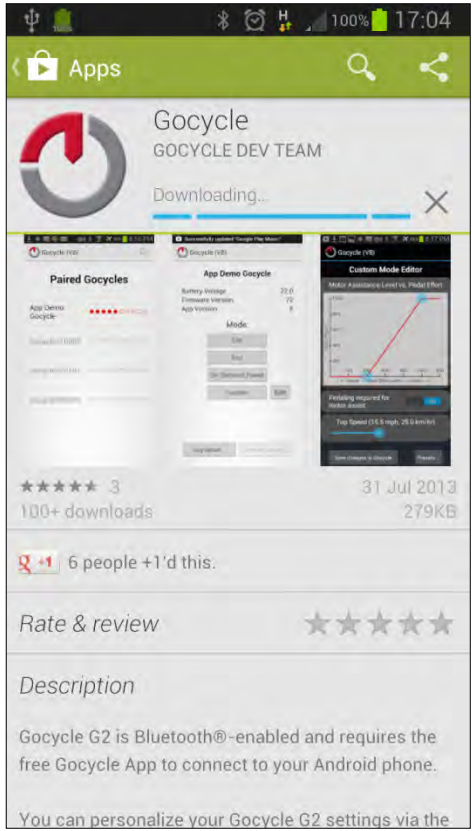

1.6 The Gocycle Connect App will now begin downloading.

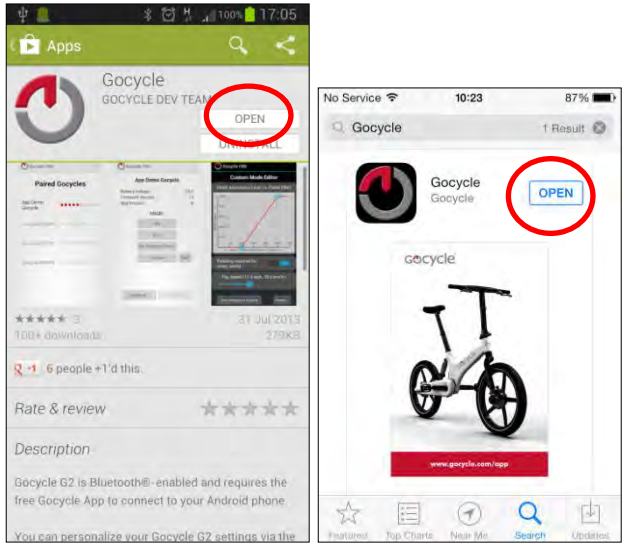

1.7 Click on the "OPEN" tab.



1.8 The Gocycle Connect App will now open.

2. REGISTERING YOUR GOCYCLE CONNECT APP

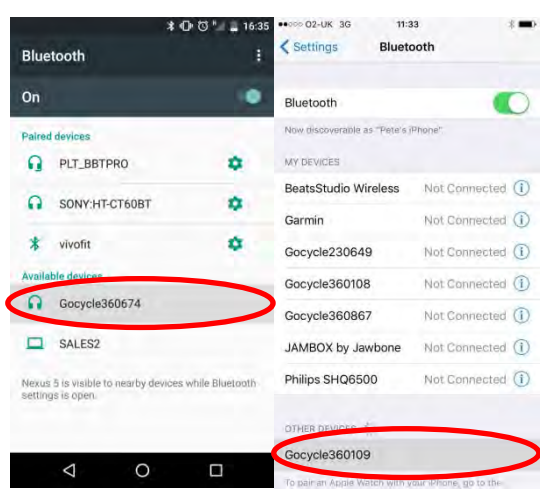

2.1 To connect to your Gocycle, open and turn on your Bluetooth and wait for your Frame Number to appear in the list of available devices.

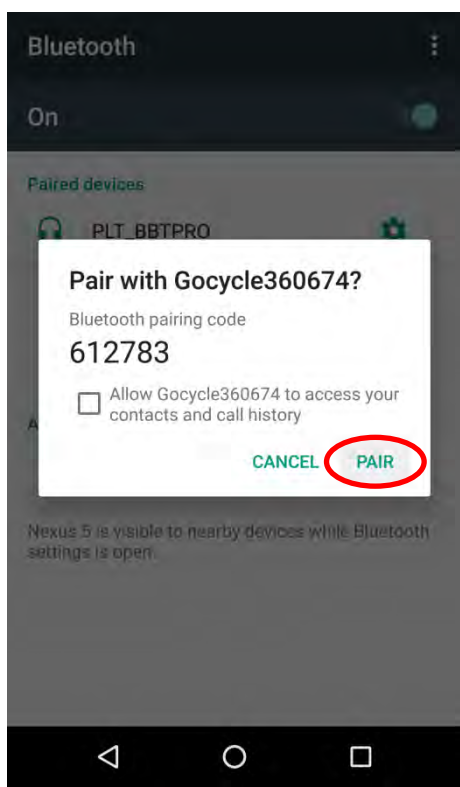

2.2 Click on your Gocycle Frame Number and your device will look to connect and pair with your Gocycle.

N.B. Note Android users will be prompted to "PAIR".

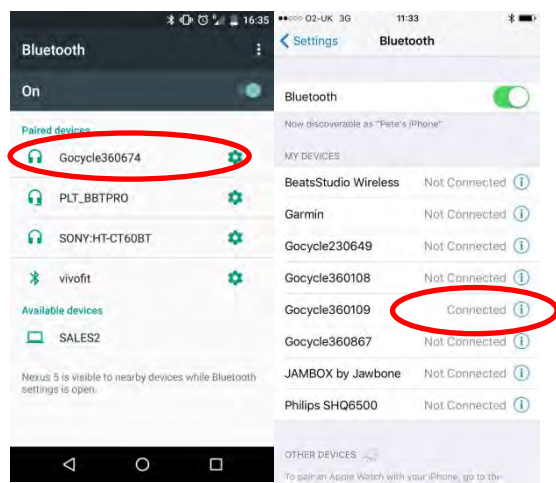

2.3 Your Gocycle should now be connected with your Bluetooth – please return to the Gocycle App.

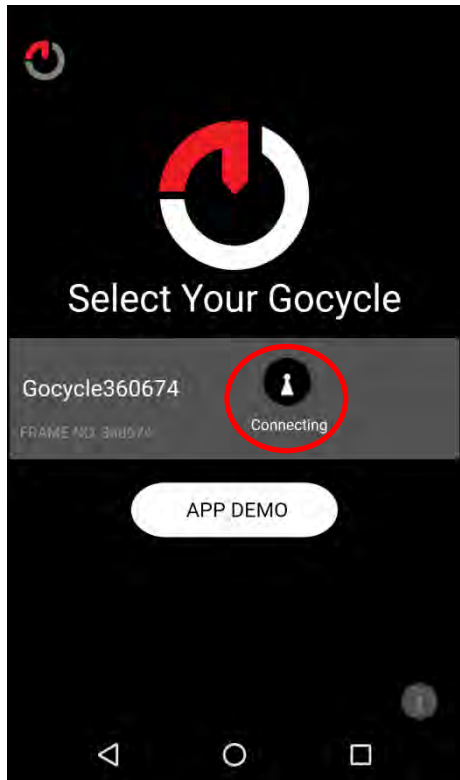

2.4 Now click on Connect in order to enter the Gocycle settings and begin the registration process.

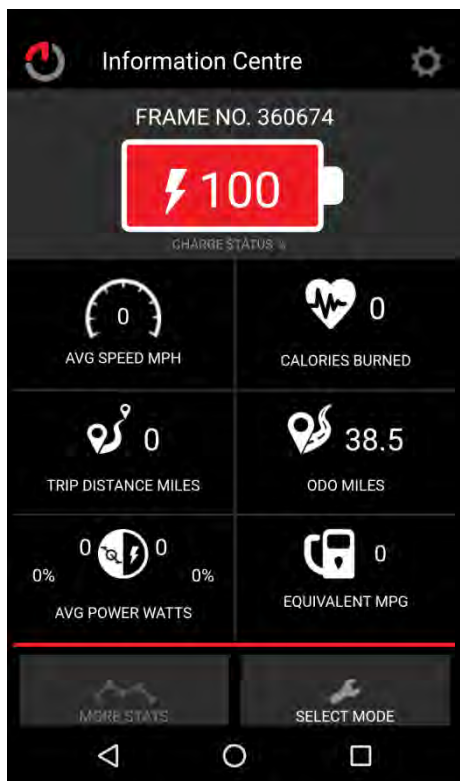

2.5 The App will display the Gocycle top level Data and as it connects to the server will bring up the registration page.

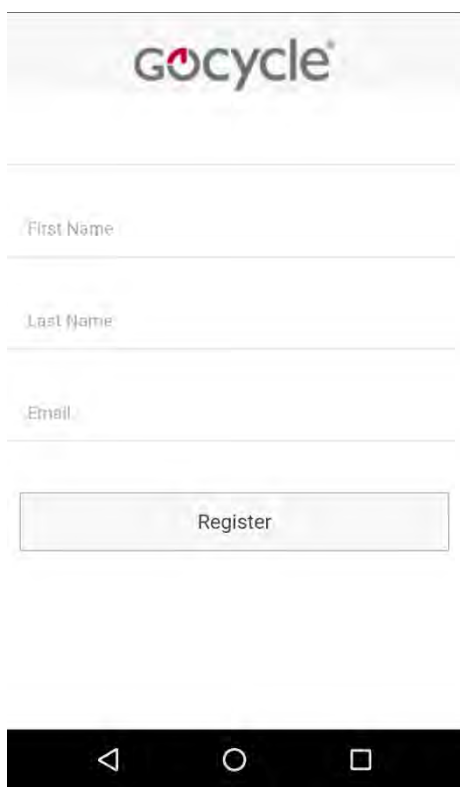

2.6 Once the “Gocycle App Registration” page appears enter your name and email details and click “Submit”.

CAUTION! Ensure that the email address is entered correctly.

NB. Your email address can only contain letters, numbers, full-stops (.), hyphens (-) and underscores (_). It CANNOT contain special characters, accented letters or letters outside the Latin alphabet.

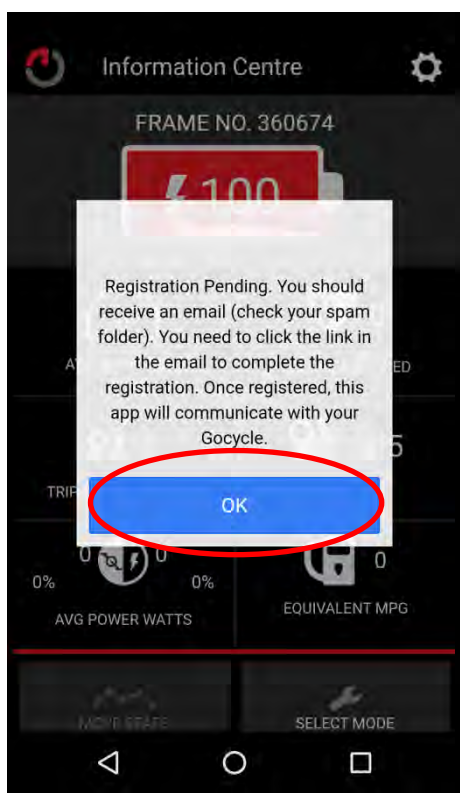

2.7 Click “OK”.

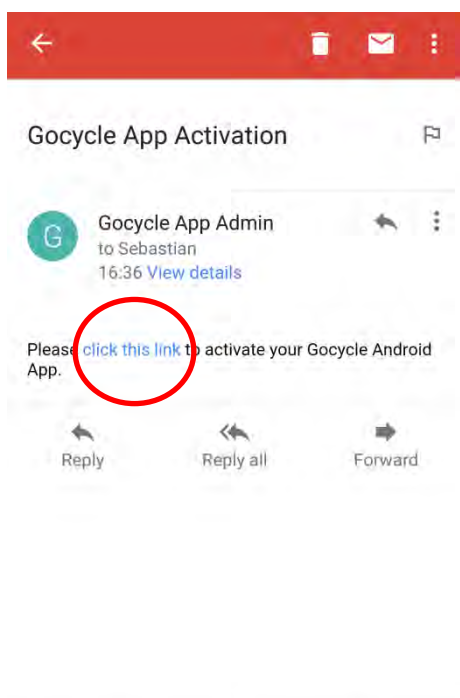

2.8 An activation email will be sent to the email address provided.

Note: (This may take a few minutes. Please also check your junk folder)

Follow the directions given on this email.

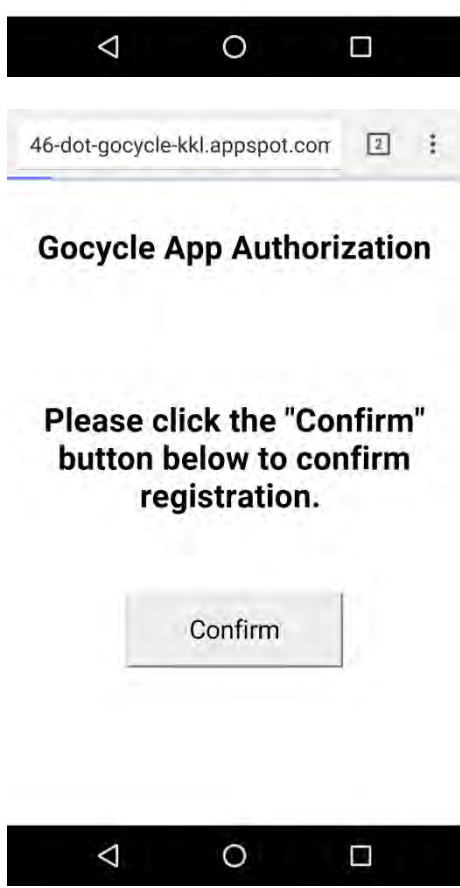

2.9 You will be redirected to a page which will authorize your Gocycle and device as registered.

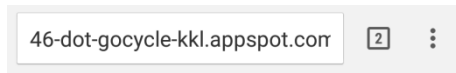

Gocycle App Authorization

Authorization successful.

You may now return to the GocycleConnect App and begin use.

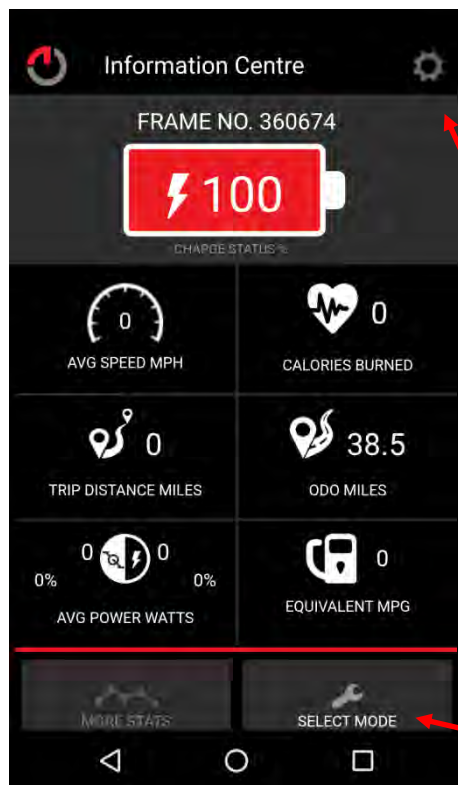

2.10 Your Gocycle Connect App is now authorised and ready to be used.

2.11 Return to the Gocycle Connect App and connect to your Gocycle. The App will display the Frame Number, average speed, calories burned, trip distance miles, average power watts (rider vs motor) and the equivalent MPG. The ODO miles will count up sequentially logging the total distance your Gocycle has travelled.

- Change settings by clicking the "gear" symbol
- New settings include unit of measure preference (miles vs km)
- Change modes by clicking "Select Mode"

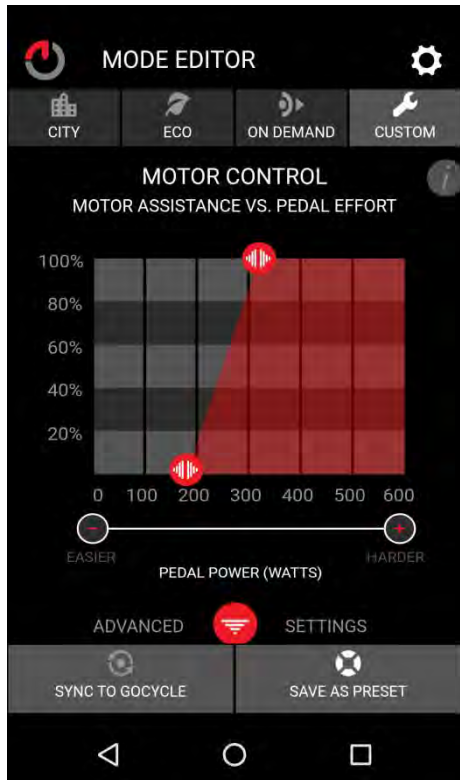

2.12 Select Mode option.

Allows you to toggle between preset modes and also set your custom mode for the Gocycle. Advanced settings allows further custom mode alterations

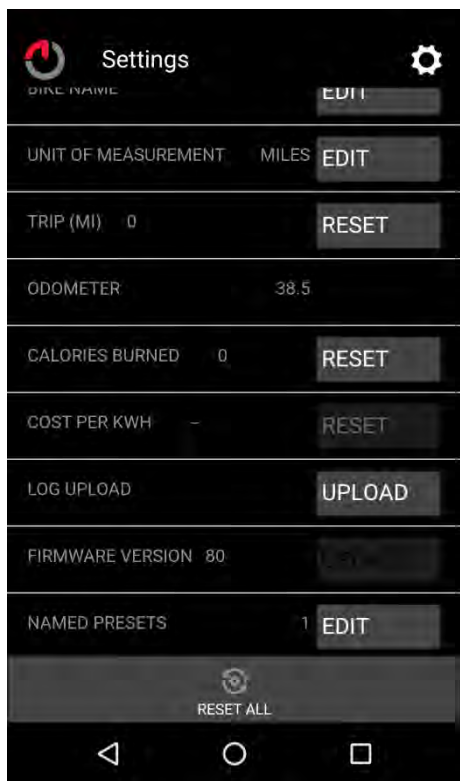

2.13 Settings Menu:

Allows personalization of your Gocycle and App.

3. HOW TO: FIRMWARE UPDATE

From time to time, improved versions of firmware will be released in the form of Firmware Updates. To take advantage of these enhancements;

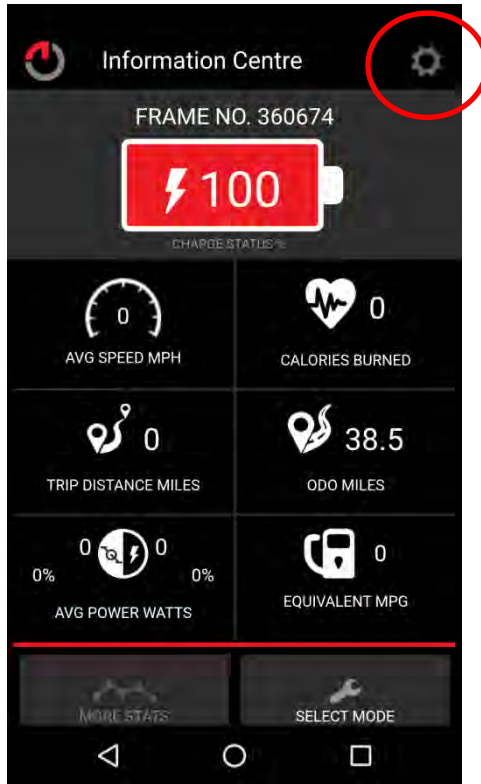

3.1 Click on the settings wheel in the top right of the App and ensure you have good wifi connection or 4g mobile data connection.

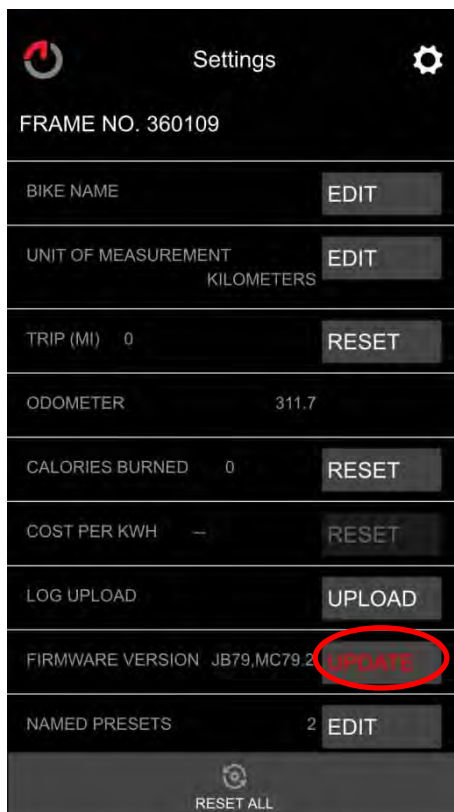

3.2 To update the Gocycle Firmware, click on the "Firmware Update..." tab. This will highlight in RED if an update is available.

Note: Ensure that you have an internet connection before continuing.

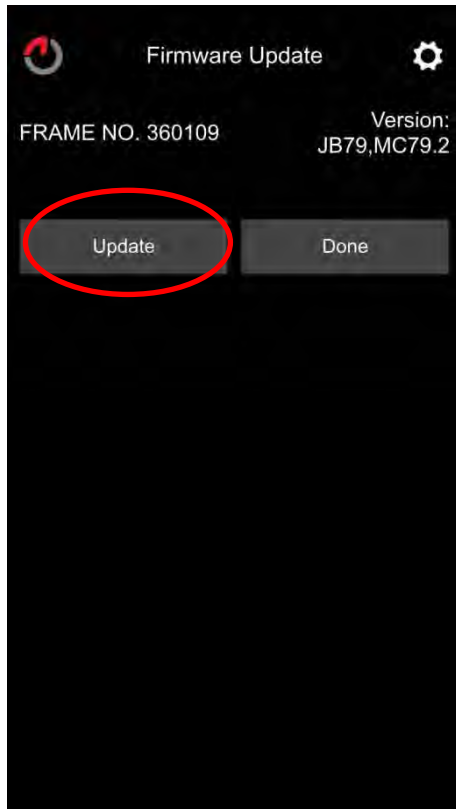

3.3 Wait for the "Update" button to highlight as it confirms the update and then press it.

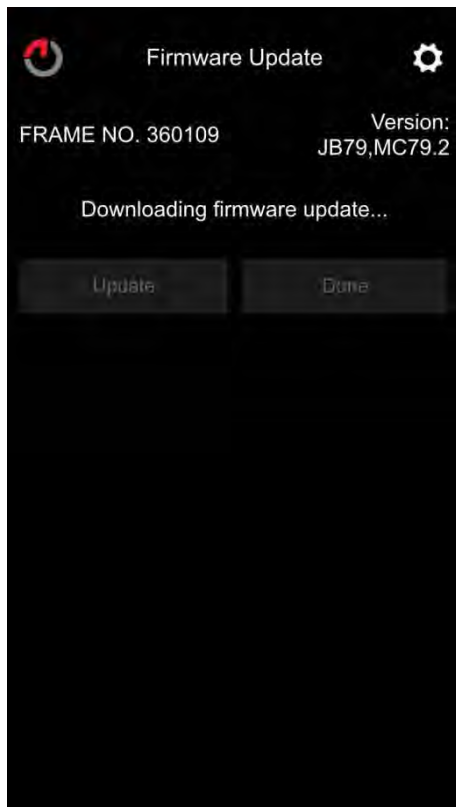

3.4 Please wait while the Firmware is updated.

IMPORTANT: DO NOT TURN OFF YOUR DEVICE, BLUETOOTH, WIFI OR DATA CONNECTION OR WALK AWAY FROM YOUR GOCYCLE DURING THE UPDATE PORCESS. Doing so can result in a corrupted firmware update

Note: Update speed will vary depending on your internet connection.

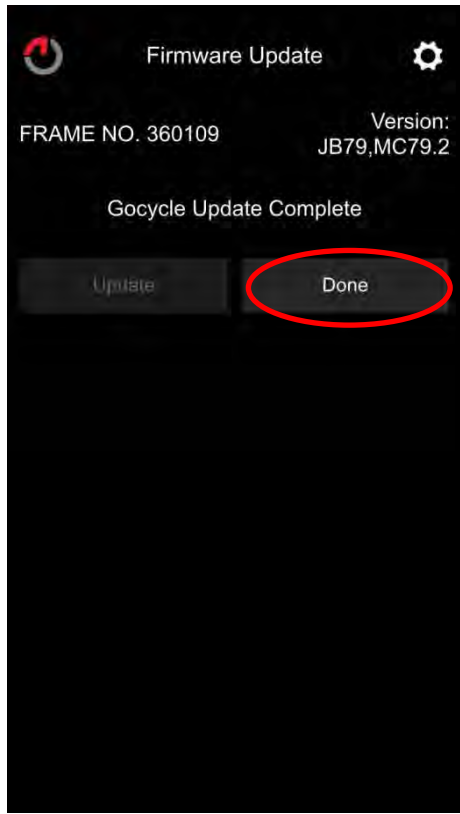

3.5 Once the Update has been successfully completed the "Gocycle Update Complete!" will appear.

Click "*Done*" to finish.



4. REGISTERING MULTIPLE GOCYCLES

In the event of multiple Gocycle ownership there are specific steps to follow to ensure all can be accessed and controlled by one or multiple devices.

The most important aspect when registering multiple Gocycles is to use the same email address – even across different devices as this will allow control across a whole fleet of Gocycles.

Please follow the outlined steps:

- 1) Turn on and register the first Gocycle as per the outlined steps in this guide.
- 2) Once registered turn off the first Gocycle and turn on second Gocycle.
- 3) Repeat the registration process for the second Gocycle and ensure to enter the SAME email address as per the first Gocycle.
- 4) Now once both Gocycle are registered both can be controlled from the same device.

If you wish to use a second device to control the Gocycles then follow the registration steps and ensure to enter the SAME email address as used the first time when registering the Gocycles.