



MYDINGHY OWNER'S MANUAL

WARNING!

Before you assemble or use MyDinghy, Please carefully read entire manual and follow all instructions. Failure to follow the instructions may result in serious injury or death. Keep this manual for future reference and provide it to anyone using MyDinghy.

Thank you for using MyDinghy! ▶▶▶ Anytime Anywhere, MYCANOE !!

- MYCANOE is working passionately to make water sports such as canoeing more accessible to everyone.
- MYCANOE company works with the Canoe Research Center to improve quality and develop new products.
- We may make improvements and changes to products at any time without announcement.
- To ensure safety during water sports, please follow all instructions in this manual.
- MYCANOE is always open to your suggestions and feedback.

Contents

1. What is MyDinghy?
2. Assembly
3. Packaging
4. Safety guides
5. Boating basics
6. Maintenance and management
7. Troubleshooting
8. Warranty

Questions and suggestions

www.oricanoe.com
info@oricanoe.com

Explanation of symbols used in the user manual



Mandatory

Indicates that failure to follow instructions in the manual may lead to death or serious injury



Prohibition

Indicates that failure to follow instructions in the manual may lead to injury or damage to your MyDinghy



Warning

Guidelines to follow to prevent damage to the dinghy
Guidelines to follow when the dinghy is broken or damaged
Important information for users
Information to make your experience more convenient

1. What is MyDinghy?

MyDinghy is a unique origami folding boat that is made with marine-rated structures and materials. MyDinghy fits in a small sedan when it is folded, and when unfolded and assembled, it transforms into a versatile 9.5-ft (289cm) boat.

1.1 Materials

Boat type Dinghy Boat **Version** MyDinghy 1.0
Main material polypropylene plastic (5mm poly-propylene)
Time required for assembly Approximately 10 minutes
Assembly method Buckles, rings
Other accessories ABS plastic, stainless steel bolt, aluminum pipe

1.2 How big is MyDinghy?

Division	Assembled	Packed
Length	9.5 ft (288 cm)	3.2 ft (99 cm)
Width	37 in (94 cm)	10 in (25 cm)
Height	2 ft (61 cm)	26 in (65 cm)
Weight	53 lb (24 kg)	53 lb (24 kg)

Images

※Separate accessory bag



1.3 How much can MyDinghy carry?

- **Maximum load**
(With stabilizer attached)
: 396lb (180 kg)
- **Recommended load**
: 286lb (130 kg)



Warnings

- ⚠ The maximum weight refers to the weight of the persons on board and all other gears.
- ⊘ The maximum load can not be exceeded under any circumstances.
- ! You must balance the weight distribution of the MyDinghy when sitting or loading gears.
- ! If the maximum load has not been exceeded but weight distribution proves difficult, try to distribute weight evenly by moving the position of the seat or gears.
- ! If weight distribution fails, try to limit weight of luggage or carry only a single person.

1.4 Part name of MyDinghy

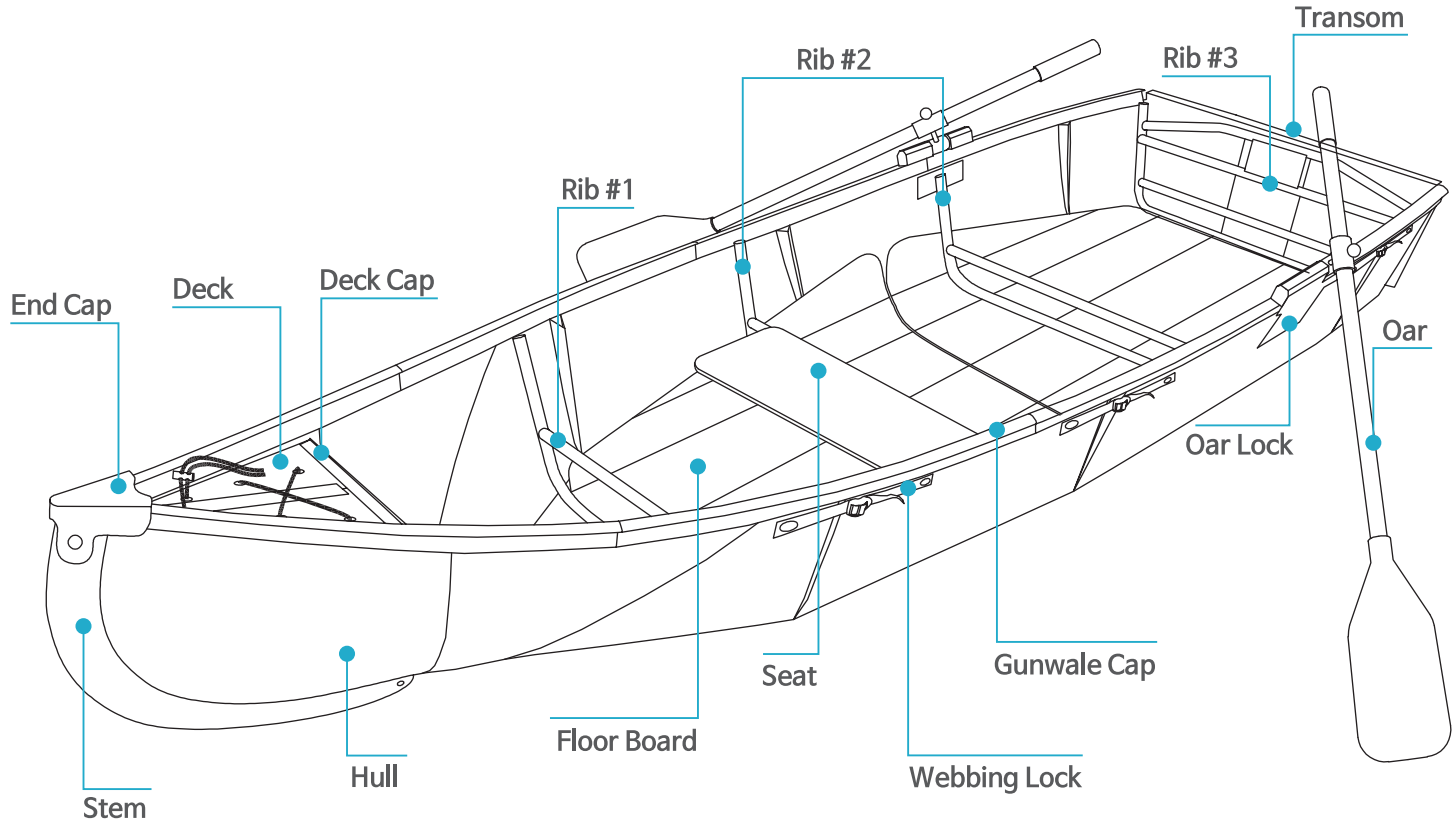

2. Assembly

Please watch assembly video at www.oricanoe.com. For the first time assembly, allow 30 -45 minutes. Once you understand the entire assembly steps, it should take 10 - 15 minutes.

Ribs and gunwale caps might be a little hard to install first time due to the curve shape of boat and characteristics of the materials, but they were designed to be tight for best performance. Please assemble with care. Once the ribs and gunwale caps are in place and used a few times, they should fit better.

If you need any assistance, please contact us either by phone at 800.566.6965 or email at service@oricanoe.com

PACKAGE BOX

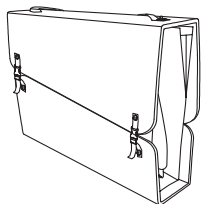

Hull Sheet

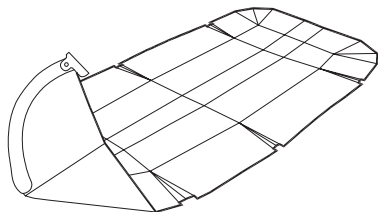

Floor Board
(case covers)

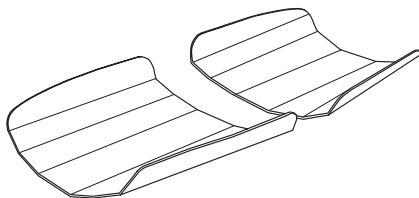

ACCESSORY BAG

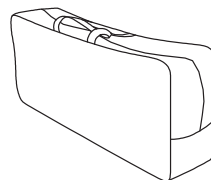

Rib#1



Rib#2

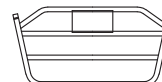

Rib#3



Gunwale Cap



mallet

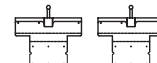

Oar Lock 1Set

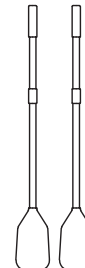

Oar 1Set



Deck Cap



Repair Kit

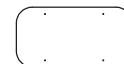

Seat

2.1 Open and unfold the package

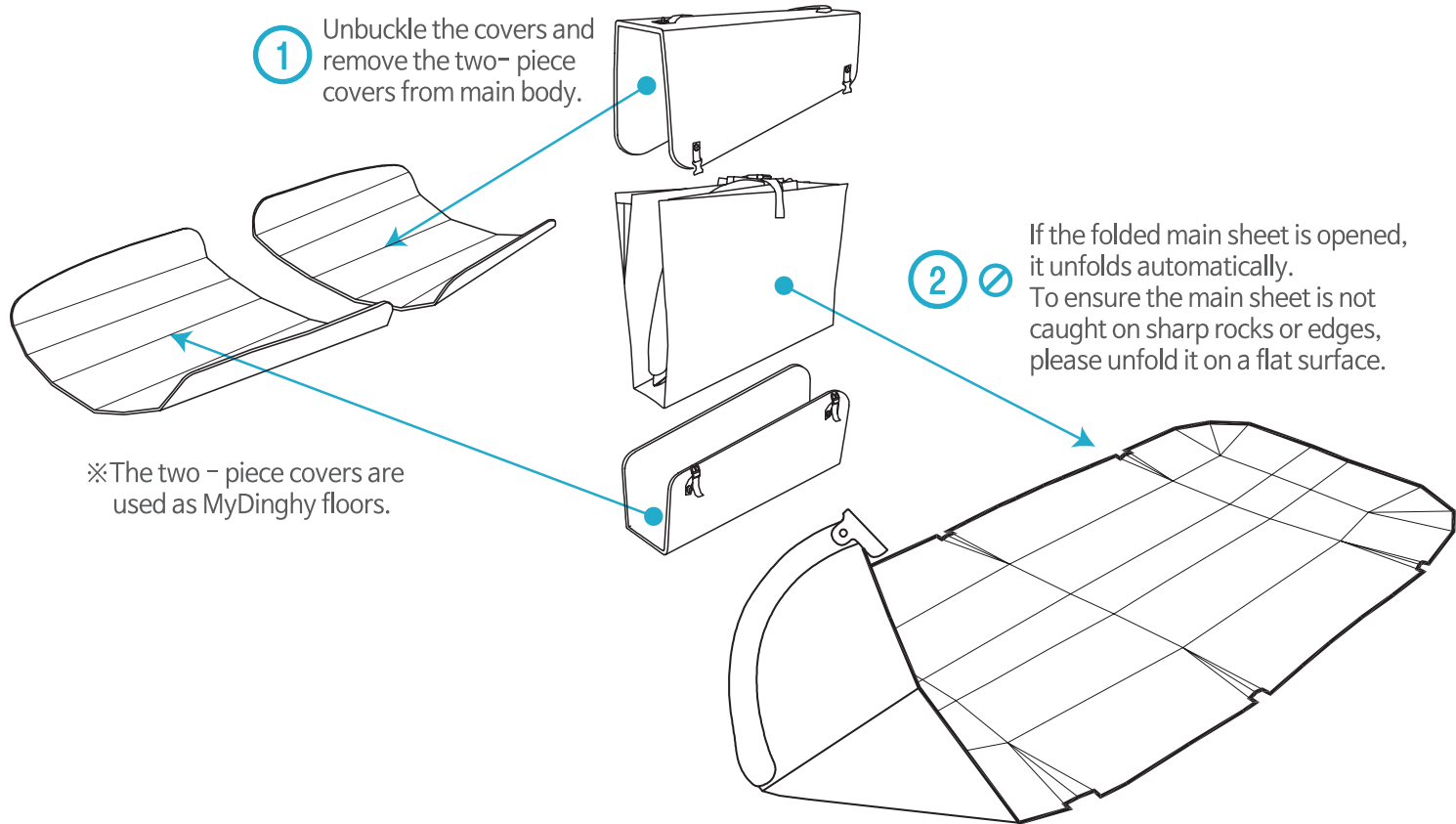

2.2 Install small ribs and floor boards (STEP-1)

1 Unfold and make a boat shape

- Unfold the hull on a flat soft surface and tighten all webbing locks.
- Fold the transom as shown in the figure below and temporarily hold with Velcro.

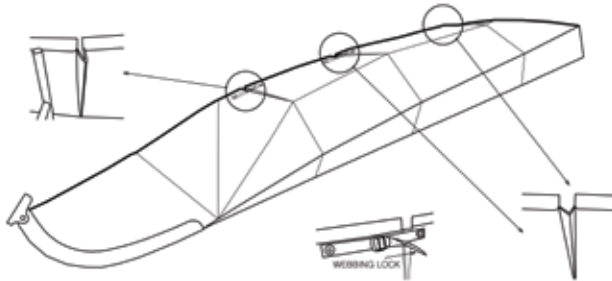

How to Fold the Dinghy's transom

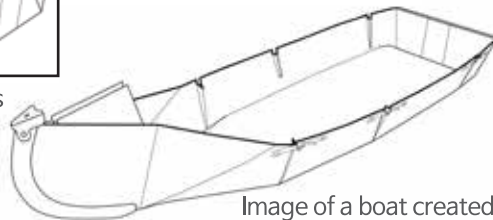
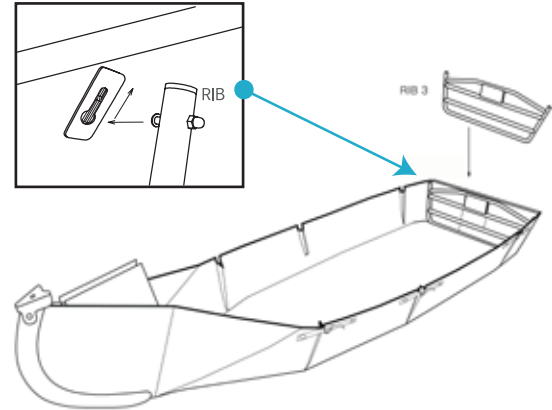

Image of a boat created with the webbing lock tightened.

2 Install the transom rib(#3) first.

- Install the transom rib (#3) by inserting one side of the rib into the slots attached in the hull.
- Do the same for the other side and slide & turn the rib to position. If necessary, gently tap using the provided mallet.



3 Install stern rib (#1) and floors.

- Install the rib where the guide mark shown on the floor.
Swing the rib from the center of the boat as shown in the figure below.
- Install two-piece case covers as floors. Velcro side up.
Match the “X” mark on the floor.

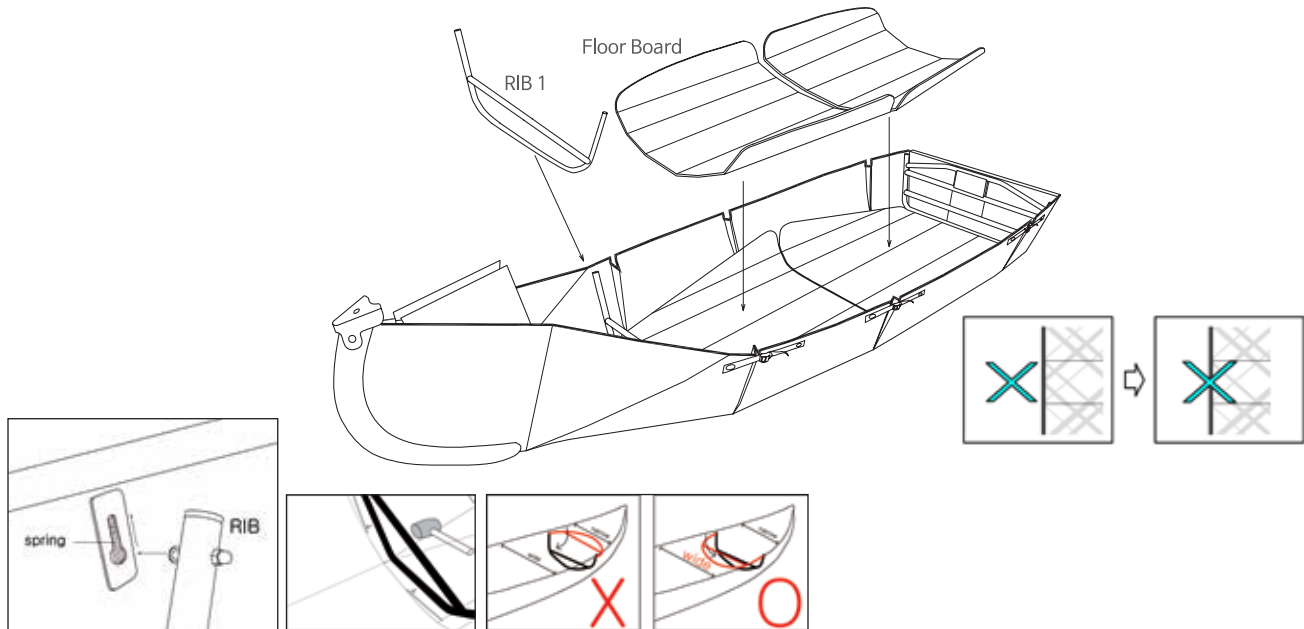

2.3 Install center ribs (#2) and deck cap (STEP-2)

- 1 Install the two ribs over the floors and secure the Velcros.

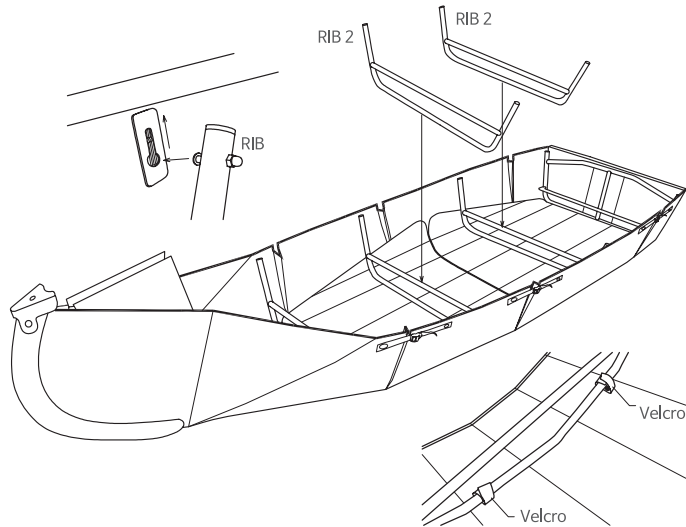

- 2 Form the front

- Push from inside to form the bow and install the spreader to the slot.
- Form the deck by putting the two sides together.
- Install deck cap.

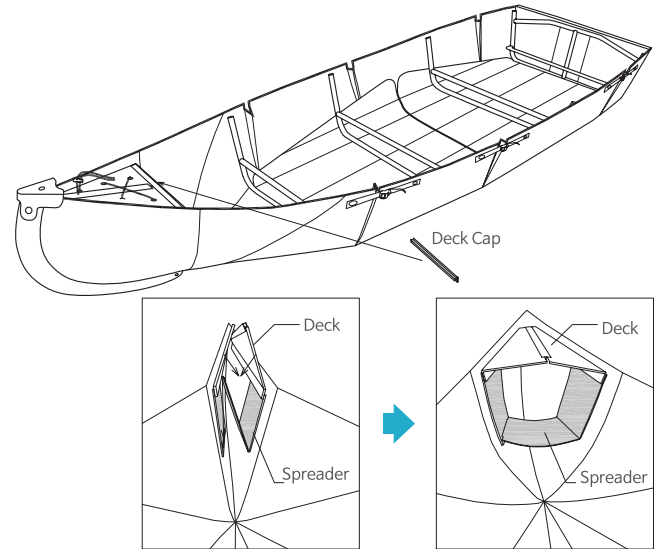

2.4 Install gunwale caps, seat, and oars (STEP-3)

1 Install gunwale caps

- Untie the transom Velcro and install gunwale cap as shown in the figure below.
- Secure Velcro.
- Insert gunwale caps beginning the end with a small metal part. Connect two caps first, install to gunwale, then proceed with the rest. Connect another cap before tightening Velcro. Finish all the way to the front and tighten the wire lock.

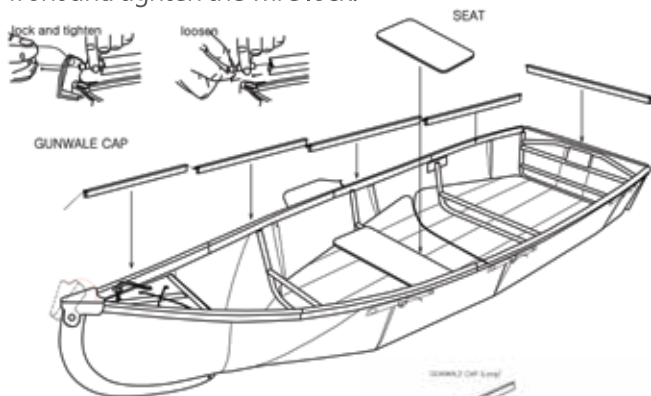

- Tighten all webbing locks again. Watch assembly video at www.oricanoe.com to better understand this step.

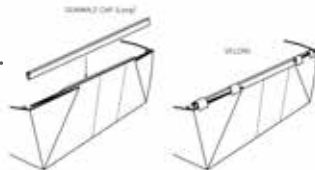

2 Install seat and oars

- Make the seat in shape. Attach the hook into the bottom rail of the center rib and install the seat on the rib. Pull the string to secure it. Test the seat before you head water.
- Untie Velcro on the built-in locks on the hull. Insert the two pins on the oar lock into the slots. Tighten Velcro.

Seat



※Make sure the bottom panel of the seat is squared with floor.

Oar

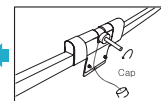
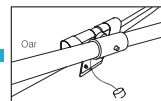
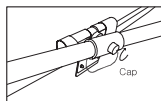
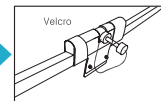
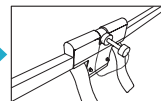
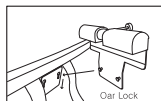

3. Disassembly

Follow the assembly steps in reverse to remove gunwale / deck caps. LOOSEN all webbing locks and unlock the spreaders. Remove ribs and floor boards. For main body, see the drawings below. You may gently tab to fold it correct direction.

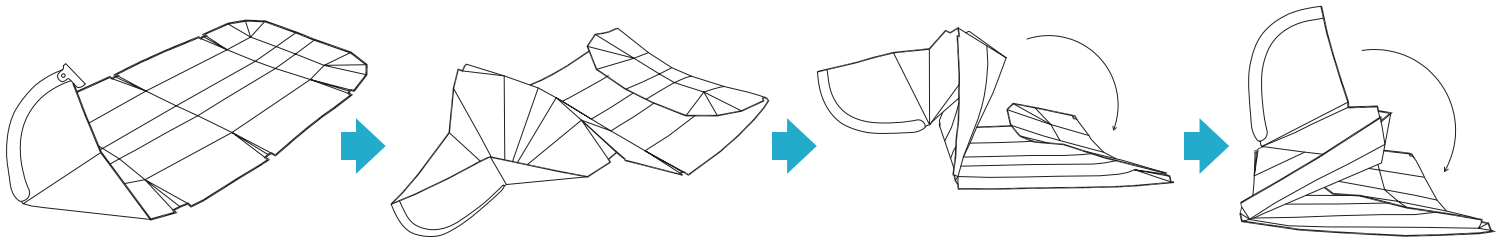

Straighten the folded main sheet and cover the floor board (cover).



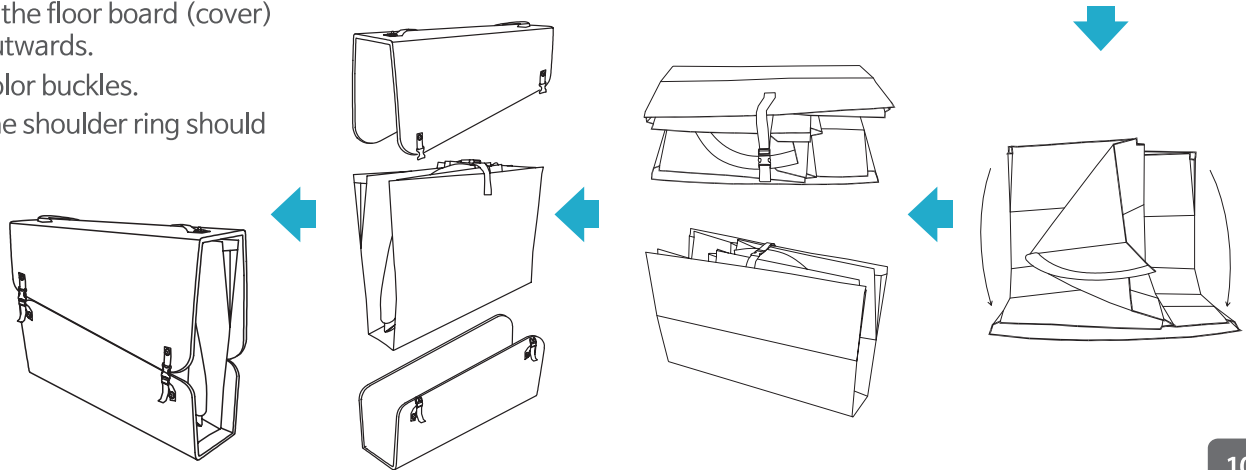

- The printed side of the floor board (cover) should be facing outwards.
- Match the same color buckles.
- The surface with the shoulder ring should face upwards.



4. Safety guide

- As boating is a dynamic sport, it may lead to dangerous outcomes if safety rules are not followed.
- Please acquaint yourself with detailed safety instructions and devices before beginning your boating experience.
- When safety rules are not followed, all responsibility for accidents lies with the canoe operator.

4.1 Before you go Boating

-  Boating is a sport enjoyed on calm lakes or softly flowing inland waterways. Please do not go Boating in water with waves such as the sea or in valleys.
-  If must not go Boating if you are not feeling well or after drinking alcohol. Please go Boating after adequate practice and stretching.
-  You must pay careful attention to the weather before you go Boating.
-  If you detect a sudden change in the weather, please get out of the water immediately.

Beaufort Wind Scale

- ✓ You may go boating in conditions up to the third level (gentle breeze) of the Beaufort Wind Scale.
- ✓ You must not go boating in windy conditions starting from the fourth level (moderate breeze).

※ The Beaufort Wind Scale is not an absolute criteria for judging wind conditions. However, you are advised to use the scale when you go boating because it can help you judge wind speed when used along with observations made with the naked eye.

Beaufort Wind Scale				
No.	Description	Sea Conditions	Land Conditions	Wind speed (m/sec)
0	Calm	Flat.	Smoke rises vertically.	0.0-0.2
1	Light Air	Ripples without crests.	Wind motion visible in smoke	0.3-1.5
2	Slight Breeze	Small wavelets. Crests of glassy appearance, not breaking.	Wind felt on exposed skin. Leaves rustle.	1.6-3.3
3	Gentle Breeze	Large wavelets. Crests begin to break; scattered white caps.	Leaves and smaller twigs in constant motion.	3.4-5.4
4	Moderate Breeze	Small waves	Dust and loose paper raised. Small branches begin to move.	5.5-7.9
5	Fresh Breeze	Moderate (1.2 m) longer waves. Some foam and spray.	Branches of a moderate size move. Small trees begin to sway.	8.0-10.7
6	Strong Breeze	Large waves with foam crests and some spray.	Large branches in motion. Whistling heard in overhead wires. Umbrella use becomes difficult. Empty plastic garbage cans tip over.	10.8-13.8
7	Near Gale	Sea heaps up and foam begins to be blown in streaks in wind direction.	Whole trees in motion. Effort needed to walk against the wind. Swaying of skyscrapers may be felt, especially by people on upper floors.	13.9-17.1
8	Gale	Moderately high waves with breaking crests forming spindrift. Streaks of foam.	Twigs broken from trees. Cars veer on road.	17.2-20.7
9	Strong Gale	High waves (6-7 m) with dense foam. Wave crests start to roll over. Considerable spray.	Larger branches break off trees, and some small trees blow over. Construction (temporary signs and barricades) blow over. Damage to circus tents and canopies.	20.8-24.4
10	Storm	Very high waves. Large patches of foam from wave crests give the sea a white appearance. Considerable tumbling of waves with heavy impact. Large amounts of airborne spray reduce visibility.	Trees are broken off or uprooted, saplings bent and deformed, poorly attached asphalt shingles and shingles in poor condition peel off roofs.	24.5-28.4
11	Violent Storm	Exceptionally high waves. Very large patches of foam, driven before the wind, cover much of the sea surface. Very large amounts of airborne spray severely reduce visibility.	Widespread vegetation damage. More damage to most roofing surfaces, asphalt tiles that have curled up and/or fractured due to age may break away completely.	28.5-32.6
12	Hurricane	Huge waves. Sea is completely white with foam and spray. Air is filled with driving spray, greatly reducing visibility.	Considerable and widespread damage to vegetation, a few windows broken. Structural damage to mobile homes and poorly constructed sheds and barns. Debris may be hurled about.	over 32.7

4.2 Safety devices and equipment used when boating

- ⊘ Always use a U.S. Coast Guard – approved life jacket or personal flotation device (PFD). Read the PFD manufacturer’s instructions and familiarize yourself with how the PFD should be worn. You must not take off your life jacket under any circumstances.
- ⚠ Adequate measures to stay warm must be undertaken
- ⚠ Practice using all safety equipment until you are familiar with the equipment.
- ⚠ The boat must be assembled completely. Incomplete assemble may result in injury or death.
- ⚠ You are advised to prepare a whistle or other communication device to call for help in case of emergency.

Necessary equipment	<ul style="list-style-type: none">• Safety equipment : lifejacket• Paddle : Single edge paddle for use with dinghy• Communication device : cell phone, walkie talkie, emergency contact device (whistle, lantern, etc.).
Extra equipment	<ul style="list-style-type: none">• Emergency medical supplies, emergency food, body warming clothes.• Map and compass.

4.3 Information to be aware of when boating

- ⚠ Going boating alone is dangerous. If you do need to go boating alone, just remember you might need to seek emergency assistance from people nearby in case of emergency.
- Ⓛ Please ensure you don't load the dinghy with more than the recommended weight in passengers or gears. In no circumstances should you exceed the maximum weight allowed.

- ⚠ After getting in the dinghy, do not stand up or shift the weight balance until you get out of the dinghy.
- ⚠ Ensure children go boating with an adult guardian.
- ⊘ Boating should only be enjoyed on calm lakes or slow-moving inland waterways. They must not be used in waters where there are fast currents, tidal currents, or high waves.
- ⊘ Go boating in water deeper than 12 in (30cm). Using the dinghy in water shallower than this may result in scratching the bottom of the dinghy and other damages.
Depending on the weather, you are advised to wear clothes that will keep you warm.

5. Basics of boating

Learning the basics of boating is about learning how to protect yourself. Proper boating is equivalent to safe boating.

5.1 Getting in and out of the dinghy ⚠

- It is safest to get in and out of the dinghy at a dock higher than water level. If there is no dock available, you may use an appropriate rock.
- The dinghy is most unstable when getting in and out of the dinghy.

5.2 Weight distribution balance ⚠

- Weight distribution balance is the basic concept underlying safe boating.
- Do not stand up in any circumstances except when getting in or out of the dinghy.
- When paddling, if the weight distribution balance is not maintained, you may need to shift your seating positions or the position of the luggage.

6. Maintenance ! ⚠

The lifespan of your MyDinghy may be shortened if proper maintenance on the product is not carried out.

Please refer to the guidelines below for maintenance and care.

⚠ Use a special dock or wharf when getting in/out of the Mydinghy.

- If a dock is unavailable, use a place with soft sand or soil. Using a place such as a rocky coastline or a place with many stones may result in scratching the bottom of the Mydinghy and other damage.
- Do not pull or push the canoe when the bottom of the hull is touching a surface may result in damage to the hull.

⚠ Ensure you do not bump into or crash into sharp rocks.

- Ensure the hull does not come into contact with sharp edges when loading or placing luggage on the Mydinghy. This may damage the hull. Place heavy luggage on the bottom of the flooring.
- If damage occurs after a collision with a sharp object/edge, use double-sided waterproof tape to secure the dinghy as an emergency measure.
✳️When transporting the dinghy a short distance, use the shoulder strap.

⚠ Emergency repair

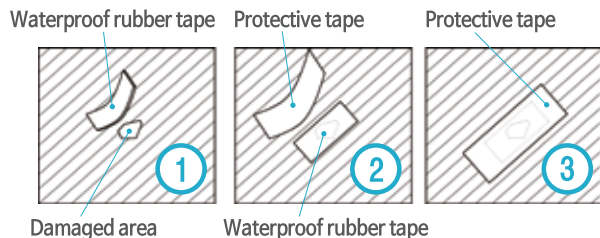

The corrugated plastic sheet requires special maintenance measures.

- ⚠ Avoid using, packaging, or assembling the dinghy in freezing temperatures. The main material plastic may crack.
- ⚠ As Mydinghy is made of a corrugated plastic sheet, it may melt if exposed to direct heat.
- ⚠ Wipe clean if boating took place in dirty water or if the hull becomes dirty.
- ⚠ Dry the dinghy after boating by turning the hull over and removing any water trapped inside. (Water may be trapped between the plastic molding. Remove water before storing.)
- ⚠ After drying, fold into packaged form and store in a place not exposed to direct sunlight. Please note that discoloration or deformation may occur if the product is exposed to sunlight for long periods of time.
- ⚠ Please note that the corrugated plastic sheet is easily scratched and may inadvertently be creased
- ⚠ Please assemble the dinghy in a place without pebbles. When assembling the dinghy, if you place your feet in the dinghy during assembly, any stones on the bottom of your feet may damage the dinghy.

❗ Any modification or changes made by customers will void warranty. Please email service@oricanoe.com or call us at 800-566-6965 for service request

7. Troubleshooting

- If MyDinghy leaks or damaged, paddle to the nearest shore and remove the water before repairing the dinghy.
- If minor damage occurs in specific sections of the hull, use waterproof tape for emergency repair. You can also use a glue gun before applying a tape for better sealing.
- If minor water leakage occurs near the bolt in the hull, tighten it using an appropriate tool.



8. Warranty

- The manufacturer is directly responsible for the product warranty and after-sales customer service.
- If a manufacturing defect or repair needs to be made within one year from the date of manufacture, an exchange or repairs will be provided without charge.
- If the product is damaged due to customer negligence or failure to follow safety guidelines, repairs will be made at cost to the customer.
- Please fill out the form below for convenient customer service.

Version		Serial No.	
Purchase date		Purchase location/agent	
Customer	Name	Phone	
	Address		

MYCANOE (USA)

P.O. Box 22463 KNOXVILLE, TN 37933

800-566-6965

E-mail: service@oricanoe.com

Homepage : www.oricanoe.com

MY Special Outdoor Event

Camping • Traveling • Fishing Gear

Dream It With MyDinghy

**Keep up with events and updates, and share
your own journeys, stories, and photographs:**

www.facebook.com/oricanoe

<https://twitter.com/MyCanoe1>

MYCANOE(USA)

P.O. Box 22463 KNOXVILLE, TN 37933

800-566-6965

E-mail : info@oricanoe.com

Homepage : www.oricanoe.com

MYCANOE 