



HEARTLAND USA®

250 Conversion 2000-2006 Softail Models (Instruction)



HARDWARE LIST

Parts List:

Swing Arm with Steel
Rock Guard,
Axle and Axle Covers

Slotted Struts

Solo Seat

Raw Steel Fender

25mm Primary Offset

Swing Arm Accesories

Hardware



Swing Arm with Steel Rock Guard,
Axle and Axle Covers



Slotted Struts



Raw Steel Fender



Solo Seat

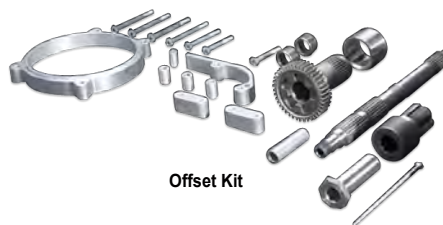

Offset Kit



ECM Tray



Horn CUT Template



Swing Arm Accesories



Hardware

17171 S. Western Ave., Gardena CA, 90247

Ph: 310-822-2697 Fax: 310-822-3687

www.heartlandbiker.com

We recommend reading through the entire install process before beginning.

1

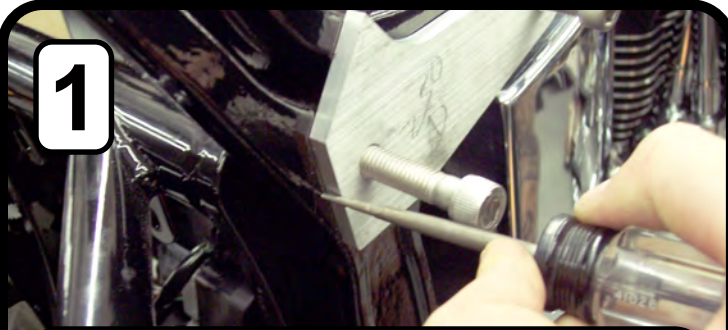

Cutting off Horns from the Frame

You will need to cut the steel horns off the frame to allow the Bobber Seat and fender to work.

1. Cut at both straight edges using the "Horn Cut Template" provided. With the template in place, begin cutting with a sawzall. .



2

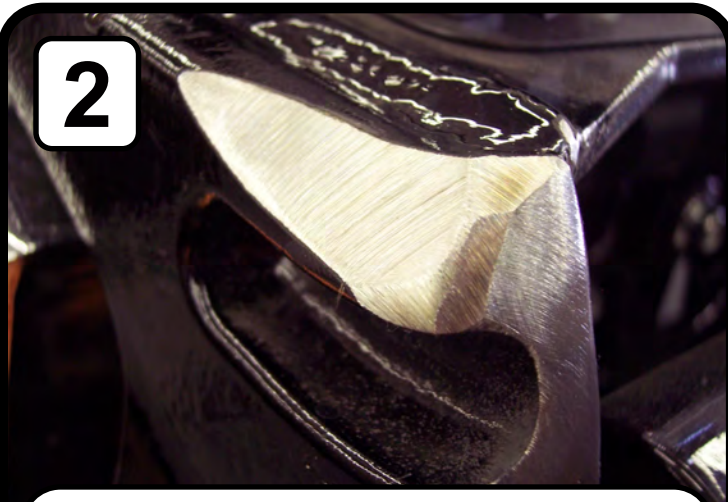

2. Grind for seat clearance on both sides of the seat frame.

4



4. Always check clearance between the swing arm and frame. See Swing arm install. You can use stock hat sleeves to help hold the swing arm in place as you check clearance. Put Stock hat sleeves from out side in as it is temporary. It will hold the swing arm as you check clearance.

3



3. You will also need to grind clearance for the swing arm on both sides of the frame. The rubber stopper will give so make the clearance about 3/16" plus / see photo.

25mm Primary Offset Installation - 25mm / 1" Offset (5-Speed)

To be installed by a trained technician using the factory service manual and factory torque specs.

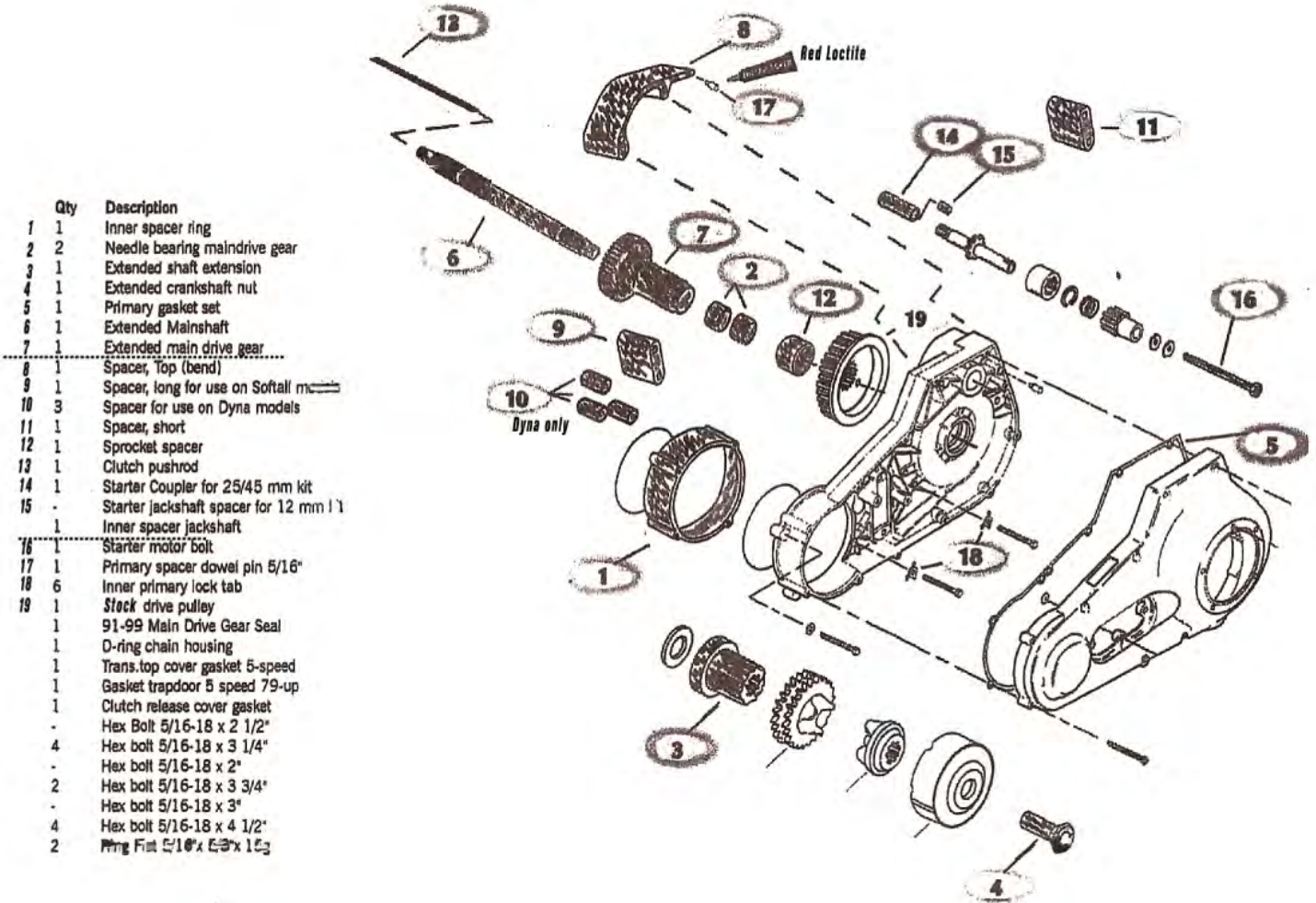

Swing Arm Install

NOTE: Swing arm sleeve for left side / two pieces. "Smooth" / "Hat".

Right side uses Stock sleeve / one piece. "Hat"



1

1. Install Pivot bearings in new 250 Swing arm from out side as per HD Specs.

2

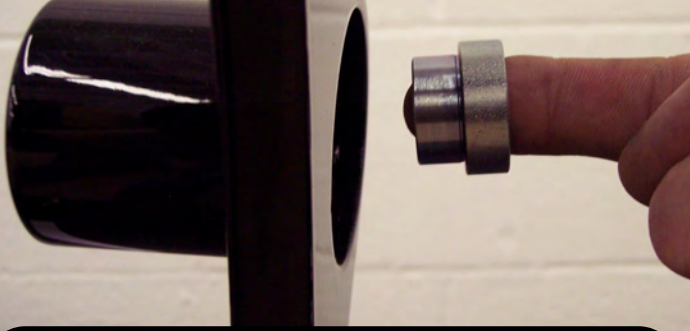

2. Install small HAT sleeve into left side of swing arm bearing.

3

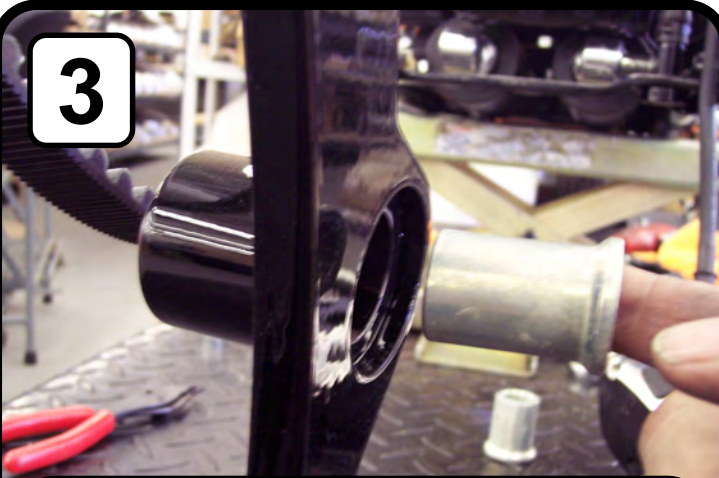

3. After the small hat sleeve is installed, place stock spacer sleeve in swing arm tunnel.

4

4. Install swing arm in frame with Hat sleeve and stock trans Spacer in the left side of swing arm.

Note: The small Hat sleeve does not extend into frame pivot bearing.

5

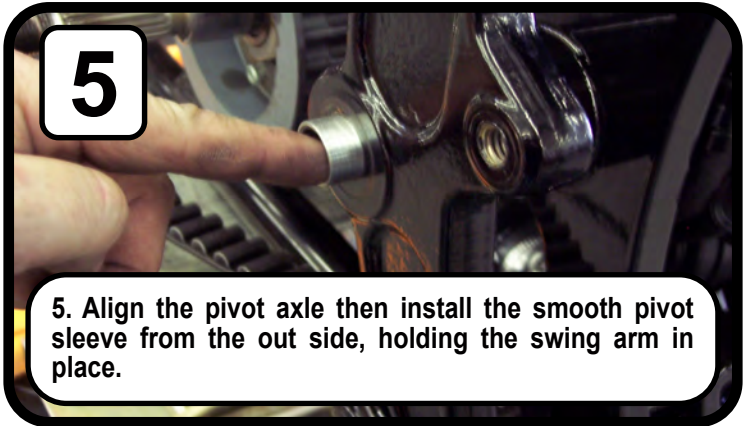

5. Align the pivot axle then install the smooth pivot sleeve from the out side, holding the swing arm in place.

6

6. Install right side stock hat sleeve on the right side from the inside.

It may be easier to install fender on the swing arm and then install on bike. It can be done either way.

7

7. Install pivot axle, from the right side and torque to factory specs.

8

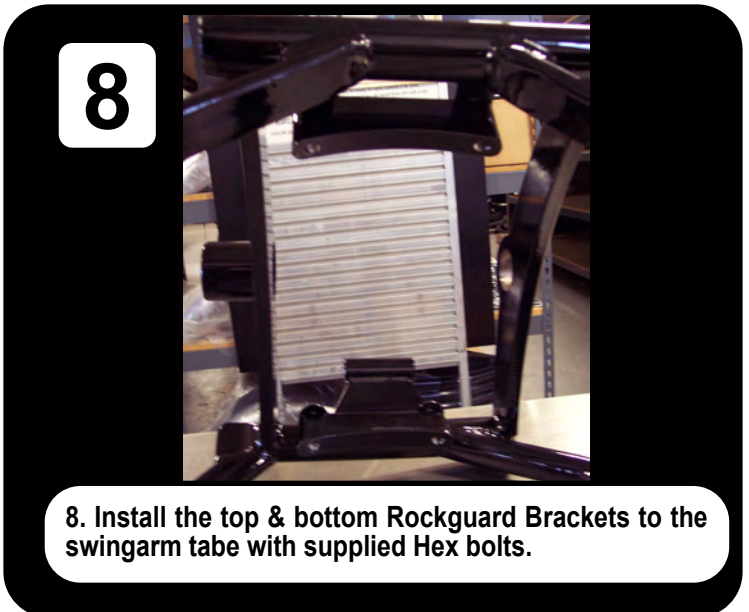

8. Install the top & bottom Rockguard Brackets to the swingarm tube with supplied Hex bolts.

9

9. Simply bolt the rockguard to the brackets with the supplied button head bolts.

Swingarm Bearing and Spacer Installation Guide

Technical Questions Please Call 310-822-2697

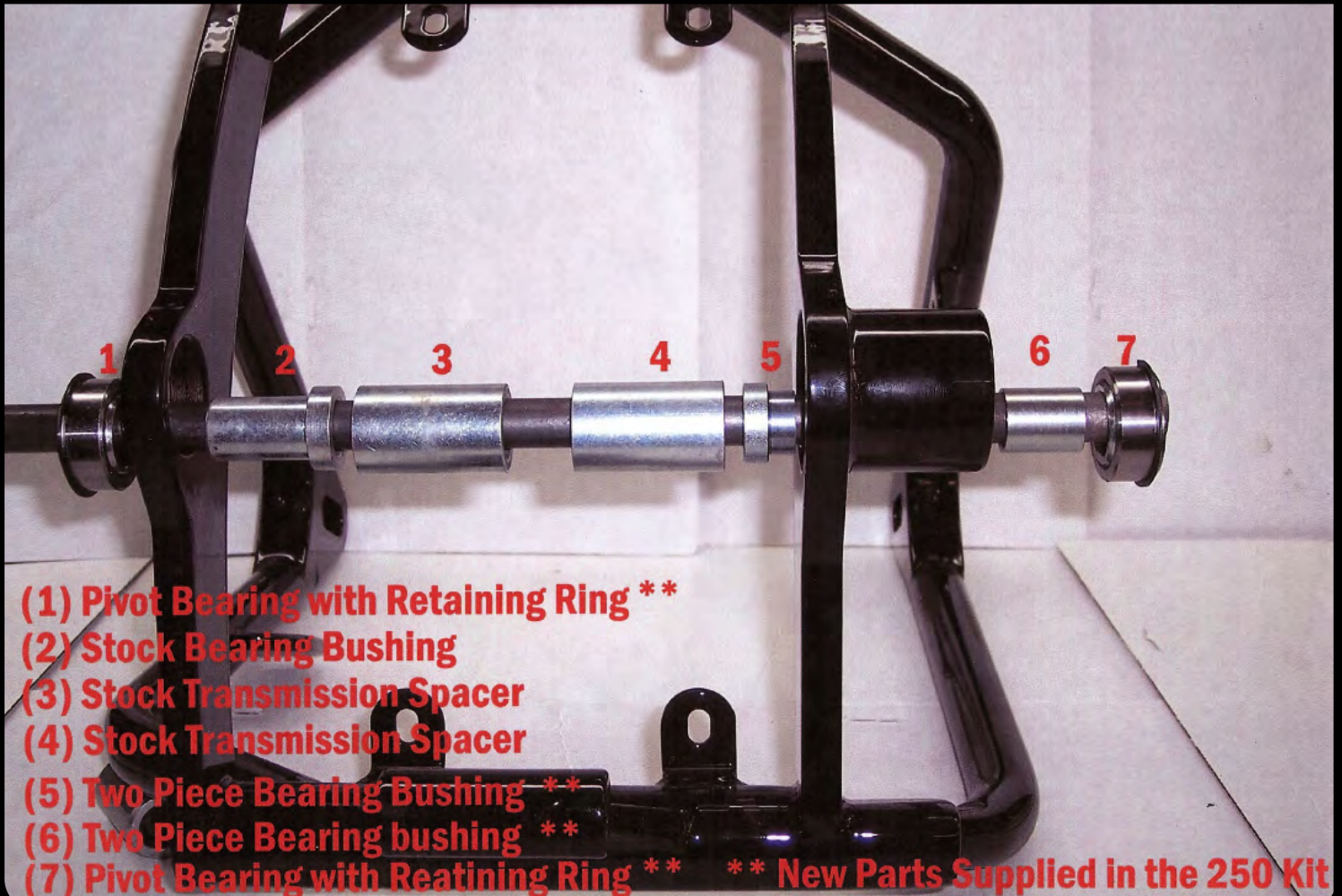

Fender, Struts & Seat Install (Instruction)

1

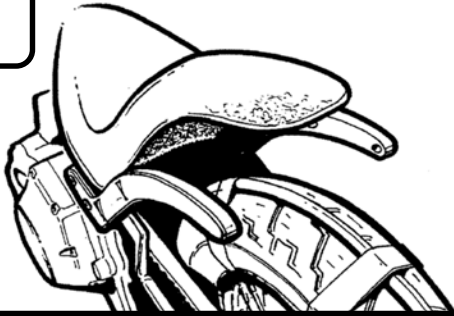

1. Mount the Heartland struts using supplied hardware and position seat tab into frame in front and push into place against struts. Position a half inch thick piece of tubing or hose in the center of the tire, use masking tape to hold in place. Using this tubing for space allowance provides centrifical force expansion clearance which may occur under extreme ridingsituations.

4

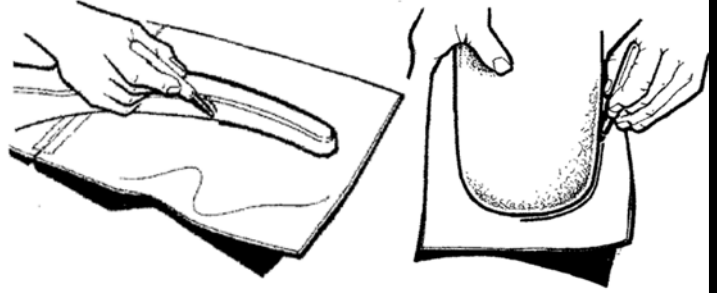

4. Remove struts and seat. Position one of the struts on a piece of heavy weight paper & trace with marker used on fender. Make sure to draw line right up to strut, no white paper should show between trace line and strut.

2

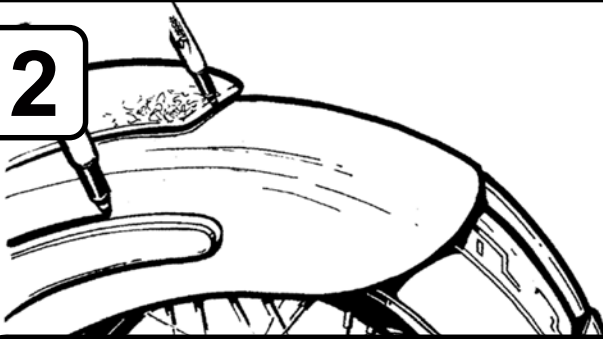

2. Position and mark fender for drilling. Reference factory "Harley Davidson Softail™ Models Service Manual" & disconnect shocks. Raise pivot swing arm & tire until it bottoms out at the rubber stops. Position fender againts tire & hose and push fender towards and against seat bottom. Balance fender on both sides, positioning front edges to line up with front edge of strut, hold in place and mark fender tracing struts with Sharpie marker. Repeat procedure around rear section of seat. Be careful not to get marker on seat covering.

5

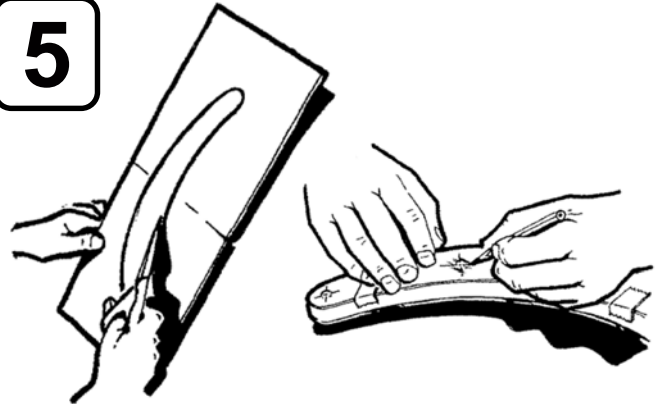

5. Cut out strut template & seat template. Cutting on the inside of the trace line, no marker line should appear on edges of the template. Template should not overlap struts.

6

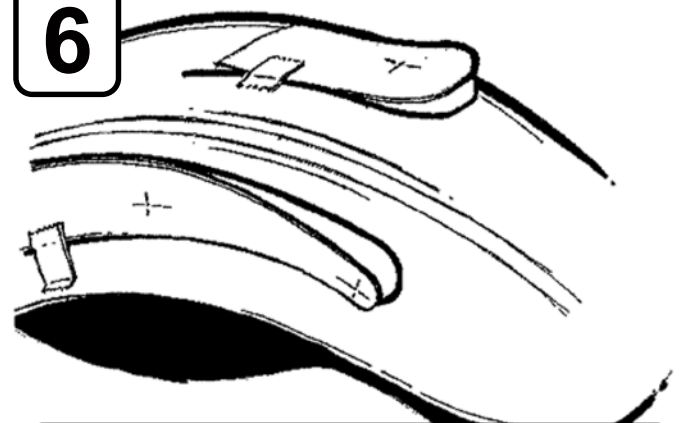

6. Position templates on fender and mark holes. Drill holes with a drill slightly larger than 3/8.

Note: Check fender clearance to belt guard, grind edge of fender if necessary.