

# YAFFA SWING ARM WALL SCONCE - HARDWIRED

Installation Guide

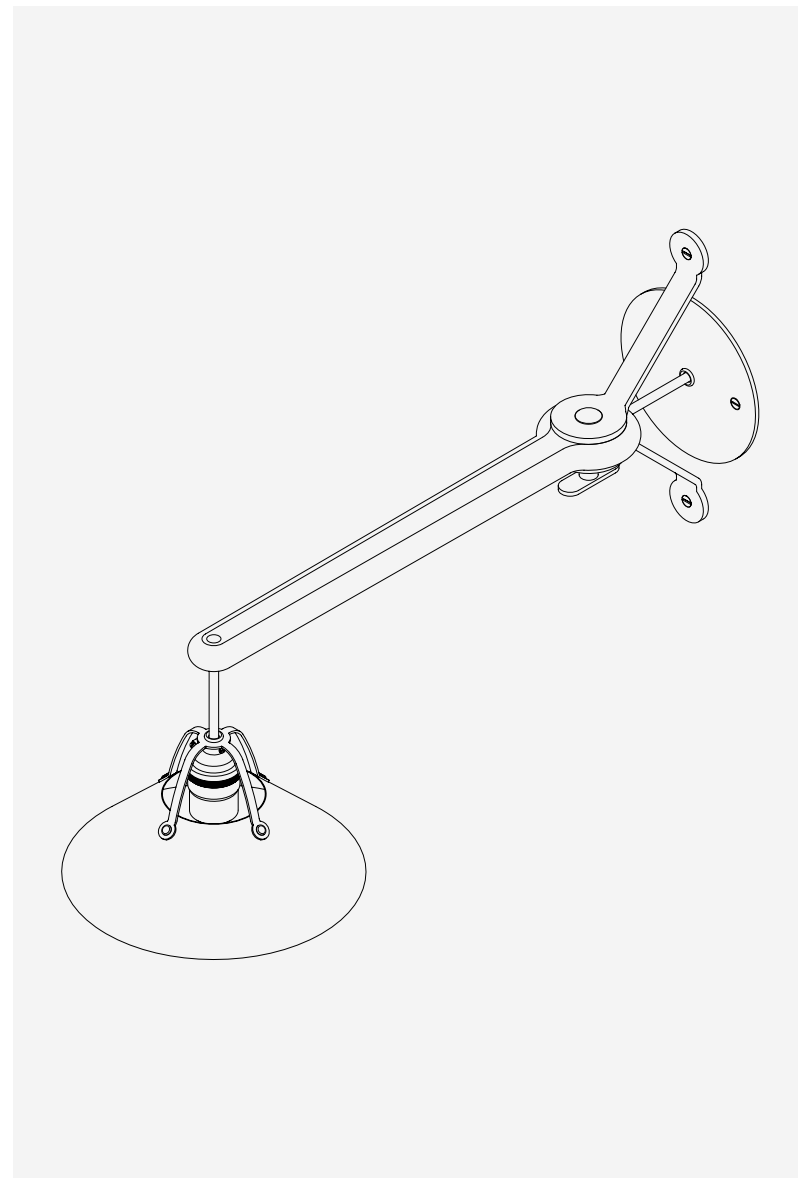



## CAUTION

This product should be installed only by a licensed electrician. Turn off all electrical power at the main fuse box before installation. Turning off the power from a light switch may not be sufficient enough to prevent from electrical shock.

For your safety and for proper operation of the luminaire, read and understand all instructions completely before installation.

## UNDERSTANDING THE FIXTURE

Please care for the brass pieces with a soft cloth, and avoid using any abrasive cleaners or products. The patination process will speed up if any brass product or component is excessively handled. Gloves are recommended for installation.

## BEFORE INSTALLATION

Carefully unpack the luminaire and inspect for damage. Please check that you received all of the components pictured in this guide. If anything is missing, please contact, [shopkeeper@lostine.com](mailto:shopkeeper@lostine.com), and one of our customer service representatives will be able to assist you.

## COMPONENTS INCLUDED

**A**

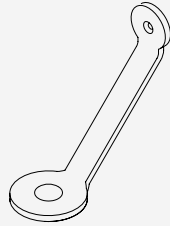

Wall Brackets  
x 2

**B**



Socket  
x 1

**C**



Cord  
x 1

**D**

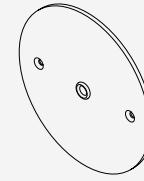

Backplate  
x 1

**E**

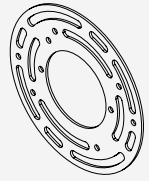

Crossbar  
x 1

**F**

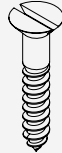

1.5" Slotted Head Screws  
x 2

**G**



Drywall Anchors  
x 2

**H**



1" Slotted Head Screws  
x 2

**I**



Pan Head Phillips Screws  
x 2

**J**



Plastic Wire Nuts  
x 3

**K**

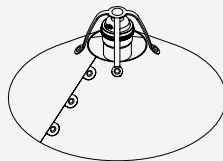

Shade  
x 1

## NOTES

1. The Socket (B) comes attached to the Shade (K).
2. Wall Brackets (A) are attached to the wooden scone arm.

**COMPONENTS NOT INCLUDED**

**L**

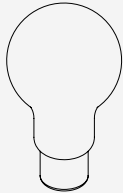

E 26 Bulb  
x 1



Phillips Head Screwdriver  
x 1

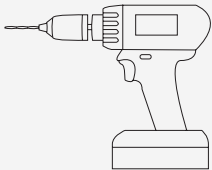

Slotted Head Drill Bit  
x 1

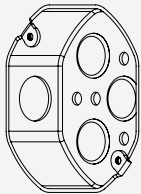

Junction Box  
x 1

WIRING

- 1. **WARNING**  
Shut off the power to the electrical box. Turning off the power from a light switch may not be sufficient to prevent electrical shock.
- 2. Attach the Crossbar (E) to the electrical box using the provided 2" Steel Screws (I), ensuring that mounting holes are level horizontally.
- 3. Align Yaffa Sconce to the wall and mark locations for Drywall Anchors (G) .
- 4. Drill two 1/4" diameter pilot holes and install Drywall Anchors (G) .
- 5. Feed the Cord (C) through the Backplate (D) and by following the electrical configuration listed below, connect the wires from the luminaire to the electrical box using the provided Plastic Wire Nuts (J).

From Electrical Box	From Luminaire
Connect Black or Red (HOT) wire from supply to:	Black Wire
Connect White (NEUTRAL) wire from supply to:	White Wire
Connect green or bare copper (GROUND) wire from supply to:	Bare copper wire from luminaire

- 6. Secure the Backplate (D) to the Crossbar (E) with the provided 1.5" Brass Screws (F).
- 7. Secure Brackets (A) to the Drywall Anchors (G) with the provided 1" Brass Screws (H) .

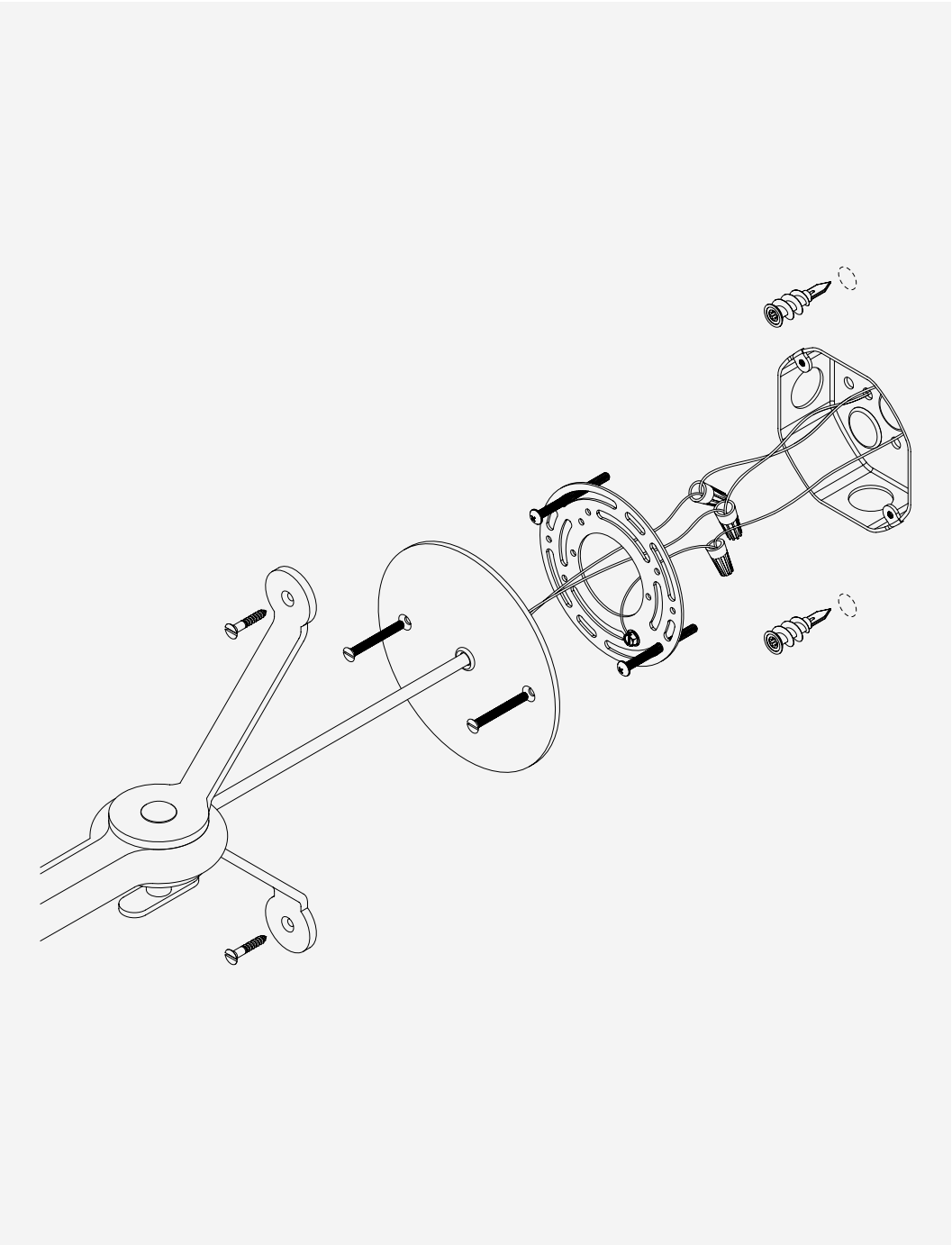

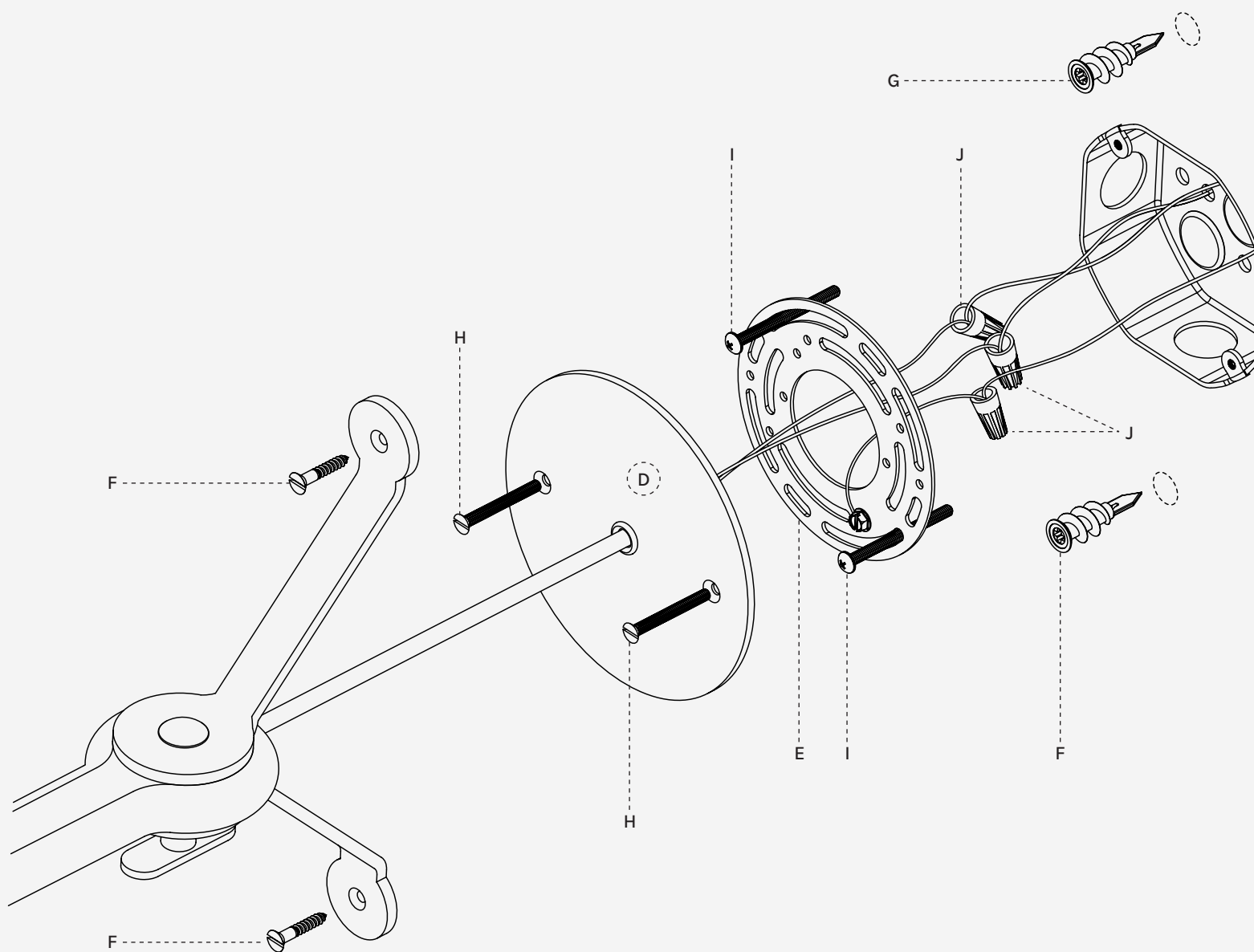

## PENDANT ASSEMBLY

1. Place bulb (L) into the Socket (B).
2. Turn the power back on to the electrical box and enjoy your luminaire.

