

R-N800A

NETWORK RECEIVER



R-N800A

Output Power

Rated Output Power	100 W + 100 W (8 ohms, 20 Hz–20 kHz, 0.07 % THD)
Maximum Power	145 W + 145 W (8 ohms, 1 kHz, 10 % THD)
Dynamic Power per Channel (8/6/4/2 ohms)	140 W / 170 W / 220 W / 290 W

Network

Wi-Fi	YES
File Format	MP3, WMA, MPEG4 AAC, WAV, FLAC, AIFF, ALAC, DSD
Bluetooth®	Version 4.2
Supported Codecs	SBC, AAC* * Receiving only.

Terminals

Inputs	Analog Audio :4 (CD, PHONO, LINE 1, LINE 2), Digital Audio :4 (Optical 1, Optical 2, Coaxial 1, Coaxial 2), USB DAC (Type B)
Outputs	Speaker :2 (4 terminals), Subwoofer :1 Pre-out Preout :1, Headphone :1
Others	Trigger out :1, YPAO mic :1

General

Standby Power Consumption	1.6 W (Wired, Network standby on) 2.0 W (WiFi, Network standby on) 0.2 W (Normal standby off)
Dimensions (W x H x D)	435 x 151 x 395 mm (without antenna) 435 x 232 x 395 mm (with antenna up)
Weight	11.4 kg

Features

AirPlay 2	YES
YPAO	YES
MusicCast	YES
Gapless Playback	YES
DAB+ Radio Tuner	YES

App	MusicCast CONTROLLER
-----	----------------------



Silver

HIGH-QUALITY SOUND FOR ALL YOUR ROOMS

The R-N800A Network Receiver delivers full-fledged, comprehensive music enjoyment with modern Hi-Fi style. It includes our original YPAO sound field correction technology to create an ideal listening environment right in your living room. From streaming services to high-resolution sound sources, you can immerse yourself in a wide range of entertainment with superb sound quality and yet a casual style.



TRUE SOUND



This is sound that only Yamaha can realize as the only audio brand in the world that handles everything from the moment a sound is created to the time it reaches the human ear. Simply close your eyes and feel the artist performing right there in front of you, and experience the profound sensation of being truly 'Closer to the Artist.'

SOUND IMAGE
Yamaha Parametric Room Acoustic Optimizer (YPAO™)

Environmental factors play an important role in the sonic signature of a room, and with any type of audio. Yamaha's own YPAO™ automatic calibration technique, refined over decades of use in Home Theater products, has been optimized for the R-N800A to deliver the ideal listening environment, as if you were in a professional audio listening room - without requiring any laborious manual setting adjustments. YPAO™ features precision EQ, which performs exceptionally high-precision equalization with accuracy of up to 192 kHz / 64-bit audio resolution. YPAO™ R.S.C. (Reflected Sound Control) works in tandem to actively control the important early reflection sounds, automatically adjusting and optimizing how the sound is heard in your room, depending on the materials of the walls and the speaker placement. The end result, a profound sound field and immersive feeling unique to Hi-Fi audio - right in your own living room.

DYNAMICS
EXPERIENCE THE LEGEND, ENJOY THE MUSICALITY

Yamaha boasts over 60 years of history as an audio brand. And the technology of R-N800A comes directly from Yamaha's legendary Hi-Fi design concept ToP-ART (Total Purity Audio Reproduction Technology), which faithfully maintains the integrity of the audio by combining a meticulously symmetrical left / right circuit layout and signal directness (straightest, shortest signal paths) with a low-vibration chassis of high rigidity, equipped with the special resin frame "Art Base" that absorbs and blocks unnecessary vibration. It maintains sonic purity and dynamism of sound.

ANTI-RESONANCE FEET

The R-N800A also employs anti-resonance feet designed under a concept of vibration absorption. By arranging thin curved reinforcing bars on the outer periphery and thick straight reinforcing bars in the center, the vibration energy transmitted from the outside of the leg is effectively dispersed and diminished, while maintaining high central rigidity. These make it possible to reproduce a focused sound that lets you fully feel the rhythm and dynamics of the music.

TONAL BALANCE
HIGH-PRECISION, HIGH-PERFORMANCE

The R-N800A uses the renowned SABRE ES9080Q 384 kHz / 32-bit DAC (from ESS Technology) to deliver superior S/N performance. Combined with Yamaha's original network module, the unit thoroughly draws out all the sonic merits of high-resolution sound sources, effectively reproducing even the subtle ambience of concert halls and delicate expressive nuances in the sound.

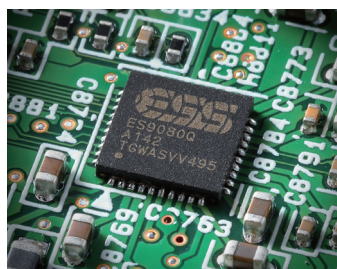
LOW IMPEDANCE CONCEPT

In order to thoroughly eliminate energy loss and degradation of the audio signal, the R-N800A features thick wires for the ground connection a critical feature that establishes the componentry as being truly premium Hi-Fi. In addition, a screw connection is adopted for the output from the power amplifier section in order to strengthen the ground, which is important for audio quality. This gives the R-N800A increased signal-to-noise performance, making it possible to reproduce sound with full clarity.

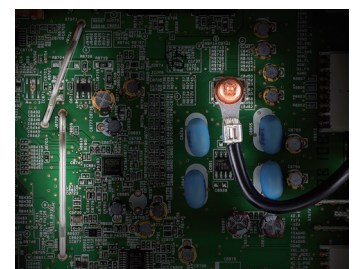

OTHER FEATURES

FULL-FLEDGED MUSICAL EXPERIENCE FROM YOUR SMARTPHONE

The R-N800A is equipped with Yamaha's original MusicCast network system. Moreover, it is compatible with a variety of streaming services such as Tidal Connect and Spotify Connect, letting you fully enjoy exceptionally high-quality sound unique to today's high-resolution and lossless sound sources, with complete fidelity. You can also use it to stream Apple Music with Airplay 2. And the MusicCast system lets you easily listen to music anywhere in your home by linking various MusicCast devices with just one app on your smart device.



* Music service availability varies by region and may change or be discontinued without notice.

HI-FI QUALITY FOR ALL YOUR MUSIC SOURCES

From audio you've stored on your PC or network drive to vinyl records and TV (Via Digital Optical)—the R-N800A handles everything, giving you superior sound and drawing out the full sonic splendor inherent in all your entertainment.

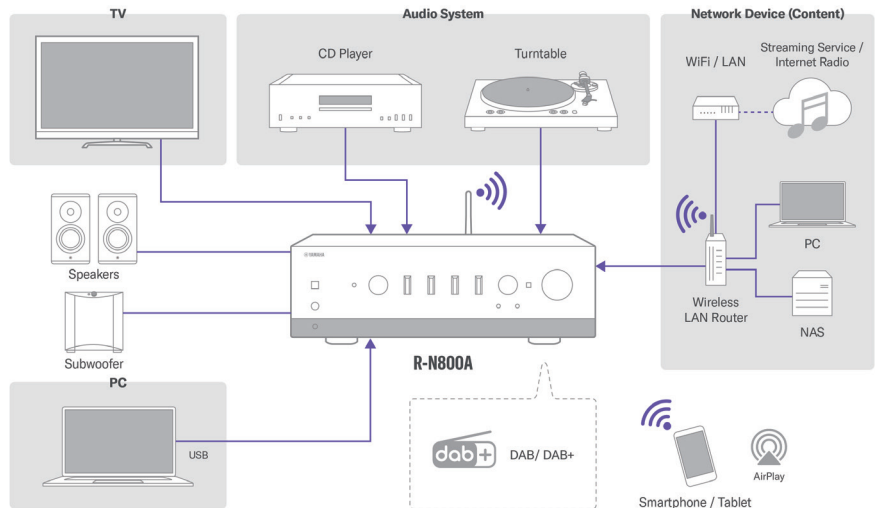

MAXIMUM SOUND PURITY



MULTI-ROOM AUDIO - MusicCast

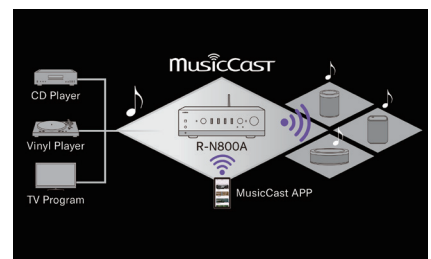

App Store is a service mark of Apple Inc., registered in the U.S. and other countries. Google Play is a trademark of Google LLC. The Wi-Fi CERTIFIED™ Logo is a registered trademark of Wi-Fi Alliance®. The Bluetooth® word mark and logos are registered trademarks owned by Bluetooth SIG, Inc. and any use of such marks by Yamaha Corporation is under license. Other trademarks and trade names are those of their respective owners. This Network Receiver is compatible with AirPlay 2. iOS 11.4 or later is required. Use of the Works with Apple badge means that an accessory has been designed to work specifically with the technology identified in the badge and has been certified by the developer to meet Apple performance standards. Apple, AirPlay, Apple TV, Apple Watch, iPad, iPad Air, iPad Pro, iPhone, Lightning, and iTunes are trademarks of Apple Inc., registered in the U.S. and other countries and regions.

Although care is taken to ensure the accuracy of the information presented, some variations may occur. Yamaha Music Australia Pty. Ltd. reserves the right to correct any errors, omissions or misprints. Errors and omissions excepted.