

Drawer Bottom Dimensions

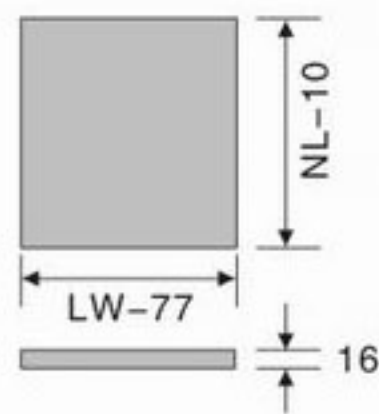

LW=Drawer Nominal Width

Drawer Back Dimensions

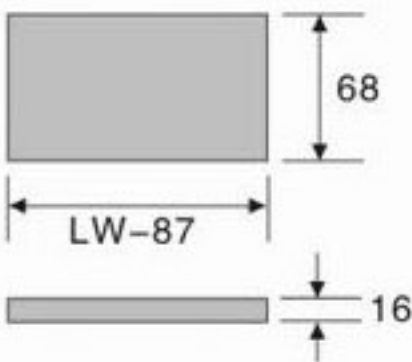

NI= Nominal Length

Runner Installation

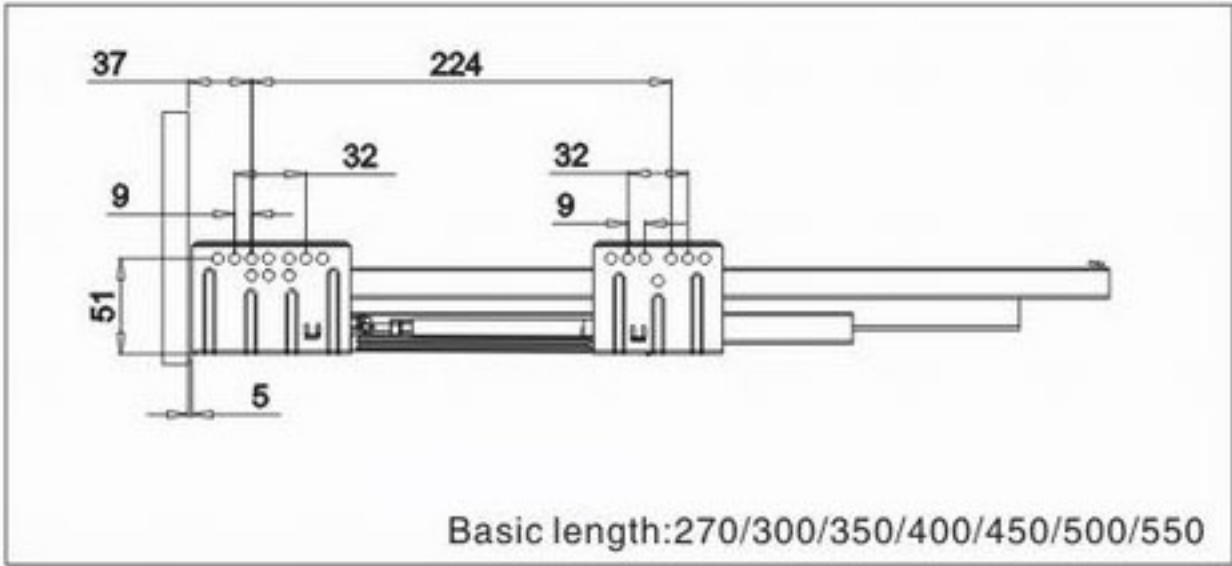

Inside Cabinet Dimension

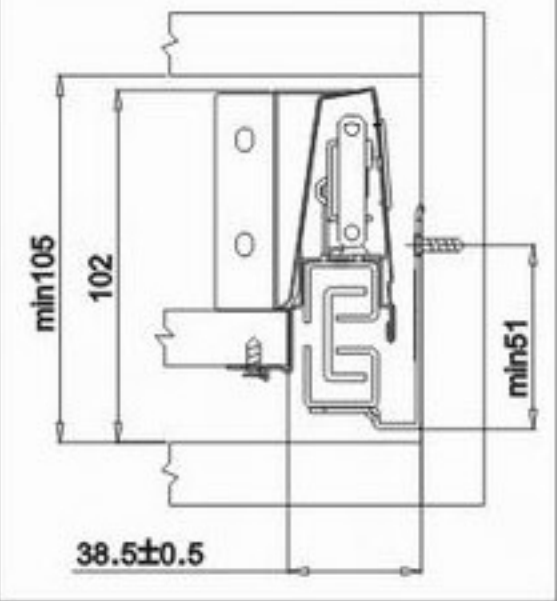

Front Panel Mounting Positions

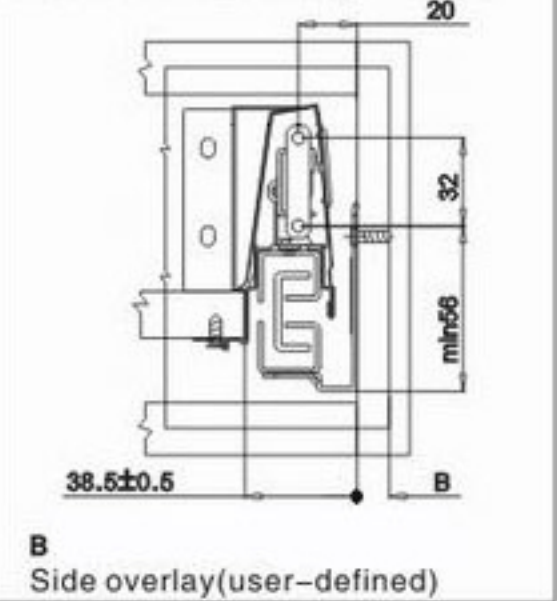

Front Fixing Brackets Positions

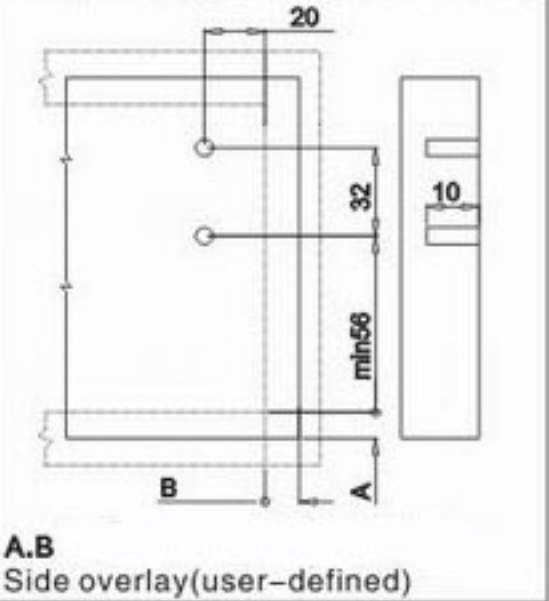

Back Panel Mounting Positions

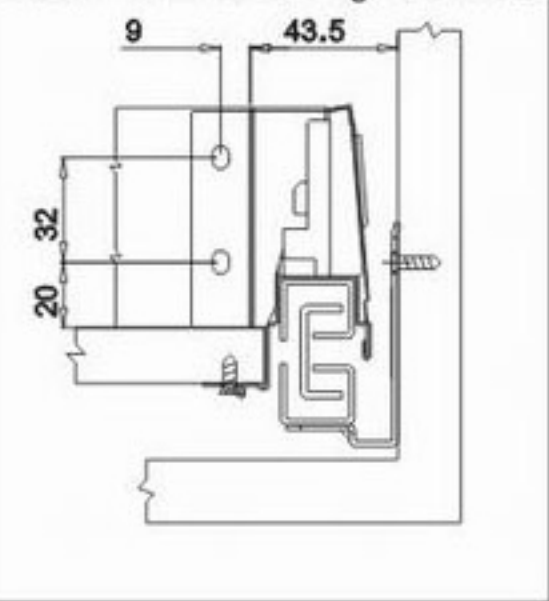

Front fixing brackets mounting

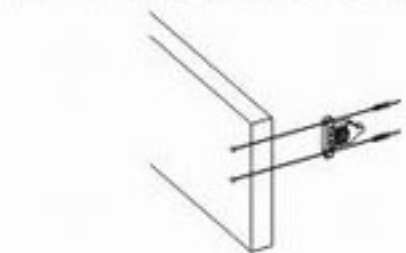

1

Installed after the panel, Remember securely tighten the screw

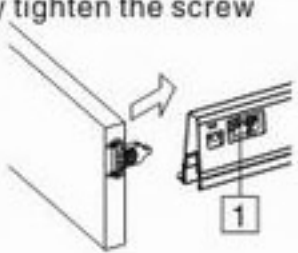

Front panel removing rackets mounting

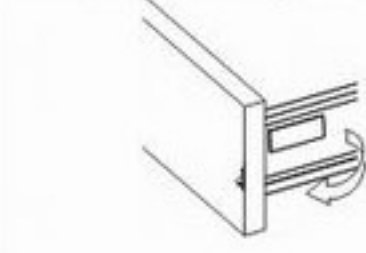

1 Reasonable first twist fixed screw



2 Rotate remove after panel

Front panel height adjustment: ±2mm

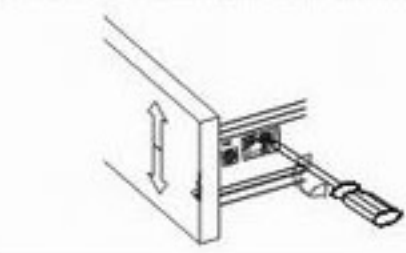

Front panel side adjustment:right 1mm

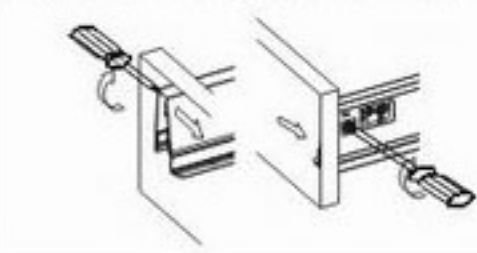

Front panel side adjustment:left 1mm

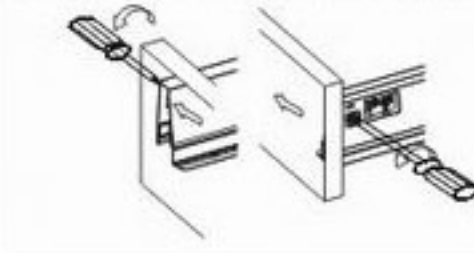

Mounting the drawer

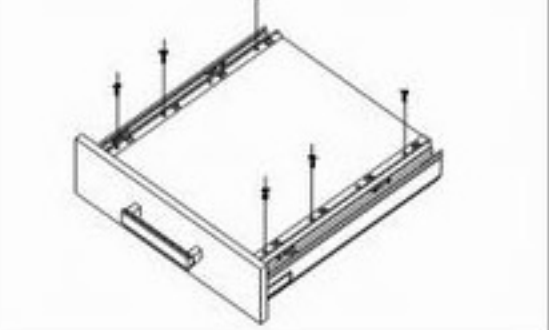
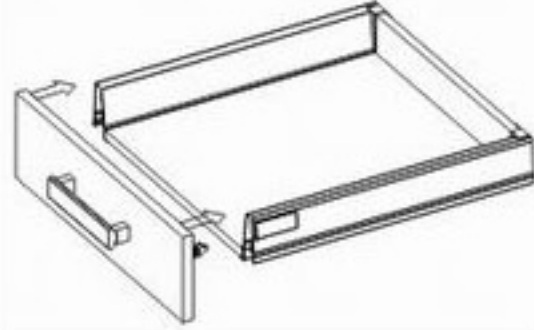
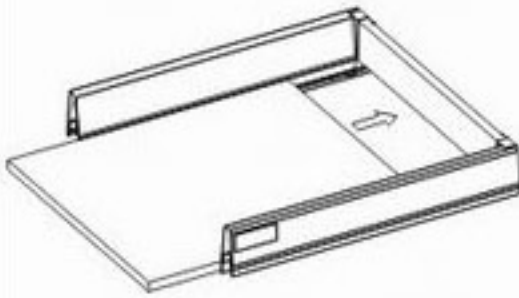
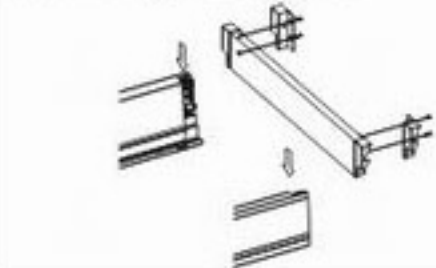

Mounting the drawer

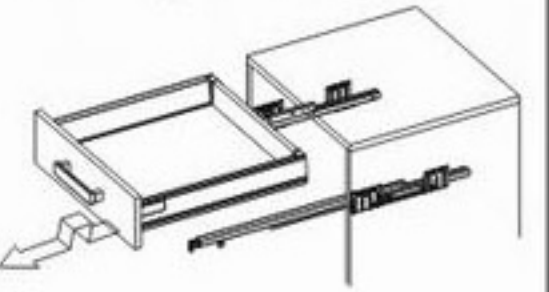
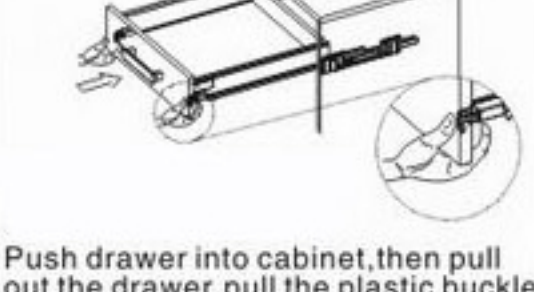

Function of the damper

