



EMF HARMONIZER MOBILITY

INSTRUCTIONS & FAQ'S

Description

- The EMF Harmonizer Mobility supports your health and well-being as you are exposed to the ubiquitous electromagnetic radiation in today's environment. While driving, shopping, or travelling, in your home, office, or school, you will meet with electromagnetic frequencies emitted by many sources – from cell phone towers to WiFi routers to smart meters. The Mobility will support your body against the negative effects of these EMF's.
- The Mobility is a stylish accessory with a band made of silicon rubber and a stainless-steel metal clasp. It is attractive enough to wear at work or out at night, but durable enough to wear when sporting or working in the garden. It is waterproof and easy to clean, and comfortable enough to sleep with if desired.
- The Mobility utilizes EMF Harmony's exclusive dual-level technology to support your health against the negative influence of electromagnetic radiation. The first level of action is a Direct Technology that harmonizes the negative energetic frequencies of the electromagnetic radiation. The second level of action is an Adaptive Technology that supports your body as it is stressed by the radiation.
- The EMF Harmony technology does not block or alter EMF activity, allowing your electronic devices to operate normally. It is designed to provide you with much needed protection against the negative health effects of 5G technology, as well as older cell phone technology, WiFi routers, smart meters, and even EMF's from conventional electric power.
- The Mobility is available in black or white, and one size fits all, as the band is easily trimmed to fit any size wrist.



Instructions *(continued on reverse)*

- Instructions for sizing the Mobility for your wrist may be found below. Be careful not to trim too much off of the band or it may be too small to fit on your wrist. It is best to err on the side of too big when you are trimming it for the first time.
- The band may be cleaned with warm water and a mild detergent cleanser.
- The Mobility is waterproof and may be worn in the shower, bath, or while swimming.
- It is preferable to wear the Mobility on your left wrist, although it will still be effective if worn on the right one. Energy enters the body on the left side and exits on the right, which is why it is better to wear it on the left wrist if possible.
- The Mobility is designed to protect you when you are moving around in the world in areas not protected by an EMF Harmonizer Home & Office. The Mobility is not designed to be a substitute for the Home & Office, which will offer you the best protection in these environments where you spend most of your time.
- The Mobility may be worn while you sleep, although it is optional if you are sleeping in an area protected by an EMF Harmonizer Home & Office.
- If you use a smartphone regularly, we highly encourage you to use an EMF Harmonizer+ on your phone as well.

Instructions *(continued)*

Sizing the Mobility for Your Wrist

- The Mobility must be trimmed to size so that it fits your wrist when you first receive it. You may have it fit snugly or loosely, depending on your preference, it will not alter the effectiveness. Of course it is better to start with a more loose fit, as you can make the band shorter by trimming off more, but you can't make it longer. Here are the steps to size it:
- Close the clasp and wrap the loose end of the band around your wrist to find the appropriate length. **(1)**
- Make a mark where the end of the band would insert into the clasp and cut the band there with scissors. **(2)**
- Open the small hinged clasp with metal "teeth" **(3)** that holds the end of the band in the main clasp, insert the band as far as it will go **(4)** (about 1/8"), and close it. (It may be necessary to pry open this small hinged clasp with a pointed knife or other small object as it can be difficult to open it with your fingers.)
- Close the main clasp again and see how the fit feels. If you feel like it is too big, simply open the small hinged clasp and trim more off of the band.

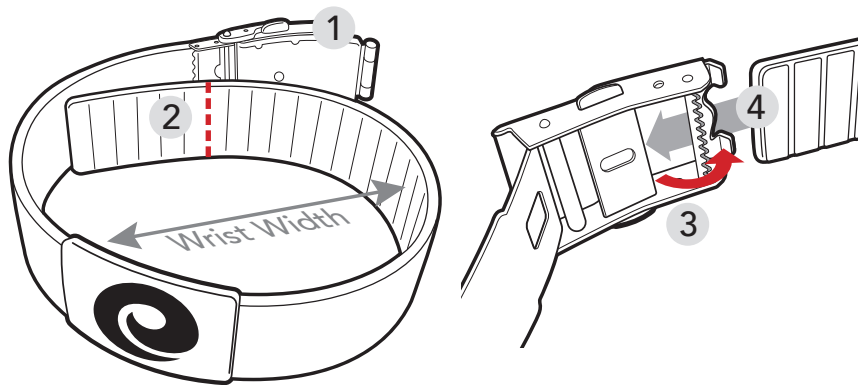

IMPORTANT: *It is better to cut off too little than too much on your first try, since you can always cut off more, but you cannot make it longer again!*

Frequently Asked Questions

- **Why do I need EMF protection?**
The negative health consequences of exposure to electromagnetic radiation have been documented in countless scientific studies. Please see the 'Why' page on our website for more details and links to many of those studies.
- **How does the Mobility work?**
All of the EMF Harmony products operate using similar technology, which is described in the 'How' page of our website.
- **How long will the Mobility last?**
The product will work effectively indefinitely, but the technology is updated regularly. Given the rapid pace of technological change today, we recommend replacing the product approximately every five years.
- **If I have a Mobility do I still need the other EMF Harmony products?**
The Mobility is not designed to replace the other products and is ideally used in combination with them. Many people start with the Mobility since it offers the broadest protection, but it is not a substitute for the stronger protection offered by the other products. For example, the Harmonizer+ is always recommended for your cell phone, and the Home & Office offers the strongest protection for your home or workplace.
- **How do I measure the effects of the Mobility?**
Since the EMF Harmony technology operates at the sub-atomic level and does not block or alter EMF's, it is not possible to measure its effects with an EMF measuring instrument. However, it is possible to measure the biological effects of the technology with various measurement devices. Please see the 'Research' page on our website for studies that demonstrate biological changes from using the technology. You may of course run your own biological tests to see the results. At the bottom of the 'How' page you will find a quick test using lemon juice that will demonstrate that the technology is doing something, which is noticeable in the taste of the juice.
- **Will I feel the effects of the Mobility?**
This depends on how sensitive you are to the effects of electromagnetic radiation. People who suffer from Electromagnetic Hypersensitivity will generally feel a difference, but that is more the exception than the rule. Many people will not notice a difference, mainly because most people are not ultra-sensitive to EMF's. However, that does not mean that EMF radiation does not damage their health, or that the product is not helping them.

It may be compared to taking a nutritional supplement. For example, when you take vitamins or fish oil, you do not "feel" different once you start taking them, but they nonetheless have measurable benefits to your health when taken regularly. Likewise, although you may not "feel" the effects, the EMF Harmony technology supports your body's health, which has been documented in biological testing (see the 'Research' page on our website). Whether you are sensitive to the effects of electromagnetic radiation or not, they do damage your health with long term exposure (see the 'Why' page on our website).

- **Do you offer a return policy?**
We do offer a 30 day money back return policy for new, unused products in original condition. Once you use or alter the product it may not be returned. Please contact us for return instructions.

*It is important to know that the product is not designed to treat or cure any disease or health problem.
If you are ill, you should seek medical advice from a doctor or other health care professional.*

Specifications

Contents: 1 EMF Harmonizer Mobility Wrist Bracelet

Material: Silicon Rubber Band with Stainless Steel Clasp

Dimensions: Approx. 10.5 (before sizing) x .75 x .0625 inch