



EMF HARMONIZER HOME & OFFICE

INSTRUCTIONS & FAQ'S



Description

- The EMF Harmonizer Home & Office supports your health and well-being as you are exposed to the ubiquitous electromagnetic radiation in today's home and workplace environments. It works for EMF's emanating from within your home or workplace as well as those emanating from outside of it (including from geopathic stress). In addition, it creates a healthier environment by generating a natural balance of positive and negative ions, helping to remove unhealthy fine particulate matter from the air.

The Home & Office product family consists of two products:

- 1 Home & Office Kit** – Designed to provide protection for a space up to 1,500 square feet, the Kit consists of one large metal sticker (3 inch x 2.5 inch) and four smaller ones (2.25 inch x .5 inch). The large sticker is placed on the inside of your fuse box door, and the small stickers are placed on different outlets within the space to be covered. To cover more than 1,500 square feet you will need an additional small sticker, the Home & Office Single, for each additional 375 square feet to be covered.
 - 2 Home & Office Single** – The Single is one small metal sticker (2.25 inch x .5 inch) that is used to supplement the Home & Office Kit by adding an additional 375 square feet of coverage. In addition, if you don't have access to the fuse box (for example in a workplace) you may still use multiple Singles to create a protected area. In this case you will purchase four Singles to cover a space up to 1,000 square feet, and then additional Singles for each additional 375 square feet to be covered.
- The Home & Office creates a protected area within which the energy of the electromagnetic radiation is harmonized to help support your body against its negative health consequences. If you have access to the fuse box, you should purchase the Home & Office Kit and additional Singles as needed for appropriate coverage (this is the preferred approach). If you do not have access to the fuse box, then you would purchase only Singles to cover the appropriate area. Please see the FAQ's and Instructions link below for details on configuring your installation according to your circumstances.
 - The Home & Office utilizes EMF Harmony's exclusive dual-level technology to support your health against the negative influence of electromagnetic radiation. The first level of action is a Direct Technology that harmonizes the negative energetic frequencies of the electromagnetic radiation. The second level of action is an Adaptive Technology that supports your body as it is stressed by the radiation.
 - The EMF Harmony technology does not block or alter EMF activity, allowing the wireless devices in your home or office to operate normally. It is designed to provide you with much needed protection against the negative health effects of the EMF radiation from 5G technology, as well as older cell phone technology, WiFi routers, smart meters, wireless appliances, and even EMF's from conventional electric power. It works on EMF's coming from outside the protected space as well, such as your neighbors' WiFi routers or nearby power lines.

Configuring Your EMF Harmonizer Home & Office Installation

1) If you have access to the fuse box (preferred):

- You should size your installation according to the entire space covered by the fuse box, even if it is not often occupied (for example the garage or an unfinished basement).
- You will need the Home & Office Kit, which will cover a space up to 1,500 square feet.
- For each additional 375 square feet over 1,500 covered by the fuse box, you will purchase an additional Home & Office Single.
- If your fuse box covers a space of 1,500 square feet or less, then you will not need any additional Home & Office Single stickers.
- For example, in a space of 2,500 square feet you would need the Kit and three Singles, for 3,000 square feet you would need the Kit and four Singles, etc. – each additional Single adds 375 square feet to the 1,500 covered by the Kit.

2) If you do not have access to the fuse box:

- You should purchase four Home & Office Singles, which will cover a space up to 1,000 square feet.
- For each additional 375 square feet over 1,000 you wish to cover, you will purchase an additional Single.
- For example, in a space of 1,500 square feet you would need six Singles, for 2,500 square feet you would need eight Singles, etc. – each additional Single adds 375 square feet to the 1,000 covered by the minimum four Singles.

1) If you have access to the fuse box:

- The large sticker in the Home & Office Kit should be placed on the inside of your fuse box door. When the door is closed the sticker will be facing the fuses (a.k.a. circuit breakers).
- The four smaller stickers in the Home & Office Kit should be placed on outlets on the four outside walls of the space. For multi-story spaces, place the stickers opposite each other, one on the top floor and one on the bottom floor. It is not important where on the outlet they are placed.
- If additional smaller Single stickers are needed for a space larger than 1,500 square feet, space them as evenly as possible on outlets on the interior walls of the space.
- The stickers do not need to be exactly opposite and evenly distributed to work effectively. Just do the best you can with the outlets you have available. You may also place them on light switches instead of outlets and they will work just as well.

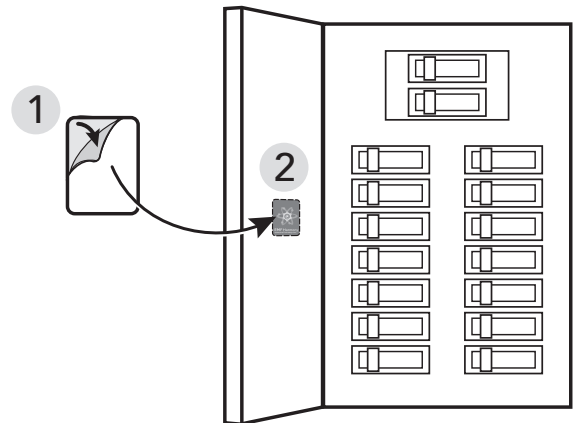

2) If you do not have access to the fuse box:

- Place four Single stickers on outlets on the four outside walls of the space. For multi-story spaces, place the stickers opposite each other, one on the top floor and one on the bottom floor. It is not important where on the outlet they are placed.
- If additional smaller Single stickers are needed for a space larger than 1,000 square feet, space them as evenly as possible on outlets on the interior walls of the space.
- The stickers do not need to be exactly opposite and evenly distributed to work effectively. Just do the best you can with the outlets you have available. You may also place them on light switches instead of outlets

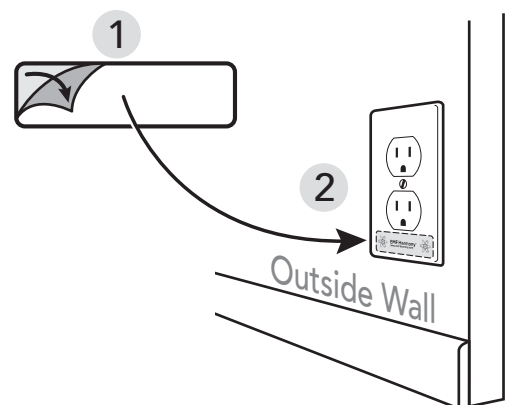

and they will work just as well.

Frequently Asked Questions

- **If I have access to the fuse box, must I purchase the Kit?**

The Home & Office Kit is the preferred configuration if you do have access to the fuse box. The large sticker which is placed on the fuse box door will offer somewhat better protection than a configuration without it. Of course the configuration without it will also provide protection, it is just not quite as robust without the sticker at the point of distribution in the fuse box.

- **Do I need the EMF Harmonizer products for the wireless devices within the protected space?**

You do not need the EMF Harmonizer for the devices within the home or workplace once it is protected by the Home & Office. The only exceptions would be 1) An EMF Harmonizer+ for your cell phone if you talk on it frequently 2) An EMF Harmonizer for your laptop, tablet, or Bluetooth device if you frequently use it outside the protected area 3) An EMF Harmonizer+ for your WiFi router, since it is generally the most powerful EMF emitting device in the home.

- **What if my outlets are spaced unevenly, or there are no outlets on one of the four outside walls?**

It is not critical that the stickers are spaced evenly for the Home & Office system to be effective. You may also place them on light switches instead of outlets, and they will be just as effective.

- **What if I work in a cubicle?**

In such a case where you do not have walls or outlets, you may purchase one Single to be placed on your power strip if you have one, and the EMF Harmonizer for your computer and any other wireless devices in the space that communicate via WiFi.

- **How does the Home & Office improve the air quality within the protected space?**

The Home & Office helps to restore the natural balance of negative and positive ions within the space. Most indoor spaces, especially those polluted by electromagnetic radiation, have an unnaturally low presence of negative ions. When the natural balance is restored, fine and ultra-fine particles in the air clump together and fall to the floor. This is good for your health, since breathing the particulate matter is unhealthy. A higher concentration of negative ions generally improves the "feel" or "energy" of the space as well, which is one reason why we feel happier and more energized when outdoors in nature.

- **Why do I need EMF protection?**

The negative health consequences of exposure to electromagnetic radiation have been documented in countless scientific studies. Please see the 'Why' page on our website for more details and links to many of those studies.

- **How does the Home & Office technology work?**

All of the EMF Harmony products operate using similar technology, which is described on the 'How' page of our website.

- **How long will the Home & Office last?**

The product will work effectively indefinitely, but the technology is updated regularly. Given the rapid pace of technological change today, we recommend replacing the product approximately every ten years.

- **How do I measure the effects of the Home & Office?**

Since the EMF Harmony technology operates at the sub-atomic level and does not block or alter EMF's, it is not possible to measure its effects with an EMF measuring instrument. However, it is possible to measure the biological effects of the technology with various measurement devices. Please see the 'Research' page on our website for studies that demonstrate biological changes from using the technology. You may of course run your own biological tests to see the results. At the bottom of the 'How' page you will find a quick test using lemon juice that will demonstrate that the technology is doing something, which is noticeable in the taste of the juice.

- **Will I feel the effects of the Home & Office?**

This depends on how sensitive you are to the effects of electromagnetic radiation. People who suffer from Electromagnetic Hypersensitivity will generally feel a difference, but that is more the exception than the rule. Many people will not notice a difference, mainly because most people are not ultra-sensitive to EMF's. However, that does not mean that EMF radiation does not damage their health, or that the product is not helping them.

It may be compared to taking a nutritional supplement. For example, when you take vitamins or fish oil, you do not "feel" different once you start taking them, but they nonetheless have measurable benefits to your health when taken regularly. Likewise, although you may not "feel" the effects, the EMF Harmony technology supports your body's health, which has been documented in biological testing (see the 'Research' page on our website). Whether you are sensitive to the effects of electromagnetic radiation or not, they do damage your health with long term exposure (see the 'Why' page on our website).

- **Do you offer a return policy?**

We do offer a 30 day money back return policy for new, unused products in original condition. Once you use or alter the product it may not be returned. Please contact us for return instructions.

*It is important to know that the product is not designed to treat or cure any disease or health problem.
If you are ill, you should seek medical advice from a doctor or other health care professional.*

Specifications

EMF Harmonizer Home & Office Kit

Contents: 1 Large & 4 Small Stickers

Material: Metalized Plastic Plate with Adhesive Backing

Dimensions: Large approx. 3 x 2.5 x .075 inch; Small approx. 2.25 x .5 x .075 inch

EMF Harmonizer Home & Office Single

Contents: 1 Sticker

Material: Metalized Plastic Plate with Adhesive Backing

Dimensions: Approx. 2.25 x .5 x .075 inch