

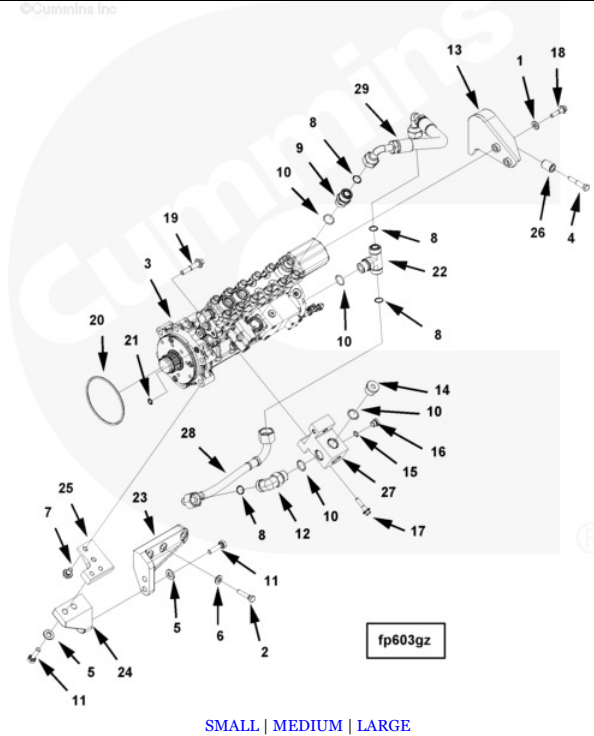

Parts Catalog - Option Detail

Electronic Parts Catalog - Option Detail				
Option	Group	Graphic	Film Card	Date
FP6908-01	05.01	fp603gz	K50	18-APR-11
Engines	G50, K50, K50-DPM, QSK50 CM2150 K107, QSK50 CM2150 MCRS, QSK50 CM2350 K108, QSK50 CM850 MCRS, QSK50 DF CM850/CM2150 MCRS			



SMALL | MEDIUM | LARGE

Cart	Ref No	Part Number	Part Description	Required	Remarks
View My Cart					
		FP6908-01	Fuel Pump		Fuel Pump...(More)
					Engine Family: Qsk50 fuel
					control system: Cummins mcrcs
					fuel pump manufacturer:
					Robert Bosch
					Fuel Inlet Fitting Thread
					Size: M27 x 2-6 h stor
					Fuel Inlet Fitting Location:
					From engine centerline (mm):
					446.87 (17.60in.) from
					crankc/l (mm): -168.85 (-
					6.65in.) from front face of
					block (mm): -301.74 (-
					11.90in.)
					CPL: 3379, 3391, 3548, 3669
					flexible hoses marine
					certification agency
					approved: No

					Additional Information:
					For use with c3/CM2150 e
					ratings only.
<input type="checkbox"/>	1	108330	Plain Washer	2	3/8 in.
<input type="checkbox"/>	2	204736	Hexagon Head Cap Screw	3	7/16 - 14 X 1 3/4 Inch.
<input type="checkbox"/>	3	2888798	Fuel Injection Pump	1	
<input type="checkbox"/>	4	3035697	Hexagon Head Cap Screw	2	7/16 - 14 X 2 1/4 Inch.
<input type="checkbox"/>	5	3036900	Plain Washer	4	1/2 in.
<input type="checkbox"/>	6	3042330	Plain Washer	3	3/8 in.
<input type="checkbox"/>	7	3093937	Hexagon Flange Head Cap Screw	2	M12 x 1.75 x 20
<input type="checkbox"/>		3171722	Male Union	1	
<input type="checkbox"/>	8	3085709	O-Ring Seal	1	
	9	3171723	Male Union	1	
<input type="checkbox"/>	10	3678606	O-Ring Seal	1	M27 X 2.00
<input type="checkbox"/>	11	3202222	Hexagon Head Cap Screw	4	1/2 - 13 X 1 3/4 in.
<input type="checkbox"/>		3331818	Male Union Elbow	1	
<input type="checkbox"/>	8	3085709	O-Ring Seal	1	
	12	3331819	Male Union Elbow	1	
<input type="checkbox"/>	10	3678606	O-Ring Seal	1	M27 X 2.00
<input type="checkbox"/>	13	3641171	Fuel Pump Brace	1	
<input type="checkbox"/>		3678611	Threaded Plug	1	
		3678605	Threaded Plug	1	
<input type="checkbox"/>	10	3678606	O-Ring Seal	1	M27 X 2.00
<input type="checkbox"/>		3678921	Threaded Plug	1	M14 X 1.5 X 16
<input type="checkbox"/>	15	3678912	O-Ring Seal	1	M14
	16	3678922	Threaded Plug	1	M14 X 1.5 X 16
<input type="checkbox"/>	17	3903464	Hexagon Flange Head Cap Screw	2	M10 X 1.50 X 40.
<input type="checkbox"/>	18	3925437	Hexagon Flange Head Cap Screw	2	M10 X 1.50 X 40.
<input type="checkbox"/>	19	3937692	Hexagon Flange Head Cap Screw	6	M12 x 1.75 x 60
<input type="checkbox"/>	20	4916449	O-Ring Seal	1	
<input type="checkbox"/>	21	4916450	O-Ring Seal	1	
<input type="checkbox"/>		4924683	Male Union Tee	1	
<input type="checkbox"/>	8	3085709	O-Ring Seal	2	
<input type="checkbox"/>	10	3678606	O-Ring Seal	1	M27 X 2.00
	22	4924682	Male Union Tee	1	
<input type="checkbox"/>	23	4924691	Fuel Pump Brace	1	
<input type="checkbox"/>	24	4924692	Fuel Pump Brace	1	
<input type="checkbox"/>	25	4924693	Fuel Pump Brace	1	
<input type="checkbox"/>	26	4951877	Mounting Spacer	2	
<input type="checkbox"/>	27	4964144	Fuel Manifold	1	
<input type="checkbox"/>	28	4964155	Flexible Hose	1	
<input type="checkbox"/>	29	4964200	Flexible Hose	1	
<input type="checkbox"/>		2867265	Kit , Gerotor	1	
<input type="checkbox"/>		2882025	Electronic Fuel Control Kit	1	
<input type="checkbox"/>		4924613	Pressure Relief Valve	1	
<input type="checkbox"/>		4924709	O-Ring Seal	1	
<input type="checkbox"/>		4924711	O-Ring Seal	1	

<input type="checkbox"/>		4924712	O-Ring Seal	1	
<input type="checkbox"/>		4927980	Threaded Plug	3	
<input type="checkbox"/>		4927981	Copper Washer	1	
<input type="checkbox"/>		4927982	Threaded Plug	1	
<input type="checkbox"/>		4927983	Expansion Plug	5	
<input type="checkbox"/>		4927984	O-Ring Seal	1	
<input type="checkbox"/>		4927985	O-Ring Seal	1	
<input type="checkbox"/>		4927986	Socket Head Cap Screw	4	
<input type="checkbox"/>		4928035	Adapter Plug	1	
<input type="checkbox"/>		4928107	Sensor Seal	1	
<input type="checkbox"/>		4964102	Pressure Sensor	1	Fuel Pump/Accumulator.