

Kirby Morgan 47 Helmet 500-070 / 500-071



Location #	Part #	Description
1	520-054	Visor
2	510-754	Head Cushion Assembly
	510-722	Head Cushion Bag
3	510-837	Head Cushion Foam Spacer Assembly (Order P/N 525-745)
	510-836	Head Cushion Foam Spacer Bag
	510-639	Chin Cushion Bag
4	520-020	Valve Body
5	510-550	Valve, Oral Nasal
6	510-575	Nose Block Pad
	545-015	Nose Block Device Includes location #6
8	510-743	Oral Nasal Mask
9	550-372	Nut, Regulator Mount
10	510-741	Valve, Water Dump
11	320-040	Regulator Mount Washer
12	505-024	Side Block Assembly (B)
	505-025	Side Block Assembly (B), Brass
13	520-033	O-ring, Teflon®
14	555-167	47/77 Bent Tube
15	510-012	O-ring
16	555-168	Bent Tube Assembly w/O-rings
17	560-125	Weight, Top
	560-116	Weight, Top, Brass
18	530-070	Screw
19	530-032	Screw
20	530-070	Screw
21	530-540	Washer
22	505-162	Helmet Shell, 47 with Ring
23	530-078	Screw
24	530-540	Washer
25	530-527	Washer
26	530-078	Screw
27	560-133	Handle, 47
	560-136	Handle, Brass, 47
28	560-173	Plaque, 47
	560-186	Handle with Plaque, 47
29	560-187	Handle with Plaque, Brass 47
30	530-045	Screw
31	510-762	Air Train Gasket

Location #	Part #	Description
32	530-050	Screw
33	530-535	Washer
34	530-415	Washer, Lock
35	530-317	Nut
36	545-016	Air Train
37	530-535	Washer
38	530-317	Nut
39	560-032	Weight, Port Side
	560-033	Weight, Port Side, Brass
40	530-062	Screw
41	530-052	Screw
42	530-035	Screw
43	550-062	Knob, Nose Block
	550-252	Knob, Nose Block, Brass
44	555-180	Packing Nut
	555-190	Packing Nut, Brass
45	510-008	O-ring
46	550-116	Nose Block Guide
	550-249	Nose Block Guide, Brass
47	560-070	Port Retainer, w/#46
	560-071	Port Retainer, Brass, w/#46 Brass
48	510-010	O-ring
49	520-004	Face Port
50	510-260	O-ring, View Port
51	530-015	Screw
52	505-110	Sealed Pull Pin
53	550-061	Spacer
54	540-015	Kidney Plate
55	530-045	Screw
56	505-278	REX® Regulator Assembly Purchase 525-774 Kit
57	530-032	Screw
58	530-059	Screw
59	540-039	Front Stand Off
60	510-683	Chin Cushion Assembly
61	505-111	Chin Strap Assembly Purchase 525-716 Kit
62	530-546	Washer for Swing Catch
63	530-035	Screw

Location #	Part #	Description
64	550-061	Spacer
65	540-086	Swing Catch
66	520-167	Teflon® Washer for Swing Catch
67	535-825	Spring, Swing Catch
68	530-045	Screw
69	550-122	Spring Spacer
70	505-119	Neck Ring Assembly (neoprene) Med.
71	530-545	Washer
72	530-028	Lock Nut
73	560-111	Locking Collar
74	550-113	Adjustment Nut, Neck Pad
75	520-098	Neck Pad
76	530-064	Screw
77	550-045	T-Washer
78	530-027	Hinge Bolt
79	520-165	Washer
80	320-026	Comm. Mount Nut
81	515-029	Microphone Assembly
82	515-019	Earphone, Left, 15.5"
83	515-018	Earphone, Right, 9"
84	515-024	Comm. Assembly w/MWP
85	515-023	Comm. Assembly w/Posts
86	540-054	Earphone Retainer
87	530-519	Washer
88	530-018	Screw
89	530-702	Snap
90	530-527	Washer
91	530-031	Screw

⚠ CAUTION

Use only Kirby Morgan original replacement parts. The use of other manufacturers' parts will interfere with the performance characteristics of your life support equipment and may jeopardize your safety. Additionally, any substitutions will void any warranties offered by KMDSI. When ordering spares, always insist on Kirby Morgan original parts.



Kirby Morgan Dive Systems, Inc.® 1430 Jason Way, Santa Maria, CA 93455
 Phone: 805/928-7772 Fax: 805/928-0342
www.KirbyMorgan.com e-mail: kmdsi@KirbyMorgan.com

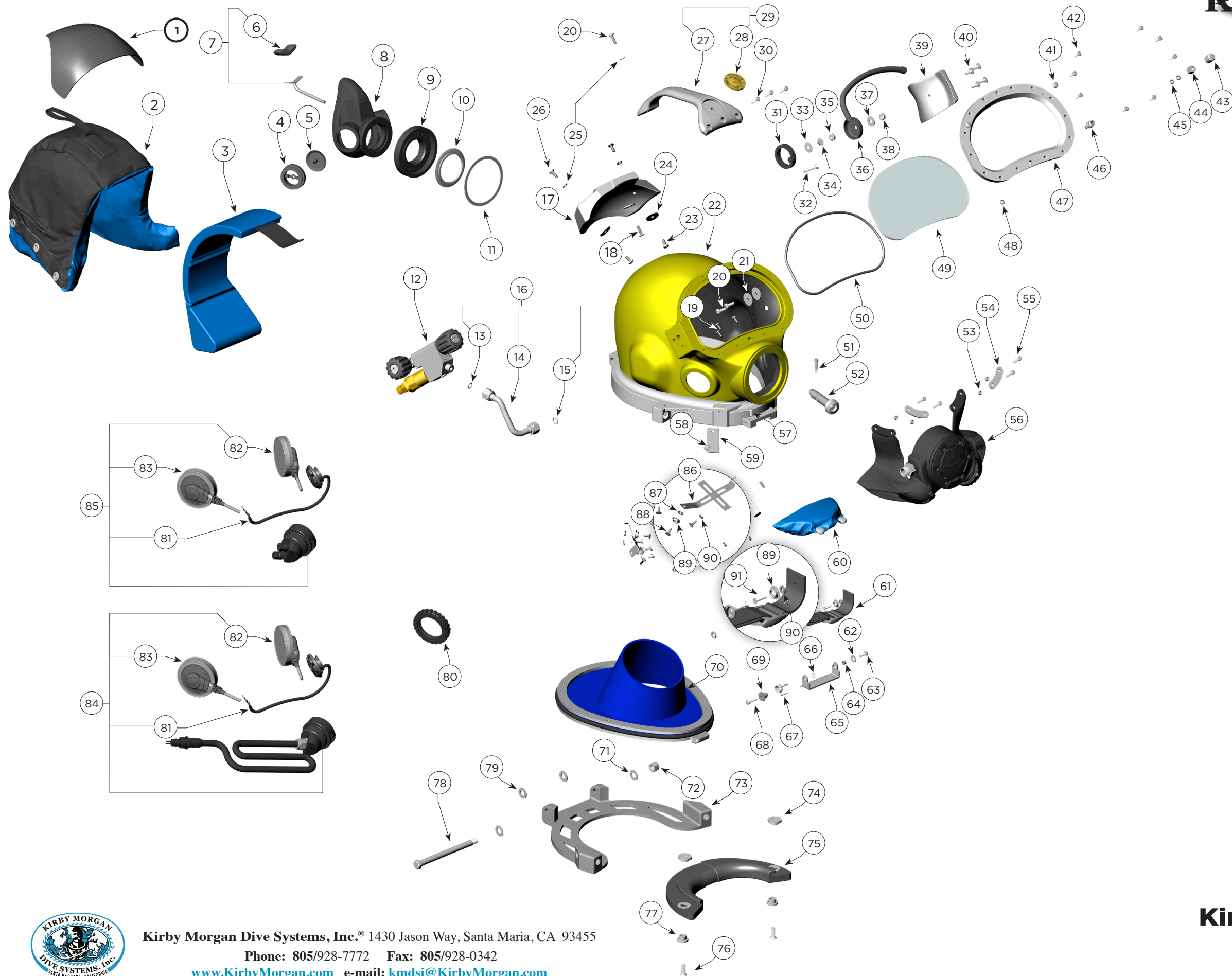

Kirby Morgan 47 Helmet



Kirby Morgan Dive Systems, Inc.[®] 1430 Jason Way, Santa Maria, CA 93455
 Phone: 805/928-7772 Fax: 805/928-0342
www.KirbyMorgan.com e-mail: kmdsi@KirbyMorgan.com