



401 South Grand Ave., Santa Ana, CA 92705
Tel: 714.550.6070 Fax: 714.550.9661 www.twobros.com

Honda CBR1000RR

V.A.L.E.™ Slip-on Exhaust System with M-2 Canister
Part # 005-31904



Parts List

Qty.	Description	Part Number
1	M-2 Muffler Canister	Varies
1	Slip-On Tube Assembly	005-31904S
1	HARDWARE KIT	005-319-3
1	Custom Mounting Bracket	005-206B
1	Lower side cover	005-319SC
1	X-Ring Kit	005-7-2-3KIT
1	Muffler Clamp	005-2C
1	Barrel Clamp	005-27-63MSH
2	Button Head Cap Screws 6x10mm	005-BH608
1	8x20mm Socket Head Cap Screw	005-SHF820
1	8mm Aluminum Washer	005-WA8
1	8mm Flange Nut	005-FN8
1	O2 Sensor Kit	005-92-22KIT
1	TBR Sticker Kit	015-10212

Installation Instructions

1. Make sure the bike is completely cool before starting the installation. Make sure the bike is secure on a centerstand or ideally a service lift.
2. Locate servo-motor cover under right side tail section in wheel well. Remove push-pins to access.



3. Mark the location of servo. Disconnect Servo Butterfly valve cable and re-route cable as shown (It will be removed later with exhaust). Return servo to its original location or engine light may be tripped.



4. Remove the lower fairing bolt from left side of motorcycle to access o2 sensor and remove sensor.



5. Remove OEM muffler assembly.



6. Install the muffler bracket using the supplied bracket and OEM nut and bolt.

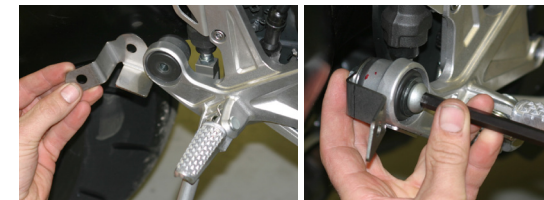

7. Loosely attach the V.A.L.E.™ muffler to the stainless steel V.A.L.E.™ connector tube using the supplied 6x20mm socket head cap screws and 6mm split washers.

8. Slide rubber-lined muffler clamp over TBR exhaust canister, loosely slide the barrel clamp over the slip-tube. Install the muffler assembly to the bike by attaching the muffler clamp to the custom bracket using the supplied counter-sunk washer, bolt and nut.



9. Once the muffler is aligned tighten the 4 6x20mm V.A.L.E.™ screws with the supplied ball end hex key. Tighten the barrel clamp. Attach o2 sensor. Re-install OEM lower fairing bolt to left side.

10. Install TBR lower side cover to slip-tube tabs and rear right side fairing mount using supplied bolts.



11. Make sure everything is aligned and tighten all hardware.

12. Before you run the bike, clean off all fingerprints and dirt, as any oily residue will etch the metal and become somewhat permanent when the system gets hot. Run the bike and enjoy. Check for gaps or leaks. After 50 to 100 miles, recheck all fasteners for tightness.

Honda CBR1000RR

V.A.L.E.™ Slip-on Exhaust System with M-2 Canister

Part # 005-31904



Qty.	Description	Part Number
1	M-2 Muffler Canister	Varies
1	Slip-On Tube Assembly	005-31904S
1	HARDWARE KIT	005-319-3
1	Custom Mounting Bracket	005-206B
1	Lower side cover	005-319SC
1	X-Ring Kit	005-7-2-3KIT
1	Muffler Clamp	005-2C
1	Barrel Clamp	005-27-63MSH
2	Button Head Cap Screws 6x10mm	005-BH608
1	8x20mm Socket Head Cap Screw	005-SHF820
1	8mm Aluminum Washer	005-WA8
1	8mm Flange Nut	005-FN8
1	O2 Sensor Kit	005-92-22KIT
1	TBR Sticker Kit	015-10212

IMPORTANT - PLEASE READ CAREFULLY

Two Brothers Racing products are intended for closed course competition purposes only

We recommend that this performance part be installed by a qualified motorcycle technician. If you have any doubts as to your ability to install this performance part, please consult with your local motorcycle dealer. Read all instructions first before starting installation. Make sure the motorcycle and exhaust system are completely cool before starting the installation. Also, make sure the bike is secure on a centerstand or ideally a service lift during installation. Be sure to save all stock components for possible use later.



Care & Cleaning

Care & Cleaning

Keep system free of dirt and moisture. Store in a cool, dry place. Make sure vehicle is completely cool before maintenance.

Stainless Header System: Polished stainless steel pipes will turn a light golden hue after a few heat cycles, this is a normal characteristic of high quality stainless steel. Clean using a mild water based spray cleaner. Always apply cleaner or polish with a soft, clean cloth.

Titanium Header System: Polished titanium pipes will experience color shift ranging from deep blue/purple through amber after a few heat cycles. This is a normal characteristic of high quality titanium. Clean using a mild water based spray cleaner. Always apply cleaner or polish with a soft, clean cloth.

Polished Aluminum Canisters: Use an aluminum or mag wheel polish to restore the bright finish to factory spec.

Brushed Aluminum Canisters: Clean using a mild water based spray cleaner. Always apply cleaner or polish with a soft, clean cloth.

Carbon Fiber Canisters: Clean using a mild water based spray cleaner. Always apply cleaner or polish with a soft, clean cloth. Always make sure the fiberglass packing inside is in good condition and not burned out, as exhaust heat inside an empty canister will deteriorate the carbon fiber sleeve. TBR sells repack kits (Road - #005-10038, Offroad - #005-10038MX) that include everything you need to easily do it yourself.

Titanium Mufflers: For cleaning use a mild water based spray cleaner. Always apply cleaner or polish with a soft, clean cloth. Always make sure the fiberglass packing inside is in good condition and not burned out, as exhaust heat inside an empty canister will deteriorate the carbon fiber sleeve. TBR sells repack kits (Road - #005-10038, Offroad - #005-10038MX) that include everything you need to easily do it yourself.

Repack all road canisters every 3,000 miles. Part #005-10038

Repack all offroad canisters after every 10 hours of use. Part #005-10038MX

NEVER dyno test your bike with carbon fiber or titanium canisters installed - the intense heat and lack of cooling air can quickly burn through the canister material. Two Brothers Racing does not provide a warranty for burned canisters.

Warranty

Two Brothers Racing products are intended for closed course competition purposes only, and therefore are sold "as is" without warranty. Two Brothers Racing specifically disclaims any warranties of merchantability or fitness for a particular purpose and disclaims all responsibility for consequential and incidental damages or any other losses arising from the use of these products or parts.