



2011-2012 Yamaha XTZ1200

Installation Instructions



JUICEBOX PRO[®]
Premium Fuel Controller

PARTS LIST

- 1 Juice Box Pro™
- 1 USB Cable
- 1 TopTune CD-ROM
- 1 Installation Guide
- 2 Velcro strip
- 1 Alcohol swab
- 1 Posi-tap

THE IGNITION MUST BE TURNED OFF BEFORE INSTALLATION!

DOWNLOAD THE TOPTUNE SOFTWARE AND LATEST MAPS FROM OUR WEBSITE:

www.twobros.com

PLEASE READ ALL DIRECTIONS BEFORE STARTING INSTALLATION

401 S. Grand Ave. Santa Ana, CA 92705
(800) 211-2767 www.twobros.com

JUICEBOX PRO[®]

Premium Fuel Controller

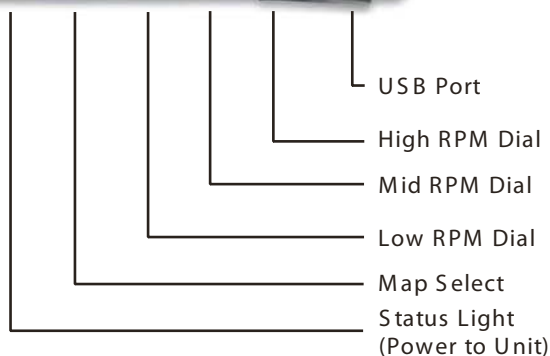

Selecting the Map Position

The Juice Box Pro comes loaded with up to ten maps. Using a #1 Phillips screwdriver, turn the map select dial to toggle between the loaded maps. Refer to the map position table below for the maps included in your Juice Box Pro.

Using the RPM Range Dials

The Low, Mid, and High RPM Dials refer to the RPM range, in thirds, of your vehicle. Each dial allows +/- 10% fuel adjustment on top of what fuel changes are done in the map. With the dial facing straight up, there is no additional fuel change. For example, if your vehicle revs to 15,000 RPM:

- the low RPM dial will adjust 0-5000 RPM
- the mid RPM dial will adjust 5001-10000 RPM
- the high RPM dial will adjust 10001-15000 RPM

Using TopTune

Take your tuning to the next level with the TopTune software.

Installing the TopTune Software

- 1 Insert the CD provided into your computer's cd-rom drive. The launch program will run automatically. If auto-run is disabled, double-click the My Computer icon then double-click the CD drive icon. Double-click TBR TopTune.exe to manually start the CD.
- 2 Click Install Software and follow the on-screen instructions to install the Top Tune software. The TopTune software and maps will be stored in C:\Program Files\TBR TopTune.
- 3 Click Map Database. All maps will automatically be installed to the C:\Program Files\TBR TopTune\maps folder.

Loading Additional Maps

- 1 Connect the USB cable from the computer to the Juice Box Pro. Verify the cable is fully seated in the Juice Box Pro.
- 2 Run the TopTune software by double-clicking the program icon installed on your desktop or on your start menu.
- 3 Click Open Map File and select a map file.
- 4 Click Send Map. You can send the map to any of the ten map positions.

Altering Maps Using TopTune

The values in the map represent a percentage of fuel change over stock. A value of 10 in the map indicates at that throttle position and RPM range the vehicle will be 10% richer than stock. If the value is -10, then it would be 10% leaner than stock. You have the ability to fine tune your fuel curve by altering these values. The TopTune software allows a value of +250 to -100 in each cell.

Position 0	Zero map	
Position 1	Stock exhaust Stock or aftermarket air filter	2011 Yamaha XTZ1200
Position 2	Two Brothers slip-on Stock or aftermarket air filter	2011-2012 Yamaha XTZ1200

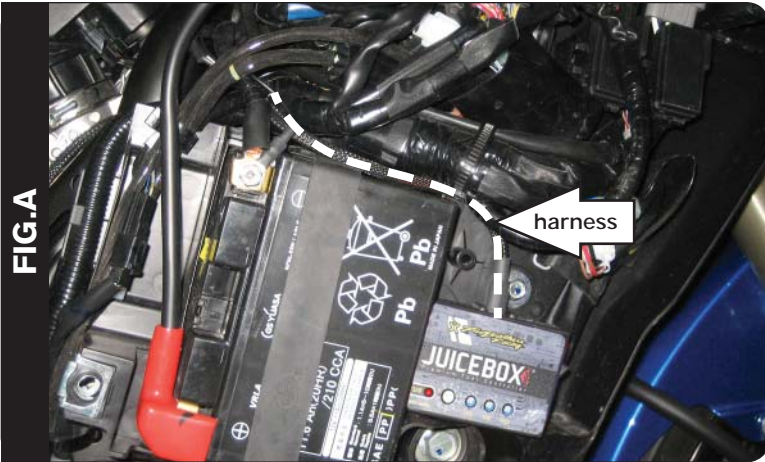

1. Remove the seat.
2. Remove both the left and right side panels.
3. Prop the front of the fuel tank up.
4. Place the Juice Box Pro on the right side of the bike near the battery as shown in Figure A.
5. Attach the Juice Box Pro ground wire to the negative side of the battery as shown in Figure A.

Using the stock zip tie, secure the Juice Box Pro harness to the main harness.

6. Route the Juice Box Pro harness along the stock main harness, under the frame tube, and to the throttle body as shown in Figure B.
7. Locate the Throttle Position Sensor (TPS) connector as shown in Figure B.

The TPS connector is located on the right side of the throttle bodies.

8. Using the supplied posi-tap, connect the grey wire from the Juice Box Pro to the stock white wire as shown in Figure B.
9. Using the stock zip tie, secure the Juice Box Pro harness to the main harness.

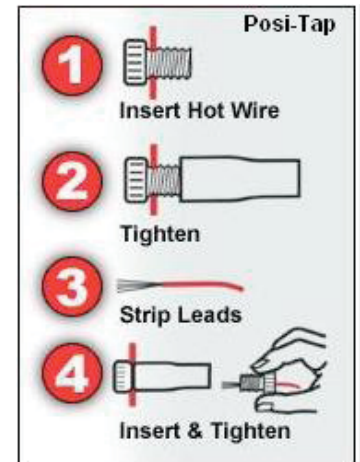

10. Unplug the stock wiring harness from each injector as shown in Figure C.

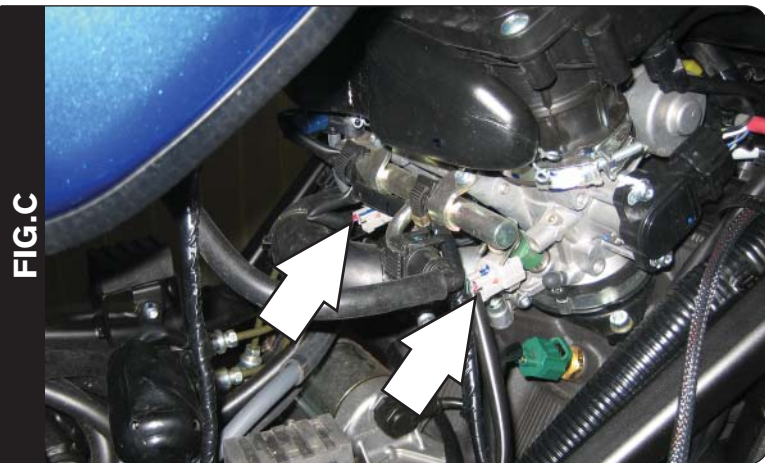
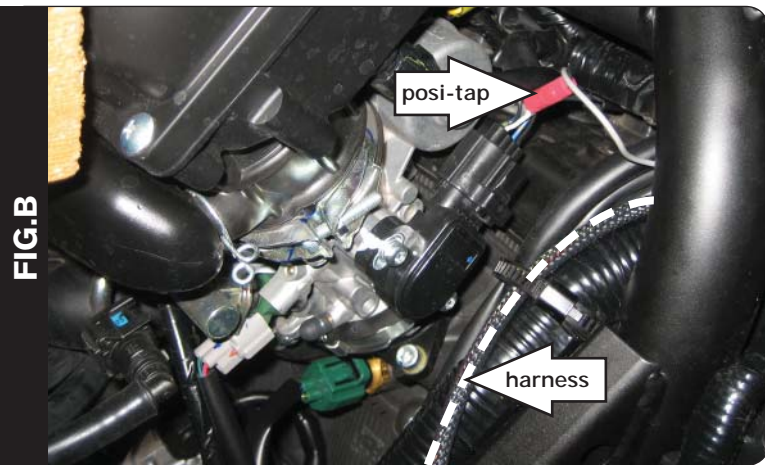



11. Attach the Juice Box Pro harness to the stock wiring harness and each injector as shown in Figure D.

Juice Box Pro orange wires connect to cylinder #1 (left).

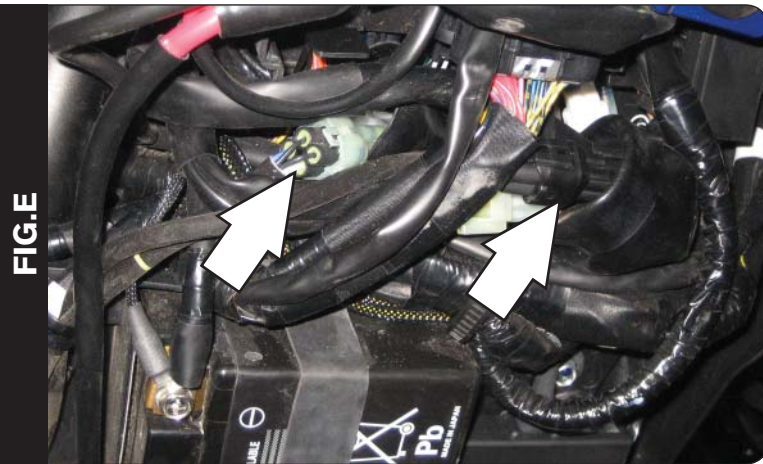

12. Locate the stock O2 sensor connectors.

The stock O2 sensor connectors are on top of the battery and are hidden inside the black rubber boots.

The clear connector is for the right O2 sensor. The black connector is for the left O2 sensor.

13. Unplug the stock O2 connectors.



14. Attach the left and right labeled connectors from the Juice Box Pro harness to the stock O2 sensor connections as shown in Figure F.

Attach the connector labeled left to the stock black connector.

Attach the connector labeled right to the stock clear connector.

15. Replace the fuel tank.
16. Replace the left and right side panels.
17. Replace the seat.

FIG.G

	0	2	5	10	15	20	40	60	80	100
500	0	0	0	0	0	0	0	0	0	0
750	0	0	0	0	0	0	0	0	0	0
1000	0	0	0	0	0	0	0	0	0	0
1250	0	0	0	0	0	0	0	0	0	0
1500	0	0	0	0	0	0	0	0	0	0
1750	0	0	0	0	0	0	0	0	0	0
2000	0	0	0	0	0	0	0	0	0	0
2250	0	0	0	0	0	0	0	0	0	0
2500	0	0	0	0	0	0	0	0	0	0
2750	0	0	0	0	0	0	0	0	0	0
3000	0	0	0	0	0	0	0	0	0	0
3250	0	0	0	0	0	0	0	0	0	0
3500	0	0	0	0	0	0	0	0	0	0
3750	0	0	0	0	0	0	0	0	0	0
4000	0	0	0	0	0	0	0	0	0	0
4250	0	0	0	0	0	0	0	0	0	0
4500	0	0	0	0	0	0	0	0	0	0
4750	0	0	0	0	0	0	0	0	0	0
5000	0	0	0	0	0	0	0	0	0	0
5250	0	0	0	0	0	0	0	0	0	0
5500	0	0	0	0	0	0	0	0	0	0
5750	0	0	0	0	0	0	0	0	0	0

The Juice Box Pro for this model controls the stock closed loop area. This area is represented by the highlighted cells shown in Figure G. The Juice Box Pro is designed to achieve a target AFR of 13.6:1. You must retain your stock O2 sensors. It is not recommended to alter the values in the highlighted area unless instructed to do so by a Two Brothers technician.