



2006-10 Yamaha Raptor 700

Installation Instructions



JUICEBOX PRO[®]
Premium Fuel Controller

PARTS LIST

- | | |
|---|--------------------|
| 1 | Juice Box Pro™ |
| 1 | USB Cable |
| 1 | Top Tune CD-ROM |
| 1 | Installation Guide |
| 2 | Velcro |
| 1 | Alcohol swab |

FOR RACE USE ONLY

DOWNLOAD THE TOPTUNE SOFTWARE
AND LATEST MAPS FROM OUR
WEBSITE:

www.twobros.com

PLEASE READ ALL DIRECTIONS BEFORE STARTING INSTALLATION

401 S. Grand Ave. Santa Ana, CA 92705
(800) 211-2767 www.twobros.com

JUICEBOX PRO[®]

Premium Fuel Controller

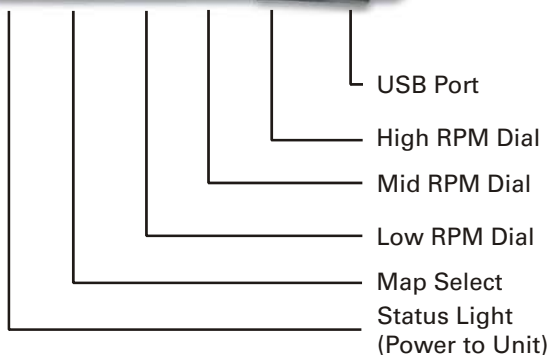

Position 0	Zero map	
Position 1	Stock exhaust, Stock air filter, Stock airbox	2006-2010 Raptor 700
Position 2	Stock exhaust, Stock air filter, Airbox lid removed	2006-2010 Raptor 700 EFI
Position 3	Stock exhaust with muffler insert removed Stock air filter, Airbox lid removed	2006-2010 Raptor 700 EFI
Position 4	Two Brothers slip-on, Stock air filter, Stock airbox	2006-2010 Raptor 700 EFI
Position 5	Two Brothers slip-on, Quad Works intake kit, Airbox lid removed	2006-2010 Raptor 700 EFI
Position 6	Two Brothers slip-on, Pro Design intake kit, Airbox lid removed	2006-2010 Raptor 700 EFI

Selecting the Map Position

The Juice Box Pro comes loaded with up to ten maps. Using a #1 Phillips screwdriver, turn the map select dial to toggle between the loaded maps. Refer to the map position table below for the maps included in your Juice Box Pro.

Using the RPM Range Dials

The Low, Mid, and High RPM Dials refer to the RPM range, in thirds, of your vehicle. Each dial allows +/- 10% fuel adjustment on top of what fuel changes are done in the map. With the dial facing straight up, there is no additional fuel change. For example, if your vehicle revs to 15,000 RPM:

- the low RPM dial will adjust 0-5000 RPM
- the mid RPM dial will adjust 5001-10000 RPM
- the high RPM dial will adjust 10001-15000 RPM

Using Top Tune

Take your tuning to the next level with the Top Tune software.

Installing the Top Tune Software

- 1 Insert the CD provided into your computer's cd-rom drive. The launch program will run automatically.
If auto-run is disabled, double-click the My Computer icon then double-click the CD drive icon. Double-click TBR TopTune.exe to manually start the CD.
- 2 Click Install Software and follow the on-screen instructions to install the Top Tune software. The Top Tune software and maps will be stored in C:\Program Files\TBR TopTune.
- 3 Click Map Database. All maps will automatically be installed to the C:\Program Files\TBR TopTune\maps folder.

Loading Additional Maps

- 1 Connect the USB cable from the computer to the Juice Box Pro. Verify the cable is fully seated in the Juice Box Pro.
- 2 Run the TopTune software by double-clicking the program icon installed on your desktop or on your start menu.
- 3 Click Open Map File and select a map file.
- 4 Click Send Map. You can send the map to any of the ten map positions.

Altering Maps Using Top Tune

The values in the map represent a percentage of fuel change over stock. A value of 10 in the map indicates at that throttle position and RPM range the vehicle will be 10% richer than stock. If the value is -10, then it would be 10% leaner than stock. You have the ability to fine tune your fuel curve by altering these values. The Top Tune software allows a value of +250 to -100 in each cell.



The ignition must be turned OFF before installation.

- 1 Remove the seat.
- 2 Remove the fuel tank cover and the front shroud over the radiator.
- 3 Remove the four fuel tank mounting bolts and two push pins. Figure A shows the two rear mounting bolts and two push pins.

Note: The fuel tank needs to be raised up to access the throttle body. You do not need to disconnect the wiring harness or the fuel line from the fuel tank.

- 4 Route the Juice Box Pro wiring harness from the rear of the quad to the throttle body along the left hand side of the frame. Route the harness behind the air box mounting tab as shown in Figure B.

- 5 Route the Juice Box Pro wiring harness between the battery and the battery bracket as shown in Figure C.
- 6 Continue routing the Juice Box Pro wiring harness underneath the frame and towards the throttle body.
- 7 Attach the ground wire from the Juice Box Pro to the negative side of the battery as shown in Figure C.

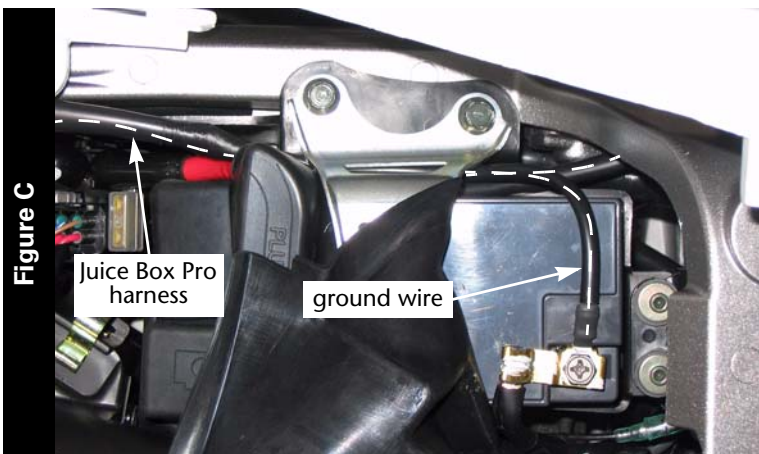
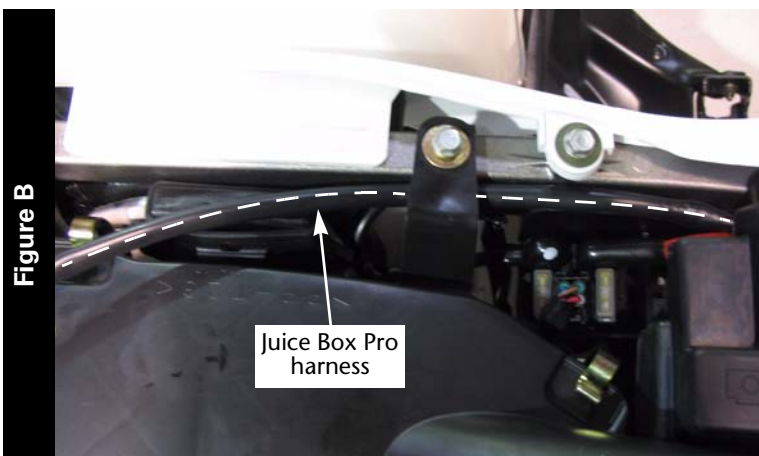
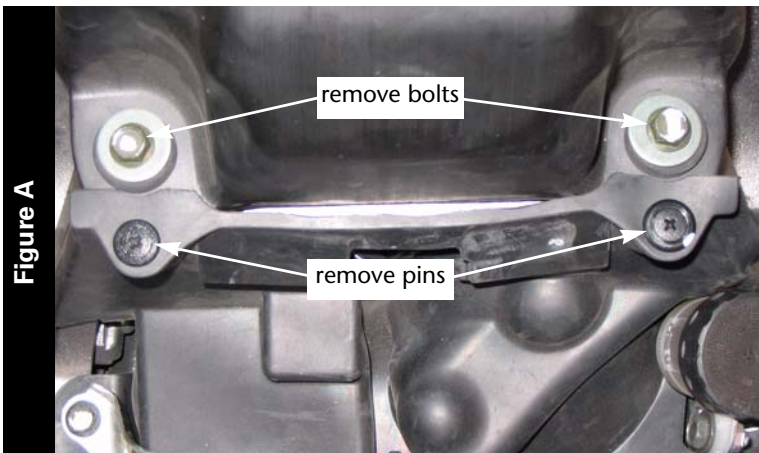

- 8 Unplug the stock wiring harness from the fuel injector as shown in Figure D.



- 9 Attach the Juice Box Pro connectors to the fuel injector and stock wiring harness as shown in Figure E.



- 10 Unplug the throttle position sensor (TPS) connector from the right hand side of the throttle body as shown in Figure F.
The TPS connector is covered with a black rubber boot.

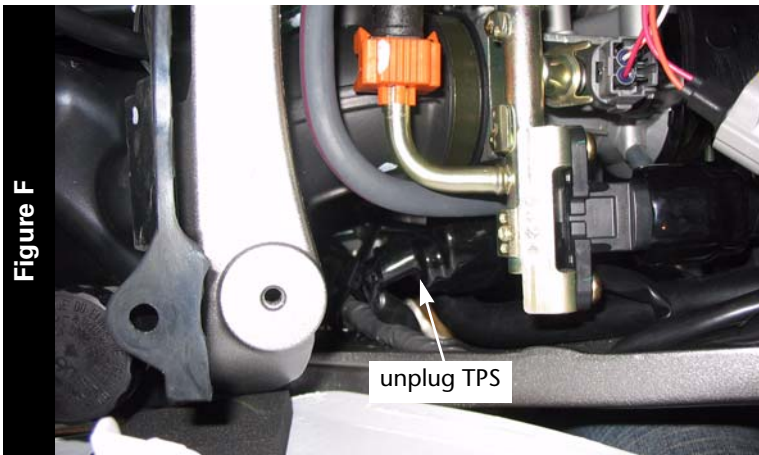

Figure G



- 11 Attach the Juice Box Pro connectors to the stock TPS connector and wiring harness as shown in Figure G.

Figure H



- 12 Using the supplied velcro, secure the Juice Box Pro in the tail section. Make sure to clean both surfaces with the alcohol swab before attaching.
- 13 Mount the fuel tank back into place. Verify the wiring harness will not get pinched or damaged.
- 14 Reinstall the seat.