



401 South Grand Ave., Santa Ana, CA 92705  
Tel: 714.550.6070 Fax: 714.550.9661 www.twobros.com



## 2006-10 Yamaha R6

V.A.L.E.™ Slip-on Exhaust System with M-2 Canister  
Part # 005-1460406V / 005-1460407V / 005-1460408V



### Parts List

Qty.	Description	Part Number
1	Yamaha R6 Muffler Canister M-2	Varies
1	Yamaha R6 Slip-On Tube	005-14604S
1	Muffler Clamp	Varies
1	HARDWARE KIT	005-146-3
1	X-Lite™ V.A.L.E.™ Retaining Ring	005-7-2-2
1	Yamaha R6 Billet Muffler Mounting Bracket	005-146B
1	8x16mm Flange Bolt	005-FB816
1	Barrel Clamp	005-27-61MSH
1	5mm Long Handle Ball end hex key	005-9-18610
4	6x14mm Socket Head Cap Screw	005-SH614
4	6mm Split Lock Washer	005-WL6

### IMPORTANT - PLEASE READ CAREFULLY

*We recommend that this performance part be installed by a qualified motorcycle technician. If you have any doubts as to your ability to install this performance part, please consult with your local motorcycle dealer. Read all instructions first before starting installation. Make sure the motorcycle and exhaust system are completely cool before starting the installation. Also, make sure the bike is secure on a centerstand or ideally a service lift during installation. Be sure to save all stock components for possible use later.*

### Installation Instructions

1. Make sure the bike is completely cool before starting the installation. Make sure the bike is secure on a centerstand or ideally a service lift.
2. Remove lower right fairing from the motorcycle.



3. Remove muffler inlet cover from front of muffler to expose exhaust valve cables (noise reduction valve).

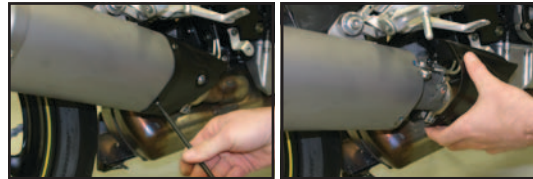

4. Remove cables from muffler and cable clamp from right side rearset assembly.

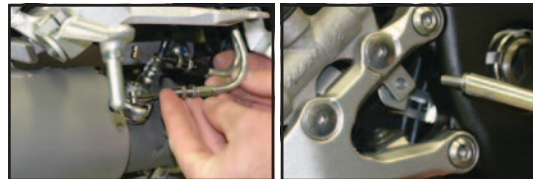

5. Remove muffler joint clamp and muffler mounting bolt.



6. Remove muffler assembly. Also be sure to remove the OEM retaining ring and gasket from the stock slip tube.



7. Remove bracket holding the brake reservoir to the frame.



8. Remove the noise reduction valve servo bracket from the frame.



9. Remove servo by pulling out from the right side of the motorcycle and disconnect the cables. Disregard cables.

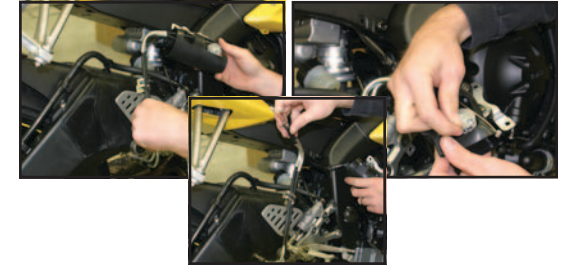

10. Remount the servo without the cables. This step is necessary in order to keep an error code from being displayed on the LCD screen.



11. Reinstall the brake reservoir.



(Continued on Page 2)





401 South Grand Ave., Santa Ana, CA 92705  
Tel: 714.550.6070 Fax: 714.550.9661 www.twobros.com



## 2006-10 Yamaha R6

V.A.L.E.™ Slip-on Exhaust System with M-2 Canister  
Part # 005-1460406V / 005-1460407V / 005-1460408V

(Continued from Page 1)

12. Slide the V.A.L.E. x-ring over the slip-on tube and loosely attach the slip-on tube to the muffler with the 4 supplied 6x14mm socket head cap screws. Use the supplied split lock washers.



13. Slide the rubber-lined muffler clamp over the muffler and loosely attach the supplied muffler bracket to the muffler clamp using the supplied 8x16mm flange bolt. Use the supplied threadlock.



14. Slide the barrel clamp over the TBR slip-tube.



15. Slide the muffler assembly onto the OEM muffler joint tube.



### Installation Instructions

16. Attach muffler assembly using OEM muffler mount bolt. Use supplied threadlock. Do not tighten yet.



17. Align muffler and muffler clamp with swingarm and then securely tighten both muffler mounting bolts.

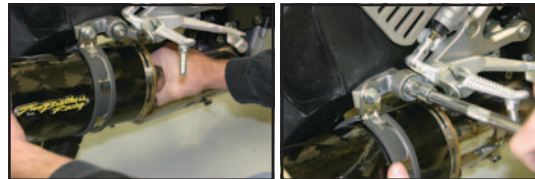

18. Tighten barrel clamp.



19. Tighten the 4 6x14mm socket head cap screws at muffler inlet.

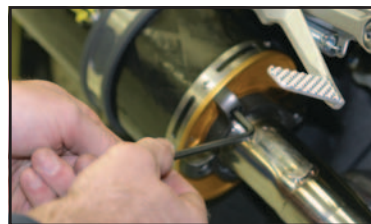

20. Reinstall lower right side fairing.



21. Double check your work and make sure all hardware is securely tightened.

22. Before you run the bike, clean off all fingerprints and dirt, as any oily residue will etch the metal and become somewhat permanent when the system gets hot. Run the bike and enjoy. It is normal for some white smoke to appear the first time you start the bike. This is packing/manufacturing oil from inside the pipe burning off. Check for gaps or leaks. If you find a leak, a little high temperature silicon sealant should fix it. After 50 to 100 miles, recheck all fasteners for tightness.



### Care & Cleaning / Warranty

#### Care & Cleaning

Keep system free of dirt and moisture. Store in a cool, dry place. For cleaning use a mild spray cleaner. Always apply cleaner or polish with a soft, clean cloth.

**Stainless Header System:** Polished stainless steel pipes will turn a light golden hue after a few heat cycles, this is a normal characteristic of high quality stainless steel.

**Carbon Fiber Mufflers:** Always make sure the fiberglass packing inside is in good condition and not burned out, as exhaust heat inside an empty canister will deteriorate the Carbon Fiber sleeve. TBR sells repack kits (TBR part # 005-10038) that include new rivets and repack material as well as a drill bit (#30), making it easy to do yourself. Also, NEVER dyno test your bike with carbon fiber mufflers installed - the intense heat and lack of cooling air can quickly cause the CF material to burn. Two Brothers Racing does not provide a warranty for burned carbon fiber.

**Aluminum Mufflers:** Use an aluminum or mag wheel polish such as Mother's to restore the bright finish to factory spec.

#### Warranty Information

Two Brothers Racing products are intended for closed course competition purposes only, and therefore are sold "as is" without warranty. Two Brothers Racing specifically disclaims any warranties of merchantability or fitness for a particular purpose and disclaims all responsibility for consequential and incidental damages or any other losses arising from the use of these products or parts.



401 South Grand Ave., Santa Ana, CA 92705  
Tel: 714.550.6070 Fax: 714.550.9661 www.twobros.com



**2006-10  
Yamaha R6**

V.A.L.E.™ Slip-on Exhaust System with M-2 Canister  
Part # 005-1460406V / 005-1460407V / 005-1460408V



005-1460406V

005-1460407V

005-1460408V



Qty.	Description	Part Number
1	Yamaha R6 Muffler Canister M-2 Aluminum	005-146-206
1	Yamaha R6 Slip-On Tube	005-14604S
1	Muffler Clamp	005-2C
1	HARDWARE KIT	005-146-3
1	X-Lite™ V.A.L.E.™ Retaining Ring	005-7-2-2
1	Yamaha R6 Billet Muffler Mounting Bracket	005-146B
1	8x16mm Flange Bolt	005-FB816
1	Barrel Clamp	005-27-61MSH
1	5mm Long Handle Ball end hex key	005-9-18610
4	6x14mm Socket Head Cap Screw	005-SH614
4	6mm Lock Washer	005-WL6

Qty.	Description	Part Number
1	Yamaha R6 Muffler Canister M-2 Carbon Fiber	005-146-207
1	Yamaha R6 Slip-On Tube	005-14604S
1	Muffler Clamp	005-2C1
1	HARDWARE KIT	005-146-3
1	X-Lite™ V.A.L.E.™ Retaining Ring	005-7-2-2
1	Yamaha R6 Billet Muffler Mounting Bracket	005-146B
1	8x16mm Flange Bolt	005-FB816
1	Barrel Clamp	005-27-61MSH
1	5mm Long Handle Ball end hex key	005-9-18610
4	6x14mm Socket Head Cap Screw	005-SH614
4	6mm Lock Washer	005-WL6

Qty.	Description	Part Number
1	Yamaha R6 Muffler Canister M-2 Titanium	005-146-208
1	Yamaha R6 Slip-On Tube	005-14604S
1	Muffler Clamp	005-2C2
1	HARDWARE KIT	005-146-3
1	X-Lite™ V.A.L.E.™ Retaining Ring	005-7-2-2
1	Yamaha R6 Billet Muffler Mounting Bracket	005-146B
1	8x16mm Flange Bolt	005-FB816
1	Barrel Clamp	005-27-61MSH
1	5mm Long Handle Ball end hex key	005-9-18610
4	6x14mm Socket Head Cap Screw	005-SH614
4	6mm Lock Washer	005-WL6