



401 South Grand Ave., Santa Ana, CA 92705
Tel: 714.550.6070 Fax: 714.550.9661 www.twobros.com

2006-07 Kawasaki ZX-10R

DUAL Flange-On Exhaust System with M-2 Canisters
Part # 005-1390406D / 005-1390407D / 005-1390408D



Parts List



Qty.	Description	Part Number
1	ZX-10R Flange-on Muffler Canister (Right)	Varies
1	ZX-10R Flange-on Muffler Canister (Left)	Varies
1	HARDWARE KIT	005-139-4
1	ZX-10R License Plate Bracket	005-13904B
2	8x16mm Flange Bolt	005-FB816
2	Lite'n Boltz (1 lighted license plate bolt)	005-8504LT2
4	Blue Scotchlock	005-BS
1	Zip Tie - 4" x 5/8" - Black	005-ZT458B
1	Zip Tie Mount - 4 Way With Adhesive Back	005-ZTM4
4	6mm Flat Washer	005-WF6
8	8mm Flat Washer	005-WF8
2	ZX-10R Aluminum Muffler Bracket	005-13904B2
4	6x16mm Socket Head Cap Screw	005-SH616
8	8x20mm Socket Head Cap Screw	005-SH820

IMPORTANT - PLEASE READ CAREFULLY

We recommend that this performance part be installed by a qualified motorcycle technician. If you have any doubts as to your ability to install this performance part, please consult with your local motorcycle dealer. Read all instructions first before starting installation. Make sure the motorcycle and exhaust system are completely cool before starting the installation. Also, make sure the bike is secure on a centerstand or ideally a service lift during installation. Be sure to save all stock components for possible use later.

Installation Instructions

1. Make sure the bike is completely cool before starting the installation. Make sure the bike is secure on a centerstand or ideally a service lift.
2. Remove passenger seat.
3. Remove left and right side panels and remove seat.



4. Remove rear cowling by removing bolts and push pins that attach to frame.



5. Remove right side rear passenger peg, heat shield and heat shield cover.
6. Remove left side and right side rear passenger peg assembly.



7. Remove left side muffler mount bolt and loosen the 4 bolt connector tube to remove right side muffler assembly.

8. Remove right side muffler mount bolt and 4 bolt connector.

9. Remove rear fender assembly by removing the 4 bolts under passenger seat base and unplug connector wire



from right side of rear cowling area.

Note: Use threadlock on all hardware to ensure a stronger/tighter fit.

10. Loosely attach mufflers to the OEM Flange, using the supplied 8x20mm socket head cap screws and washers. Use threadlock. Make sure you use the OEM gasket.

11. Loosely install supplied gold muffler mount with OEM hardware and lower shoulder protruding inward to both sides.



12. Slide lined muffler clamps over mufflers and attach to the new muffler mount location using the 8x16mm Hex Head Flange Bolt provided. Use threadlock.

13. Making sure that muffler orientation is correct, tighten upper muffler mount bolt, then tighten the 4 8x20mm flange bolts.





401 South Grand Ave., Santa Ana, CA 92705
Tel: 714.550.6070 Fax: 714.550.9661 www.twobros.com

2006-07 Kawasaki ZX-10R

DUAL Flange-On Exhaust System with M-2 Canisters
Part # 005-1390406D / 005-1390407D / 005-1390408D



Installation Instructions

14. Reinstall passenger peg assembly on both sides.



15. Install supplied license plate bracket onto rear tail section using the 4 6x16mm socket head cap screws and washers.
16. Use supplied Lite'n-bolts to attach license plate to

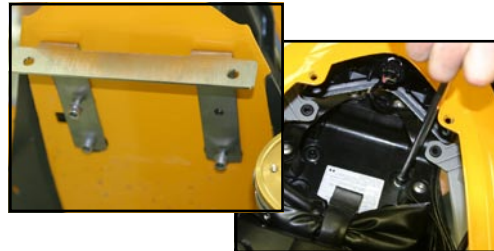

license plate bracket and connect wires using supplied scotch locks to the red and black license plate wires on left side of rear cowling area. Use included adhesive tab and zip tie to keep wires contained. Check that plate lights light license plate with key on.

17. Reinstall lower cowling and upper rear cowling.

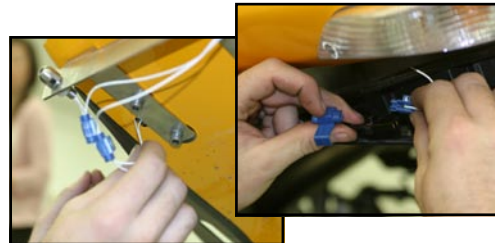

18. Reinstall seat and passenger seat. Reinstall side covers.

19. Double check your work to ensure everything is tight and properly installed.

20. Before you run the bike, clean off all fingerprints and dirt, as any oily residue will etch the metal and become somewhat permanent when the system gets hot. Run the bike and enjoy. It is normal for some white smoke to appear the first time you start the bike. This is packing/manufacturing oil from inside the pipe burning off. Check for gaps or leaks. If you find a leak, a little high temperature silicon sealant should fix it. After 50 to 100 miles, recheck all fasteners for tightness.

Care & Cleaning / Warranty

Care & Cleaning

Keep system free of dirt and moisture. Store in a cool, dry place. Make sure vehicle is completely cool before maintenance.

Stainless Header System: Polished stainless steel pipes will turn a light golden hue after a few heat cycles, this is a normal characteristic of high quality stainless steel. Clean using a mild water based spray cleaner. Always apply cleaner or polish with a soft, clean cloth.

Titanium Header System: Polished titanium pipes will experience color shift ranging from deep blue/purple through amber after a few heat cycles. This is a normal characteristic of high quality titanium. Clean using a mild water based spray cleaner. Always apply cleaner or polish with a soft, clean cloth.

Polished Aluminum Canisters: Use an aluminum or mag wheel polish to restore the bright finish to factory spec.

Brushed Aluminum Canisters: Clean using a mild water based spray cleaner. Always apply cleaner or polish with a soft, clean cloth.

Carbon Fiber Canisters: Clean using a mild water based spray cleaner. Always apply cleaner or polish with a soft, clean cloth. Always make sure the fiberglass packing inside is in good condition and not burned out, as exhaust heat inside an empty canister will deteriorate the carbon fiber sleeve. TBR sells repack kits (Road - #005-10038, Offroad - #005-10038MX) that include everything you need to easily do it yourself.

Titanium Mufflers: For cleaning use a mild water based spray cleaner. Always apply cleaner or polish with a soft, clean cloth. Always make sure the fiberglass packing inside is in good condition and not burned out, as exhaust heat inside an empty canister will deteriorate the carbon fiber sleeve. TBR sells repack kits (Road - #005-10038, Offroad - #005-10038MX) that include everything you need to easily do it yourself.

Repack all road canisters every 3,000 miles. Part #005-10038
Repack all offroad canisters after every 10 hours of use. Part #005-10038MX

NEVER dyno test your bike with carbon fiber or titanium canisters installed - the intense heat and lack of cooling air can quickly burn through the canister material. Two Brothers Racing does not provide a warranty for burned canisters.

Two Brothers Racing products are intended for closed course competition purposes only, and therefore are sold "as is" without warranty. Two Brothers Racing specifically disclaims any warranties of merchantability or fitness for a particular purpose and disclaims all responsibility for consequential and incidental damages or any other losses arising from the use of these products or parts.



401 South Grand Ave., Santa Ana, CA 92705
Tel: 714.550.6070 Fax: 714.550.9661 www.twobros.com

2006-07 Kawasaki ZX-10R

DUAL Flange-On Exhaust System with M-2 Canisters
Part # 005-1390406D / 005-1390407D / 005-1390408D



005-1390406D



Qty.	Description	Part Number
1	ZX-10R Flange-on Muffler Canister (Right)	005-139-206FL
1	ZX-10R Flange-on Muffler Canister (Left)	005-139-206FR
1	HARDWARE KIT	005-139-4
1	ZX-10R License Plate Bracket	005-13904B
2	8x16mm Flange Bolt	005-FB816
2	Lite'n Boltz (1 lighted license plate bolt)	005-8504LT2
4	Blue Scotchlock	005-BS
1	Zip Tie - 4" x 5/8" - Black	005-ZT458B
1	Zip Tie Mount - 4 Way w/ Adhesive Back	005-ZTM4
4	6mm Flat Washer	005-WF6
8	8mm Flat Washer	005-WF8
2	ZX-10R Aluminum Muffler Bracket	005-13904B2
4	6x16mm Socket Head Cap Screw	005-SH616
8	8x20mm Socket Head Cap Screw	005-SH820

005-1390407D



Qty.	Description	Part Number
1	ZX-10R Flange-on Muffler Canister (Right)	005-139-207FL
1	ZX-10R Flange-on Muffler Canister (Left)	005-139-207FR
1	HARDWARE KIT	005-139-4
1	ZX-10R License Plate Bracket	005-13904B
2	8x16mm Flange Bolt	005-FB816
2	Lite'n Boltz (1 lighted license plate bolt)	005-8504LT2
4	Blue Scotchlock	005-BS
1	Zip Tie - 4" x 5/8" - Black	005-ZT458B
1	Zip Tie Mount - 4 Way w/ Adhesive Back	005-ZTM4
4	6mm Flat Washer	005-WF6
8	8mm Flat Washer	005-WF8
2	ZX-10R Aluminum Muffler Bracket	005-13904B2
4	6x16mm Socket Head Cap Screw	005-SH616
8	8x20mm Socket Head Cap Screw	005-SH820

005-1390408D



Qty.	Description	Part Number
1	ZX-10R Flange-on Muffler Canister (Right)	005-139-208FL
1	ZX-10R Flange-on Muffler Canister (Left)	005-139-208FR
1	HARDWARE KIT	005-139-4
1	ZX-10R License Plate Bracket	005-13904B
2	8x16mm Flange Bolt	005-FB816
2	Lite'n Boltz (1 lighted license plate bolt)	005-8504LT2
4	Blue Scotchlock	005-BS
1	Zip Tie - 4" x 5/8" - Black	005-ZT458B
1	Zip Tie Mount - 4 Way w/ Adhesive Back	005-ZTM4
4	6mm Flat Washer	005-WF6
8	8mm Flat Washer	005-WF8
2	ZX-10R Aluminum Muffler Bracket	005-13904B2
4	6x16mm Socket Head Cap Screw	005-SH616
8	8x20mm Socket Head Cap Screw	005-SH820