

SKOOKUM TUBE

USER GUIDE



INFLATING / DEFLATING SKOOKUM TUBE

TO INFLATE:

1. Remove valve cap by twisting **counter-clockwise** and pulling out.

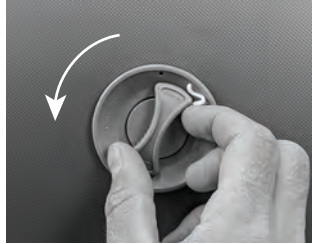

2. Fully extend the valve stem by pressing it inward and twisting **counter-clockwise**.



3. Use any high pressure pump with a Halkey-Roberts valve adapter to inflate to desired firmness. Insert the pump hose adapter into the valve and twist **clockwise** ¼ turn to secure. The valve will automatically open when the hose is inserted correctly. Do not exceed 10psi.



4. Detach pump and replace valve cap by inserting into valve and twisting **clockwise**.



TO DEFLATE:

1. Remove valve cap by twisting **counter-clockwise** and pulling out.

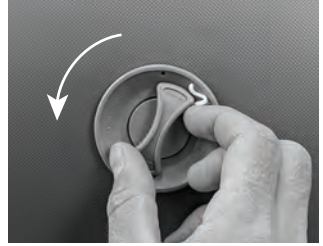

2. Lock valve in open position by depressing valve stem and twisting **clockwise**.



3. Force out air by folding and using body weight.



4. Close valve by depressing valve stem and twisting **counter-clockwise** to fully extend it.



5. If your pump has a deflate function, insert the pump hose adapter into the valve and twist clockwise $\frac{1}{4}$ turn to secure. Operate pump until all remaining air has been removed and then detach pump hose adapter from valve.



6. Replace valve cap by inserting into valve and twisting **clockwise**.

PRODUCT CARE & MAINTENANCE

Inflatables like Skookum Tube are susceptible to damage from excessive sun, heat, dirt, mold, mildew, or abrasion. Following the care, maintenance, and repair recommendations below will allow you to enjoy your Skookum Tube for many years to come.

CLEANING:

It's a good idea to give Skookum Tube a thorough fresh water rinse after each use to remove any dirt, debris or salt water. For heavier soiling wash with soap and water or use an inflatable boat cleaner. Be sure to thoroughly rinse off any soaps or cleaners with fresh water.

UV PROTECTION:

Skookum Tube materials are UV resistant, but long term exposure to the UV rays from the sun can still cause material degradation over time. Treatment with 303 Aerospace Protectant a couple of times per year can go a long way to prevent damage. When Skookum Tube is not in use, place it in the shade or store it in the included carry case.

STORAGE:

Store in a cool dry place, especially when storing for an extended period of time. If Skookum Tube is stored damp, mold or mildew can grow and damage the materials. Do not expose Skookum Tube to excessive heat for extended periods.

HANDLING:

Skookum Tube is made from rugged PVC coated fabric that is abrasion and puncture resistant, but excessive wear or sharp objects can damage the material and result in leaks. Avoid dragging Skookum Tube on rough surfaces like pavement, and keep it away from sharp objects.

USE:

On hot, sunny days periodically release a little bit of air to prevent excessive pressure from damaging the valve or seams. Do not use while wearing clothing with sharp buckles or zippers that may damage the surface of Skookum Tube.

PRODUCT REPAIR WITH INCLUDED PATCHES

Skookum Tube may very gradually lose air when left inflated for extended periods. This is normal and not a cause for concern. If you suspect a leak, spray Skookum Tube with a soap and water solution and look for any bubbles indicating the location of a leak. Leaks can be easily patched using the included patches according to the directions below:

Step 1 - Deflate Skookum Tube.

Step 2 - Clean and completely dry the area surrounding the leak.

Step 3 - Apply a thin layer of glue to an area slightly larger than the size of the patch as well as to the patch itself. Due to shipping restrictions, glue is not included with your repair kit. Email info@lakesurf.com to get a tube of glue shipped to you free of charge.

Step 4 - Let dry for 20 minutes and apply a second coat of glue to Skookum Tube and the patch.

Step 5 - Let dry for another 20 minutes.

Step 6 - Apply a third, and final, coat of adhesive to Skookum Tube and the patch and allow to dry for 3-5 minutes (preferably 3 minutes). If beyond this time, reactivate by applying an additional coat of adhesive. Bond when tacky.

Step 7 - Carefully align the patch and press both surfaces together.

Step 8 - Apply pressure to the entire glued surface using a roller if available. Roll every millimeter of patch in multiple directions, working from the inside to the outside of the patch.

Step 9 - Allow to cure for a full 24 hours before rolling up or inflating.

Sometimes air can leak from the valve when debris becomes lodged on the valve's sealing surfaces. A few quick bursts of air from depressing the valve stem will typically remove any blockages. If an air leak persists, reach out to Lakesurf customer care for assistance by emailing info@lakesurf.com.

PRODUCT WARRANTY

Skookum Tube is fully guaranteed to the original owner against defects in materials and workmanship for a period of one year from the date of purchase. Lakesurf is not responsible for the effects of normal wear and tear, accidents, abuse, alteration, modification, misuse or improper care, including sun damage, mold, or mildew.



To make a warranty claim email info@lakesurf.com and include 1) Description of the defect, 2) Photograph clearly showing the nature of the defect, and 3) Order number and name of purchaser. If the warranty claim is approved, Lakesurf will, at its sole discretion, repair or replace the defective item free of charge.

CONTACT INFORMATION



Lakesurf, LLC
29980 Technology Drive, Ste 9
Murrieta, CA 92563

www.lakesurf.com
info@lakesurf.com

 Lakesurf
 @lake.surf



Scan for additional product information.



WARNING

It is the owner's responsibility to read the instruction manual and instruct all users in the safe operation of this product. User ASSUMES ALL RISKS related to the use, or misuse, of this product. Please read this manual prior to inflating and using the product and keep for future reference. As with any snow or water play equipment, recklessness, inexperience, misuse, or neglect of the equipment may result in SERIOUS INJURY or DEATH.

- Children should only use this product under strict adult supervision.
- This product is not a personal flotation device.
- Always wear a U.S. Coast Guard-approved Type III (PFD) personal flotation device when using the product in water.
- Never place wrists or feet through handles.
- Maintain a safe distance from obstacles and hazards that could result in injury to the user or damage to the product.
- When sledding, ensure the path is clear of people before proceeding downhill.
- Sledders should wear a helmet.
- Never ride face down or head first. Always sit in the suspended seat and hold the handles.
- When towing behind snowmobile, or other vehicle, speed should not exceed 10mph.
- Do not use while under the influence of alcohol or drugs.
- Take all reasonable precautions in the use and operation of your product.
- Know your own limits and act responsibly.
- Do not use where the potential exists for dangerous conditions.
- Periodically check all equipment to ensure safety. Replace any portion of the equipment that shows signs of wear.
- Do not add any hardware or attachments not otherwise supplied by the manufacturer.

THE WARNINGS AND PRACTICES SET FORTH ABOVE REPRESENT SOME COMMON RISKS ENCOUNTERED BY USERS AND DOES NOT PURPORT TO COVER ALL INSTANCES OF RISK OR DANGER. PLEASE USE COMMON SENSE AND GOOD JUDGMENT.