

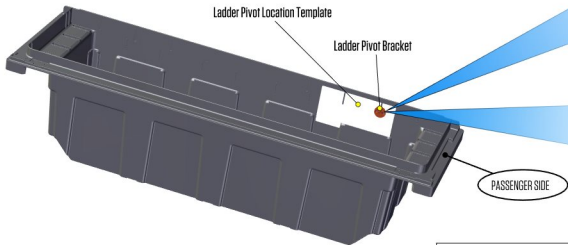

## ToolBox Ladder Bracket Installation



Ladder Pivot Location Template

Ladder Pivot Bracket

PASSENGER SIDE

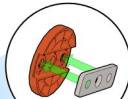

5. Place the Backer Plate on the backside of the Ladder Pivot Bracket. The counter-sunk holes on both parts must face out.

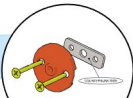

6. Using a #3 Phillips drill bit, install the two screws through the front of the Ladder Pivot Bracket and Backer Plate into the ToolBox tub and aluminum spanner.

7. Transfer the template to the passenger tailgate side of the ToolBox tub and repeat this process for the opposing Ladder Pivot Bracket.

**Skip to the next page if your ladder brackets are already installed.**

1. Align and adhere Ladder Pivot Location Template on passenger cabside of tub as shown.
2. Place Ladder Pivot Bracket in hole on Template, ensuring holes are horizontal.
3. Using a 5/32" drill bit and the LEFT and RIGHT holes on the Pivot Bracket as a guide, drill through the tub and aluminum spanner. Do not drill through the middle hole of the bracket.

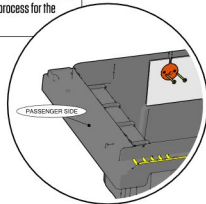

**WARNING:**

Failure to read and follow instructions for DECKED Tool Box installation and ladder usage may result in personal injury, or cause damage to the vehicle. Please read our comprehensive DECKED Tool Box warning in detail: [DECKED.COM/TOOLBOX-WARNING](http://DECKED.COM/TOOLBOX-WARNING)

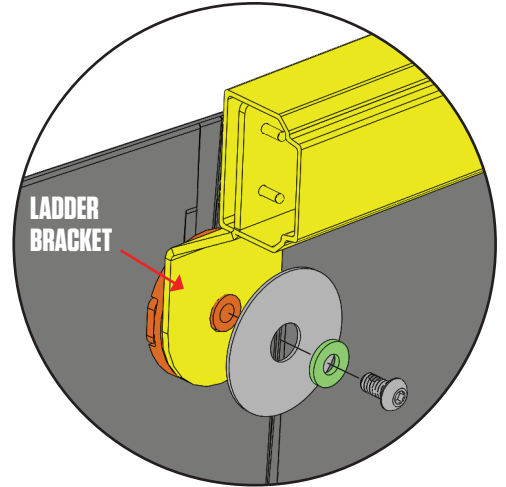
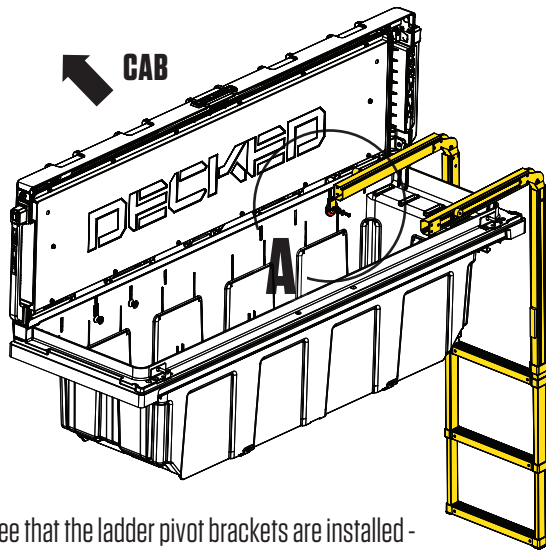

**DETAIL A**

- Check to see that the ladder pivot brackets are installed - (orange in Detail A). If not, see previous page.
- Rest the folded ladder on a table or hard surface so that you can read the instructions on the bottom of the first rung.
- While holding the top rung, pull the bottom rung from the ladder assembly until both the bottom and middle rungs lock in place.
- Set the ladder on the ground vertically next to the passenger side of your Tool Box.
- Raise both arms and extend them up and over the edge of the Tool Box to meet with the mounting discs. **NOTE: The ladder brackets must be facing down.**
- Using a 5/32" hex wrench, install the hardware in the order shown, DETAIL A. Repeat on opposite side. Tighten until snug - **DO NOT OVERTIGHTEN.**
- Return the ladder to the Tool Box by collapsing the rungs and folding back into place.

## USING THE LADDER:

<p><b>STEP 1</b></p> <p>"CLICK"</p>	<p><b>STEP 2</b></p> <p>"CLICK" AGAIN</p>	<p><b>STEP 3</b></p> <p>POSITION LADDER VERTICALLY TO SOLID GROUND</p>
-------------------------------------	---	--

**▼ WARNING DON'T DO THIS ▼**

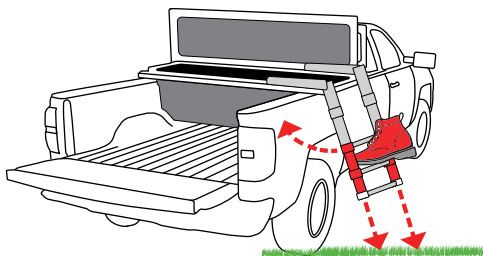

PLACE LADDER ON SOLID GROUND WITH BOTH RUNGS LOCKED INTO PLACE (LADDER STEPS 1-3). FAILURE TO DO THIS COULD ALLOW LADDER TO SWING INTO TRUCK AND CAUSE DAMAGE TO THE VEHICLE



SCAN ME

WATCH LADDER INSTRUCTIONAL VIDEOS:  
[DECKED.COM/LADDER](https://DECKED.COM/LADDER)