



DED-200

ELECTRONIC DRUM

INSTRUCTION MANUAL

5drum3cymbals



www.idonner.com
www.donnerdeal.com

Dear Customer,

Thank you for ordering from Donner! This is Donner Customer Service Team.

After received the package, please test and see if there's any problem. Any problem please feel free to contact us by amazon (the order page) or the email address below.



Welcome to Donner

Gmail: donnerdeal@gmail.com

Website: <https://www.donnerdeal.com/>

Thank you again for choosing Donner! Please enjoy making your own music.

Best regards
Donner Customer Service Team.

FUNCTION INTRODUCTION

- Six layers of force are adopted to make it closer to the original drum playing.
- Supports double triggers with edge-hit response.
- Fifteen sets of drum group and one sets of custom drum group.
- Number of timbres 225 and GM standard timbre library. (song use)
- Thirty songs, adjustable GM volume and drum volume .(for learning)
- Effect: reverberation type 0-5, two-band EQ equalization.
- Supporting adjustment of sensitivity parameters of drum discs.
- Speed control: 30-250 beats/minute.
- Metronome: 9 kinds.
- Other functions: customize settings, store and restore factory settings.
- Interpoles: USB MIDI, headphones, audio input, audio output, adding cymbal socket.



CATALOG

FUNCTION INTRODUCTION	1
CATALOG	2
INSTALLATION GUIDE	3
Check the attached items	3
Kick drum installation	4
Install hammer stick	4
Kick drum and pedal fixation	4
Installation module bracket	4
Drum stand	5
Drum stand installation	5
Installation of support rod and module box	6
Installation of strike components	7
Insert Connection Line	8
DIAGRAM OF MODULE BOX SOCKET	9
POWER TERMINAL CONNECTION	9
USB MIDI PORT	9
EARPHONE PORT	9
AUDIO OUTPUT PORT	9
AUDIO INPUT PORT	9
ADDING CYMBAL SOCKET	9
OPERATION GUIDE	10
POWER ON	10
MASTER VOLUME	10
TIMBRE SELECTION OF DRUM GROUP	11
PLAY THE DRUM	11
METRONOME	12
DEMONSTRATION MUSIC PLAYING	12
PLAY SPEED	13
DRUM DISC SENSITIVITY ADJUSTMENT	13
REVERBERATION/EQUILIBRIUM OPTIMIZATION	13
FACTORY RESET	13
APPENDIX	14
Timbre	14
Drum combination timbre	14
Demonstration music	14
User drum group	14
PRODUCT MAINTENANCE	15
SAFETY PRECAUTIONS	16
WARRANTY CARD	19



INSTALLATION GUIDE

REMARK !

- Please follow the instructions and read the "safety precautions" in the User Manual carefully before using it.
- When you have completed the connection, please turn on the power according to the instructions in the User's Manual and check whether you can hear the sound.
- This product needs adult to install, do not let the minor install it independently.

01

Check the attached items

- After opening the package, please check whether it contains all the items immediately. If there are any omissions, please contact your dealer.



Sound module

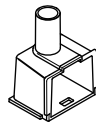

Module bracket

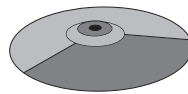

Hi hat

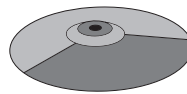

Ride

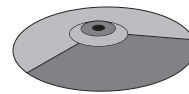

Crash

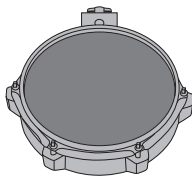

Tom-tom
(3pcs)

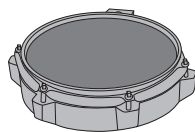

Snare

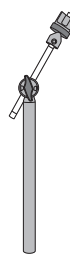

Hi hat mount

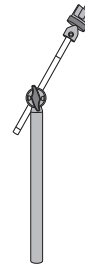

Cymbal mounts
(2pcs)

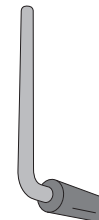

Drum mount
(4pcs)

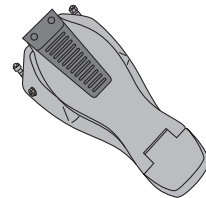

Hi hat pedal

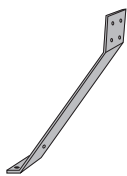

Supporting parts



Fixed parts

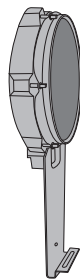

Kick

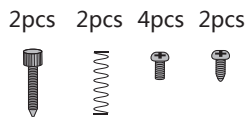

Fastening screw



Stick hammer

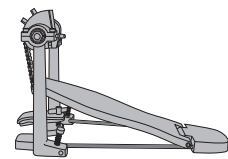

Kick pedal



drum stick

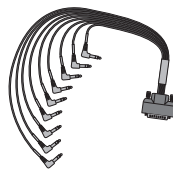

Signal Connection Line



power adapter



Bolt driver



Inner six angle



Drum key



INSTALLATION GUIDE

02

Kick drum installation

- During installation, tighten the screws and be careful not to pinch your finger!

The top two are pointed screw

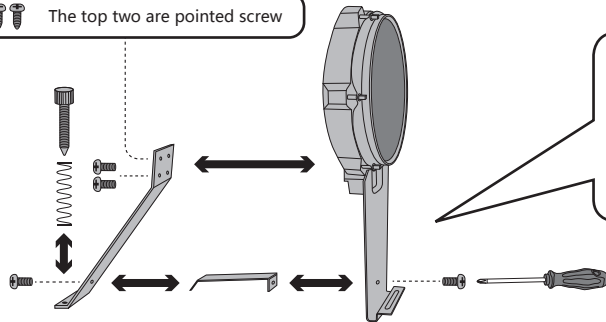

Use screwdriver to lock the kick drum, fixing parts and supporting parts with 6 small screws according to the figure. Then insert two springs into two anti-skid screws, lock in the bottom of the support until it is against the ground.

03

Install hammer stick

- Tighten the screw to avoid loosening.

Insert the hammer rod into the round hole according to the figure, rotate the wool hammer head to align it with the drum face, and tighten it with the drum key.

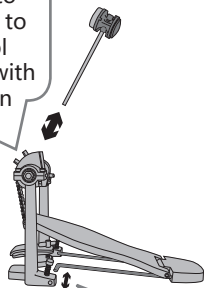
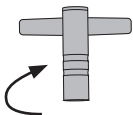

Insert the fixed iron bar into the hole position according to the figure.

04

Kick drum and pedal fixation

- Bottom drum and pedal should be fixed and tightened to avoid falling off.

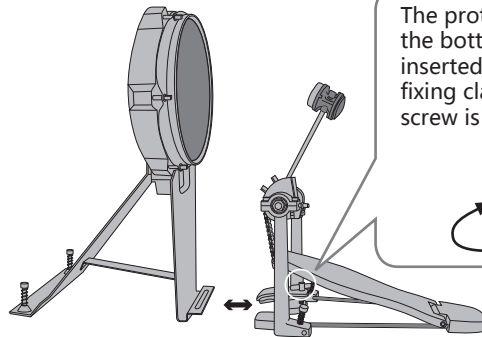

The protruding edge of the bottom drum is inserted into the pedal fixing clamp and the screw is tightened.

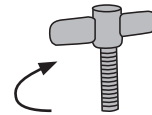

05

Installation module bracket

Push the sound bracket in the right direction to jam the sound module box

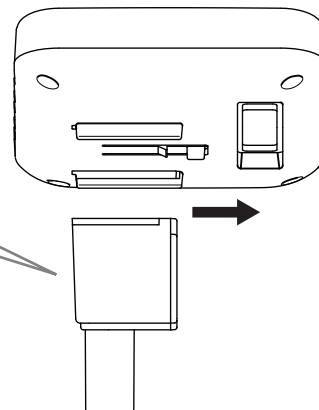



INSTALLATION GUIDE

06

Drum stand

- After opening the package, please check whether it contains all the items immediately. If there are any omissions, please contact your dealer.

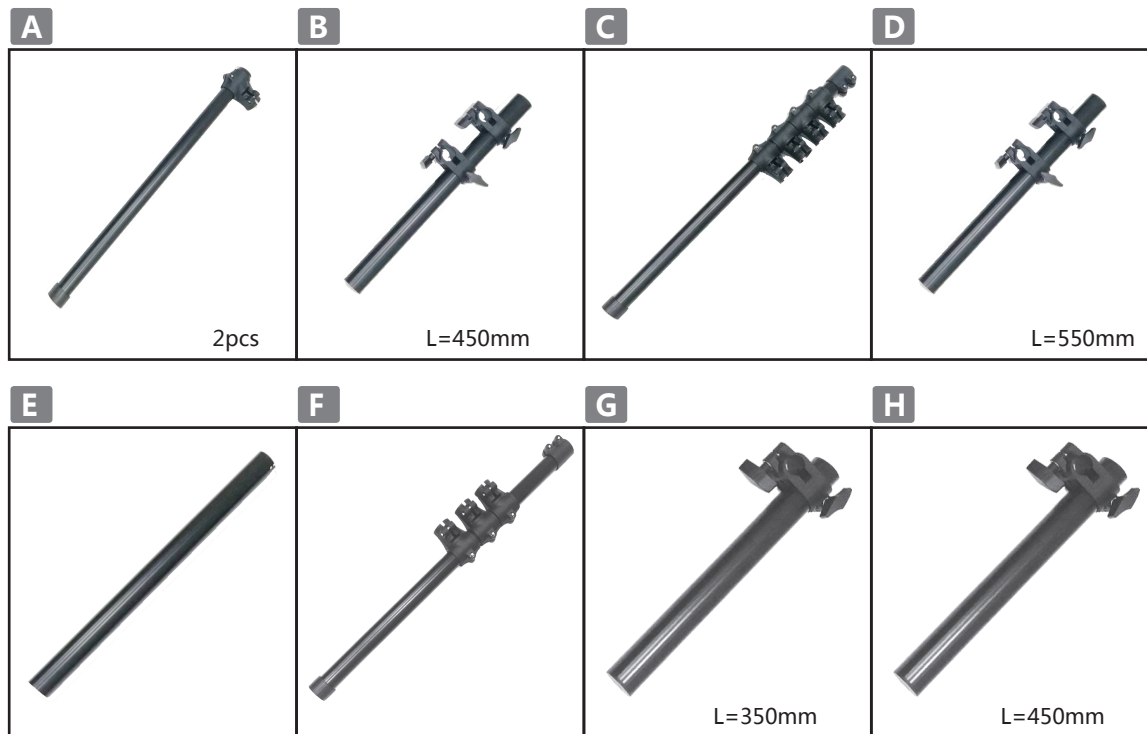

07

Drum stand installation

- During installation, tighten the screws and be careful not to pinch your finger!
- Assemble the drum stand according to the direction indicated.

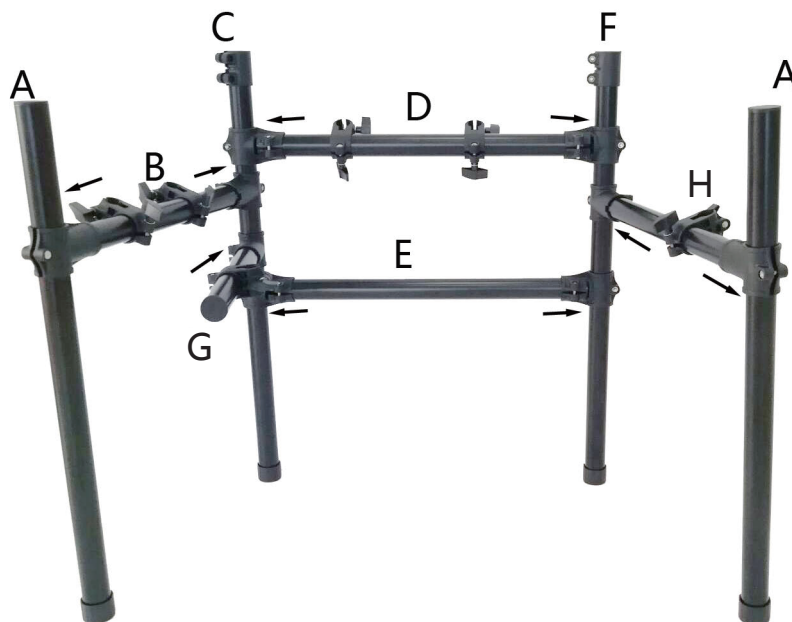



08

Installation of support rod and module box

- Support rods and module boxes need to be inserted in place, and tighten the plastic head screw to avoid falling.

Insert three cymbal support rods, four drum support rods and module boxes into corresponding positions respectively, and tighten the plastic head screw.

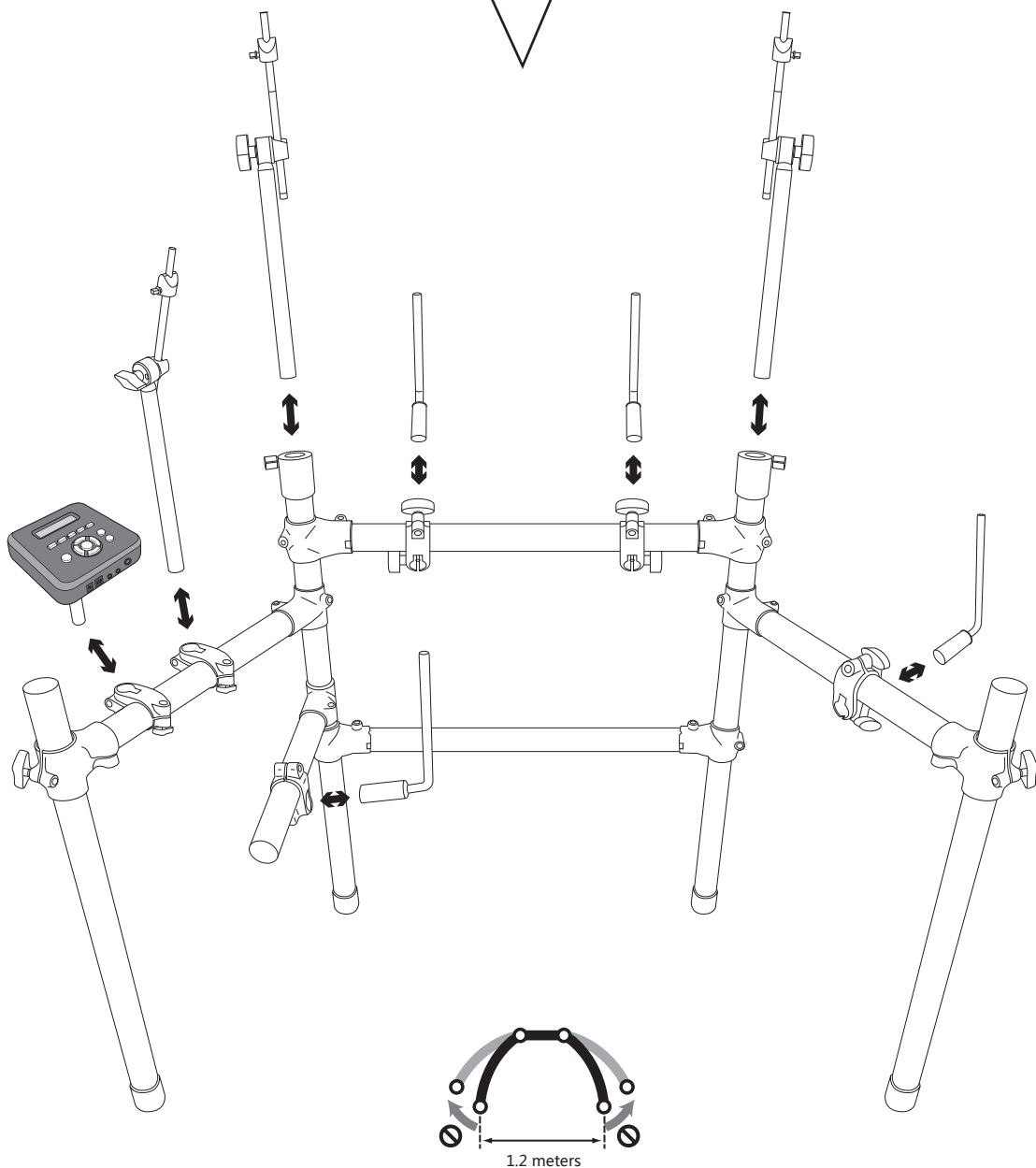

For safety considerations, the expansion width of the bracket should not be greater than 1.2 meters.



09

Installation of strike components

- After inserting the drum disc, tighten the screw to avoid loosening.
- Do not screw the cymbals tightly, leave some space for them to sway up and down.

Install cymbals, Tom drums and army drums in corresponding positions according to the figures.

Attention: Each cymbal, Tom drum and army drum has different functions. It needs to be installed correctly with reference to the identification of accessories.

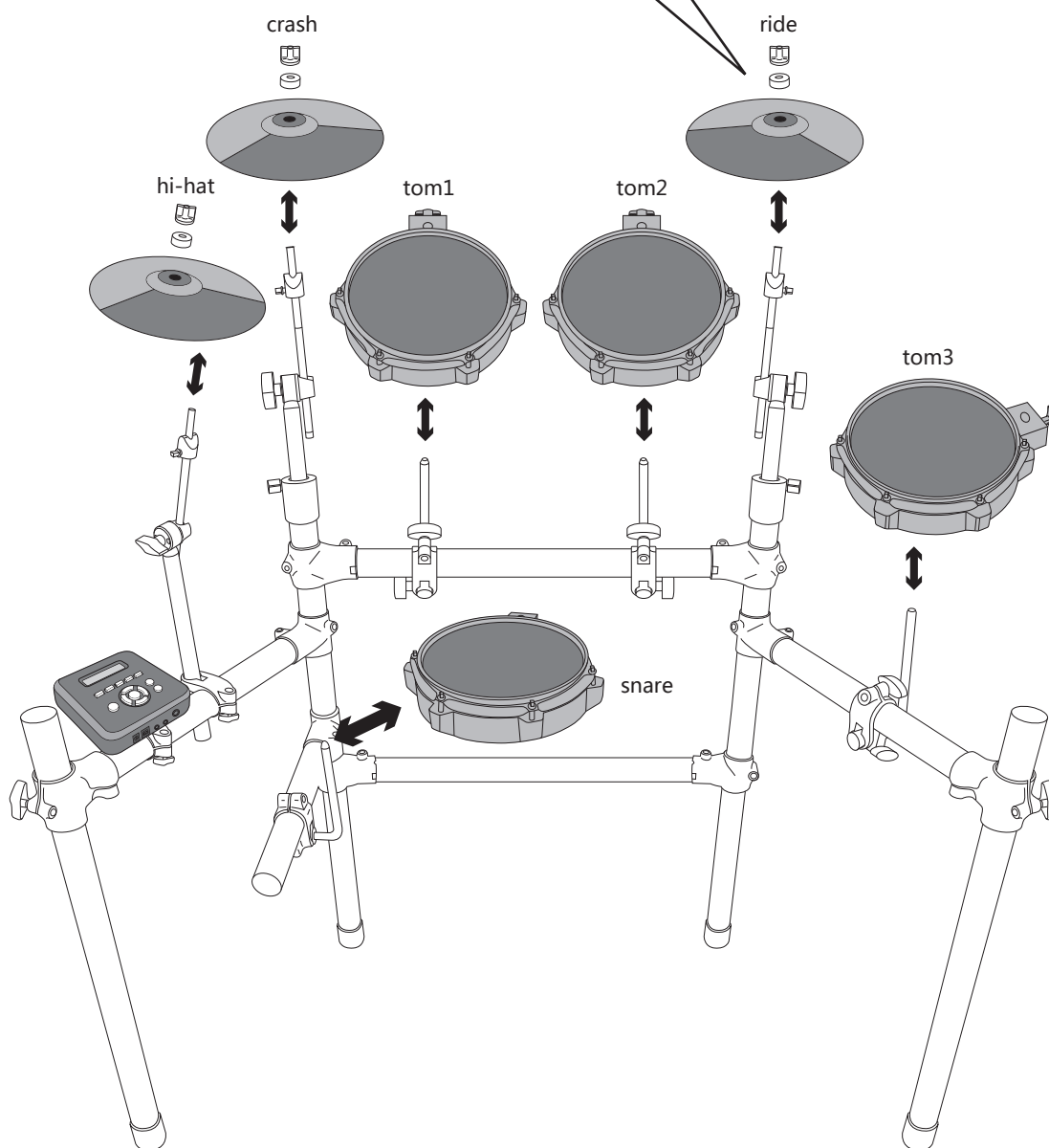



INSTALLATION GUIDE

10

Insert Connection Line

- Please insert the connecting wire in place to avoid bad contact and insert it correctly follow the diagram.

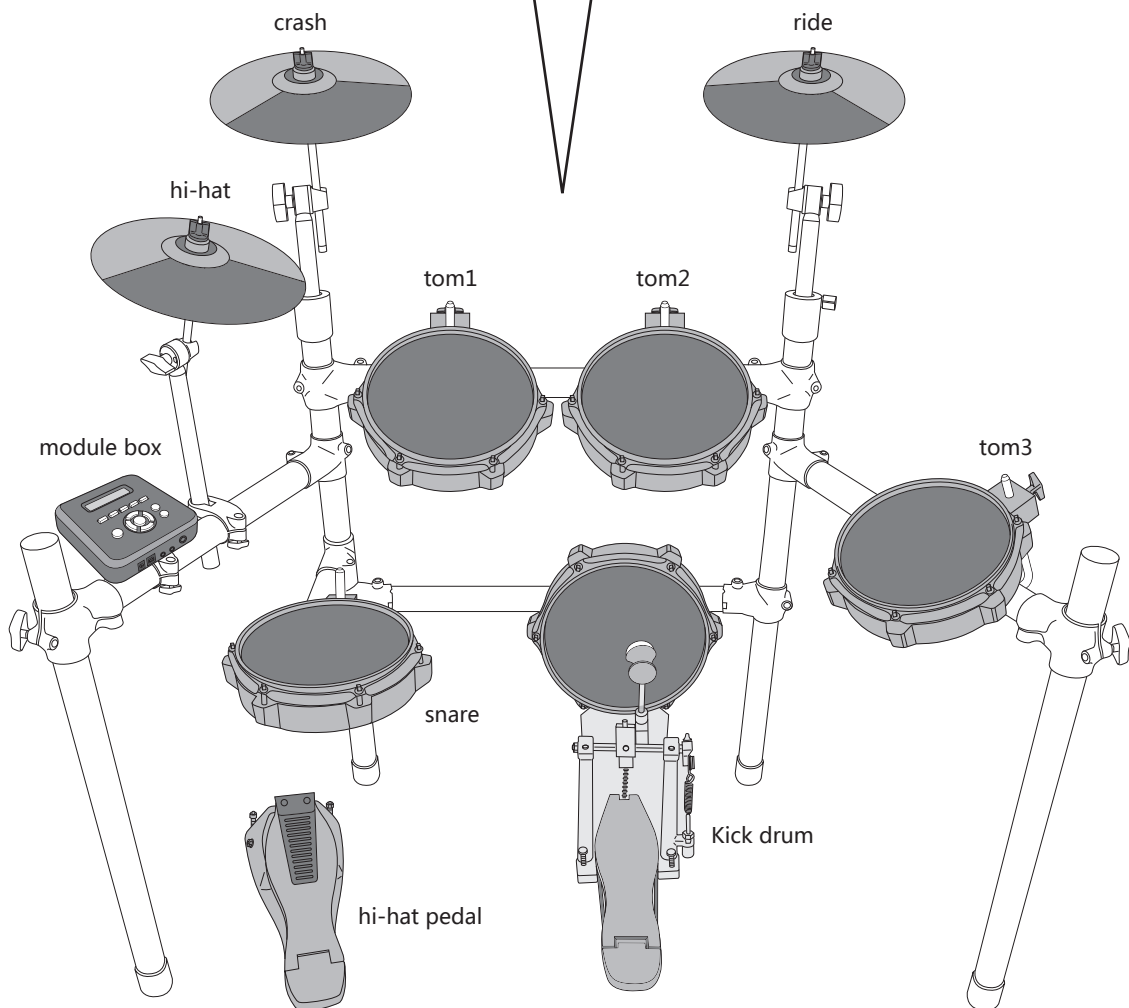
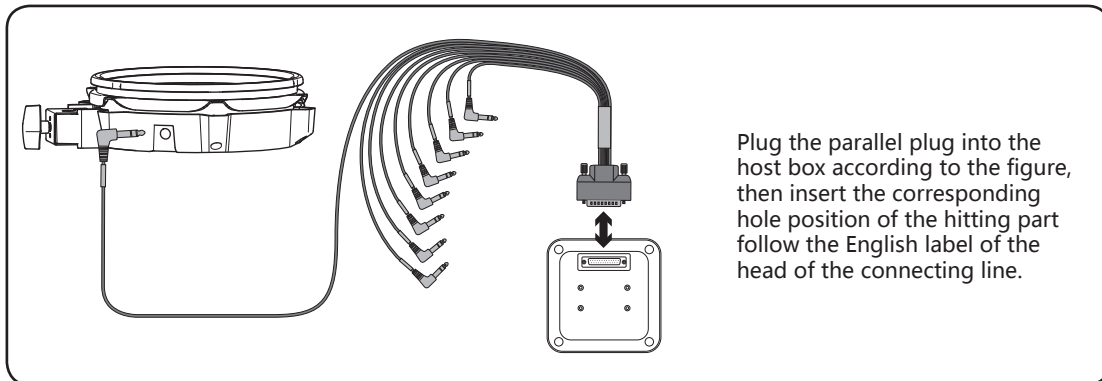
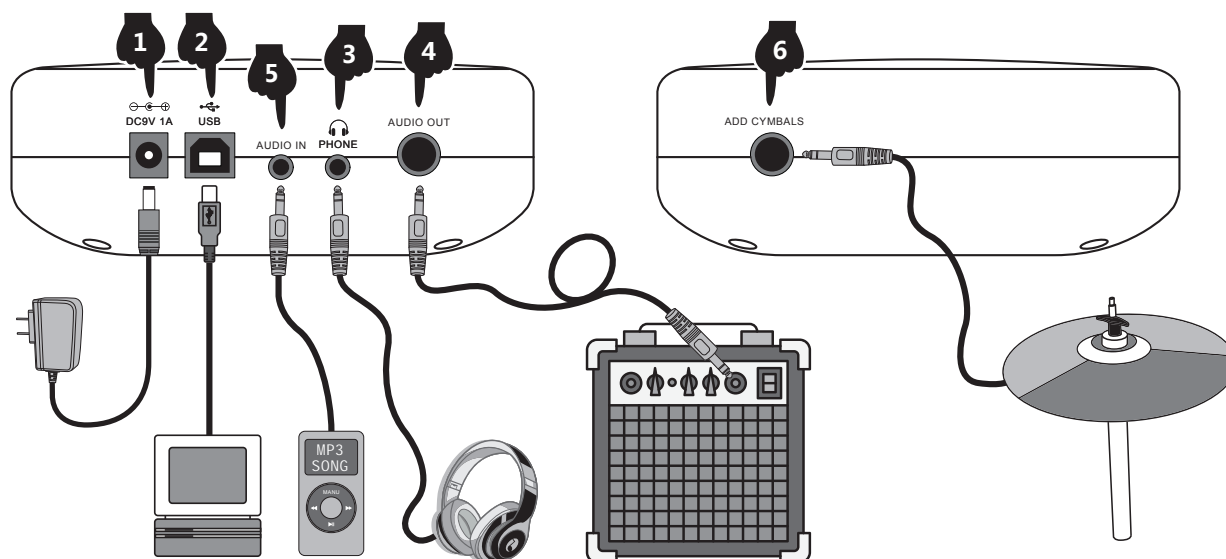



DIAGRAM OF MODULE BOX SOCKET



1 POWER TERMINAL CONNECTION

1. When in use, connect the power terminal according to the diagram, insert the power outlet of the module box at one end and 100-240V household power outlet at the other end. (Fig. 1)
2. If you do not use this product for a long time, please pull out the power plug and keep it properly.

2 USB MIDI PORT

The use of electronic drum MIDI USB interface can interact with music devices with MIDI.

1. Through the pre-installed Music software on computers and mobile phones, we can learn to play, compose music, store and other functions. (Fig. 2)
2. When connected to a computer or mobile phone, the audio output of the device needs to be connected to the audio input socket of the module box in order to synchronize the sound effects on the device. (Fig. 5)

3 EARPHONE PORT

Connecting headphones monitors the details of percussion and does not disturb others when playing without connecting speakers. (Fig. 3)

4 AUDIO OUTPUT PORT

Audio output port can be connected with active speaker (special electronic drum speaker) and large audio equipment. (Fig. 4)

5 AUDIO INPUT PORT

Audio input port can connect the sound source playback device to the module box for playback (such as MP3, mobile phone and other audio signal input). (Fig. 5)

6 ADDING CYMBAL SOCKET

This socket can add a cymbal to facilitate expansion. (Fig. 6)

REMARK !

- To prevent damage to the equipment, make sure to turn down the volume and shut down all the equipment before making any connection.
- Additional cymbals, speakers, headphones and peripherals are all purchased separately. They are not in standard configuration.



OPERATION GUIDE

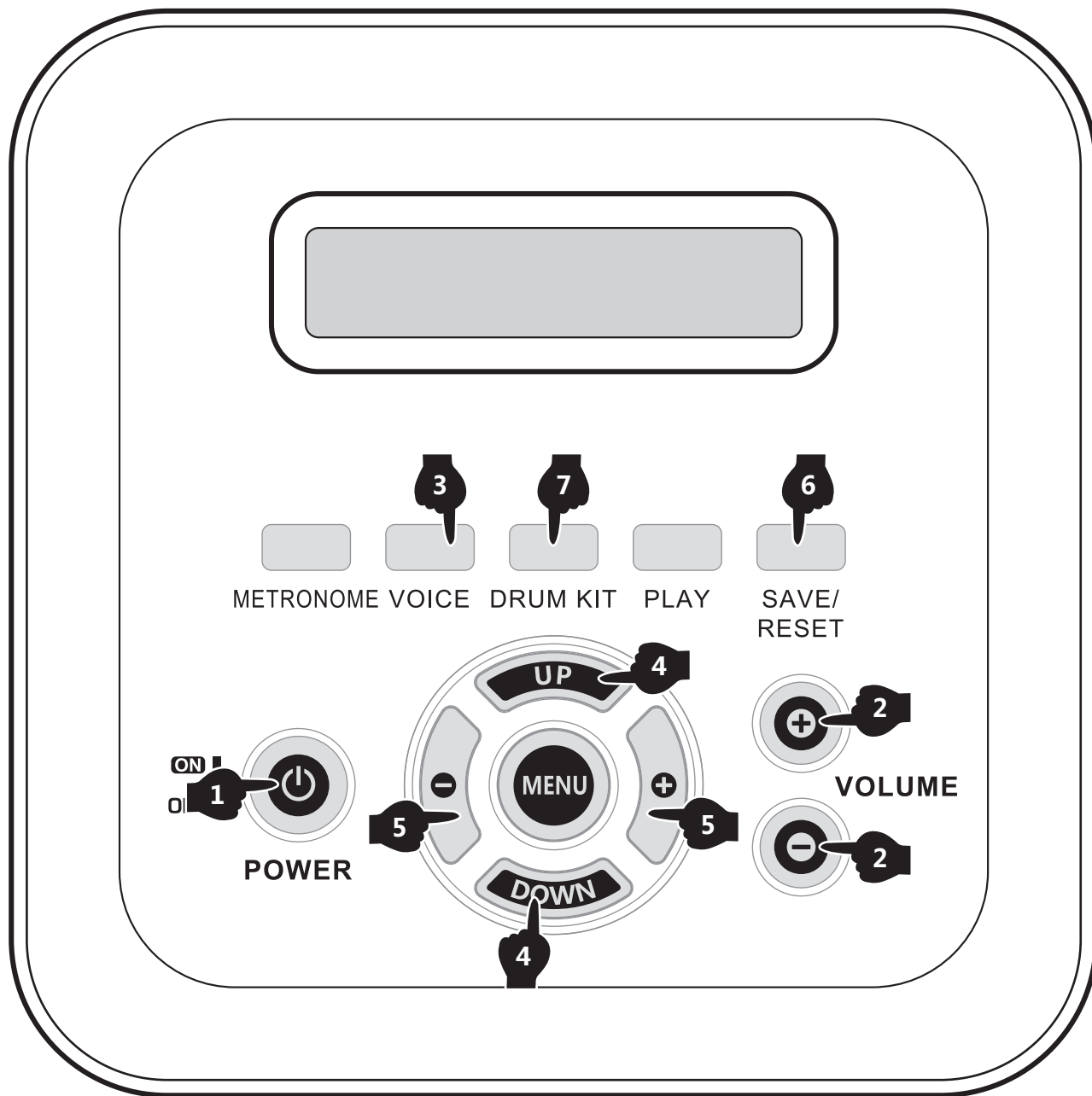

1 POWER ON

1. Turn on the "POWER" switch, and you can enter the playing state. (Fig. 1)

2. Please turn off the power when not in use.

- Processor chips of this product are complex, similar to computer systems. Sometimes they can not respond. Please turn off the power switch and then turn it on to work properly.

2 MASTER VOLUME

Use the "VOLUME +/-" button to increase or decrease the total volume. Please adjust the volume to a satisfactory position. (Fig. 2)



OPERATION GUIDE

3 TIMBRE SELECTION OF DRUM GROUP

1. Press the "VOICE" button, display the screen (Voice), and enter the drum group adjustment mode. (Fig. 3)
2. Using the "UP/DOWN" button, you can choose the following options as an adjustment. (Fig. 4)

Display screen display:

- (KitNum 001-015) : Drum combination timbre selection, a total of 15 sets of preset drum group.
 - (KitVol 000-127) : The volume of drum combination can be adjusted at 128 levels.
 - (Kick 001-015) : Kick drum timbre selection, a total of 15 timbres can be adjusted.
 - (Snare 001-015) : Snare drum timbre selection, a total of 15 timbres can be adjusted.
 - (SnareRim 001-015) : Snare drum edge-click timbre selection, a total of 15 timbres can be adjusted.
 - (Tom1 001-015) : Tom-tom drum 1 timbre selection, a total of 15 timbres can be adjusted.
 - (Tom2 001-015) : Tom-tom drum 2 timbre selection, a total of 15 timbres can be adjusted.
 - (Tom3 001-015) : Tom-tom drum 3 timbre selection, a total of 15 timbres can be adjusted.
 - (Cras 001-015) : Crash cymbal timbre selection, a total of 15 timbres can be adjusted.
 - (CrasRim 001-015) : Crash cymbal edge-click timbre selection, a total of 15 timbres can be adjusted.
 - (Cras2 001-015) : Crash cymbal 2 timbre selection, a total of 15 timbres can be adjusted.
 - (Cras2Rim 001-015) : Crash cymbal 2 edge-click timbre selection, a total of 15 timbres can be adjusted.
 - (Ride 001-015) : Ride cymbal timbre selection, a total of 15 timbres can be adjusted.
 - (RideRim 001-015) : Ride cymbal edge-click timbre selection, a total of 15 timbres can be adjusted.
 - (OpenHat 001-015) : Open hi-hat cymbal timbre selection, a total of 15 timbres can be adjusted.
 - (CloseHat 001-015) : Close the high-hat cymbal timbre selection, a total of 15 timbres can be adjusted.
 - (Pedal 001-015) : Hi-hat pedal timbre selection, a total of 15 timbres can be adjusted.
3. Use the "+/-" button to adjust the parameters of the above options. (Fig. 5)
 4. Press the "SAVE/RESET" button to save the adjusted drum group for later invocation. (Fig. 6)
 5. Press the "DRUM KIT" button to call the previously customized adjusted drum group. (Fig. 7)

4 PLAY THE DRUM

This product has double trigger induction, making the hitting sound effect closer to the original sound drum effect.

1. "Snare drum" can tap drum face and drum edge.
2. "Crash cymbal" and "Ride cymbal" can tap cymbal face and edge, and hold cymbal edge with finger to stop the sound.
3. Different combinations of "Hi-hat cymbal" and "Hi-hat pedal" will change the timbre.
 - Open hi-hat cymbal timbre: Click on the surface of cymbals.
 - Close hi-hat cymbal timbre: Step on the pedal and keep it closed while tapping the cymbal surface.
 - Hi-hat pedal timbre: Step on the pedal and don't hit the cymbal surface.

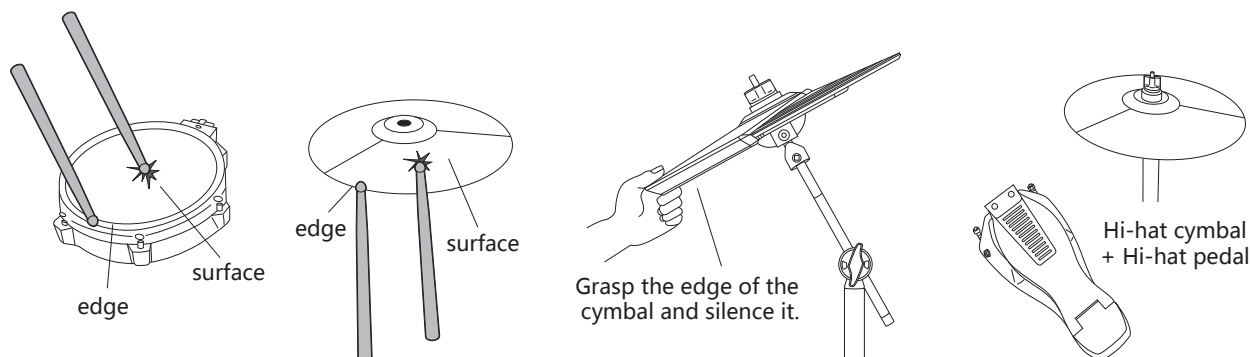



OPERATION GUIDE

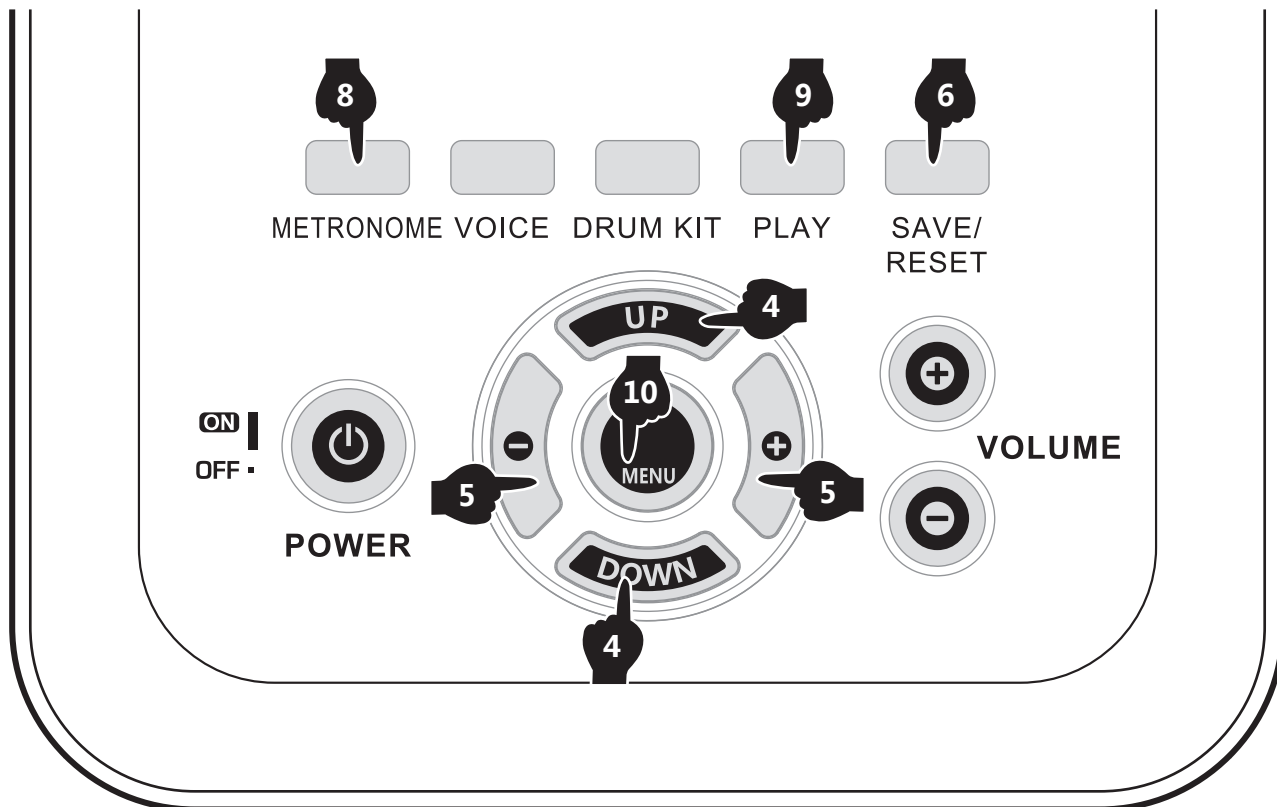

5 METRONOME

1. Press the "METRONOME" button and display (Metro) on the screen. (FIG. 8)
2. Using the "UP/DOWN" button, you can choose the following options as an adjustment. (Fig. 4)

Display screen display:

- (Time 002-016) : Metrometer Speed - A total of 4 levels of standard speed can be adjusted.
 - (Beat 001-009) : Metrometer type - 9 types can be adjusted.
 - (MetroVol 000-127) : Metrometer volume - 128 levels adjustable.
3. Use the "+/-" button to adjust the parameters of the above options. (Fig. 5)
 4. Press the "PLAY" button to start playing the metronome and press again to stop. (Fig. 9)

6 DEMONSTRATION MUSIC PLAYING

1. Press the "MENU" button several times until the display screen (Song) enters the sub-option music mode. (FIG. 10)
2. Using the "UP/DOWN" button, you can choose the following options as an adjustment. (Fig. 4)

Display screen display:

- (Num 001-030): Music Selection - A total of 30 built-in pieces.
 - (GmVol 000-127): Chord accompaniment volume - 128 levels adjustable.
 - (DmVol 000-127: Volume of drum group - 128 levels adjustable.
3. Use the "+/-" button to adjust the parameters of the above options. (Fig. 5)
 4. Press the "PLAY" button to start playing the music and press again to stop. (Fig. 9)



OPERATION GUIDE

7 PLAY SPEED

In the mode of demonstration music or metronome playing, adjusting speed can control the speed of demonstration music and metronome playing.

1. Press the "MENU" button several times until the display screen (Tempo) enters the sub-option playback speed mode. (FIG. 10)

Display screen display:

- (Speed 030-250) : Play speed selection - 221 level speed adjustable.
2. Use the "+/-" button to adjust the parameters. The adjustment range (Speed 030-250) is 221 levels. (Fig. 5)

8 DRUM DISC SENSITIVITY ADJUSTMENT

1. Press the "MENU" button several times until the display screen displays (Sensity) and enter the sensitivity adjustment mode of the sub-option components. (FIG. 10)
2. Hit the drum tray you want to adjust with a drum stick.
3. Using the "UP/DOWN" button, you can choose the following options as adjustments. (Fig. 4)

Display screen display:

- (PadSen 001-006) : Strike surface sensitivity - 6 levels adjustable.
 - (RimSen 001-006) : Strike Side Ring Sensitivity - 6 levels adjustable.
 - (HHCLevel 001-003) : Hi-hat cymbal sensitivity-three levels adjustable.
 - (HHCSen 001-003) : Hi-hat cymbal closure speed-three levels adjustable.
 - (Threshold 001-032) : Trigger threshold - 32 levels adjustable.
 - (XTalk 001-032) : Crosstalk threshold - 32 levels adjustable.
 - (Retrigger 001-032) : Repeated trigger - 32 levels adjustable.
 - (Velocity 001-003) : Force Curve - 3 levels adjustable.
 - (Volume 000-127) : Drum disc volume - 128 levels adjustable.
4. With the "+/-" button, the parameters of the above options can be adjusted according to the custom. (Fig. 5)
 5. Press the "SAVE/RESET" button to save the adjusted parameters for future use. (Fig. 6)

9 REVERBERATION/EQUILIBRIUM OPTIMIZATION

1. Press the "MENU" button several times until the display screen displays (Utility) and enter the sub-option reverberation/balancing optimization mode. (FIG. 10)
2. Using the "UP/DOWN" button, you can choose the following options as an adjustment. (Fig. 4)

Display screen display:

- (RevType 000-005) : Reverberation Category - altogether 6 levels adjustable.
 - (Revlevel 000-127) : Reverberation size - 128 levels can be adjusted, when the value is "000", the reverberation is closed.
 - (EQ_H 000-127) : High Frequency Equilibrium - 128 levels adjustable.
 - (EQ_L 000-127) : Low Frequency Equilibrium - 128 levels adjustable.
3. Use the "+/-" button to adjust the parameters of the above options. (Fig. 5)
 4. Press "SAVE/RESET" button to save the adjusted parameters for future use. (Fig. 6)

10 FACTORY RESET

Press the "SAVE/RESET" button for more than 3 seconds to restore the factory settings. (Fig. 6)



APPENDIX

Timbre

KICK

- 1 Acoustic Kick
- 2 Military Kick
- 3 Original Kick
- 4 Funk Kick
- 5 Standard Kick
- 6 Dance Kick
- 7 Rock Kick
- 8 Jazz Kick
- 9 808 Kick
- 10 Songo Kick
- 11 909 Kick
- 12 Fairfax Kick
- 13 Dancehall Kick 3
- 14 70's Kick
- 15 Clean Kick

SNARE

- 16 Acoustic Snare
- 17 Military Snare
- 18 Original Snare
- 19 Funk Snare
- 20 Standard Snare
- 21 Dance Snare
- 22 Rock Snare
- 23 Jazz Snare
- 24 808 Snare1
- 25 Songo Snare
- 26 909 Snare
- 27 Fairfax Snare
- 28 Dancehall Snare
- 29 70's Snare
- 30 Clean Snare
- 31 Acoustic Snare Rim
- 32 Military Snare Rim
- 33 Original Snare Rim
- 34 Funk Snare Rim
- 35 Standard Snare Rim
- 36 Dance Snare Rim
- 37 Rock Snare Rim
- 38 Jazz Snare
- 39 808 Snare Rim
- 40 Songo Snare Rim
- 41 909 Snare Rim
- 42 Fairfax Snare Rim
- 43 Dancehall Snare Rim
- 44 70's Snare Rim
- 45 Clean Snare Rim

Tom

- 46 Acoustic Tom1
- 47 Military Tom1
- 48 Original Tom1
- 49 Funk Tom1
- 50 Standard Tom1
- 51 Dance Tom1
- 52 Rock Tom1
- 53 Jazz Tom1
- 54 808 Tom1
- 55 Songo Tom1
- 56 909 Tom1
- 57 Fairfax Tom1
- 58 Dancehall Tom1
- 59 70's Tom1
- 60 Clean Tom1
- 61 Acoustic Tom2
- 62 Military Tom2
- 63 Original Tom2
- 64 Funk Tom2
- 65 Standard Tom2
- 66 Dance Tom2
- 67 Rock Tom2
- 68 Jazz Tom2
- 69 808 Tom2
- 70 Songo Tom2
- 71 909 Tom2
- 72 Fairfax Tom2
- 73 Dancehall Tom2
- 74 70's Tom2
- 75 Clean Tom2
- 76 Acoustic Tom3
- 77 Military Tom3
- 78 Original Tom3
- 79 Funk Tom3
- 80 Standard Tom3
- 81 Dance Tom3
- 82 Rock Tom3
- 83 Jazz Tom3
- 84 808 Tom3
- 85 Songo Tom3
- 86 909 Tom3
- 87 Fairfax Tom3
- 88 Dancehall Tom3
- 89 70's Tom3
- 90 Clean Tom3

CRASH

- 91 Acoustic Crash1
- 92 Military Crash1
- 93 Original Crash1
- 94 Standard Crash1
- 95 Funk Crash1
- 96 Dance Crash1
- 97 Rock Crash1
- 98 Jazz Crash1
- 99 808 Crash1
- 100 Songo Crash1
- 101 909 Crash1
- 102 Fairfax Crash1
- 103 Dancehall Crash1
- 104 70's Crash1
- 105 Clean Crash1
- 106 Acoustic Crash1 Rim
- 107 Military Crash1 Rim
- 108 Original Crash1 Rim
- 109 Standard Crash1 Rim
- 110 Funk Crash1 Rim
- 111 Dance Crash1 Rim
- 112 Rock Crash1 Rim
- 113 Jazz Crash1 Rim
- 114 808 Crash1 Rim
- 115 Songo Crash1 Rim
- 116 909 Crash1 Rim
- 117 Fairfax Crash1 Rim
- 118 Dancehall Crash1 Rim
- 119 70's Crash1 Rim
- 120 Clean Crash1 Rim
- 121 Acoustic Crash2
- 122 Military Crash2
- 123 Original Crash2
- 124 Standard Crash2
- 125 Funk Crash2
- 126 Dance Crash2
- 127 Rock Crash2
- 128 Jazz Crash2
- 129 808 Crash2
- 130 Songo Crash2
- 131 909 Crash2
- 132 Fairfax Crash2
- 133 Dancehall Crash2
- 134 70's Crash2
- 135 Clean Crash2
- 136 Acoustic Crash2 Rim
- 137 Military Crash2 Rim

- 138 Original Crash2 Rim
- 139 Standard Crash2 Rim
- 140 Funk Crash2 Rim
- 141 Dance Crash2 Rim
- 142 Rock Crash2 Rim
- 143 Jazz Crash2 Rim I
- 144 808 Crash2 Rim I
- 145 Songo Crash2 Rim
- 146 909 Crash2 Rim
- 147 Fairfax Crash2 Rim
- 148 Dancehall Crash2 Rim
- 149 70's Crash2 Rim
- 150 Clean Crash2 Rim

HI-HAT

- 181 Acoustic Hi-hat Open
- 182 Military Hi-hat Open
- 183 Original Hi-hat Open
- 184 Standard Hi-hat Open
- 185 Funk Hi-hat Open
- 186 Dance Hi-hat Open
- 187 Rock Hi-hat Open
- 188 Jazz Hi-hat Open
- 189 808 Hi-hat Open
- 190 Songo Hi-hat Open
- 191 909 Hi-hat Open
- 192 Fairfax Hi-hat Open
- 193 Dancehall Hi-hat Open
- 194 70's Hi-hat Open
- 195 Clean Hi-hat Open
- 196 Acoustic Hi-hat Close
- 197 Military Hi-hat Close
- 198 Original Hi-hat Close
- 199 Standard Hi-hat Close
- 200 Funk Hi-hat Close
- 201 Dance Hi-hat Close
- 202 Rock Hi-hat Close
- 203 Jazz Hi-hat Close
- 204 808 Hi-hat Close
- 205 Songo Hi-hat Close
- 206 909 Hi-hat Close
- 207 Fairfax Hi-hat Close
- 208 Dancehall Hi-hat Close
- 209 70's Hi-hat Close
- 210 Clean Hi-hat Close
- 211 Acoustic Hi-hat Pedal
- 212 Military Hi-hat Pedal
- 213 Original Hi-hat Pedal
- 214 Standard Hi-hat Pedal
- 215 Funk Hi-hat Pedal
- 216 Dance Hi-hat Pedal
- 217 Rock Hi-hat Pedal
- 218 Jazz Hi-hat Pedal
- 219 808 Hi-hat Pedal
- 220 Songo Hi-hat Pedal
- 221 909 Hi-hat Pedal
- 222 Fairfax Hi-hat Pedal
- 223 Dancehall Hi-hat Pedal
- 224 70's Hi-hat Pedal
- 225 Clean Hi-hat Pedal

RIDE

- 151 Acoustic Ride
- 152 Military Ride
- 153 Original Ride
- 154 Standard Ride
- 155 Funk Ride
- 156 Dance Ride
- 157 Rock Ride
- 158 Jazz Ride
- 159 808 Ride
- 160 Songo Ride
- 161 909 Ride
- 162 Fairfax Ride
- 163 Dancehall Ride
- 164 70's Ride
- 165 Clean Ride
- 166 Acoustic Ride Rim
- 167 Military Ride Rim
- 168 Original Ride Rim
- 169 Standard Ride Rim
- 170 Funk Ride Rim
- 171 Dance Ride Rim
- 172 Rock Ride Rim
- 173 Jazz Ride Rim
- 174 808 Ride Rim
- 175 Songo Ride Rim
- 176 909 Ride Rim
- 177 Fairfax Ride Rim
- 178 Dancehall Rim
- 179 70's Ride Rim
- 180 Clean Ride Rim

Drum combination timbre

- | | | | | |
|------------|------------|--------|------------|--------------|
| 1 Acoustic | 4 Funk | 7 Rock | 10 Songo | 13 Dancehall |
| 2 Military | 5 Standard | 8 Jazz | 11 909 | 14 70's |
| 3 Original | 6 Dance | 9 808 | 12 Fairfax | 15 Clean |

User drum group

- 16 Kit Num

Demonstration music

- | | | | | | |
|-----------------------|------------|---------------|------------------|-----------------|-------------|
| 1 Drum & Bass | 6 Country1 | 11 March | 16 Pop Rock | 21 Swing1 | 26 Swing3 |
| 2 Blues | 7 R & B | 12 Pop Bossa | 17 Country Blues | 22 Swing2 | 27 Jazz2 |
| 3 Jazz1 | 8 Pop1 | 13 Fusion | 18 Pop4 | 23 Country2 | 28 Country3 |
| 4 Rock1 | 9 Pop2 | 14 Dance | 19 Scotland | 24 Modern Pop | 29 Rock2 |
| 5 Electroponic & Funk | 10 Pop3 | 15 Jazz Swing | 20 Latin Jazz | 25 Electroponic | 30 Pop5 |



PRODUCT MAINTENANCE

Careful maintenance and protection of the product, to extend the service life of the product, reduce the fault has a very important role.

1 AVOID HEATING, DAMPNES OR DIRECT SUNLIGHT

Do not over expose the product to direct sunlight, or place it near air conditioning or extremely hot place.

2 DO NOT USE NEAR THE TV OR RADIO

This product may cause video or audio interference to the reception of TV and radio. If this happens, the product should be removed from the TV or radio.

3 NO DILUENTS OR SIMILAR CHEMICALS SHOULD BE USED FOR CLEANING

Clean the product with a soft cloth wetted with weak water solution and neutral detergent. Soak the cloth in a solution and wring it dry until it approaches drying.

4 DO NOT SHAKE, AVOID COLLISION

When moving, the product should be handled carefully and lightly. Violent vibration and collision are strictly prohibited in order to avoid damage to the shell or internal electronic components.



SAFETY PRECAUTIONS

POWER SUPPLY

This product can be powered by standard indoor wall sockets. Please only use the power cord specified in this product. When not in use, please turn off the power supply. When not in use for a long time, pull out the power cord and keep it properly.

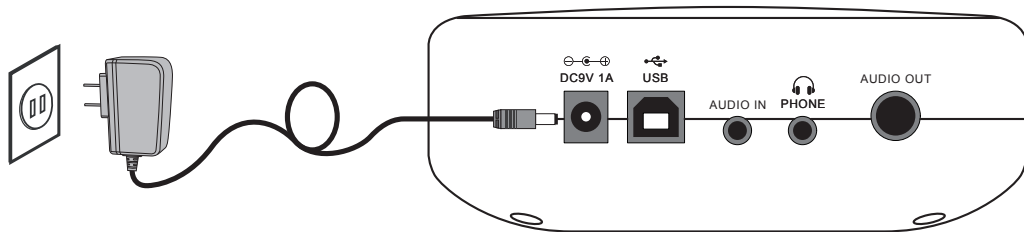

SIGN

To ensure that you use this product safely and correctly, to prevent harm to users and others and financial damage, this manual and products are marked with a series of safety signs. The various signs and their meanings are as follows:

WARNING

This sign indicates that there is a potential risk of death or serious injury if this mark is ignored and the product is mishandled.

BE CAREFUL

This sign indicates that there is a potential danger of injury to personnel or other financial damage if this sign is ignored and the product is operated incorrectly.

EXAMPLE OF LOGO



This triangle sign (Δ) indicates what users should pay attention to. (The left example is careful shocks)



A circular sign (\odot) with an oblique line indicates prohibitions. The icons in or beside the logo indicate the contents specifically prohibited. (The example on the left is no disassembly)



The round black bottom sign (\odot) indicates what must be observed. The diagrams in this sign indicate the contents of the specific matters that must be observed. (The example on the left is that the power plug must be pulled out of the socket)



SAFETY PRECAUTIONS

WARNING

Smoke, odor, overheating

When the product smokes, smells or overheats, there is a danger of fire and electric shock when it is used continually. In case of the above situation, the following operations should be performed immediately:

1. Turn off the power supply.
2. Pull the plug out of the power outlet.
3. Contact your dealer.

Power cord

1. The improper use of power cord may cause fire and electric shock. The following precautions must be observed:
 - The special power cord designated for this product must be used.
 - The AC power supply with output voltage within the rated voltage range for household use must be used.
 - Do not overload power sockets and extension lines.
2. The improper treatment of power line will lead to its damage or breakage, which will cause fire and electric shock hazards. The following precautions must be observed:
 - Do not place or heat heavy objects on power lines.
 - Do not attempt to alter or bend the power cord too much.
 - Do not twist or pull the power cord.
 - If the power cord or plug is damaged, please replace the same type of power cord.
3. Do not touch the power cord and plug with wet hands, otherwise there is a danger of electric shock.
4. Please use the power cord where the water will not splash. Water is in danger of causing fire and electric shock.
5. Never place vases or any other container containing water on this product. Water is dangerous of causing fire and electric shock.
6. Do not allow minors to unplug and touch power lines or connection boards. Minors have no common sense of electricity safety, which may cause electric shock.

BE CAREFUL

The improper use of power cord may cause fire and electric shock. The following precautions must be observed:

- Never put the power cord near the oven or other heat source.
- Do not pull the cable when pulling out of the power socket. The main body of the plug must be grasped.
- The power cord plug must be inserted in the socket to the end.
- Make sure the power supply is off before connecting or disconnecting it.
- When thunderstorms occur or before traveling or other long-term departure, disconnect the power cord from the wall outlet.
- At least once a year, remove the power cord from the wall outlet and clean the dust accumulated around the plug.

Do not burn this product

Do not put this product in the fire, otherwise it will lead to product combustion and explosion of internal electronic components, which will cause fire and personnel injury.

Water and foreign bodies

Water, other liquids and (metal sheets, etc.) entering this product are in danger of causing fire and electric shock. In case of the above situation, the following operations shall be performed immediately:

1. Turn off the power supply.
2. If you are using a power cord for power supply, unplug it from the wall outlet.
3. Contact your distributor.

Disassembly and transformation

Do not disassemble or transform the product in any way, otherwise there is a risk of electric shock, scald or other personal injury. All internal inspection, adjustment and maintenance operations should be entrusted to your distributor.



SAFETY PRECAUTIONS

Falling or colliding

If the product falls or is damaged by strong impact, it will be in danger of causing fire and electric shock. In case of the above situation, the following operations shall be performed immediately:

1. Turn off the power supply.
2. If you are using a power cord for power supply, you need to unplug it from the wall outlet.
3. Contact your distributor.



Plastic bag

Do not let anyone put plastic bags for this product on his head or in his mouth. Otherwise, there is a risk of asphyxia. Families with young children should pay special attention to it.



Keep a distance from the product and the bracket

Climbing the bracket is dangerous of overturning or damage. Families with young children should pay special attention to it.



Put

Avoid placing the product on an uneven surface or any other unstable place. Otherwise, it will cause the product to fall down, which will lead to the risk of injury.



Product Mobility

Before moving this product, you must unplug the power cord plug from the wall outlet and pull out all other cables and connecting wires. Otherwise, it will lead to damage of power or connection wires, resulting in fire and electric shock.



clean

Before cleaning this product, you must unplug the power cord plug from the wall outlet, otherwise there is a risk of fire and electric shock.



Jack

The socket of this product can only be connected to the designated equipment and devices. Connecting non-designated equipment or devices is dangerous of causing fire and electric shock.



Location selection

It should be avoided to place the product in the following places, otherwise there is a risk of fire and electric shock.

- High temperature or dusty places.
- Kitchen or other places with lampblack.
- Where the product is exposed to direct sunlight, or any other place where the product will produce high temperature.



Volume

Don't play music long and loud. Pay special attention when using headphones. Excessive volume can damage your hearing.



Heavy

Do not place heavy objects on this product. Otherwise, the top of the product will be overweight, causing the product to overturn or drop objects on it, which will lead to the risk of injury.



Correct assembly of scaffolds

The incorrect assembly of the bracket may overturn, causing the product to fall off and posing a risk of injury to personnel. Therefore, it must be assembled according to the instructions in the attached installation guide to ensure that the product is properly mounted on its bracket.





WARRANTY CARD

Warranty rules

1. Faults arising from normal use of this product can be guaranteed free of charge for _____ days from the date of purchase.
2. Failure occurs during the warranty period. This warranty card and shopping ticket must be presented during maintenance.
3. In the following cases, no free warranty will be provided:
 - Damage caused by improper use by users.
 - Fault damage caused by irresistible factors such as fire, flood, earthquake and lightning strike.
 - Failure caused by unauthorized self-disassembly.
4. After exceeding the warranty period, the company is responsible for maintenance, but it needs to charge a cost fee.

Seller: _____

Address: _____

Telephone: _____

Maintenance record

Date	Maintenance record	Repairman