

*Donner*

**DED-100**

ELECTRONIC DRUM

**INSTRUCTION MANUAL**

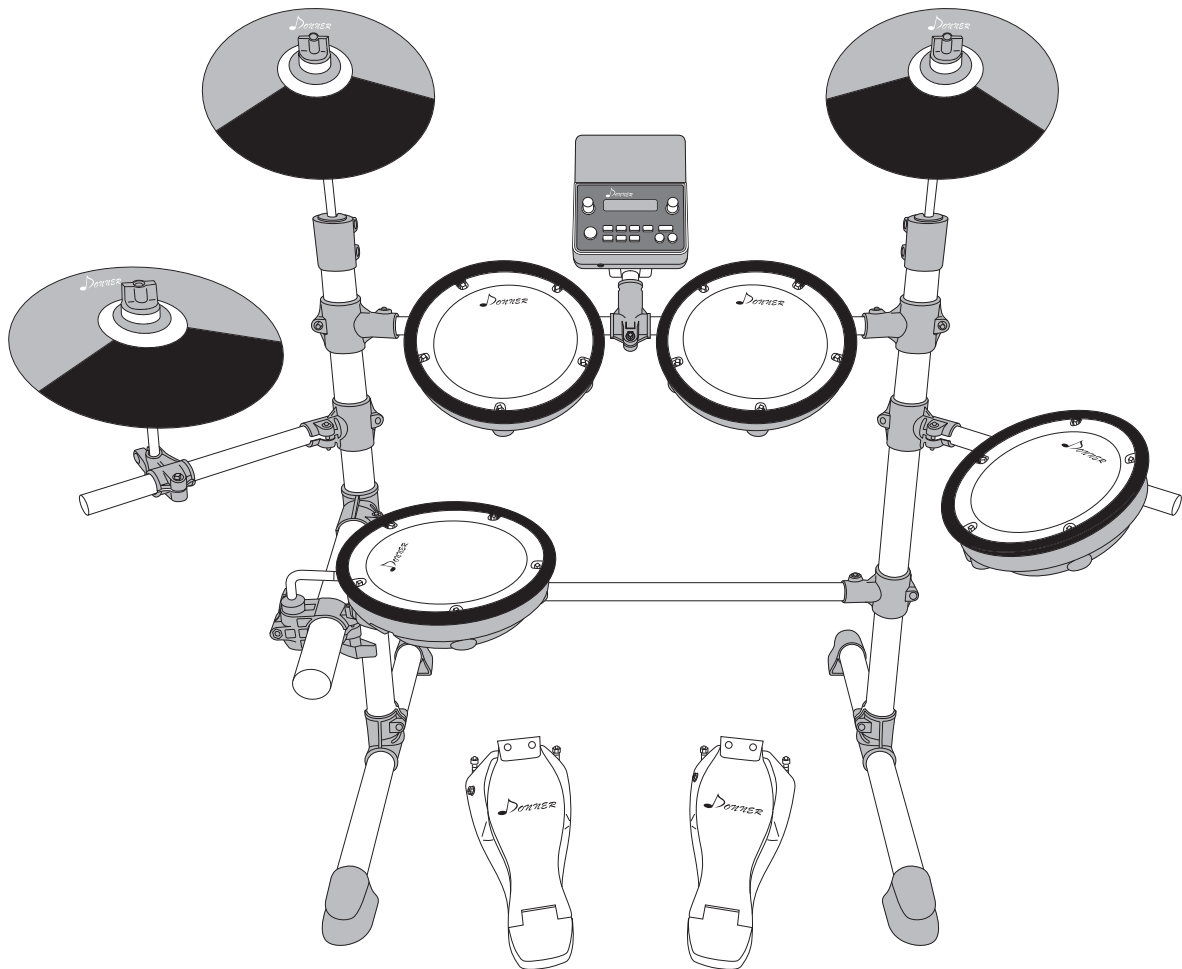

This product is subject to change without prior notice

Dear Customer,

Thank you for ordering from Donner! This is Donner Customer Service Team.

After received the package, please test and see if there's any problem. Any problem please feel free to contact us by amazon (the order page) or the email address below.



**Welcome to Donner**

**Gmail:** [donnerdeal@gmail.com](mailto:donnerdeal@gmail.com)

**Website:** <https://www.donnerdeal.com/>

Thank you again for choosing Donner! Please enjoy making your own music.

Best regards  
Donner Customer Service Team.

## **FUNCTION INTRODUCTION**

- Six layers of force are adopted to make it closer to the original drum playing.
- Supports double triggers with edge-hit response.
- Fifteen sets of drum group and one sets of custom drum group.
- Number of timbres 195 and GM standard timbre library. (song use)
- Thirty songs, adjustable GM volume and drum volume .(for learning)
- Effect: reverberation type 0-5, two-band EQ equalization.
- Supporting adjustment of sensitivity parameters of drum discs.
- Speed control: 30-250 beats/minute.
- Metronome: 9 kinds.
- Other functions: customize settings, store and restore factory settings.
- Interpoles: USB MIDI, headphones, audio input, audio output.



<b>FUNCTION INTRODUCTION</b>	<b>1</b>
<b>CATALOG</b>	<b>2</b>
<b>INSTALLATION GUIDE</b>	<b>3</b>
Check the attached items	3
Pipe fitting	4
Drum cannula	4
Mounting bracket and drum plate	5
Install the cymbal, control box and place the pedal	6
Insert the connecting wire of drum and cymbal	7
<b>DIAGRAM OF MODULE BOX SOCKET</b>	<b>8</b>
<b>POWER TERMINAL CONNECTION</b>	<b>8</b>
USB MIDI PORT	8
AUDIO OUTPUT PORT	8
AUDIO INPUT PORT	8
EARPHONE PORT	8
<b>OPERATION GUIDE</b>	<b>9</b>
POWER ON	9
MASTER VOLUME	9
PLAY THE DRUM	9
TIMBRE SELECTION OF DRUM GROUP	10
METRONOME	10
DEMONSTRATION MUSIC PLAYING	11
PLAY SPEED	11
DRUM DISC SENSITIVITY ADJUSTMENT	12
REVERBERATION/EQUILIBRIUM OPTIMIZATION	12
PERCUSSION RECORDING	12
FACTORY RESET	12
<b>APPENDIX</b>	<b>13</b>
Timbre	13
Drum combination timbre	13
User drum group	13
Demonstration music	13
<b>PRODUCT MAINTENANCE</b>	<b>14</b>
<b>SAFETY PRECAUTIONS</b>	<b>15</b>
<b>WARRANTY CARD</b>	<b>18</b>



# INSTALLATION GUIDE

## REMARK !

- Please follow the instructions and read the "safety precautions" in the User Manual carefully before using it.
- This product needs adult to install, do not let the minor install it independently.

## 01

### Check the attached items

- After opening the package, please check whether it contains all the items immediately. If there are any omissions, please contact your dealer.



Sound module

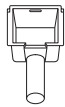

Module bracket

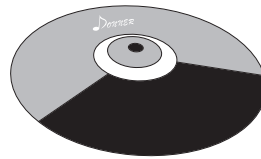

Hi hat

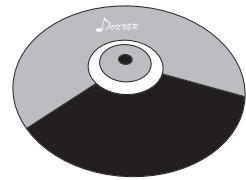

Ride

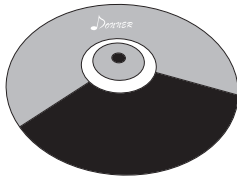

Crash



Cymbal long pole  
( 2pcs )



Cymbal short pole

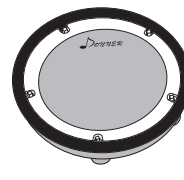

Tom-tom  
(3pcs)

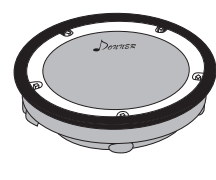

Snare

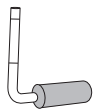

Snare Support rod



Plastic head screw  
( 3pcs )



Hi hat pedal



Kick pedal

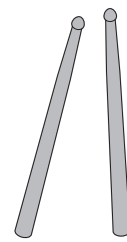

drum stick

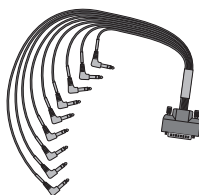

Signal Connection Line



Audio input line

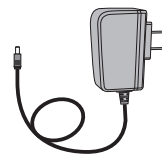

power adapter

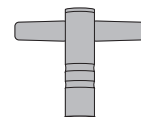

Drum key



# INSTALLATION GUIDE

## 02

### Pipe fitting

- The pipe fittings are located in an independent small package in the packing box.

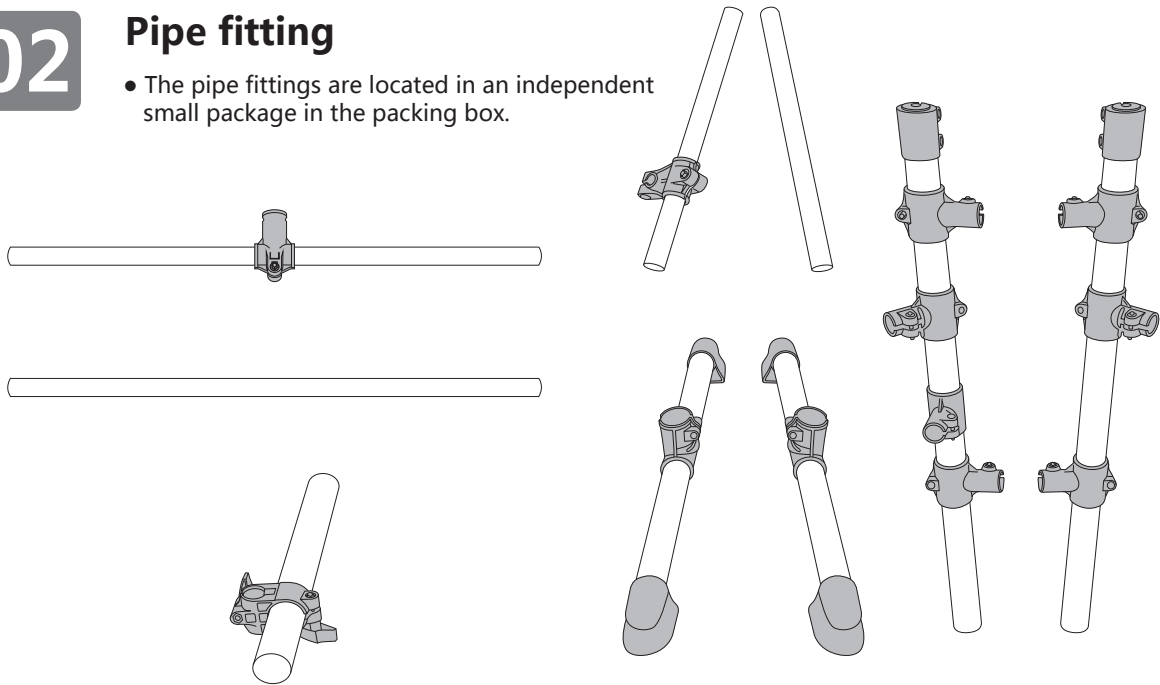

## 03

### Drum cannula

- please operate carefully during installation, and be careful not to pinch your fingers.

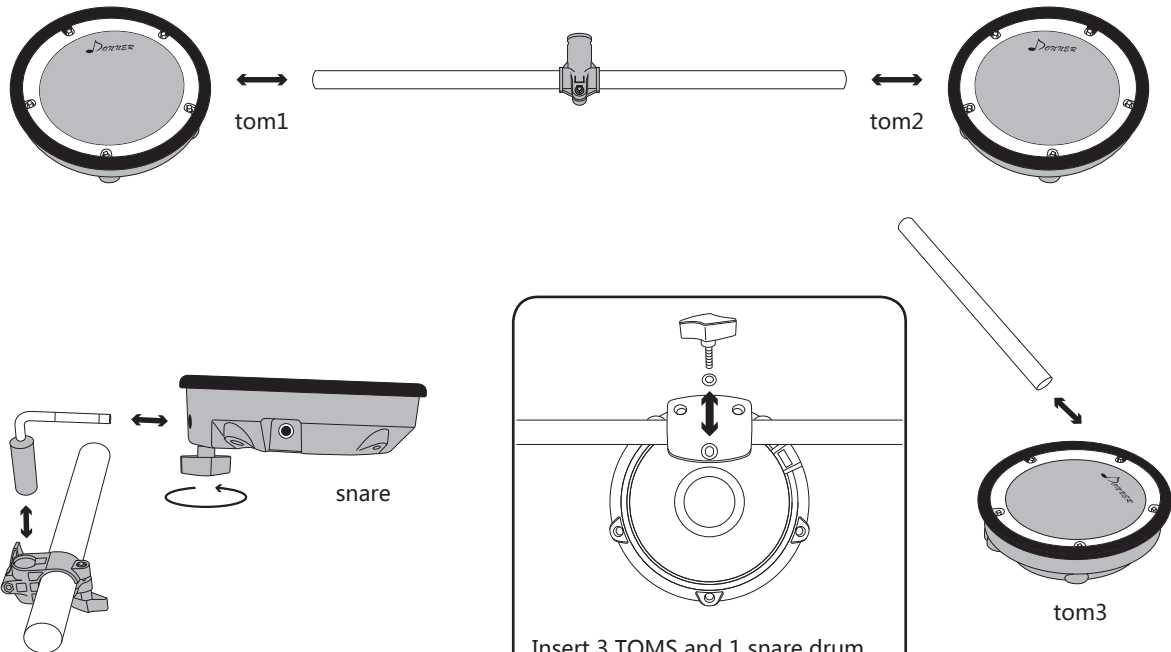

Insert 3 TOMS and 1 snare drum into the pipe respectively as shown in the figure, and lock in the plastic head fastening screw.



## 04

### Mounting bracket and drum plate

- The bracket should be inserted in place and the screw should be tightened to avoid falling.

Insert the bracket and drum into corresponding positions, and then tighten the screws.

Note: tom and snare drum have different functions. It is necessary to install them correctly with reference to the accessory identification!

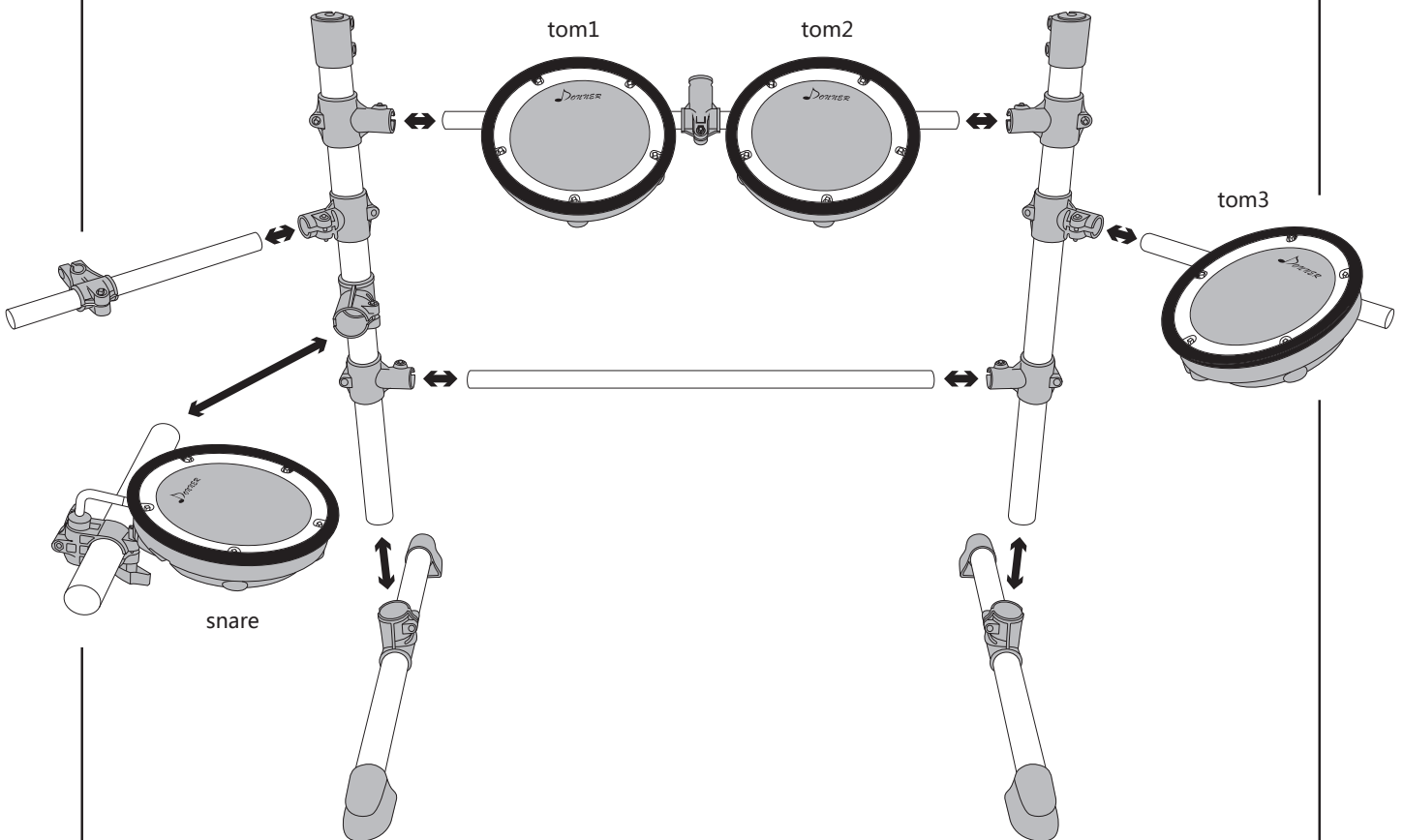
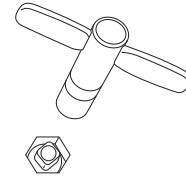



# INSTALLATION GUIDE

## 05

### Install the cymbal, control box and place the pedal

- Do not tighten the cymbal, leave some space for it to shake up and down.

Install the cymbal and control box on the bracket as shown in the figure

Note: each cymbal has different functions. It needs to refer to the accessory identification for correct installation!

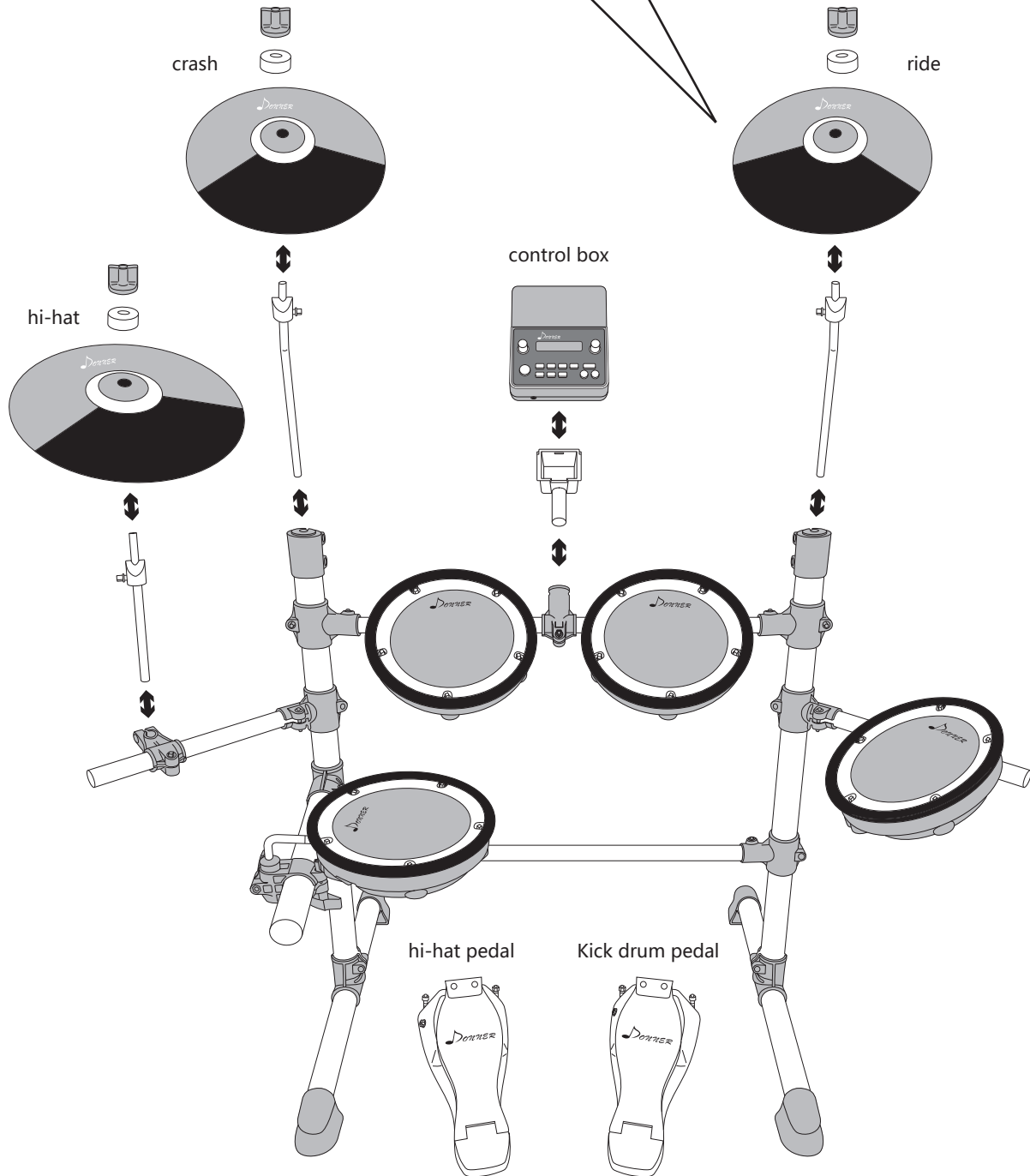
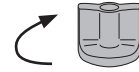



## 06

### Insert the connecting wire of drum and cymbal

- Please insert the connecting wire in place to avoid poor contact and insert it correctly as shown in the figure.

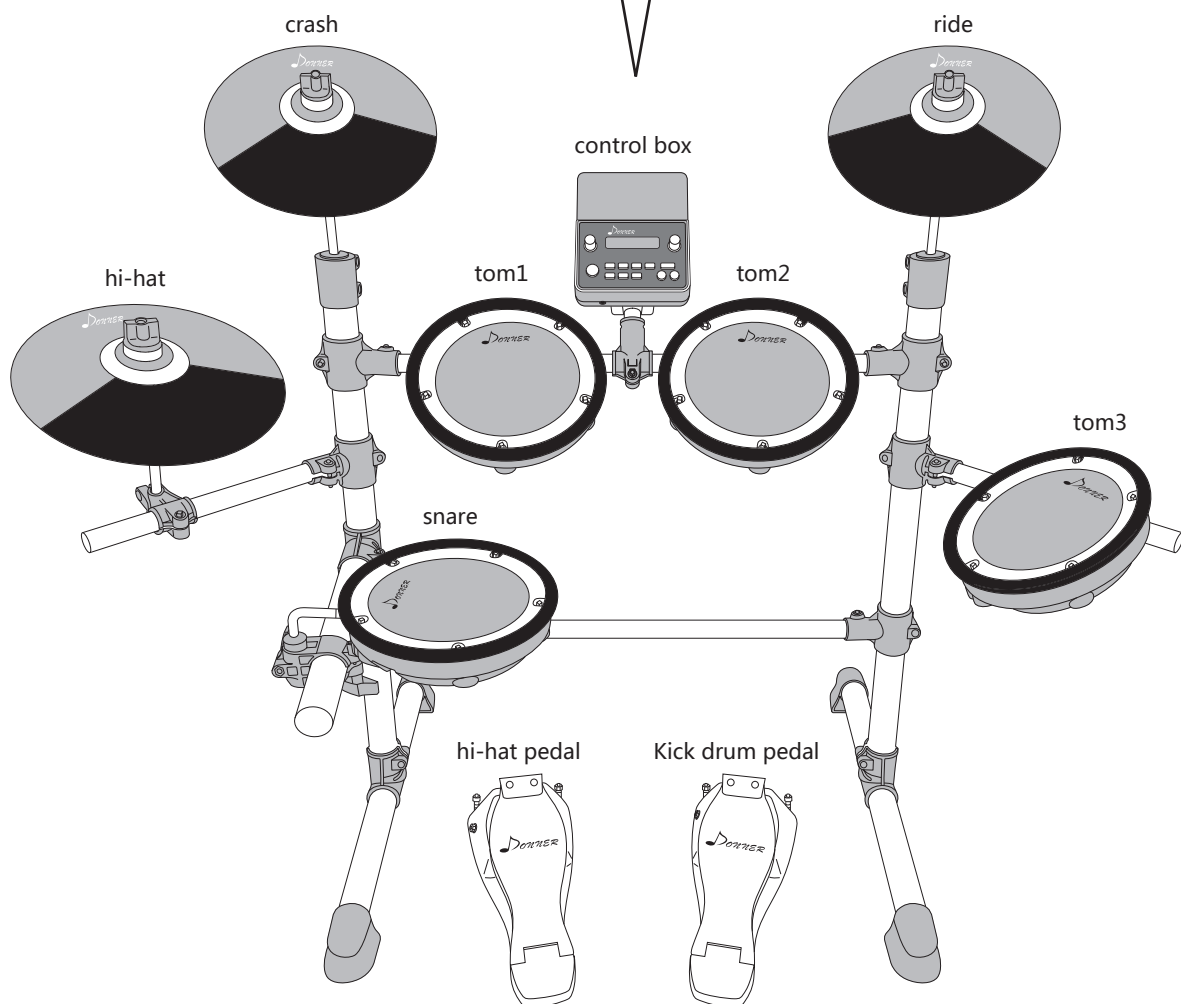
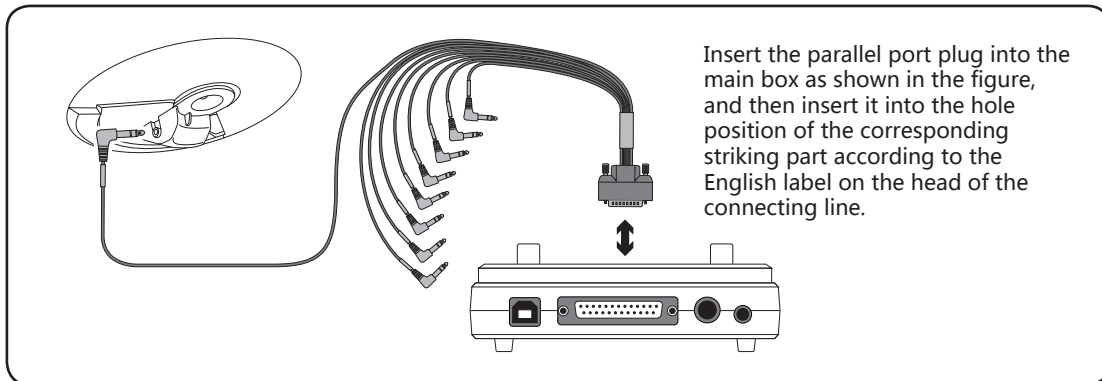





## DIAGRAM OF MODULE BOX SOCKET

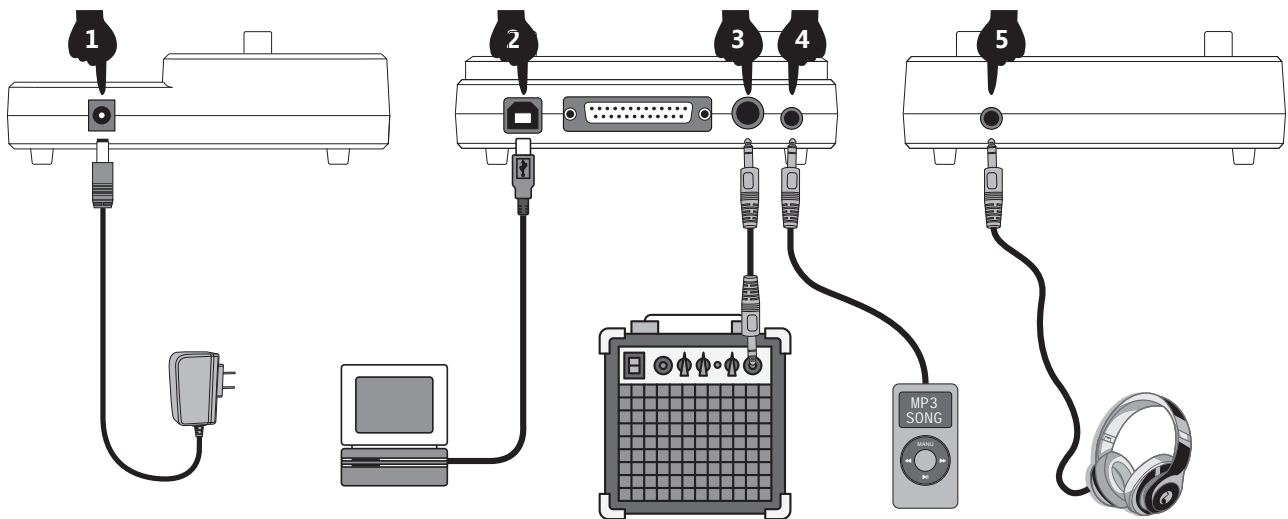

### 1 POWER TERMINAL CONNECTION

1. When in use, connect the power terminal according to the diagram, insert the power outlet of the module box at one end and 100-240V household power outlet at the other end. (Fig. 1)
2. If you do not use this product for a long time, please pull out the power plug and keep it properly.

### 2 USB MIDI PORT

The use of electronic drum MIDI USB interface can interact with music devices with MIDI.

1. Through the pre-installed Music software on computers and mobile phones, we can learn to play, compose music, store and other functions. (Fig. 2)
2. When connected to a computer or mobile phone, the audio output of the device needs to be connected to the audio input socket of the module box in order to synchronize the sound effects on the device. (Fig. 5)

### 3 AUDIO OUTPUT PORT

Audio output port can be connected with active speaker (special electronic drum speaker) and large audio equipment. (Fig. 3)

### 4 AUDIO INPUT PORT

Audio input port can connect the sound source playback device to the module box for playback (such as MP3, mobile phone and other audio signal input). (Fig. 4)

### 5 EARPHONE PORT

Connecting headphones monitors the details of percussion and does not disturb others when playing without connecting speakers. (Fig. 5)

## REMARK !

- To prevent damage to the equipment, make sure to turn down the volume and shut down all the equipment before making any connection.
- All the external equipment are accessories purchased separately, not included.

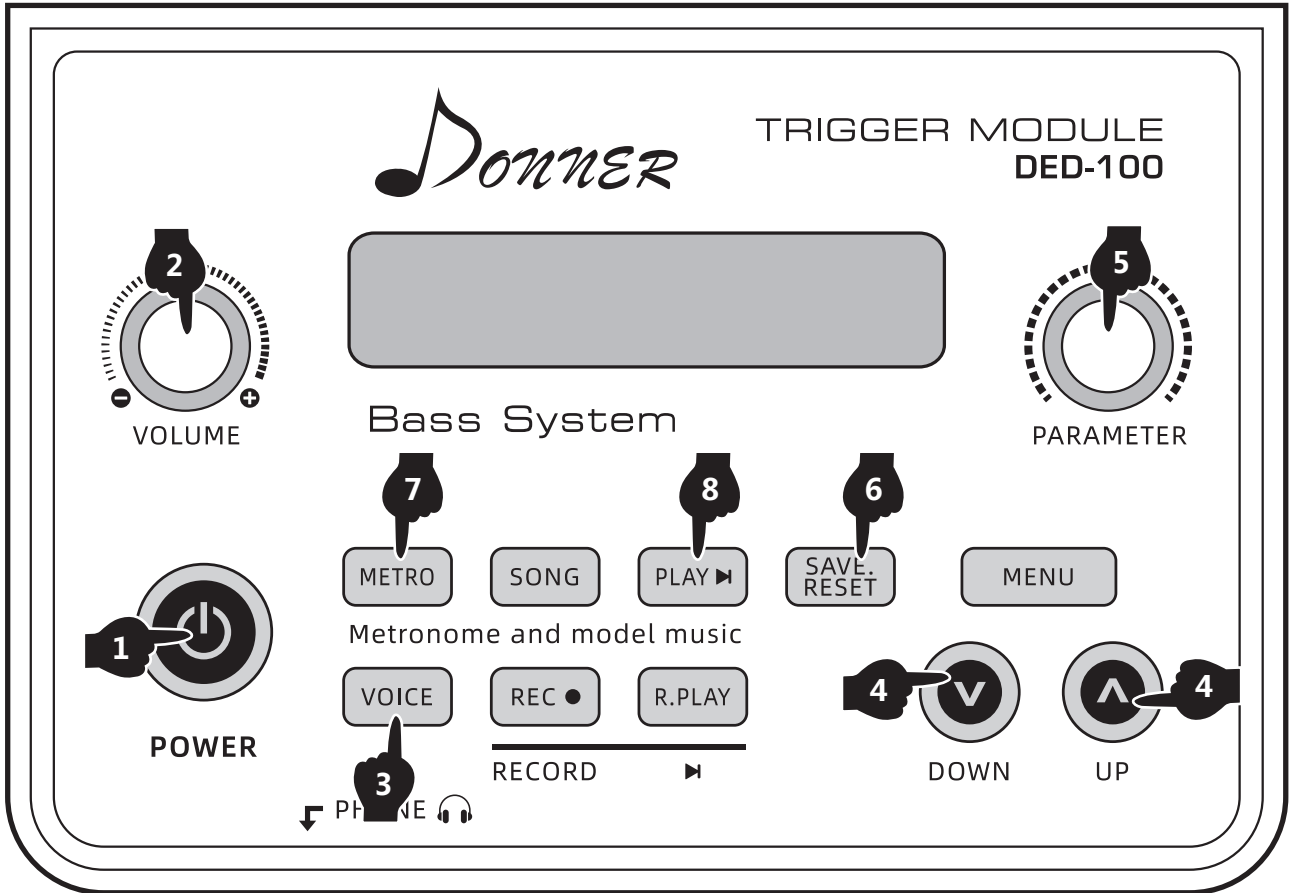

## 1 POWER ON

1. Turn on the "POWER" switch, and you can enter the playing state. (Fig. 1)
2. Please turn off the power when not in use.
  - Processor chips of this product are complex, similar to computer systems. Sometimes they can not respond. Please turn off the power switch and then turn it on to work properly.

## 2 MASTER VOLUME

Turn the "VOLUME" wheel to adjust the total volume, please adjust the volume to the desired position. (Fig. 2)

## 3 PLAY THE DRUM

This product has double trigger induction, making the hitting sound effect closer to the original sound drum effect.

1. "Snare drum" can tap drum face and drum edge.
2. "Crash cymbal" and "Ride cymbal" can tap cymbal face and edge, and hold cymbal edge with finger to stop the sound.
3. Different combinations of "Hi-hat cymbal" and "Hi-hat pedal" will change the timbre.
  - Open hi-hat cymbal timbre: Click on the surface of cymbals.
  - Close hi-hat cymbal timbre: Step on the pedal and keep it closed while tapping the cymbal surface.
  - Hi-hat pedal timbre: Step on the pedal and don't hit the cymbal surface.



## OPERATION GUIDE

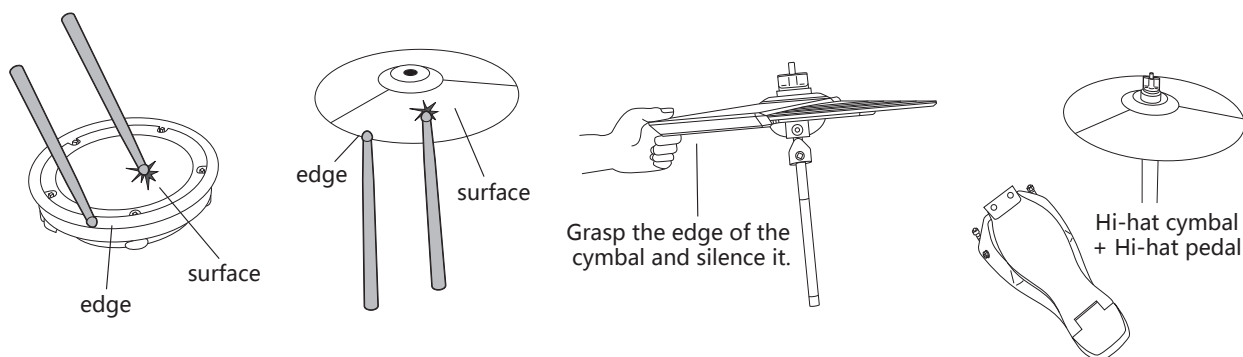

### 4 TIMBRE SELECTION OF DRUM GROUP

1. Press the "VOICE" button, display the screen (Voice), and enter the drum group adjustment mode. (Fig. 3)
2. Using the "UP/DOWN" button, you can choose the following options as an adjustment. (Fig. 4)

#### Display screen display:

- ( KitNum 001-015 ) : Drum combination timbre selection, a total of 15 sets of preset drum group.
  - ( KitVol 000-127 ) : The volume of drum combination can be adjusted at 128 levels.
  - ( Kick 001-015 ) : Kick drum timbre selection, a total of 15 timbres can be adjusted.
  - ( Snare 001-015 ) : Snare drum timbre selection, a total of 15 timbres can be adjusted.
  - ( SnareRim 001-015 ) : Snare drum edge-click timbre selection, a total of 15 timbres can be adjusted.
  - ( Tom1 001-015 ) : Tom-tom drum 1 timbre selection, a total of 15 timbres can be adjusted.
  - ( Tom2 001-015 ) : Tom-tom drum 2 timbre selection, a total of 15 timbres can be adjusted.
  - ( Tom3 001-015 ) : Tom-tom drum 3 timbre selection, a total of 15 timbres can be adjusted.
  - ( Cras 001-015 ) : Crash cymbal timbre selection, a total of 15 timbres can be adjusted.
  - ( CrasRim 001-015 ) : Crash cymbal edge-click timbre selection, a total of 15 timbres can be adjusted.
  - ( Ride 001-015 ) : Ride cymbal timbre selection, a total of 15 timbres can be adjusted.
  - ( RideRim 001-015 ) : Ride cymbal edge-click timbre selection, a total of 15 timbres can be adjusted.
  - ( OpenHat 001-015 ) : Open hi-hat cymbal timbre selection, a total of 15 timbres can be adjusted.
  - ( CloseHat 001-015 ) : Close the high-hat cymbal timbre selection, a total of 15 timbres can be adjusted.
  - ( Pedal 001-015 ) : Hi-hat pedal timbre selection, a total of 15 timbres can be adjusted.
3. Turn the "PARAMETER" knob to adjust the parameters of the above options. (Fig. 5)
  4. Press the "SAVE/RESET" button, we can save the adjusted drum set and make it easy to call later. (Fig. 6)
  5. Press and hold the "VOICE" button for more than 3 seconds to call the previously customized adjusted saved drum group. (Fig. 3)

### 5 METRONOME

1. Press the "METRO" key, the display will display (Metro), and enter metronome mode. (FIG. 7)
2. Using the "UP/DOWN" button, you can choose the following options as an adjustment. (Fig. 4)

#### Display screen display:

- ( Time 002-016 ) : Metrometer Speed - A total of 4 levels of standard speed can be adjusted.
  - ( Beat 001-009 ) : Metrometer type - 9 types can be adjusted.
  - ( MetroVol 000-127 ) : Metrometer volume - 128 levels adjustable.
3. Turn the "PARAMETER" knob to adjust the parameters of the above options. (Fig. 5)
  4. Press the "PLAY" button to start playing the metronome and press again to stop. (Fig. 8)

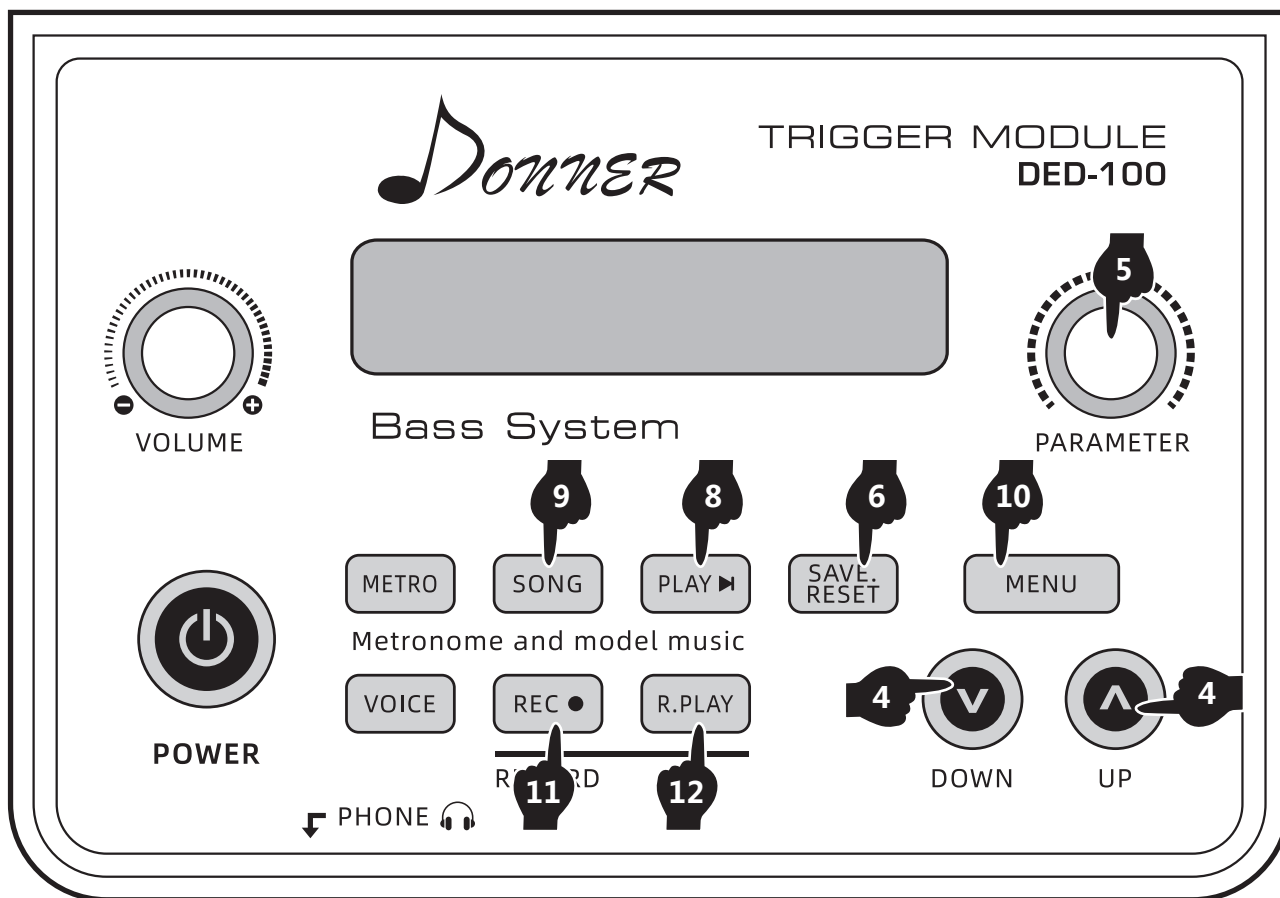

## 6 DEMONSTRATION MUSIC PLAYING

1. Press the "SONG" button, the display will show (Song) and enter the demo music mode. (FIG. 9)
2. Using the "UP/DOWN" button, you can choose the following options as an adjustment. (Fig. 4)

### Display screen display:

- ( Num 001-030): Music Selection - A total of 30 built-in pieces.
  - ( GmVol 000-127): Chord accompaniment volume - 128 levels adjustable.
  - ( DrmVol 000-127: Volume of drum group - 128 levels adjustable.
3. Turn the "PARAMETER" knob to adjust the parameters of the above options. (Fig. 5)
  4. Press the "PLAY" button to start playing the music and press again to stop. (Fig. 8)

## 7 PLAY SPEED

In the mode of demonstration music or metronome playing, adjusting speed can control the speed of demonstration music and metronome playing.

1. Press the "MENU" button several times until the display screen (Tempo) enters the sub-option playback speed mode. (FIG. 10)

### Display screen display:

- ( Speed 030-250 ) : Play speed selection - 221 level speed adjustable.
2. Turn the "PARAMETER" knob to adjust the parameters of the above options. (Fig. 5)



## 8 DRUM DISC SENSITIVITY ADJUSTMENT

1. Press the "MENU" button repeatedly until the display shows (Sensity), enter the sub option to enter the sub option sensitivity adjustment mode of percussion instrument components. (FIG. 10)
2. Hit the drum tray you want to adjust with a drum stick.
3. Using the "UP/DOWN" button, you can choose the following options as adjustments. (Fig. 4)

### Display screen display:

- ( PadSen 001-006 ) : Strike surface sensitivity - 6 levels adjustable.
  - ( RimSen 001-006 ) : Strike Side Ring Sensitivity - 6 levels adjustable.
  - ( Threhold 001-032 ) : Trigger threshold - 32 levels adjustable.
  - ( XTalk 001-032 ) : Crosstalk threshold - 32 levels adjustable.
  - ( Retrigger 001-032 ) : Repeated trigger - 32 levels adjustable.
  - ( Velocity 001-003 ) : Force Curve - 3 levels adjustable.
  - ( Volume 000-127 ) : Drum disc volume - 128 levels adjustable.
4. Turn the "PARAMETER" knob to adjust the parameters of the above options. (Fig. 5)
  5. Press the "SAVE/RESET" button to save the adjusted parameters for future use. (Fig. 6)

## 9 REVERBERATION/EQUILIBRIUM OPTIMIZATION

1. Press the "MENU" button repeatedly until the display shows (Utility) to enter the sub option reverb / equalization optimization mode. (FIG. 10)
2. Using the "UP/DOWN" button, you can choose the following options as an adjustment. (Fig. 4)

### Display screen display:

- ( RevType 000-005 ) : Reverberation Category - altogether 6 levels adjustable.
  - ( Revlevel 000-127 ) : Reverberation size - 128 levels can be adjusted, when the value is "000", the reverberation is closed.
  - ( EQ\_H 000-127 ) : High Frequency Equilibrium - 128 levels adjustable.
  - ( EQ\_L 000-127 ) : Low Frequency Equilibrium - 128 levels adjustable.
3. Turn the "PARAMETER" knob to adjust the parameters of the above options. (Fig. 5)
  4. Press "SAVE/RESET" button to save the adjusted parameters for future use. (Fig. 6)

## 10 PERCUSSION RECORDING

1. Press the "REC" button to enter the percussion recording mode, and tap the drum disk to start recording. Press again to stop recording. (Fig. 11)
2. Press the "R.PLAY" button to play the recorded percussion music. Press again to stop playing. (Fig. 12)

## 11 FACTORY RESET

Press the "SAVE/RESET" button for more than 3 seconds to restore the factory settings. (Fig. 6)



# APPENDIX

## Timbre

### KICK

- 01 Acoustic Kick
- 02 Military Kick
- 03 Original Kick
- 04 Funk Kick
- 05 Standard Kick
- 06 Dance Kick
- 07 Rock Kick
- 08 Jazz Kick
- 09 808 Kick
- 10 Songo Kick
- 11 909 Kick
- 12 Fairfax Kick
- 13 Dancehall Kick 3
- 14 70's Kick
- 15 Clean Kick

### SNARE

- 01 Acoustic Snare
- 02 Military Snare
- 03 Original Snare
- 04 Funk Snare
- 05 Standard Snare
- 06 Dance Snare
- 07 Rock Snare
- 08 Jazz Snare
- 09 808 Snare
- 10 Songo Snare
- 11 909 Snare
- 12 Fairfax Snare
- 13 Dancehall Snare
- 14 70's Snare
- 15 Clean Snare

### SNARE RIM

- 01 Acoustic Snare Rim
- 02 Military Snare Rim
- 03 Original Snare Rim
- 04 Funk Snare Rim
- 05 Standard Snare Rim
- 06 Dance Snare Rim
- 07 Rock Snare Rim
- 08 Jazz Snare
- 09 808 Snare Rim
- 10 Songo Snare Rim
- 11 909 Snare Rim
- 12 Fairfax Snare Rim
- 13 Dancehall Snare Rim
- 14 70's Snare Rim
- 15 Clean Snare Rim

### TOM 1

- 01 Acoustic Tom1
- 02 Military Tom1
- 03 Original Tom1
- 04 Funk Tom1
- 05 Standard Tom1
- 06 Dance Tom1
- 07 Rock Tom1
- 08 Jazz Tom1
- 09 808 Tom1
- 10 Songo Tom1
- 11 909 Tom1
- 12 Fairfax Tom1
- 13 Dancehall Tom1
- 14 70's Tom1
- 15 Clean Tom1

### TOM 2

- 01 Acoustic Tom2
- 02 Military Tom2
- 03 Original Tom2
- 04 Funk Tom2
- 05 Standard Tom2
- 06 Dance Tom2
- 07 Rock Tom2
- 08 Jazz Tom2
- 09 808 Tom2
- 10 Songo Tom2
- 11 909 Tom2
- 12 Fairfax Tom2
- 13 Dancehall Tom2
- 14 70's Tom2
- 15 Clean Tom2

### TOM 3

- 01 Acoustic Tom3
- 02 Military Tom3
- 03 Original Tom3
- 04 Funk Tom3
- 05 Standard Tom3
- 06 Dance Tom3
- 07 Rock Tom3
- 08 Jazz Tom3
- 09 808 Tom3
- 10 Songo Tom3
- 11 909 Tom3
- 12 Fairfax Tom3
- 13 Dancehall Tom3
- 14 70's Tom3
- 15 Clean Tom3

### CRASH

- 01 Acoustic Crash1
- 02 Military Crash1
- 03 Original Crash1
- 04 Standard Crash1
- 05 Funk Crash1
- 06 Dance Crash1
- 07 Rock Crash1
- 08 Jazz Crash1
- 09 808 Crash1
- 10 Songo Crash1
- 11 909 Crash1
- 12 Fairfax Crash1
- 13 Dancehall Crash1
- 14 70's Crash1
- 15 Clean Crash1

### CRASH RIM

- 01 Acoustic Crash1 Rim
- 02 Military Crash1 Rim
- 03 Original Crash1 Rim
- 04 Standard Crash1 Rim
- 05 Funk Crash1 Rim
- 06 Dance Crash1 Rim
- 07 Rock Crash1 Rim
- 08 Jazz Crash1 Rim
- 09 808 Crash1 Rim
- 10 Songo Crash1 Rim
- 11 909 Crash1 Rim
- 12 Fairfax Crash1 Rim
- 13 Dancehall Crash1 Rim
- 14 70's Crash1 Rim
- 15 Clean Crash1 Rim

### RIDE

- 01 Acoustic Ride
- 02 Military Ride
- 03 Original Ride
- 04 Standard Ride
- 05 Funk Ride
- 06 Dance Ride
- 07 Rock Ride
- 08 Jazz Ride
- 09 808 Ride
- 10 Songo Ride
- 11 909 Ride
- 12 Fairfax Ride
- 13 Dancehall Ride
- 14 70's Ride
- 15 Clean Ride

### RIDE RIM

- 01 Acoustic Ride Rim
- 02 Military Ride Rim
- 03 Original Ride Rim
- 04 Standard Ride Rim
- 05 Funk Ride Rim
- 06 Dance Ride Rim
- 07 Rock Ride Rim
- 08 Jazz Ride Rim
- 09 808 Ride Rim
- 10 Songo Ride Rim
- 11 909 Ride Rim
- 12 Fairfax Ride Rim
- 13 Dancehall Rim
- 14 70's Ride Rim
- 15 Clean Ride Rim

### HI-HAT OPEN

- 01 Acoustic Hi-hat Open
- 02 Military Hi-hat Open
- 03 Original Hi-hat Open
- 04 Standard Hi-hat Open
- 05 Funk Hi-hat Open
- 06 Dance Hi-hat Open
- 07 Rock Hi-hat Open
- 08 Jazz Hi-hat Open
- 09 808 Hi-hat Open
- 10 Songo Hi-hat Open
- 11 909 Hi-hat Open
- 12 Fairfax Hi-hat Open
- 13 Dancehall Hi-hat Open
- 14 70's Hi-hat Open
- 15 Clean Hi-hat Open

### HI-HAT CLOSE

- 01 Acoustic Hi-hat Close
- 02 Military Hi-hat Close
- 03 Original Hi-hat Close
- 04 Standard Hi-hat Close
- 05 Funk Hi-hat Close
- 06 Dance Hi-hat Close
- 07 Rock Hi-hat Close
- 08 Jazz Hi-hat Close
- 09 808 Hi-hat Close
- 10 Songo Hi-hat Close
- 11 909 Hi-hat Close
- 12 Fairfax Hi-hat Close
- 13 Dancehall Hi-hat Close
- 14 70's Hi-hat Close
- 15 Clean Hi-hat Close

### HI-HAT PEDAL

- 01 Acoustic Hi-hat Pedal
- 02 Military Hi-hat Pedal
- 03 Original Hi-hat Pedal
- 04 Standard Hi-hat Pedal
- 05 Funk Hi-hat Pedal
- 06 Dance Hi-hat Pedal
- 07 Rock Hi-hat Pedal
- 08 Jazz Hi-hat Pedal
- 09 808 Hi-hat Pedal
- 10 Songo Hi-hat Pedal
- 11 909 Hi-hat Pedal
- 12 Fairfax Hi-hat Pedal
- 13 Dancehall Hi-hat Pedal
- 14 70's Hi-hat Pedal
- 15 Clean Hi-hat Pedal

## Drum combination timbre

- |            |            |        |            |              |
|------------|------------|--------|------------|--------------|
| 1 Acoustic | 4 Funk     | 7 Rock | 10 Songo   | 13 Dancehall |
| 2 Military | 5 Standard | 8 Jazz | 11 909     | 14 70's      |
| 3 Original | 6 Dance    | 9 808  | 12 Fairfax | 15 Clean     |

## User drum group

- 16 Kit Num

## Demonstration music

- |                       |            |               |                  |                 |             |
|-----------------------|------------|---------------|------------------|-----------------|-------------|
| 1 Drum & Bass         | 6 Country1 | 11 March      | 16 Pop Rock      | 21 Swing1       | 26 Swing3   |
| 2 Blues               | 7 R & B    | 12 Pop Bossa  | 17 Country Blues | 22 Swing2       | 27 Jazz2    |
| 3 Jazz1               | 8 Pop1     | 13 Fusion     | 18 Pop4          | 23 Country2     | 28 Country3 |
| 4 Rock1               | 9 Pop2     | 14 Dance      | 19 Scotland      | 24 Modern Pop   | 29 Rock2    |
| 5 Electroponic & Funk | 10 Pop3    | 15 Jazz Swing | 20 Latin Jazz    | 25 Electroponic | 30 Pop5     |



## PRODUCT MAINTENANCE

Careful maintenance and protection of the product, to extend the service life of the product, reduce the fault has a very important role.

### **1 AVOID HEATING, DAMPNESS OR DIRECT SUNLIGHT**

Do not over expose the product to direct sunlight, or place it near air conditioning or extremely hot place.

### **2 DO NOT USE NEAR THE TV OR RADIO**

This product may cause video or audio interference to the reception of TV and radio. If this happens, the product should be removed from the TV or radio.

### **3 NO DILUENTS OR SIMILAR CHEMICALS SHOULD BE USED FOR CLEANING**

Clean the product with a soft cloth wetted with weak water solution and neutral detergent. Soak the cloth in a solution and wring it dry until it approaches drying.

### **4 DO NOT SHAKE, AVOID COLLISION**

When moving, the product should be handled carefully and lightly. Violent vibration and collision are strictly prohibited in order to avoid damage to the shell or internal electronic components.



# SAFETY PRECAUTIONS

## POWER SUPPLY

This product can be powered by standard indoor wall sockets. Please only use the power cord specified in this product. When not in use, please turn off the power supply. When not in use for a long time, pull out the power cord and keep it properly.

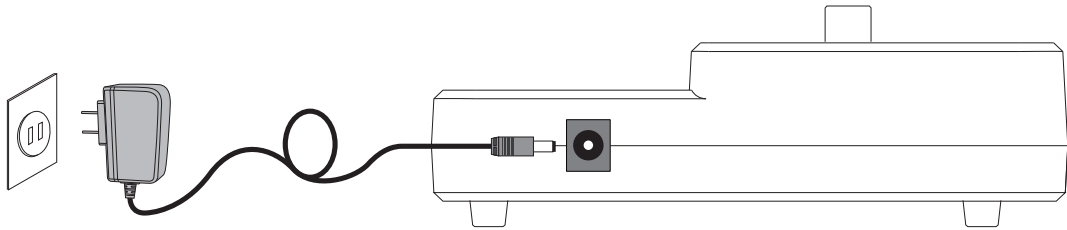

## SIGN

To ensure that you use this product safely and correctly, to prevent harm to users and others and financial damage, this manual and products are marked with a series of safety signs. The various signs and their meanings are as follows:

### **WARNING**

This sign indicates that there is a potential risk of death or serious injury if this mark is ignored and the product is mishandled.

### **BE CAREFUL**

This sign indicates that there is a potential danger of injury to personnel or other financial damage if this sign is ignored and the product is operated incorrectly.

## EXAMPLE OF LOGO



This triangle sign ( $\Delta$ ) indicates what users should pay attention to. (The left example is careful shocks)



A circular sign ( $\textcircled{\diagdown}$ ) with an oblique line indicates prohibitions. The icons in or beside the logo indicate the contents specifically prohibited. (The example on the left is no disassembly)



The round black bottom sign ( $\textcircled{\text{⬇}}$ ) indicates what must be observed. The diagrams in this sign indicate the contents of the specific matters that must be observed. (The example on the left is that the power plug must be pulled out of the socket)





# SAFETY PRECAUTIONS

## WARNING

### Smoke, odor, overheating

When the product smokes, smells or overheats, there is a danger of fire and electric shock when it is used continually. In case of the above situation, the following operations should be performed immediately:

1. Turn off the power supply.
2. Pull the plug out of the power outlet.
3. Contact your dealer.

### Power cord

1. The improper use of power cord may cause fire and electric shock. The following precautions must be observed:
  - The special power cord designated for this product must be used.
  - The AC power supply with output voltage within the rated voltage range for household use must be used.
  - Do not overload power sockets and extension lines.
2. The improper treatment of power line will lead to its damage or breakage, which will cause fire and electric shock hazards. The following precautions must be observed:
  - Do not place or heat heavy objects on power lines.
  - Do not attempt to alter or bend the power cord too much.
  - Do not twist or pull the power cord.
  - If the power cord or plug is damaged, please replace the same type of power cord.
3. Do not touch the power cord and plug with wet hands, otherwise there is a danger of electric shock.
4. Please use the power cord where the water will not splash. Water is in danger of causing fire and electric shock.
5. Never place vases or any other container containing water on this product. Water is dangerous of causing fire and electric shock.
6. Do not allow minors to unplug and touch power lines or connection boards. Minors have no common sense of electricity safety, which may cause electric shock.

## BE CAREFUL

The improper use of power cord may cause fire and electric shock. The following precautions must be observed:

- Never put the power cord near the oven or other heat source.
- Do not pull the cable when pulling out of the power socket. The main body of the plug must be grasped.
- The power cord plug must be inserted in the socket to the end.
- Make sure the power supply is off before connecting or disconnecting it.
- When thunderstorms occur or before traveling or other long-term departure, disconnect the power cord from the wall outlet.
- At least once a year, remove the power cord from the wall outlet and clean the dust accumulated around the plug.

### Do not burn this product

Do not put this product in the fire, otherwise it will lead to product combustion and explosion of internal electronic components, which will cause fire and personnel injury.

### Water and foreign bodies

Water, other liquids and (metal sheets, etc.) entering this product are in danger of causing fire and electric shock. In case of the above situation, the following operations shall be performed immediately:

1. Turn off the power supply.
2. If you are using a power cord for power supply, unplug it from the wall outlet.
3. Contact your distributor.

### Disassembly and transformation

Do not disassemble or transform the product in any way, otherwise there is a risk of electric shock, scald or other personal injury. All internal inspection, adjustment and maintenance operations should be entrusted to your distributor.



# SAFETY PRECAUTIONS

## Falling or colliding

If the product falls or is damaged by strong impact, it will be in danger of causing fire and electric shock. In case of the above situation, the following operations shall be performed immediately:

1. Turn off the power supply.
2. If you are using a power cord for power supply, you need to unplug it from the wall outlet.
3. Contact your distributor.



## Plastic bag

Do not let anyone put plastic bags for this product on his head or in his mouth. Otherwise, there is a risk of asphyxia. Families with young children should pay special attention to it.



## Keep a distance from the product and the bracket

Climbing the bracket is dangerous of overturning or damage. Families with young children should pay special attention to it.



## Put

Avoid placing the product on an uneven surface or any other unstable place. Otherwise, it will cause the product to fall down, which will lead to the risk of injury.



## Product Mobility

Before moving this product, you must unplug the power cord plug from the wall outlet and pull out all other cables and connecting wires. Otherwise, it will lead to damage of power or connection wires, resulting in fire and electric shock.



## clean

Before cleaning this product, you must unplug the power cord plug from the wall outlet, otherwise there is a risk of fire and electric shock.



## Jack

The socket of this product can only be connected to the designated equipment and devices. Connecting non-designated equipment or devices is dangerous of causing fire and electric shock.



## Location selection

It should be avoided to place the product in the following places, otherwise there is a risk of fire and electric shock.

- High temperature or dusty places.
- Kitchen or other places with lampblack.
- Where the product is exposed to direct sunlight, or any other place where the product will produce high temperature.



## Volume

Don't play music long and loud. Pay special attention when using headphones. Excessive volume can damage your hearing.



## Heavy

Do not place heavy objects on this product. Otherwise, the top of the product will be overweight, causing the product to overturn or drop objects on it, which will lead to the risk of injury.



## Correct assembly of scaffolds

The incorrect assembly of the bracket may overturn, causing the product to fall off and posing a risk of injury to personnel. Therefore, it must be assembled according to the instructions in the attached installation guide to ensure that the product is properly mounted on its bracket.





# WARRANTY CARD

## Warranty rules

1. Faults arising from normal use of this product can be guaranteed free of charge for \_\_\_\_\_ days from the date of purchase.
2. Failure occurs during the warranty period. This warranty card and shopping ticket must be presented during maintenance.
3. In the following cases, no free warranty will be provided:
  - Damage caused by improper use by users.
  - Fault damage caused by irresistible factors such as fire, flood, earthquake and lightning strike.
  - Failure caused by unauthorized self-disassembly.
4. After exceeding the warranty period, the company is responsible for maintenance, but it needs to charge a cost fee.

**Seller:** \_\_\_\_\_

**Address:** \_\_\_\_\_

**Telephone:** \_\_\_\_\_

## Maintenance record

Date	Maintenance record	Repairman



Manufacturer: Guangzhou Rantion Technology Co., Ltd.

Address: D Building, Kengkou Electronic Digital Base, No. 9, Huaxi Road,  
Liwan District, Guangzhou City, Guangdong Province



[www.idonner.com](http://www.idonner.com)  
[www.donnerdeal.com](http://www.donnerdeal.com)