

Ring Terminals

Non-Insulated, Tin-Plated Copper

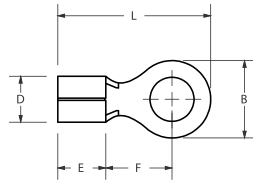

Technical Data

Body Material:

Pure Copper (Tin-Plated)

Temperature Range:

Up to +105°C



Part No.	Wire Size		Stud Size	Dimensions (in)					Part No.	Wire Size		Stud Size	Dimensions (in)				
	AWG	mm ²		B	L	F	E	D		AWG	mm ²		B	L	F	E	D
RING-2218-4-NINS			4	0.224	0.496	0.195	0.189	0.067	RING-4-10-NINS			10	0.480	1.307	0.571	0.472	0.303
RING-2218-6-NINS			6	0.224	0.496	0.195	0.189	0.067	RING-4-10A-NINS			10	0.650	1.327	0.531	0.472	0.303
• RING-2218-6A-NINS			6	0.260	0.567	0.248	0.189	0.067	RING-4-1/4-NINS			1/4"	0.480	1.307	0.571	0.472	0.303
• RING-2218-6B-NINS			6	0.315	0.622	0.276	0.189	0.067	• RING-4-1/4A-NINS			1/4"	0.650	1.327	0.531	0.472	0.303
• RING-2218-8-NINS			8	0.260	0.567	0.248	0.189	0.067	• RING-4-5/16-NINS			5/16"	0.650	1.327	0.531	0.472	0.303
• RING-2218-8A-NINS			8	0.315	0.622	0.276	0.189	0.067	• RING-4-3/8-NINS			3/8"	0.650	1.327	0.531	0.472	0.303
• RING-2218-10-NINS			10	0.315	0.622	0.276	0.189	0.067	RING-4-1/2-NINS			1/2"	0.866	1.673	0.768	0.472	0.303
• RING-2218-10A-NINS			10	0.386	0.709	0.335	0.189	0.067	RING-4-9/16-NINS			9/16"	1.181	2.008	0.945	0.472	0.303
• RING-2218-1/4-NINS			1/4"	0.457	0.709	0.335	0.189	0.067	RING-4-5/8-NINS			5/8"	1.181	2.008	0.984	0.472	0.303
• RING-2218-1/4A-NINS			1/4"	0.457	0.858	0.437	0.189	0.067	RING-4-11/16-NINS			11/16"	1.181	2.008	1.024	0.472	0.303
• RING-2218-5/16-NINS			5/16"	0.457	0.858	0.437	0.189	0.067	RING-4-3/4-NINS			3/4"	1.181	2.008	1.063	0.472	0.303
• RING-2218-3/8-NINS			3/8"	0.535	1.004	0.547	0.189	0.067									
RING-2218-1/2-NINS			1/2"	0.756	1.220	0.650	0.189	0.067	RING-2-10-NINS			10	0.602	1.535	0.720	0.551	0.370
									RING-2-1/4-NINS			1/4"	0.602	1.535	0.720	0.551	0.370
RING-1614-4-NINS			4	0.260	0.484	0.169	0.189	0.091	RING-2-5/16-NINS			5/16"	0.602	1.535	0.720	0.551	0.370
RING-1614-6-NINS			6	0.260	0.484	0.169	0.189	0.091	RING-2-5/16A-NINS			5/16"	0.866	1.681	0.697	0.551	0.370
• RING-1614-6A-NINS			6	0.260	0.571	0.256	0.189	0.091	RING-2-3/8-NINS			3/8"	0.602	1.536	0.720	0.551	0.370
RING-1614-6B-NINS			6	0.335	0.661	0.306	0.189	0.091	RING-2-3/8A-NINS			3/8"	0.866	1.681	0.697	0.551	0.370
RING-1614-8-NINS			8	0.260	0.571	0.256	0.189	0.091	RING-2-1/2-NINS			1/2"	0.866	1.681	0.697	0.551	0.370
• RING-1614-8A-NINS			8	0.335	0.661	0.305	0.189	0.091	RING-2-9/16-NINS			9/16"	1.181	2.055	0.886	0.551	0.370
• RING-1614-10-NINS			10	0.335	0.661	0.306	0.189	0.091	RING-2-5/8-NINS			5/8"	1.181	2.055	0.925	0.551	0.370
RING-1614-10A-NINS			10	0.374	0.661	0.285	0.189	0.091	RING-2-11/16-NINS			11/16"	1.181	2.055	0.965	0.551	0.370
• RING-1614-1/4-NINS			1/4"	0.472	0.858	0.433	0.189	0.091	RING-2-3/4-NINS			3/4"	1.181	2.055	1.004	0.551	0.370
• RING-1614-5/16-NINS			5/16"	0.472	0.858	0.433	0.189	0.091									
• RING-1614-3/8-NINS			3/8"	0.575	1.024	0.547	0.189	0.091	RING-1/0-1/4-NINS			1/4"	0.865	1.953	0.814	0.707	0.605
• RING-1614-1/2-NINS			1/2"	0.756	1.228	0.650	0.189	0.091	RING-1/0-5/16-NINS			5/16"	0.865	1.953	0.814	0.707	0.605
									RING-1/0-3/8-NINS			3/8"	0.865	1.953	0.814	0.707	0.605
RING-1412-8-NINS			8	0.315	0.709	0.303	0.236	0.197	RING-1/0-1/2-NINS			1/2"	0.865	1.953	0.814	0.707	0.605
RING-1412-10-NINS			10	0.315	0.709	0.303	0.236	0.197	RING-1/0-9/16-NINS			9/16"	1.258	2.260	0.924	0.707	0.605
RING-1412-10A-NINS			10	0.472	0.846	0.303	0.236	0.197	RING-1/0-5/8-NINS			5/8"	1.258	2.260	0.924	0.707	0.605
RING-1412-1/4-NINS			1/4"	0.472	0.846	0.303	0.236	0.197	RING-1/0-11/16-NINS			11/16"	1.258	2.260	0.924	0.707	0.605
RING-1412-5/16-NINS			5/16"	0.591	1.083	0.551	0.236	0.197	RING-1/0-3/4-NINS			3/4"	1.258	2.260	0.924	0.707	0.605
RING-1412-3/8-NINS			3/8"	0.591	1.083	0.551	0.236	0.197	RING-1/0-7/8-NINS			7/8"	1.258	2.260	0.924	0.707	0.605
RING-1210-4-NINS			4	0.283	0.618	0.232	0.268	0.134	RING-2/0-1/4-NINS			1/4"	0.943	2.004	0.786	0.747	0.688
• RING-1210-6-NINS			6	0.283	0.618	0.232	0.268	0.134	RING-2/0-5/16-NINS			5/16"	0.943	2.004	0.786	0.747	0.688
RING-1210-8-NINS			8	0.283	0.618	0.232	0.268	0.134	RING-2/0-3/8-NINS			3/8"	0.943	2.004	0.786	0.747	0.688
• RING-1210-8A-NINS			8	0.374	0.780	0.327	0.268	0.134	RING-2/0-1/2-NINS			1/2"	0.943	2.004	0.786	0.747	0.688
• RING-1210-10-NINS			10	0.374	0.780	0.327	0.268	0.134	RING-2/0-9/16-NINS			9/16"	1.258	2.397	1.022	0.747	0.688
• RING-1210-1/4-NINS			1/4"	0.472	1.016	0.512	0.268	0.134	RING-2/0-5/8-NINS			5/8"	1.258	2.397	1.022	0.747	0.688
• RING-1210-5/16-NINS			5/16"	0.591	1.102	0.539	0.268	0.134	RING-2/0-11/16-NINS			11/16"	1.258	2.397	1.022	0.747	0.688
• RING-1210-3/8-NINS			3/8"	0.591	1.102	0.539	0.268	0.134	RING-2/0-3/4-NINS			3/4"	1.258	2.397	1.022	0.747	0.688
• RING-1210-1/2-NINS			1/2"	0.756	1.276	0.630	0.268	0.134	RING-2/0-7/8-NINS			7/8"	1.258	2.397	1.022	0.747	0.688
RING-8-8-NINS			8	0.346	0.937	0.366	0.335	0.177	RING-3/0-1/4-NINS			1/4"	1.061	2.130	0.814	0.786	0.766
RING-8-10-NINS			10	0.346	0.937	0.437	0.335	0.177	RING-3/0-5/16-NINS			5/16"	1.061	2.130	0.814	0.786	0.766
• RING-8-10A-NINS			10	0.472	0.937	0.366	0.335	0.177	RING-3/0-3/8-NINS			3/8"	1.061	2.130	0.814	0.786	0.766
RING-8-10B-NINS			10	0.591	1.173	0.543	0.335	0.177	RING-3/0-1/2-NINS			1/2"	1.061	2.130	0.814	0.786	0.766
• RING-8-1/4-NINS			1/4"	0.472	0.937	0.366	0.335	0.177	RING-3/0-9/16-NINS			9/16"	1.258	2.672	1.258	0.786	0.766
RING-8-1/4A-NINS			1/4"	0.591	1.173	0.543	0.335	0.177	RING-3/0-5/8-NINS			5/8"	1.258	2.672	1.258	0.786	0.766
• RING-8-5/16-NINS			5/16"	0.591	1.173	0.543	0.335	0.177	RING-3/0-11/16-NINS			11/16"	1.258	2.672	1.258	0.786	0.766
• RING-8-3/8-NINS			3/8"	0.591	1.173	0.543	0.335	0.177	RING-3/0-3/4-NINS			3/4"	1.258	2.672	1.258	0.786	0.766
RING-8-1/2-NINS			1/2"	0.787	1.319	0.591	0.335	0.177	RING-3/0-7/8-NINS			7/8"	1.258	2.672	1.258	0.786	0.766
RING-6-8-NINS			8	0.472	1.173	0.524	0.413	0.228	RING-4/0-1/4-NINS			1/4"	1.120	2.185	0.802	0.825	0.869
RING-6-10-NINS			10	0.472	1.173	0.524	0.413	0.228	RING-4/0-5/16-NINS			5/16"	1.120	2.185	0.802	0.825	0.869
• RING-6-1/4-NINS			1/4"	0.472	1.173	0.524	0.413	0.228	RING-4/0-3/8-NINS			3/8"	1.120	2.185	0.802	0.825	0.869
RING-6-1/4A-NINS			1/4"	0.630	1.291	0.524	0.413	0.228	RING-4/0-1/2-NINS			1/2"	1.120	2.185	0.802	0.825	0.869
• RING-6-5/16-NINS			5/16"	0.630	1.291	0.571	0.413	0.228	RING-4/0-9/16-NINS			9/16"	1.258	2.712	1.258	0.825	0.869
• RING-6-3/8-NINS			3/8"	0.630	1.291	0.571	0.413	0.228	RING-4/0-5/8-NINS			5/8"	1.258	2.712	1.258	0.825	0.869
• RING-6-1/2-NINS			1/2"	0.866	1.614	0.768	0.413	0.228	RING-4/0-11/16-NINS			11/16"	1.258	2.712	1.258	0.825	0.869
RING-6-9/16-NINS			9/16"	1.181	2.008	0.984	0.413	0.228	RING-4/0-3/4-NINS			3/4"	1.258	2.712	1.258	0.825	0.869
RING-6-5/8-NINS			5/8"	1.181	2.008	1.024	0.413	0.228	RING-4/0-7/8-NINS			7/8"	1.258	2.712	1.258	0.825	0.869
RING-6-11/16-NINS			11/16"	1.181	2.008	1.063	0.413	0.228									
RING-6-3/4-NINS			3/4"	1.181	2.008	1.102	0.413	0.228									