

EPIC® Rectangular Connectors

HD 25 Inserts

Stamped & Formed Crimp Terminated Plugs & Receptacles



Please note that contacts are sold separately.

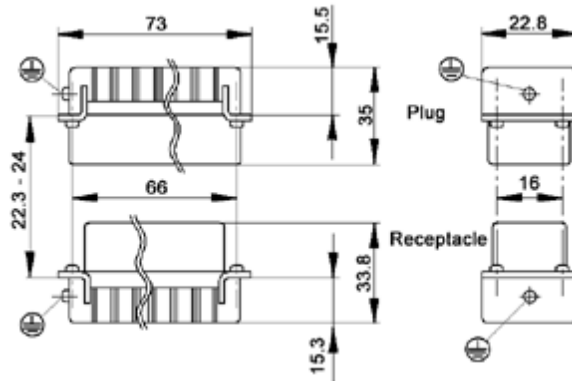

All dimensions are in mm.

View from Cable Side

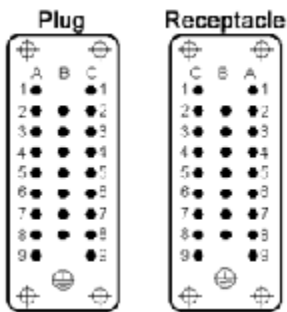

Panel Cut-Out
(Insert Only)

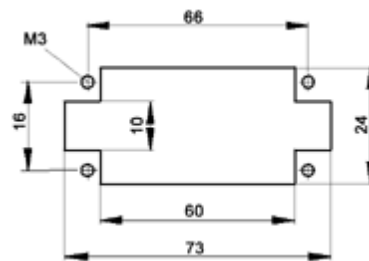

DERATING CURVES

HD Stamped & Formed Crimp Terminated:
0.5 mm² (20 AWG)

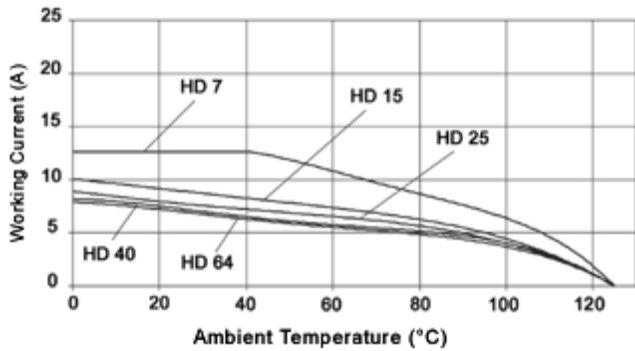

HD Stamped & Formed Crimp Terminated:
1.5 mm² (16 AWG)

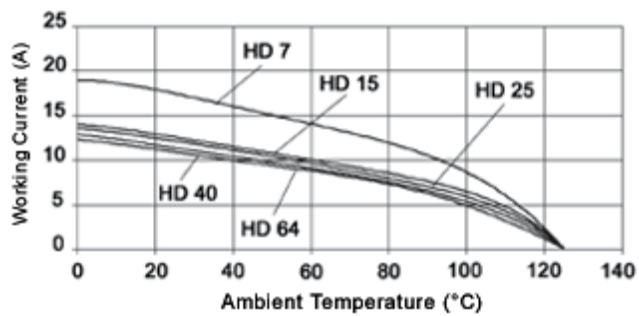

HD Stamped & Formed Crimp Terminated:
2.5 mm² (14 AWG)

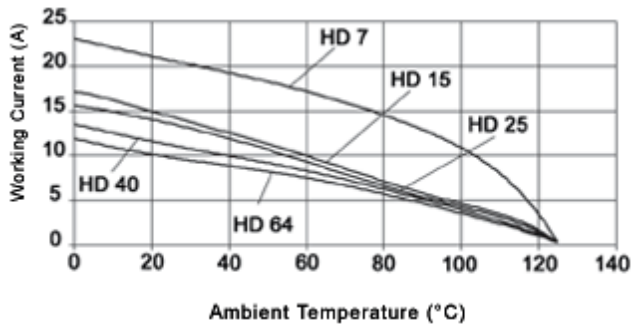

TECHNICAL DATA

Rated Voltage:	UL: 600V	VDE: 250V
Rated Current:	UL: 10A	VDE: 10A
Temperature Range:	-40°C to 125°C	
Test Voltage:	2.5 kV	
Pollution Level:	3	
Termination:	0.14 - 2.5mm ²	AWG 22-14
Contact Material:	Copper Alloy, silver plated/gold plated	
Contact Resistance:	<2 mOhm	
Mating Cycles:	100 (higher mating cycles depending on the application)	

PART NUMBERS

	Plug	Receptacle
Crimp Terminated: Machined	11.2600	11.2610

CONTACTS

Stamped & Formed Contacts: Diameter 1.6 mm

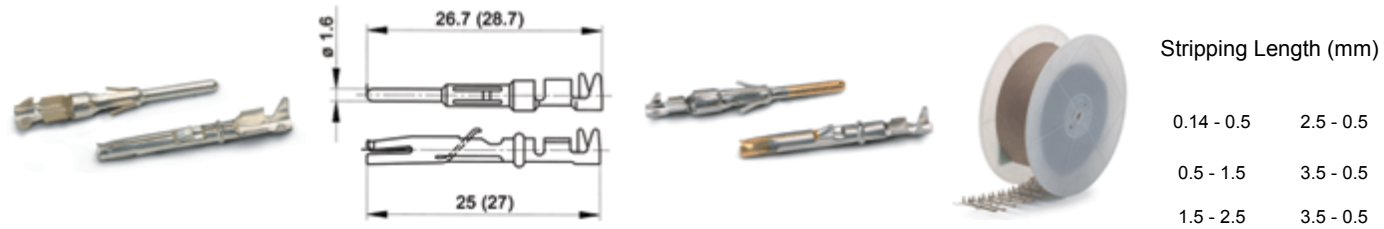

		Bags of 100				Silver: Left Hand Feed Reel			
		SILVER		GOLD		Reel of 100		Reel of 200	
mm ²	AWG	Pin	Socket	Pin	Socket	Pin	Socket	Pin	Socket
0.14 - 0.5	26 - 22	11.2411	11.2311	11.2431	11.2331	-	-	11.2407	11.2307
0.5 - 1.5	20 - 16	11.2210	11.2361	11.2213	11.2381	-	-	11.2207	11.2357
1.5 - 2.5	16 - 14	11.2235	11.2285	-	-	11.2230	11.2280	-	-

		Reel of 2000: Right Hand Feed				Reel of 2000: Left Hand Feed			
		SILVER		GOLD		SILVER		GOLD	
mm ²	AWG	Pin	Socket	Pin	Socket	Pin	Socket	Pin	Socket
0.14 - 0.5	26 - 22	11.2400	11.2300	-	-	11.2404	11.2304	11.2305	11.2405
0.5 - 1.5	20 - 16	11.2200	11.2350	11.2201	11.2352	11.2260	11.2265	-	-
1.5 - 2.5	16 - 14	-	-	-	-	11.2227	11.2277	-	-

Part number= 1 contact (bags) or 1 reel

TOOLS



Locator
11.1473



Crimp Dies
0.14 - 0.5: 11.147170
0.5 - 1.5: 11.147180
1.5 - 2.5: 11.147190



Crimp Tool
11.1470

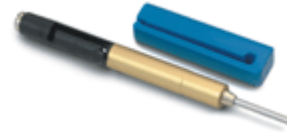

Removal Tool
11.1610



Crimp Tool for Reel
11.1535



Crimp Dies for Reel

0.14 - 0.5: 11.1536
0.5 - 1.5: 11.1537
1.5 - 2.5: 11.1538

► [HA 16 Housings](#)



DOWNLOAD PDF CATALOG PAGE

LAPP USA ■ 29 HANOVER ROAD, FLORHAM PARK, NJ 07932
SALES TEL: 1-800-774-3539 ■ **SALES FAX: 973-660-9330**

A Lapp Group Company



Lapp USA or the Lapp Group are not affiliated with Lapp Insulator.