

FACE VIEW

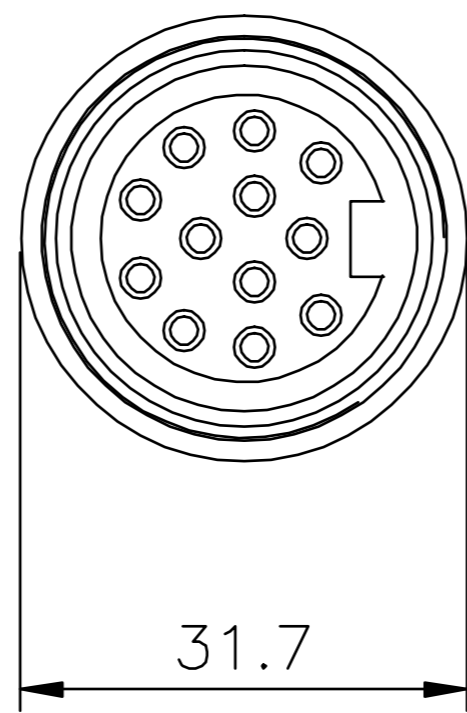

CONNECTOR FACE VIEW

31.7

1 1/8" - 16 UN-2A
INTERNAL THREAD

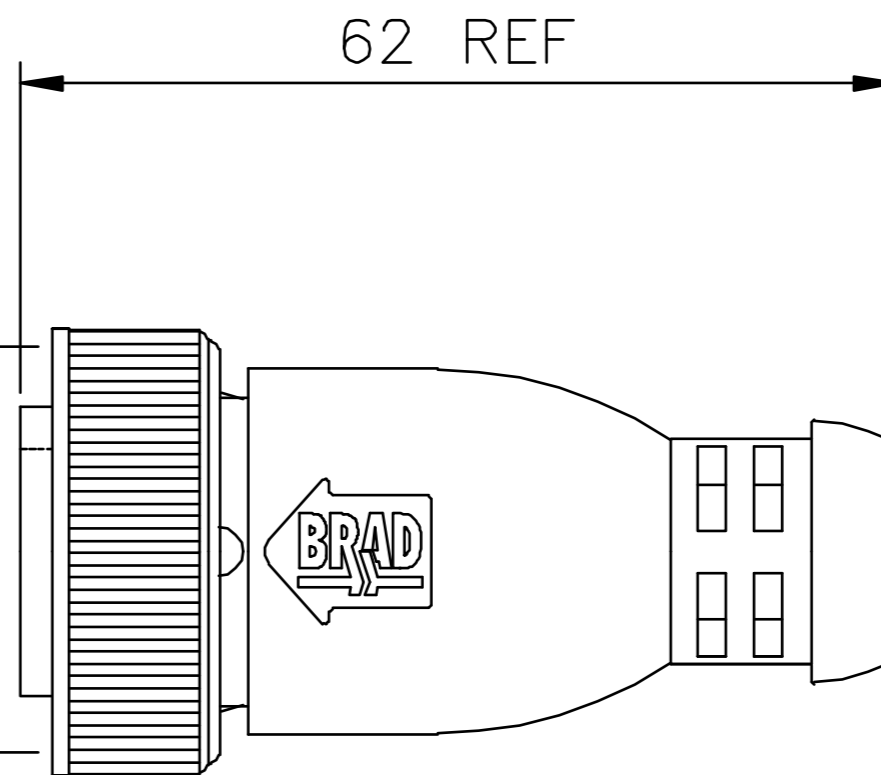

62 REF

BALL LINK CHAIN - 300mm LONG

Wiring Configuration

Pin No	WIRING
1	Link to Pin 6
2	Not Used
3	Not Used
4	Link to Pin 10
5	Not Used
6	Link to Pin 1
7	Not Used
8	Not Used
9	Not Used
10	Link to Pin 4
11	Not Used
12	Not Used

Specification.

- Insert Material - PVC
- Contact Material - Brass (CuZn36)
- Contact Plating - 2um Ni, 0.70um Gold
- Coupling Nuts - Zinc Die Cast-Black E Coat
- Protection Class - IP68
- Voltage Rating - 300V
- Contact Current Rating-8 Amps
- Connector Shell Rating-24Amps
- Overmoulding - PVC
- Chain-Brass, Bright Nickel Plate

CUSTOMER APPROVAL

SIGNATURE	DATE
-----------	------

PLEASE SIGN AND RETURN

ECN	Rev	By	Descriptions	Date	Approved
UK11246	B	NW	Second Issue	09.08.06	NW

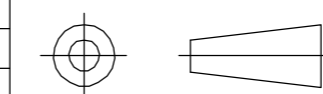

Third Angle Projection

This drawing and its contents are the proprietary and confidential property of Woodhead Industries Inc. and/or its subsidiaries and may not be used or disclosed to others without the express prior written consent of Woodhead Industries Inc. and/or its subsidiaries.

Applicable Standards ASME Y14.5M ISO 1660		
NAME	DATE	
Drawn	N WITTS	09.08.06
Checked	N.WITTS	09.08.06
Approved	N.WITTS	09.08.06

Material
Finish
Dimensions In MM
0.0 ± 0.25mm
0.00 ± 0.10mm
0.000 ± 0.025mm
Angles ± 1°

Part No. BG 1 9 7 3 2 Size A4

Description MC-12P-M-ST SHORTING PLUG WITH CHAIN

Drawing No. BG 1 9 7 3 2 Rev B

Scale NTS SHEET 1 OF 1