

Continuous light element, with integrated LED, yellow, 24 V AC/DC,  
Diameter 70 mm



General technical data	
Product brand name	SIRIUS
Product designation	Continuous light element
Design of the optical signal	continuous light
Type of voltage of the operating voltage	AC/DC
Operating voltage	
• 1 at DC rated value	24 V
• 1 at AC at 50 Hz rated value	24 V
• 1 at AC at 60 Hz rated value	24 V
Relative positive tolerance of the operating voltage	10 %
Relative negative tolerance of the operating voltage	-10 %
Consumed current maximum	35 mA
Service life of LED	100 000 h
Material	PC
Color	yellow
Mounting type	Bayonet
Reference code	
• acc. to DIN EN 61346-2	P
• acc. to DIN EN 81346-2	P

## Mechanical data

Outer diameter of the signal column element	70 mm
---	-------





## Lamp

Product component Light source	Yes
Type of light source	LED
Light intensity	1.18 cd
Light intensity	0.81 ... 1.65 cd

## Ambient conditions

Ambient temperature during operation	-20 ... +50 °C
Protection class IP	IP65
Height	65.5 mm
Width	70 mm

## Certificates/ approvals

General Product Approval	EMC	Declaration of Conformity	other
 UL		 RCM	 EG-Konf.
		<a href="#">Miscellaneous</a>	<a href="#">Confirmation</a>

## Further information

Information- and Downloadcenter (Catalogs, Brochures,...)

[www.siemens.com/sirius/catalogs](http://www.siemens.com/sirius/catalogs)

Industry Mall (Online ordering system)

<https://mall.industry.siemens.com/mall/en/en/Catalog/product?mlfb=8WD4420-5AD>

Cax online generator

<http://support.automation.siemens.com/WW/CAXorder/default.aspx?lang=en&mlfb=8WD4420-5AD>

Service&Support (Manuals, Certificates, Characteristics, FAQs,...)

<https://support.industry.siemens.com/cs/ww/en/ps/8WD4420-5AD>

Image database (product images, 2D dimension drawings, 3D models, device circuit diagrams, EPLAN macros, ...)

[http://www.automation.siemens.com/bilddb/cax\\_de.aspx?mlfb=8WD4420-5AD&lang=en](http://www.automation.siemens.com/bilddb/cax_de.aspx?mlfb=8WD4420-5AD&lang=en)

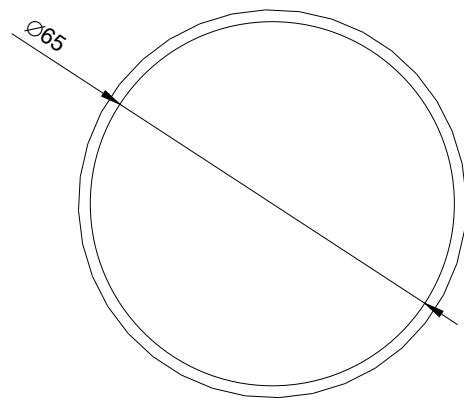
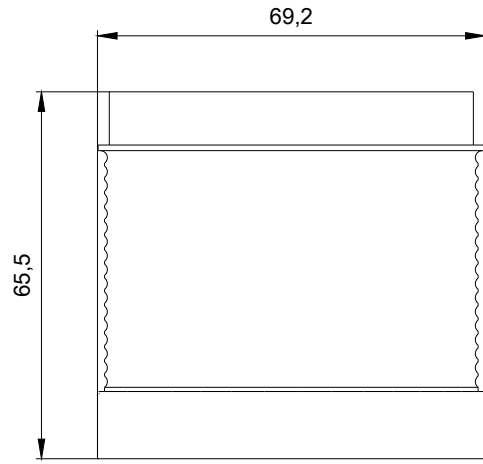

last modified:

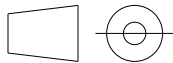

WS 4444;  
 W6.8333; 8WD44...\_ALL  
 11/29/2019