

AS-Interface module, 2 safe inputs, 1 LED, red, Spring-type terminal (Push-in), for floor mounting



Product brand name	SIRIUS ACT
Product designation	AS-Interface module
Product type designation	3SU1
General technical data	
Product function	2F-DI / 1 LED
Degree of pollution	3
Type of voltage	
• of the operating voltage	DC
• of the input voltage	DC
Consumed current	
• maximum	60 mA
Protection class IP	IP20
Shock resistance	
• for railway applications acc. to DIN EN 61373	Category 1, Class B
Vibration resistance	
• for railway applications acc. to DIN EN 61373	Category 1, Class B
Reference code acc. to DIN 40719 extended according to IEC 204-2 acc. to IEC 750	A
Reference code acc. to DIN EN 81346-2	K

Reference code acc. to DIN EN 61346-2	K
Design of the slave type	2 F-DI + 1 LED
AS interface slave profile	S-7.B.0
ID1 code	0...F
Number of AS-i slaves	1
Protocol is supported ASIsafe (Safety at work) protocol	Yes
Operating voltage	
• rated value	18 ... 31.6 V
Operating voltage 1	
• at DC rated value	30 V

Communication/ Protocol	
Protocol is supported	
• AS-Interface protocol	Yes

Inputs/ Outputs	
Number of digital inputs	0
• safety-related	2
Number of digital outputs	1; For controlling the LED

Connections/ Terminals	
Type of electrical connection	Push-in terminal
Type of connectable conductor cross-sections	
• solid without core end processing	1x (0.14 ... 0.5 mm ²)
• finely stranded without core end processing	1x (0.2 ... 0.5 mm ²)
• at AWG conductors	1x (26 ... 20)

Lamp	
Color of the light source	red

Product Function	
Suitability for use	
• safety-related circuits	Yes

Safety related data	
Safety Integrity Level (SIL) acc. to IEC 61508	3
SIL Claim Limit (subsystem) acc. to EN 62061	SILCL 3
Performance level (PL) acc. to EN ISO 13849-1	e
Safe failure fraction (SFF)	99 %
Average diagnostic coverage level (DC _{avg})	99 %
PFHD with high demand rate acc. to EN 62061	0.0000000048 1/h
PFDA _{avg} with low demand rate acc. to IEC 61508	0.000005
Category acc. to EN 954-1	4

Ambient conditions	
Ambient temperature	

- during operation
- during storage

-25 ... +70 °C

-40 ... +80 °C

Environmental category during operation acc. to IEC 60721

3M6, 3S2, 3B2, 3K6 (with relative air humidity of 10 ... 95 %, no condensation in operation permitted)

Installation/ mounting/ dimensions

Mounting type

- of modules and accessories
- of AS-i slaves

Floor mounting

Floor mounting

Height

54.6 mm

Width

25.9 mm

Depth

36.7 mm

Certificates/ approvals

General Product Approval

EMC

Functional Safety/Safety of Machinery

Declaration of Conformity



[Type Examination Certificate](#)



[Miscellaneous](#)

Test Certificates

other

[Type Test Certificates/Test Report](#)

[Special Test Certificate](#)



ASi

[Confirmation](#)

Further information

Information- and Downloadcenter (Catalogs, Brochures,...)

<https://www.siemens.com/ic10>

Industry Mall (Online ordering system)

<https://mall.industry.siemens.com/mall/en/en/Catalog/product?mfb=3SU1401-2EE20-6AA0>

Cax online generator

<http://support.automation.siemens.com/WW/CAXorder/default.aspx?lang=en&mfb=3SU1401-2EE20-6AA0>

Service&Support (Manuals, Certificates, Characteristics, FAQs,...)

<https://support.industry.siemens.com/cs/ww/en/ps/3SU1401-2EE20-6AA0>

Image database (product images, 2D dimension drawings, 3D models, device circuit diagrams, EPLAN macros, ...)

http://www.automation.siemens.com/bilddb/cax_de.aspx?mfb=3SU1401-2EE20-6AA0&lang=en

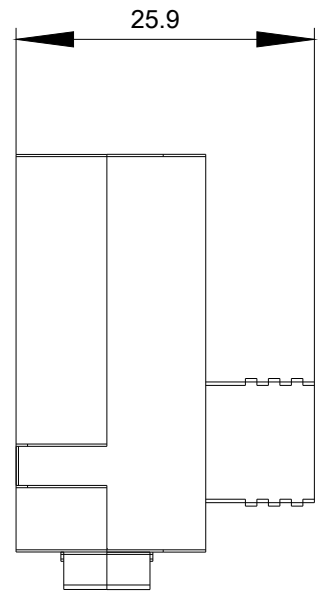
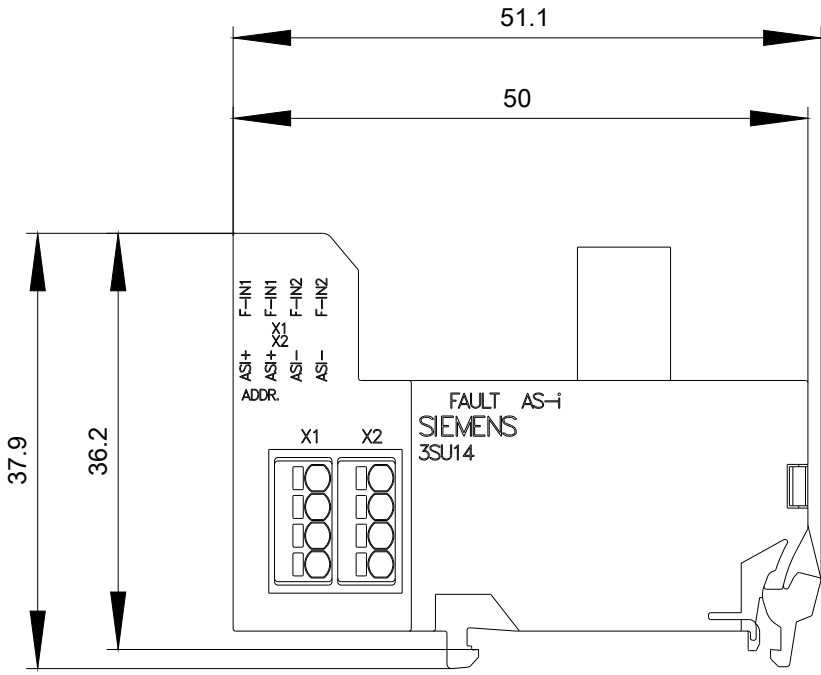

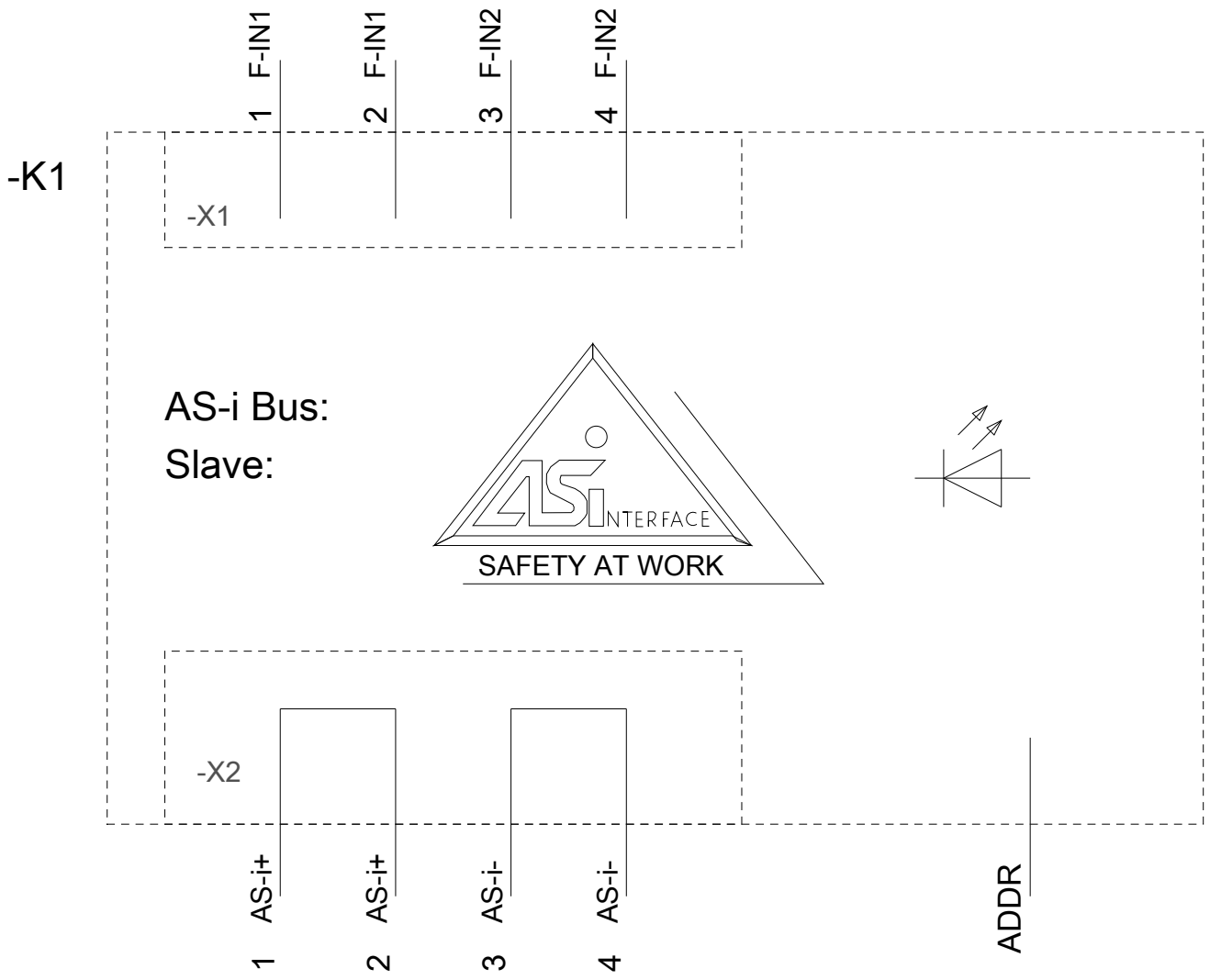

last modified:

03/10/2020