

AS-Interface module, 2 safe inputs, black, Spring-type terminal (Push-in), for input/output, for floor mounting

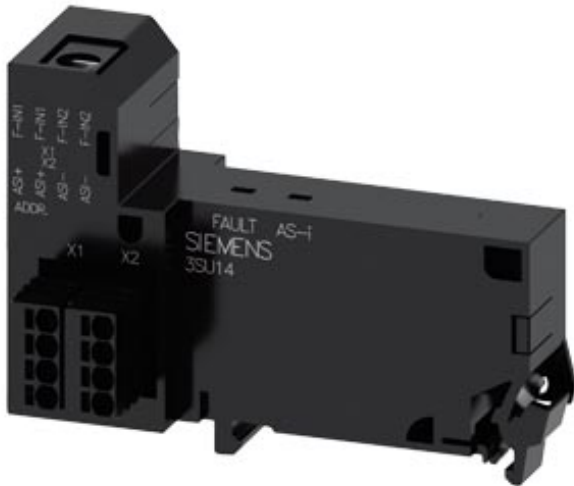

Product brand name	SIRIUS ACT
Product designation	AS-Interface module
Product type designation	3SU1
<b>General technical data</b>	
Product function	2F-DI
Degree of pollution	3
Type of voltage	
• of the operating voltage	DC
• of the input voltage	DC
Consumed current	
• maximum	60 mA
Protection class IP	IP20
Shock resistance	
• for railway applications acc. to DIN EN 61373	Category 1, Class B
Vibration resistance	
• for railway applications acc. to DIN EN 61373	Category 1, Class B
Reference code acc. to DIN 40719 extended according to IEC 204-2 acc. to IEC 750	A
Reference code acc. to DIN EN 81346-2	K

Reference code acc. to DIN EN 61346-2	K
Design of the slave type	2 F-DI
AS interface slave profile	S-0.B.F
ID1 code	0...F
Number of AS-i slaves	1
Protocol is supported ASIsafe (Safety at work) protocol	Yes
<b>Operating voltage</b>	
• rated value	18 ... 31.6 V
<b>Operating voltage 1</b>	
• at DC rated value	30 V

#### Communication/ Protocol

<b>Protocol is supported</b>	
• AS-Interface protocol	Yes

#### Inputs/ Outputs

<b>Number of digital inputs</b>	0
• safety-related	2
<b>Number of digital outputs</b>	0

#### Connections/ Terminals

<b>Type of electrical connection</b>	Push-in terminal
<b>Type of connectable conductor cross-sections</b>	
• solid without core end processing	1x (0.14 ... 0.5 mm <sup>2</sup> )
• finely stranded without core end processing	1x (0.2 ... 0.5 mm <sup>2</sup> )
• at AWG conductors	1x (26 ... 20)

#### Product Function

<b>Suitability for use</b>	
• safety-related circuits	Yes

#### Safety related data

Safety Integrity Level (SIL) acc. to IEC 61508	3
SIL Claim Limit (subsystem) acc. to EN 62061	SILCL 3
Performance level (PL) acc. to EN ISO 13849-1	e
<b>Safe failure fraction (SFF)</b>	99 %
<b>Average diagnostic coverage level (DCavg)</b>	99 %
<b>PFHD with high demand rate acc. to EN 62061</b>	0.0000000048 1/h
<b>PFDAvg with low demand rate acc. to IEC 61508</b>	0.000005
<b>Category acc. to EN 954-1</b>	4

#### Ambient conditions

<b>Ambient temperature</b>	
• during operation	-25 ... +70 °C
• during storage	-40 ... +80 °C

Environmental category during operation acc. to IEC 60721	3M6, 3S2, 3B2, 3C3 (without salt spray), 3K6 (with relative humidity of 10 ... 95%, no condensation in operation permitted)
---	---

**Installation/ mounting/ dimensions**

<b>Mounting type</b>	
<ul style="list-style-type: none"> <li>• of modules and accessories</li> <li>• of AS-i slaves</li> </ul>	<p>Floor mounting</p> <p>Floor mounting</p>
<b>Height</b>	54.6 mm
<b>Width</b>	25.9 mm
<b>Depth</b>	32.5 mm

**Certificates/ approvals**

<b>General Product Approval</b>	<b>EMC</b>	<b>Functional Safety/Safety of Machinery</b>	<b>Declaration of Conformity</b>
---------------------------------	------------	--	----------------------------------



[Type Examination Certificate](#)



[Miscellaneous](#)

<b>Test Certificates</b>	<b>other</b>
--------------------------	--------------

[Type Test Certificates/Test Report](#)

[Special Test Certificate](#)



ASi

[Confirmation](#)

**Further information**

**Information- and Downloadcenter (Catalogs, Brochures,...)**

<https://www.siemens.com/ic10>

**Industry Mall (Online ordering system)**

<https://mall.industry.siemens.com/mall/en/en/Catalog/product?mlfb=3SU1400-2EA10-6AA0>

**Cax online generator**

<http://support.automation.siemens.com/WW/CAXorder/default.aspx?lang=en&mlfb=3SU1400-2EA10-6AA0>

**Service&Support (Manuals, Certificates, Characteristics, FAQs,...)**

<https://support.industry.siemens.com/cs/ww/en/ps/3SU1400-2EA10-6AA0>

**Image database (product images, 2D dimension drawings, 3D models, device circuit diagrams, EPLAN macros, ...)**

[http://www.automation.siemens.com/bilddb/cax\\_de.aspx?mlfb=3SU1400-2EA10-6AA0&lang=en](http://www.automation.siemens.com/bilddb/cax_de.aspx?mlfb=3SU1400-2EA10-6AA0&lang=en)

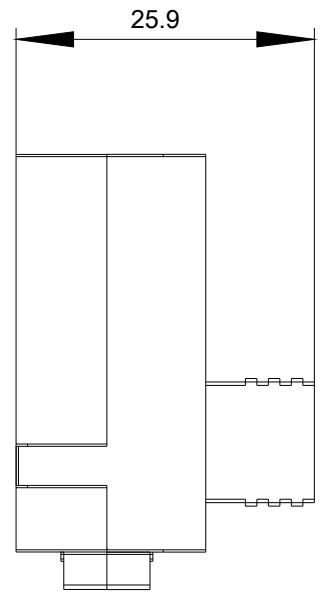
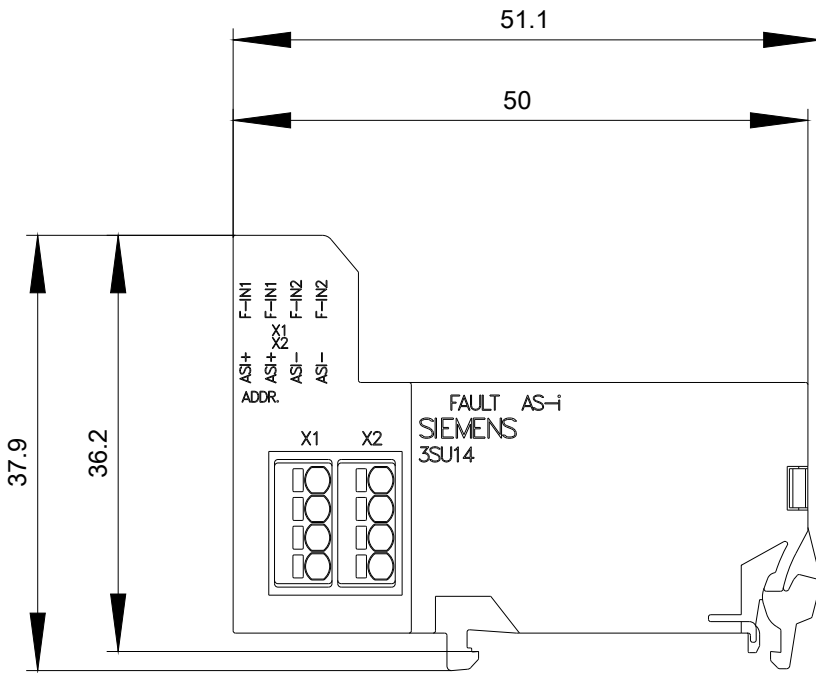

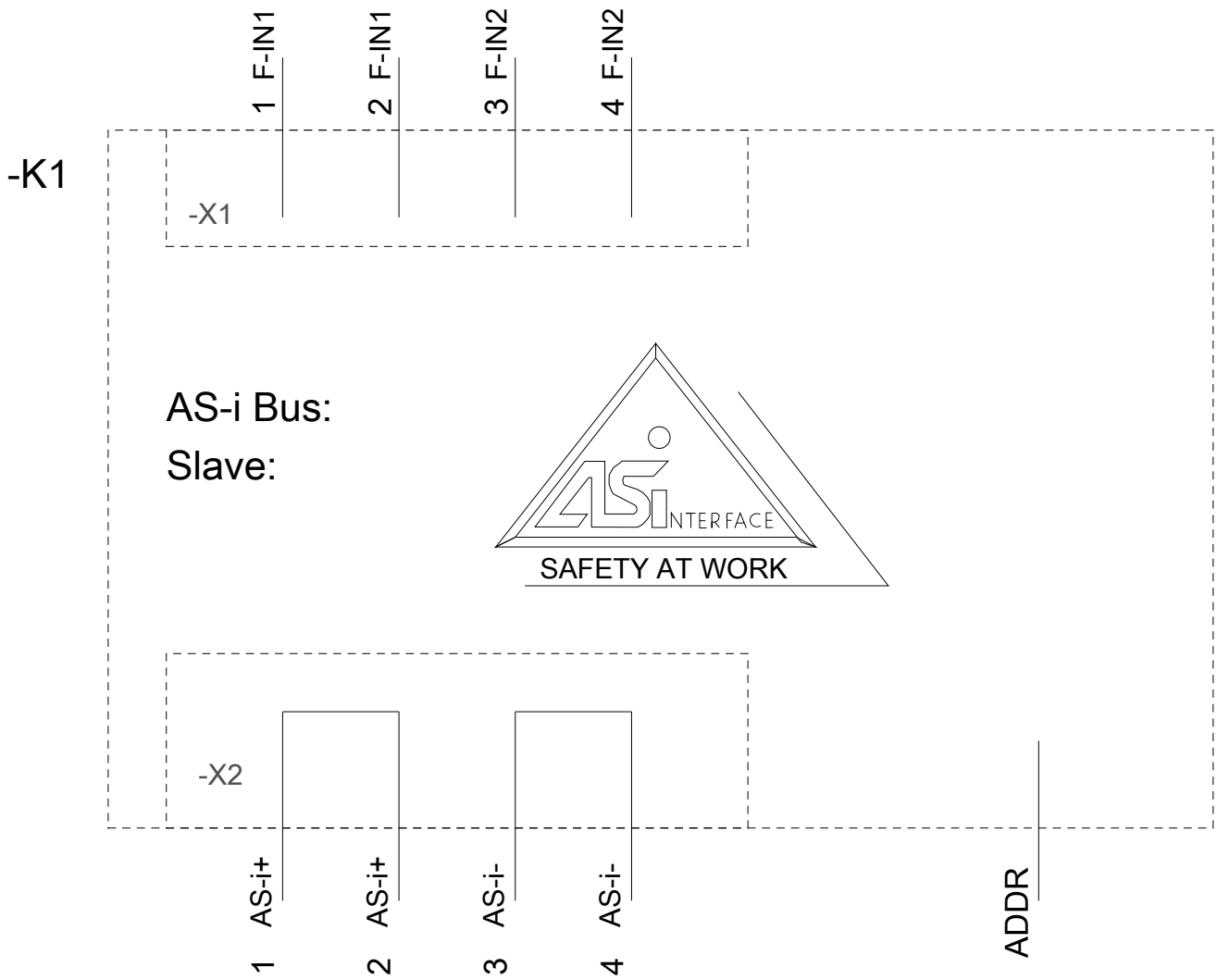

last modified:

03/10/2020