



Model Number

NJ2-8GM40-E0

Features

- 2 mm flush

Accessories

BF 8

Mounting flange, 8 mm

Technical Data

General specifications

Switching element function		NPN	NO
Rated operating distance	s_n	2 mm	
Installation		non-flush	
Output polarity		DC	
Assured operating distance	s_a	0 ... 1.62 mm	
Reduction factor r_{Al}		0.4	
Reduction factor r_{Cu}		0.3	
Reduction factor r_{304}		0.7	

Nominal ratings

Operating voltage	U_B	10 ... 60 V
Switching frequency	f	0 ... 1500 Hz
Hysteresis	H	1 ... 15 typ. 5 %
Reverse polarity protection		reverse polarity protected
Short-circuit protection		pulsing
Voltage drop	U_d	≤ 2.5 V

Voltage drop at I_L

Voltage drop $I_L = 10$ mA, switching element 1 ... 2.2 V typ. 1.6 V on U_d

Voltage drop $I_L = 20$ mA, switching element 0.9 ... 2.4 V typ. 1.7 V on U_d

Voltage drop $I_L = 50$ mA, switching element 1.2 ... 2.4 V typ. 1.8 V on U_d

Voltage drop $I_L = 100$ mA, switching element on U_d 1.4 ... 2.6 V typ. 2 V

Operating current I_L 0 ... 100 mA

Lowest operating current I_m 0 mA

Off-state current I_r ≤ 0.1 mA

Off-state current $T_U = 40$ °C, switching element off ≤ 100 μ A

No-load supply current I_0 ≤ 15 mA

Time delay before availability t_v ≤ 20 ms

Switching state indicator LED, yellow

Ambient conditions

Ambient temperature -25 ... 70 °C (-13 ... 158 °F)

Storage temperature -40 ... 85 °C (-40 ... 185 °F)

Mechanical specifications

Connection type cable PUR, 2 m

Core cross-section 0.14 mm²

Housing material stainless steel (303/1.4305)

Sensing face PBT

Degree of protection IP67

Compliance with standards and directives

Standard conformity

Standards	EN 60947-5-2:2007 IEC 60947-5-2:2007
-----------	---

Approvals and certificates

UL approval	cULus Listed, General Purpose
CSA approval	cCSAus Listed, General Purpose
CCC approval	Certified by China Compulsory Certification (CCC)

Dimensions

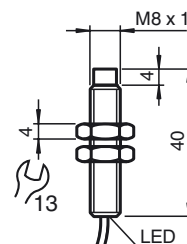

Electrical Connection

