

arrangement of pins and bushes see page 2 and 3

|   |  |  |  |   |                          |   |  |                        |
|---|--|--|--|---|--------------------------|---|--|------------------------|
|   |  | All Dimensions in mm<br>Original Size DIN A4 |  | Scale<br>2:1  | Free size tol.           |   | Ref.   |                        |
|   |  | All rights reserved<br>Department EL PD - DE |  | Created by<br>FINKEV                                | Inspected by<br>BERGHORN | Standardisation<br>TIEMANNA                 | Date<br>2016-12-07                                       |                        |
| 09 14 000 9909<br>09 14 000 9908<br>part number |  | guide bush<br>guide pin<br>description       |  | HARTING Electric GmbH & Co. KG<br>D-32339 Espelkamp |                          | Title<br><b>Han-Modular Fuehrungsstifte</b> |  | State<br>Final Release |
|   |  |  |  | Type<br>TB  | Number<br>09 14 000 990X |   | Doc-Key / ECM-Nr.<br>100175794/UGD/003/C<br>500000112380 |                        |
|   |  |  |  |   |                          | Rev.<br>C                                   | Page<br>1/3  |                        |

1 2 3 4 5 6

# coding system with guide pins and bushes

for hoods/housings with one frame or hinged frame

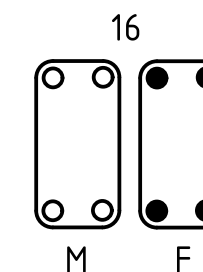
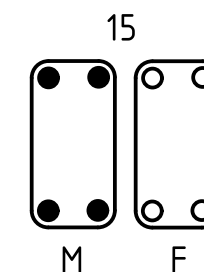
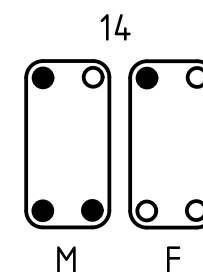
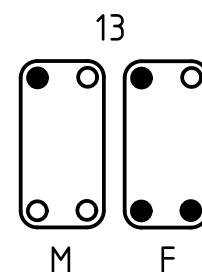
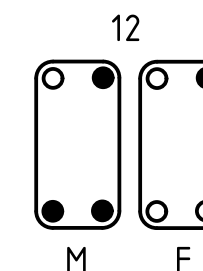
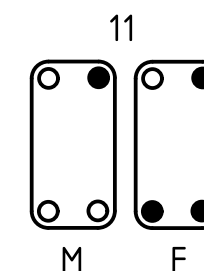
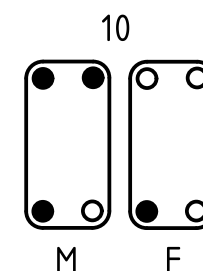
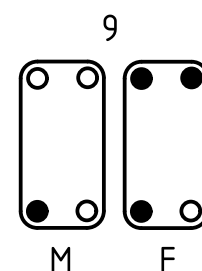
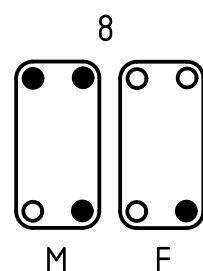
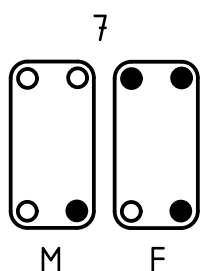
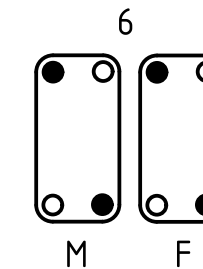
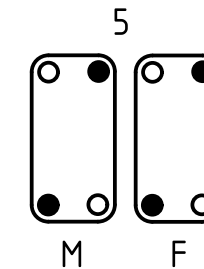
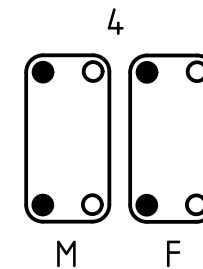
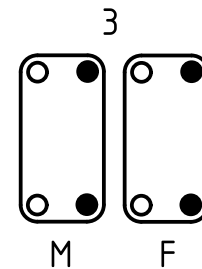
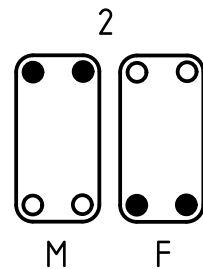
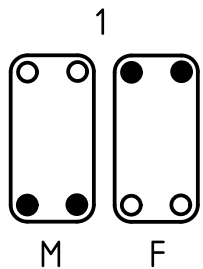

- F - frame or hinged frame for hoods
- M - frame or hinged frame for housings
- - guide pins
- - guide bushes

|   |                       |                                      |                          |                             |                    |  |             |
|---|-----------------------|--------------------------------------|--------------------------|-----------------------------|--------------------|--|-------------|
|   | All rights reserved   | Created by<br>FINKEV                 | Inspected by<br>BERGHORN | Standardisation<br>TIEMANNA | Date<br>2016-12-07 | State<br>Final Release                                   |             |
|   | Department EL PD - DE | Title<br>Han-Modular Fuehrungsstifte |                          |                             |                    | Doc-Key / ECM-Nr.<br>100175794/UGD/003/C<br>500000112380 |             |
| HARTING Electric GmbH & Co. KG<br>D-32339 Espelkamp |                       | Type<br>TB                           | Number<br>09 14 000 990X |                             |                    | Rev.<br>C  | Page<br>2/3 |

# coding system with code pins

for hoods/housings with two frame or two hinged frame

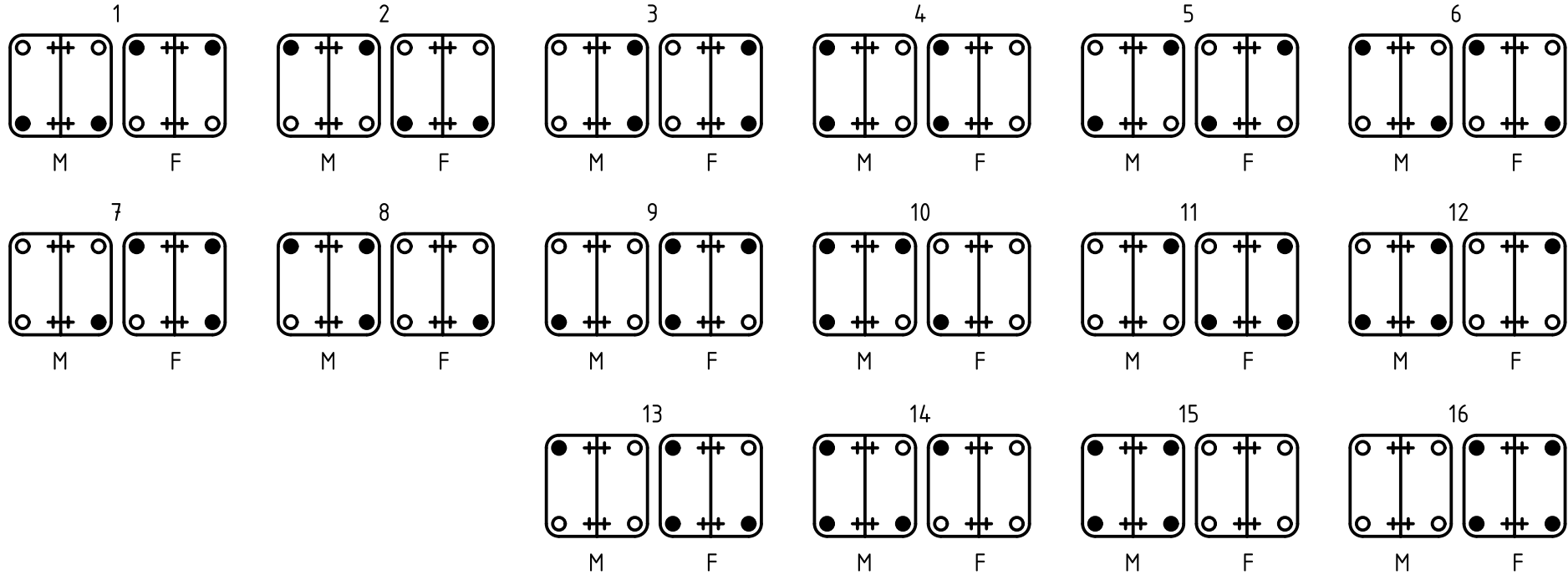

- F - frame or hinged frame for hoods
- M - frame or hinged frame for housings
- - guide pins
- - guide bushes
- + - mounting screw

|   |                       |                                      |                          |                             |                    |  |             |
|---|-----------------------|--------------------------------------|--------------------------|-----------------------------|--------------------|--|-------------|
|   | All rights reserved   | Created by<br>FINKEV                 | Inspected by<br>BERGHORN | Standardisation<br>TIEMANNA | Date<br>2016-12-07 | State<br>Final Release                                   |             |
|   | Department EL PD - DE | Title<br>Han-Modular Fuehrungsstifte |                          |                             |                    | Doc-Key / ECM-Nr.<br>100175794/UGD/003/C<br>500000112380 |             |
| HARTING Electric GmbH & Co. KG<br>D-32339 Espelkamp |                       | Type<br>TB                           | Number<br>09 14 000 990X |                             |                    | Rev.<br>C  | Page<br>3/3 |