

## Kit Content

	36rxn	
Syringe	36	set
Elution Tube	36	pcs
AD10100 Cartridge	36	set
AD10100 Column Set	36	set
AD10100 Tip Set	36	set
EtOH Tube	36	pcs
Sample Tube	36	pcs
Proteinase K	11x4	mg
PK Solvent	5	ml

## Kit Storage

Upon arrival,

1. Please store **Proteinase K** at **-20 °C** for long term storage.
2. Solvent and consumables, please store at 15-25 °C.

## Kit Preparation

### 1. Prepare 10 mg/ml Proteinase K

For 11 mg Proteinase K, please add 1.1 ml PK Solvent into tube and vortex thoroughly for dissolving. After dissolving into solvent, please store in 4°C for 6 month or -20°C for 1 year.

## Step by Step to start a AD10100 Purification Run

1. On the **Start** screen: Click “ENTER” button to enter the HOME screen.
2. On the **HOME** screen: Click “Purification” icon to start a purification run.

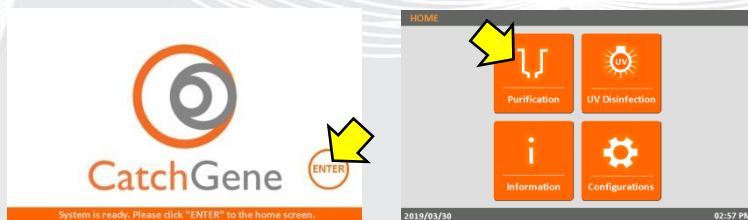

### 3. Please choose Cat. No.

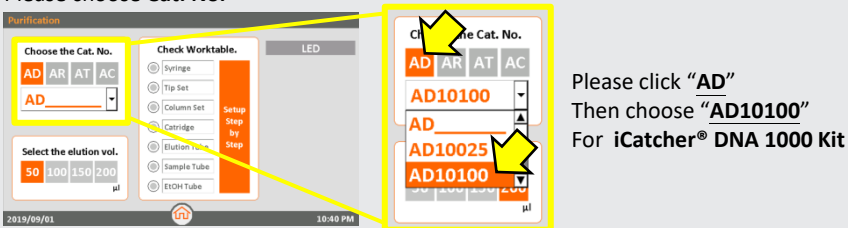

### 4. Choose Elution Vol.

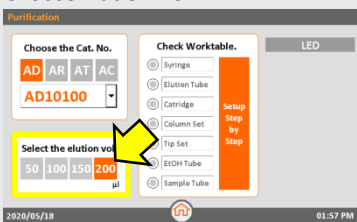

We suggest to elute in **200µl** for iCatcher® DNA 1000 Kit.

### 5. Insert the Syringe into the groove of Syringe Seat and push it to the end.

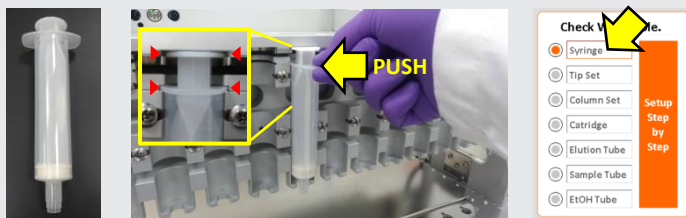

Check the **Syringe**.

6. Place **Tip Set** on **Tip Set** position and press into bottom.

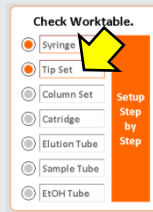
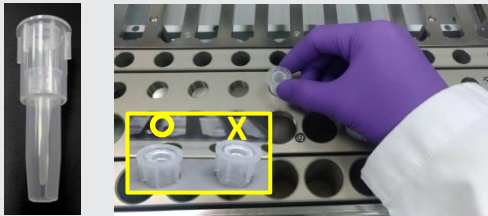

Check the **Tip Set**.

7. Insert **Column Set** into **Column Set** position and press into bottom.



Check the **Column Set**.

8. Insert the front protrude part of **Cartridge** into **Cartridge** position and press the bottom down. Then remove the foil.

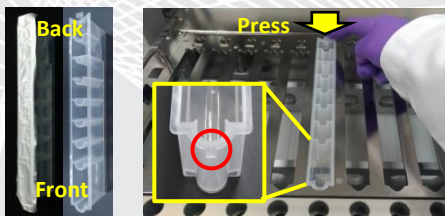

Check the **Cartridge**.

**Important! Please must remove the foil before running a protocol.**

9. Labeling , then open the lid and place the **Elution Tube** on the **Elution Tube** position.



Check the **Elution Tube**.

10. Prepare sample and load the Sample Tube into the **Sample Tube** position.



Check the **Sample Tube**.

1. Add 100  $\mu$ l Proteinase K (10 mg/ml) into the bottom of Sample Tube.
2. Transfer 1ml of whole blood sample into the Sample Tube.
3. Load the Sample Tube into the Sample Tube position of iCatcher (no need to mix or pipette it).

11. Add **15 ml** 100% EtOH into **EtOH Tube** and place on the **EtOH Tube** position.

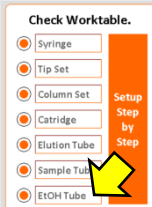
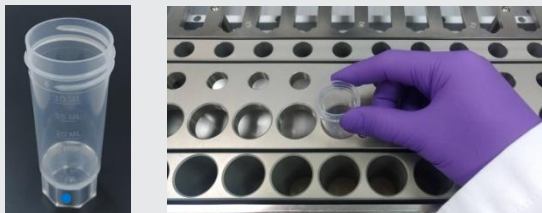

Add **15 ml** 100% EtOH for AD10100  
Check the **EtOH Tube**.  
Click "Go" to start purification.

**FOR RESEARCH USE ONLY**