

ATTACHING OR REMOVING SPACERS

You may need to remove the spacers to use your face mask platen.

1. If the platen is not in the forward position, press the moveable base button to move the platen forward.
2. Turn off the printer.
3. Remove the platen from the printer, if necessary.

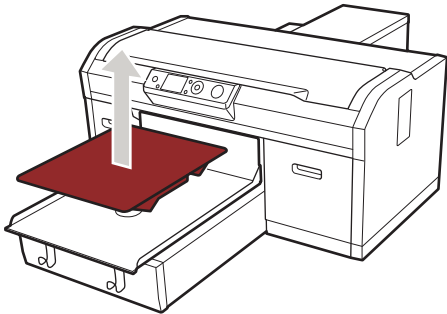

4. Rotate the fixing lever as shown to loosen it.

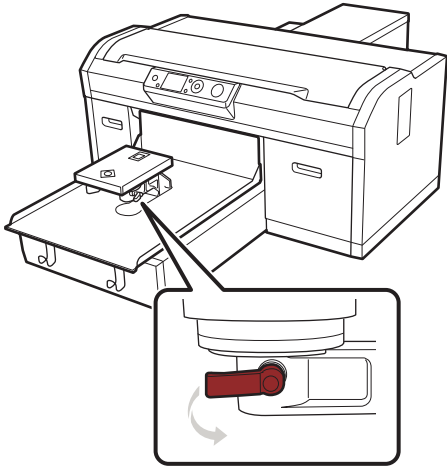

5. Remove the screw securing the parallel adjustment plate.

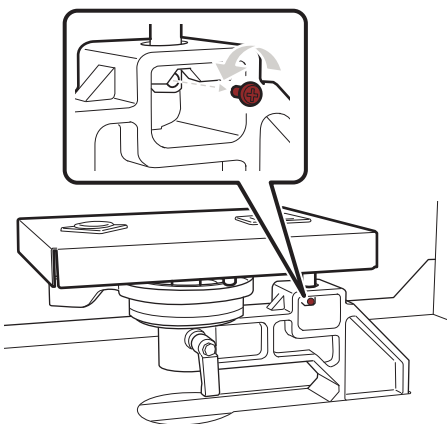

Note: Keep the screw in a safe place (you will need it when re-attaching both spacers).

6. Remove the parallel adjustment plate.

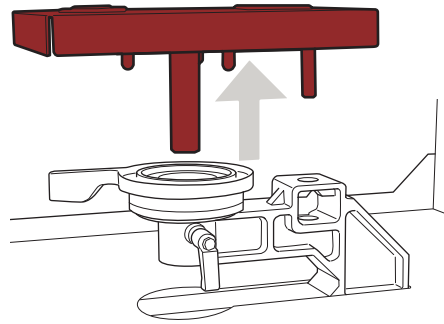

Caution: Be careful not to drop the parallel adjustment plate; it is a precision component.

7. Remove the height adjustment lever.

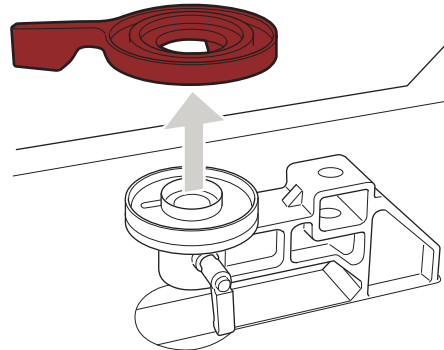

8. Remove both spacers beneath the height adjustment lever.

Removing

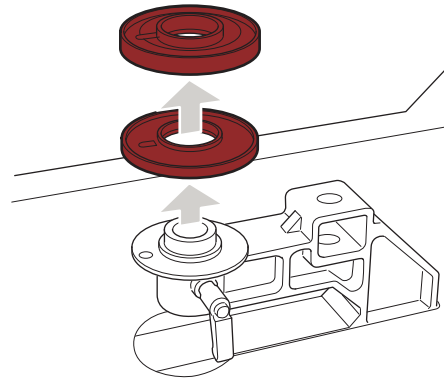

9. Replace the height adjustment lever.

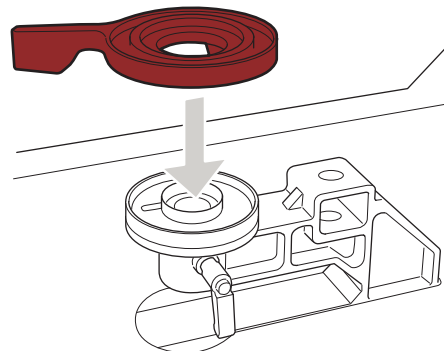

10. Reattach the parallel adjustment plate. Reinstall and tighten the screw that was removed in step 5 if you attached both spacers.

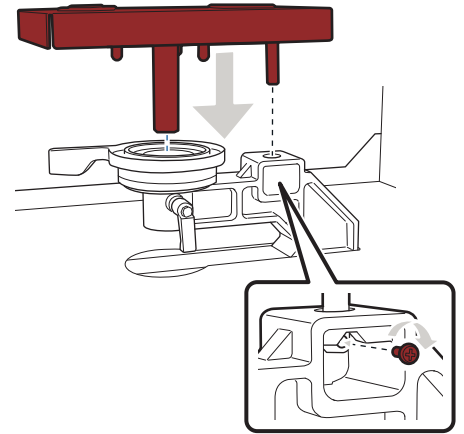

11. Rotate the fixing lever as shown to tighten it and secure the height adjustment lever.

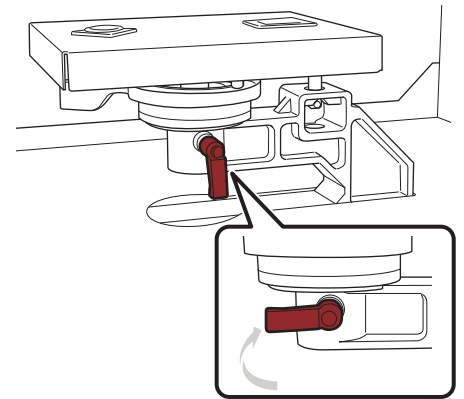

You May Now Install & Use the DTG Mask Platen

When Re-Attaching

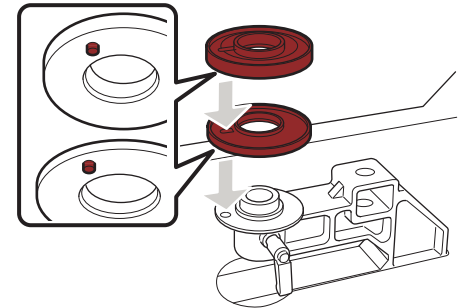

Note: Make sure the protruding sections of the spacers are aligned with the hole as shown.