

# Cartridge Replacement Instructions

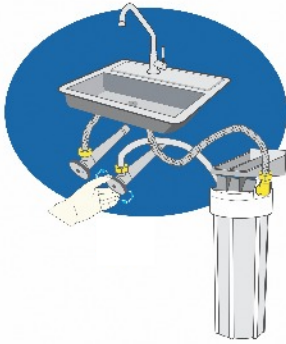

1. Stop water flow to filter by turning cold water shutoff valve clockwise.
2. Verify that cold water is off by trying to turn on cold water at the faucet.

3. Use the housing wrench to unscrew the bottom part of the housing as shown.

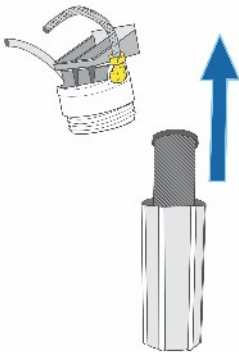
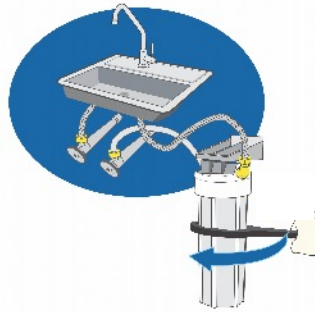

3. Discard the used filtration cartridge.

4. Drop new cartridge into bottom half of housing (a rubber o-ring must be facing up), and reattach bottom half of the housing.
5. Restore water flow to the unit. Let new cartridge flush for 5 minutes and check for leaks periodically.



## Notes

- The new cartridge may look different than the original one.
- For the first day or two, the water may appear cloudy from tiny air bubbles.
- Flow rate may be slower initially, but it will rise again over the first week.