

THE PROFESSIONALS CHOICE

# GB Chain Spinner .404"- 3/4"



**GB Chain Spinner**  
**GBCS-100**  
9312589850008



**IMPORTANT**  
Add drop of oil on rivet  
when spinning.

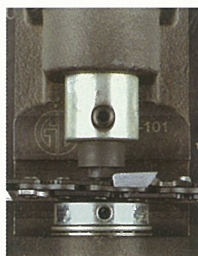
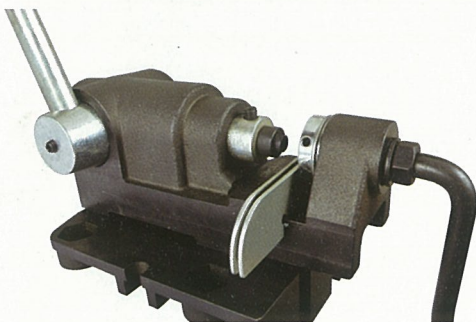
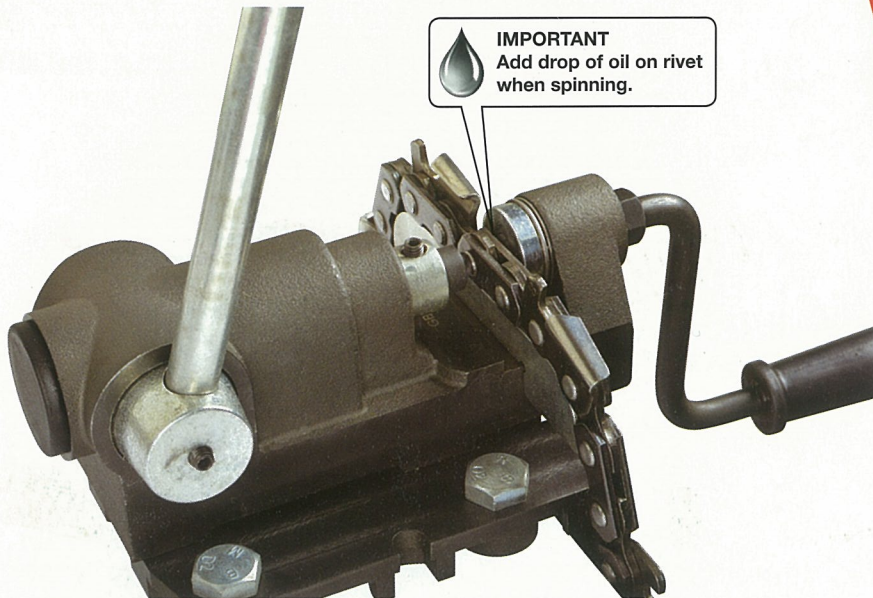

To suit:



Chain

## Parts List

Description	Part No.	Qty	Bar Code
Body	<b>GBCA-101</b>	1	9312589850022
Cam/Cam side	<b>GBCA-102</b>	1	9312589850039
Spring	<b>GBCA-103</b>	1	9312589850053
Handle	<b>GBCA-104A</b>	1	9312589850060
Handle extension	<b>GBCA-104B</b>	1	9312589850077
Base clamp bolt	<b>GBCA-105</b>	4	9312589850084
Hex Wrench 3mm	<b>GBCA-106</b>	1	9312589850091
M6*10	<b>GBCA-107</b>	2	9312589850107
Single ram	<b>GBCA-108</b>	1	9312589850114
Cover	<b>GBCA-109</b>	1	9312589850381
Hex wrench 2mm	<b>GBCS-101</b>	1	9312589850251
M4*10	<b>GBCS-102</b>	1	9312589850268
Spinner rotator	<b>GBCS-103</b>	1	9312589850275
Thrust bearing	<b>GBCS-104</b>	1	9312589850282
Spinner handle	<b>GBCS-105A</b>	1	9312589850299
Nut M10	<b>GBCS-105B</b>	1	9312589850305
Washer M10	<b>GBCS-105C</b>	1	9312589850312
.404 Spinner head	<b>GBCS-106A</b>	1	9312589850329
3/4" Spinner head	<b>GBCS-106B</b>	1	9312589850336
.404" Spinner anvil	<b>GBCS-107A</b>	1	9312589850343
3/4" Spinner anvil	<b>GBCS-107B</b>	1	9312589850350
.404 Spinner guide	<b>GBCS-108A</b>	1	9312589850367
3/4" Spinner guide	<b>GBCS-108B</b>	1	9312589850374



This device should only be used by trained personnel.





# Replacement Parts

## GB Chain Spinner .404" - 3/4"

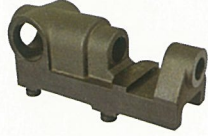

**GBCA-101**  
Body



**GBCA-102**  
Cam/Cam side



**GBCA-103**  
Spring



**GBCA-104A**  
Handle



**GBCA-104B**  
Handle extension



**GBCA-105**  
Base clamp bolt



**GBCA-106**  
Hex wrench 3mm



**GBCA-107**  
M6\*10



**GBCA-108**  
Single ram



**GBCA-109**  
Cover



**GBCS-101**  
Hex wrench 2mm



**GBCS-102**  
M4\*10



**GBCS-103**  
Spinner rotator



**GBCS-104**  
Thrust bearing



**GBCS-105A**  
Spinner handle



**GBCS-105B**  
Nut M10



**GBCS-105C**  
Washer M10



**GBCS-106A**  
.404" Spinner head



**GBCS-106B**  
.3/4" Spinner head



**GBCS-107A**  
.404" Spinner anvil



**GBCA-107B**  
3/4" Spinner anvil



**GBCS-108A**  
.404" Spinner guide



**GBCS-108B**  
3/4" Spinner guide



This device should only be used by trained personnel.