



P.O. Box 1719
 Corona, CA 92878
 Support: 951-493-7100
 www.aFepower.com

Intake Kit Installation Instructions: 2008 Ford Power Stroke V8-6.4L (td) Stage 2 Cx

Kit Part #	51 / 54 / 75-11262	Tools Required:	Part List:	2 Screws, #8-32 x 5/8"
Make:	Ford	5/16" nut driver	1 Air filter P/N (24-91039 or Pro-GUARD 7™)	2 Washers, M6 wavy
Model	Year	Engine	72-90049 or Pro Dry S™ 21-90049)	1 T-20 torx bit
Super Duty	2008	V8-6.4L (td)	1 Housing, powder coated wrinkle black	1 Tube
(F250/350/450/550)			1 Cover, aluminum	2 Clamps, #072
			1 Tube, intake	2 Clamps, #052
			4 Button head screws	1 Coupler straight 3" x 2"
			2 Screw, hex head M6 x 1 x 25	1 Coupler, hump 4-1/8" x 3"
			2 Washers, M6 flat	1 Grommet
			2 Nut, M6 hex	1 Clamp, mini #012
			1 MAF sensor gasket	



Step 1

Complete kit



Step 2

Complete stock intake.



Step 3

Remove filter minder out of air box. Loosen factory clamp with 5/16" nut driver. Disconnect MAF sensor harness.



Step 4

Take auxillary air line out of air box. Lift and pull firmly then remove OE air box out of vehicle.

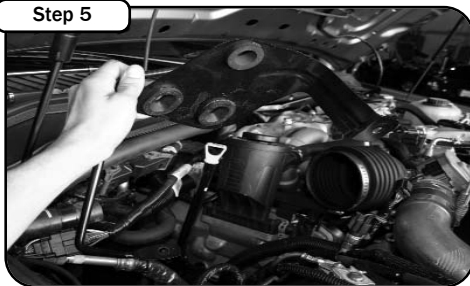

Step 5

With 13 mm socket with extension, loosen the 2 bolts that hold the OE air box bracket and remove out of vehicle.



Step 6

With T-20 torx bit provided loosen the two bolts holding in MAF sensor and remove. Remove grommet for filter minder. With screws and gasket provided, install MAF sensor into new intake tube. (make sure gasket is between sensor and tube) Re-install filter minder grommet into intake tube.

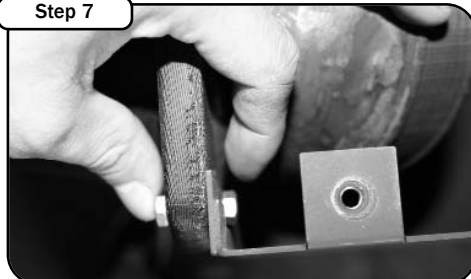

Step 7

Install tube outside of housing using M6 screws, nuts and washers provided and tighten.

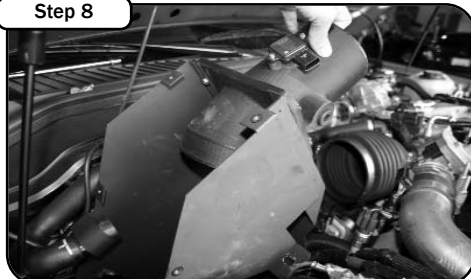

Step 8

Install intake into vehicle. Keep tabs in position of OE air box bracket.

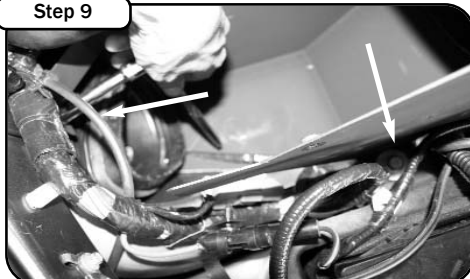

Step 9

With factory screws from step 5, mount new housing and tighten with 13 mm socket.



Step 10

Install air filter and tighten using 5/16" nut driver. Guide auxillary air line into the housing clip. Install aluminum cover. Use 4 button head screws and tighten using 5/32" allen key.



Step 11

With 5/16" nut driver loosen both clamps on turbo and air box side.



Step 12

With cutters or pliers break OE clamp. lift up and remove crank case line out of OE intake tube and remove.



Step 13

Install new tube with couplers and clamps provided. Tighten using 5/16" nut driver. Install grommet into tube.



Step 14

Re-install crank case line into new tube. Push down completely. Re-connect MAF sensor and filter minder.



Step 15

Your installation is now complete. Make sure all hoses and clamps are tight. Check and retighten connections and filter after a few hours of operation. Thank You for choosing aFe!

Note: Filter Cleaning and Re-oiling: When cleaning your aFe filter, be sure to use only aFe's "Restore Kit" (aFe P/N: 90-50001 blue oil aerosol, or aFe P/N: 90-50501 blue squeeze bottle oil or aFe P/N: 90-50000 gold oil aerosol, or aFe P/N: 90-50500 gold squeeze oil). Air Filter Replacement: P/N 24-91039 (black w/blue media) **Pro-GUARD 7™** P/N 72-90049 (black w/gold media) **Pro Dry S™** P/N 21-90049 (black w/white media) **Pro Dry S™** cleaning: see cleaning instruction sheet 06-00074