



**201014**

# DOOR MODULE

**VIDEO INTERCOM SYSTEM  
OUTDOOR CAMERA**

**USER MANUAL**

# 1. OVERVIEW

## A Series

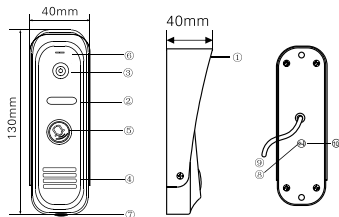

## B Series

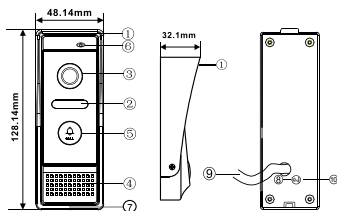

## C Series

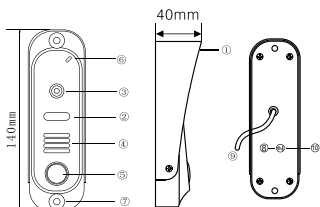

## D Series

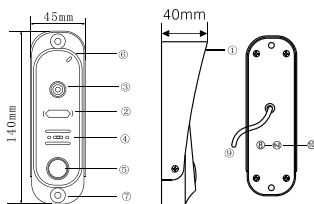

## E Series

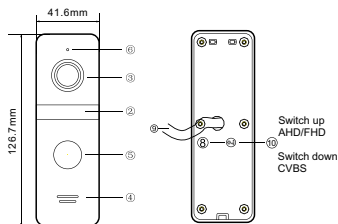

## F Series

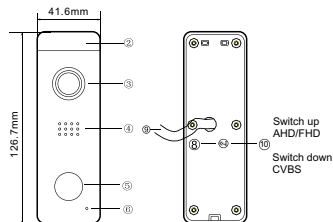

①	Weather shield	⑥	Microphone
②	IR LEDs	⑦	Screw slot
③	Camera	⑧	Volume regulator
④	Speaker	⑨	System port
⑤	Call button	⑩	CVBS and AHD/FHD signal switch button

## 2. WIRING DIAGRAM

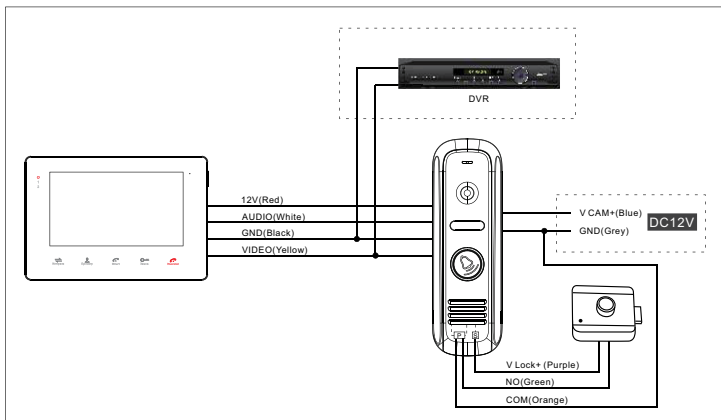

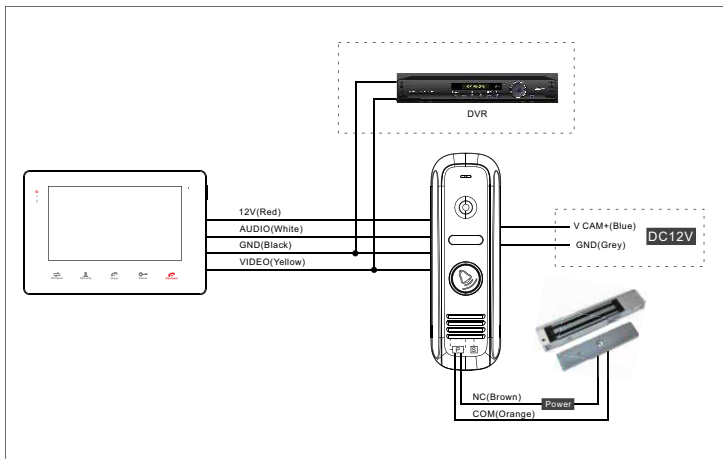
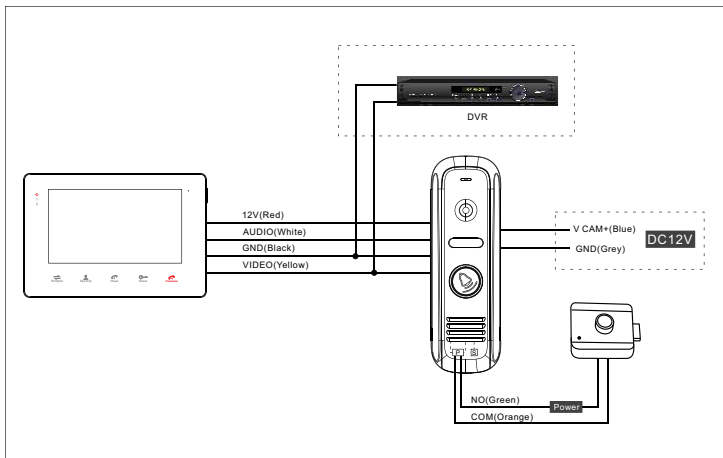

### 3.PRODUCT SPECIFICATIONS

	Analog Video Intercom System	AHD Video Intercom System	FHD Video Intercom System
Camera sensor	1/4 inch 1/3 inch CMOS camera	1/4 inch 1/3 inch CMOS camera	1/2.7 inch CMOS camera
View angle (A,B,C,D series)	60° /(120°)	60° /(120°)	80° /(120°)
View angle (E,F series)	90° /110°	90° /110°	130°
Definition(Hor.)	420/600/800TV Line	720P/960P	1080P
LEDs for night	IR LEDs(120°)		
Power consumption	150mA max.		
Power supplier	Supplied from indoor unit		
Operation temp	-40~+50℃		
Installation	Surface/flush mount		

Notice: A, B, C, D series included IR Cut function, E, F series without IR Cut function.

### 4.INSTALLATION DIAGRAM

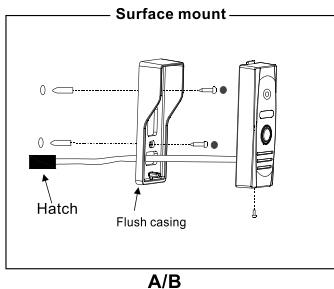
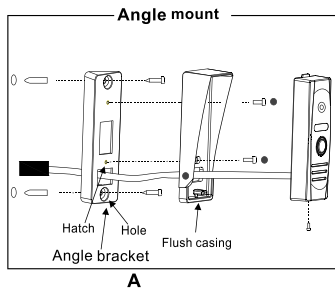

The speaker volume is too low ,how to increase it ?

- At the backside of outdoor unit, you can find out a regulator which is used to adjust the speaker volume, turn the regulator with the screwdriver to decrease/increase the speaker volume.  
Located in outside station backside, nearby sounds adjustment, you will found the dial code switch, down for CVBS signal, up for AHD/FHD.

## 5.INSTALLATION PROCESS OF OUTDOOR UNITS

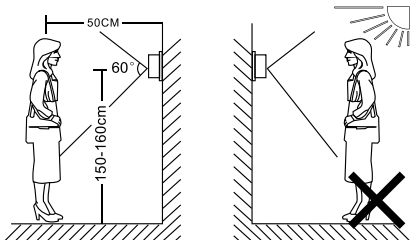

### NOTE:

- Avoid installation of the device near strong radiation e.g. AC motor and lift .
- Maintenance should be complied with qualified technician .
- Avoid hard shake , beating and collision ,otherwise the internal exact components maybe be damaged .
- Do not expose the outdoor camera under strong light or sunshine.
- Do not install the outdoor camera in the environment e.g. direct sunlight ,contact rain ,High temperature ,high humidity ,full of dust and chemistry corrosive.
- Select the most suitable position where the camera is located at user's eye level
- Switch off power supply before installation.
- Keep more than 30cm away from AC power supply to avoid external interference.
- Keep it away from the water and magnetic field.