

amphis

109001BB, 109001WW, 109001BW,
109001BB-24, 109001WW-24, 109001BW-24

LUNA

3 BLADE CEILING FAN

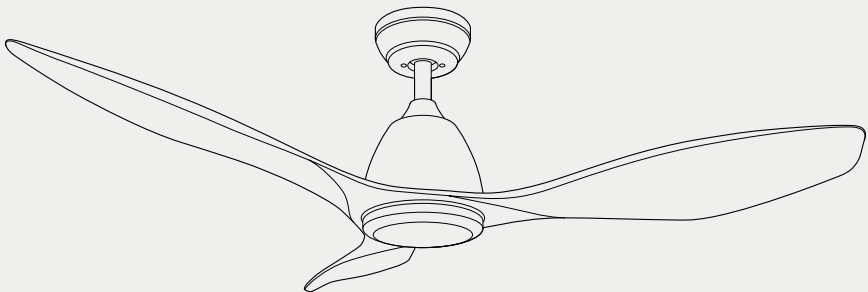

INSTALLATION MANUAL

LUNA - INSTALLATION MANUAL

Thank you for purchasing this quality Amphis product.
Please read carefully before installation.

WARRANTY

This Amphis product is covered by a 3-year residential warranty. The warranty period starts from date of purchase. Proof of purchase will be required.

Warranty will be void if the product is not assembled and installed by a licensed electrician, is used with a non-compatible dimmer, or if there is any damage due to improper usage or modification to the luminaire.

SAFETY INSTRUCTIONS

- 1 The installation **MUST** be carried out by a qualified electrician.
- 2 Turn off the main electrical switch at the circuit breaker fuse box before performing any installation or electrical works.
- 3 The ceiling fan must be grounded/earthed; electrical supply of 230V AC 50Hz.
- 4 The live and neutral supply wires must be connected to the wall switch (double poles) having a contact separation at least 3mm in all poles.
- 5 The ceiling fan must be mounted with the blades at least 2.3m from the floor to minimise the possibility of accidental contact with the fan blades.
- 6 When assembling the ceiling fan, ensure that the down rod is threaded firmly to the fan body. Make sure that the down rod screw is set tightly against the down rod after the ceiling fan is assembled to avoid unthreading.
- 7 Never install the ceiling fan in any area where ceiling fan could possibly get wet.
- 8 Never insert anything into the fan blades when the ceiling fan is in operation.
- 9 When installing, ensure that the rotating fan blades will not come into contact with any objects.
- 10 After ceiling fan is properly installed, ensure that all connections are secure to prevent ceiling fan from dropping.
- 11 It is recommended to examine the suspension system twice a year.

LUNA - INSTALLATION MANUAL

WARNING

- 1** To reduce the risk of fire or electric shock, never use the ceiling fan with any solidstate speed control device.
- 2** To reduce the risk of personal injury, do not bend the ceiling blades when installing, balancing the blades or cleaning the ceiling fan.
- 3** Use this unit **ONLY** in the manner intended by the manufacturer to avoid any hazards.
- 4** Ensure the fan switch is off before carrying out any maintenance or servicing job to avoid any hazards.

COMPONENTS

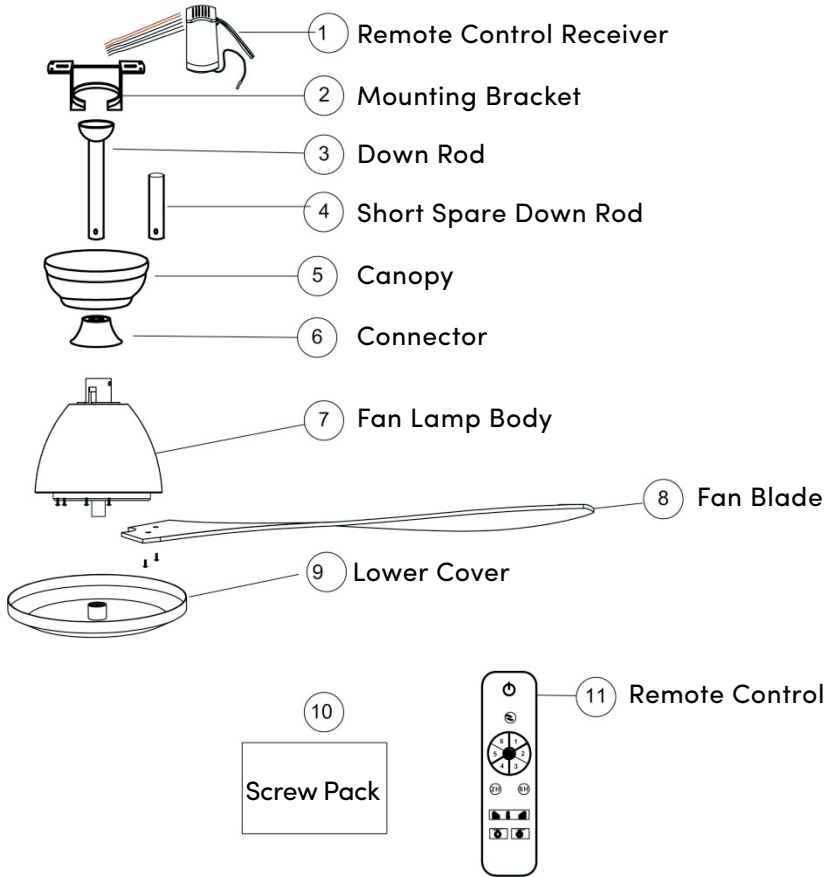

Figure 1

MOUNTING BRACKET INSTALLATION

NOTE Do not install mounting bracket if ceiling is leaking or damp. The ceiling must be able to withstand the weight of at least 40kg.

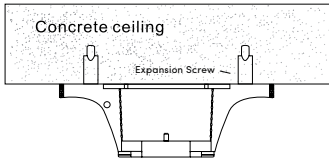

Figure 2

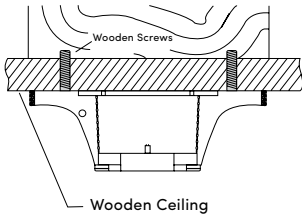

Figure 3

- 1 Concrete Ceiling** Drill two holes with an appropriate depth using an 8mm diameter drill bit and insert one expansion screw (not supplied) to each hole. Fix the mounting bracket into the expansion screws, and tighten it with the nuts of expansion screws. (Fig. 2)
- 2 Wooden Ceiling** Fix the mounting bracket to the wooden ceiling with four wooden screws. The thickness of wooden ceiling must be at least 7cm. (Fig. 3)

CEILING FAN INSTALLATION

- 1** Loosen the two screws of the fan body. (Fig. 4)
- 2** Take off the plug from the down rod by removing the R pin. Slide the down rod through the canopy and connector. Slide the fan body electrical wire through the down rod. Sit the down rod into the fan body and rotate the down rod until the holes on the down rod align with the holes of the fan body. Slide the plug through the holes and secure it with the R pin on the other side. Finally, tighten the other two screws. (Fig. 5)
- 3** Place the down rod with hanger ball into the mounting bracket. Rotate the hanger ball (or fan body) until the "Card Point" on the mounting bracket has dropped into the "Card Slot" on the hanger ball and is firmly secure. (Fig. 6)

LUNA - INSTALLATION MANUAL

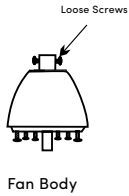

Figure 4

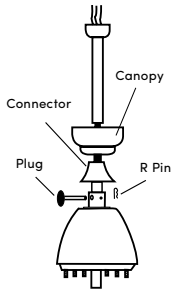

Figure 5

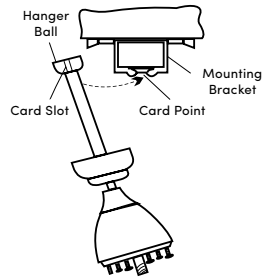
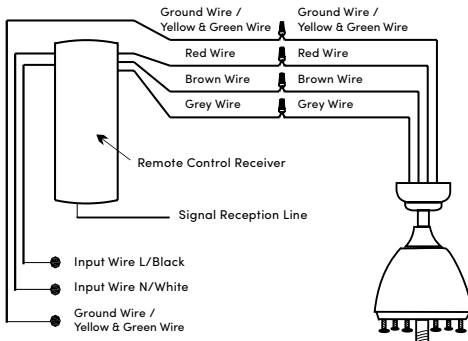

Figure 6

- 4 Connect electrical wires accurately according to the diagram. (Fig. 7)
- 5 After wires are connected, put the remote control receiver into the mounting bracket.(Fig. 8)
- 6 Raise up the canopy to the ceiling to cover the mounting bracket, making sure the canopy will sit into the two screws on the mounting bracket. Then rotate the canopy to ensure the screw heads are at the narrow end of the holes. (Fig. 9)
- 7 To attach fan blades, loosen and remove the six screws on the motor and set aside. Align



Remote Control Wiring Diagram

Figure 7

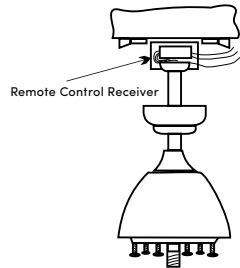

Figure 8

the two holes on the blade with the holes on the motor and secure the blade with two screws. Repeat for the remaining blades. (Fig. 10)

- 8 Secure the lower cover to the thread at the bottom of the fan by twisting the nut clockwise until firmly tight. (Fig.11)

LUNA - INSTALLATION MANUAL

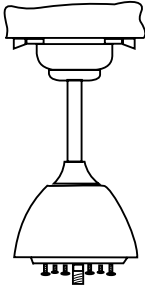

Figure 9

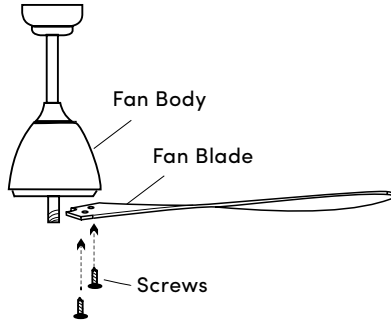

Figure 10

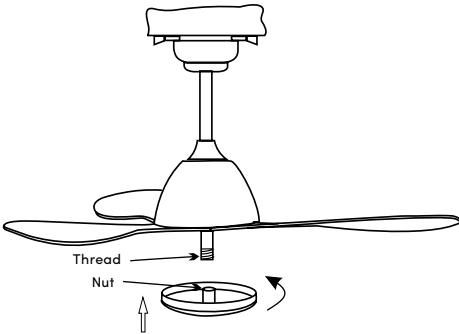
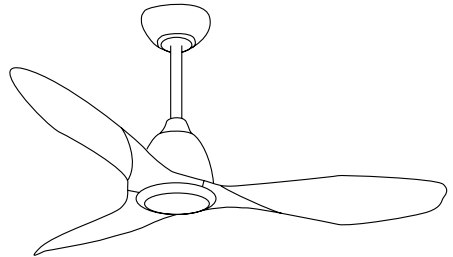

Figure 11



FAN RECEIVER PAIRING

- 1 Turn off the fan power supply and wait for 60 seconds.
- 2 Turn on the power supply again, have the transmitter pointed towards to the receiver (please ensure the batteries of the transmitter are installed correctly - indicator light is on)
- 3 Press and hold the "FAN ON/OFF" button at least 5 seconds, until hearing the long beep sound (1 second) of the receiver,
- 4 Pairing is now finished.

TUYA WIFI PAIRING

- 1 Search for and install “Tuya Smart” on your Android or IOS device. Create and account using your email account.
- 2 Once your account is all set up, go to the home screen and select “Add Device”. (Fig.12)

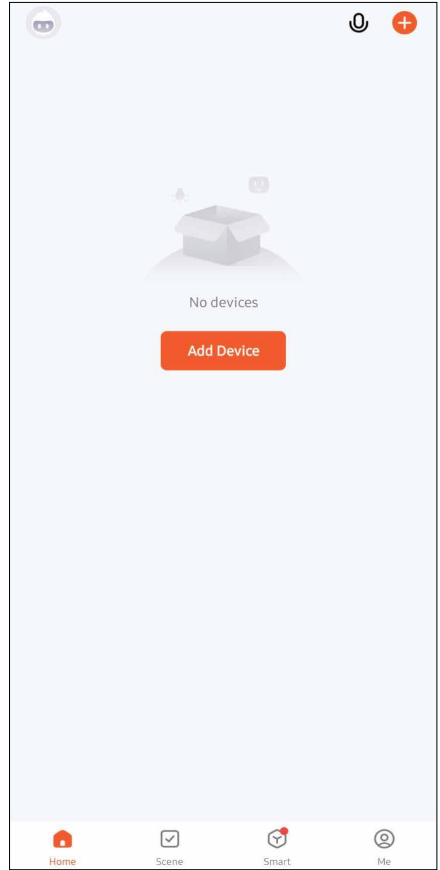

Figure 12

LUNA - INSTALLATION MANUAL

- 3 Select 'Lighting' from the left-hand side menu. (Fig.13)
- 4 Scroll down and select 'Ceiling Fan (Wi-Fi)'. (Fig.14)

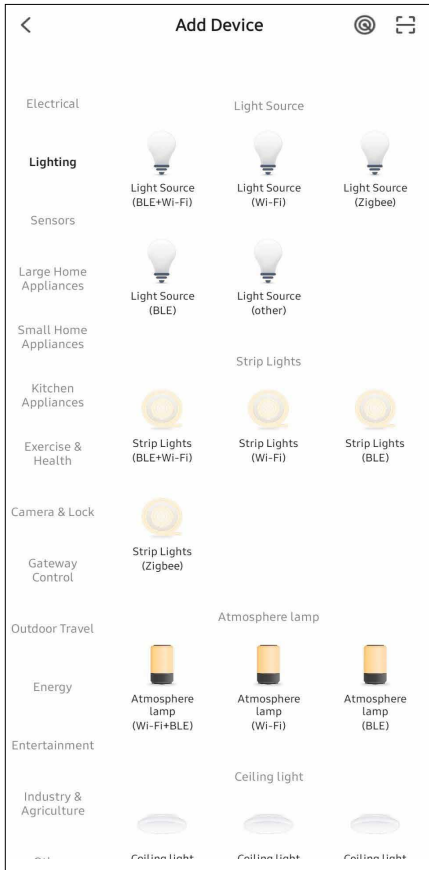

Figure 13

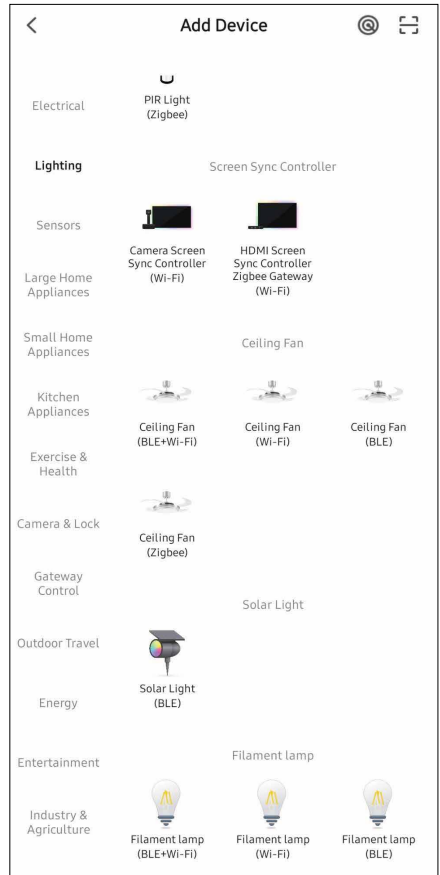

Figure 14

LUNA - INSTALLATION MANUAL

- 5 Type in your WiFi SSID and password, ensuring that you are connecting to a 2.4Ghz network. Choose 'Next'. (Fig.15)

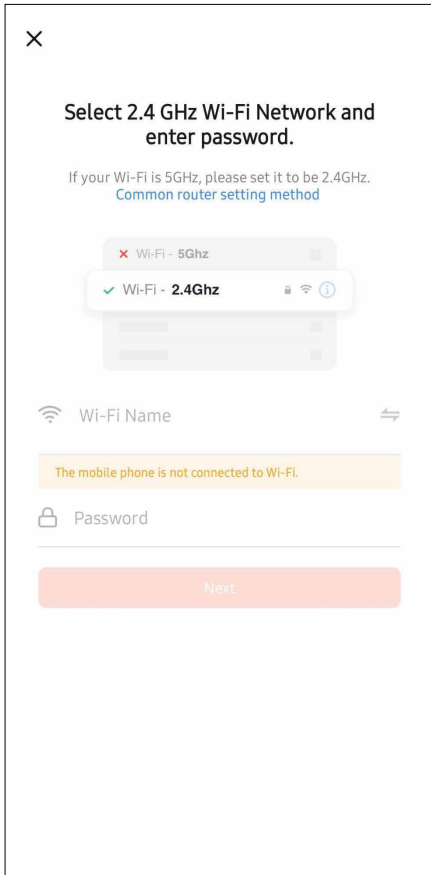

Figure 15

LUNA - INSTALLATION MANUAL

- 6 Once on the reset device page, do not select confirm as of yet. turn off the wall switch for the fan for at least 5 seconds and turn back on. Immediately after turning wall switch on and hearing single beep. Grab the remote and hold the '6H' button for 5 seconds or until you hear a long beep. A few seconds later, the fan will begin constantly beeping. Once you hear this, press the confirm button below. (Fig.16)
- 7 Select 'Blink quickly'. (Fig.17)

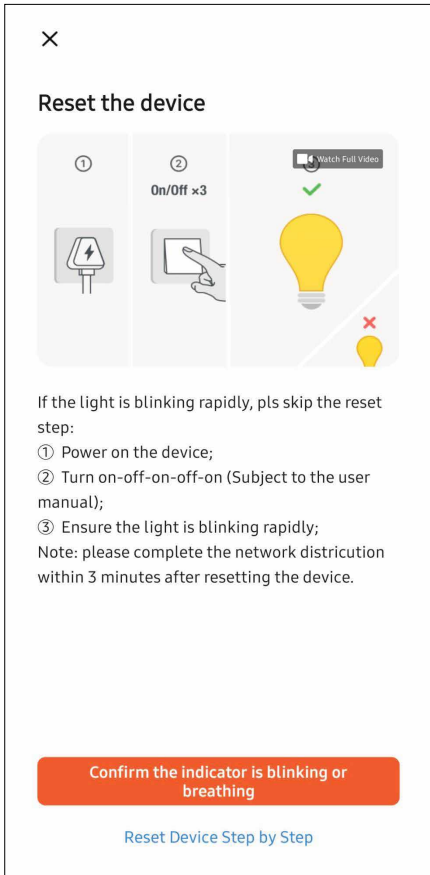

Figure 16

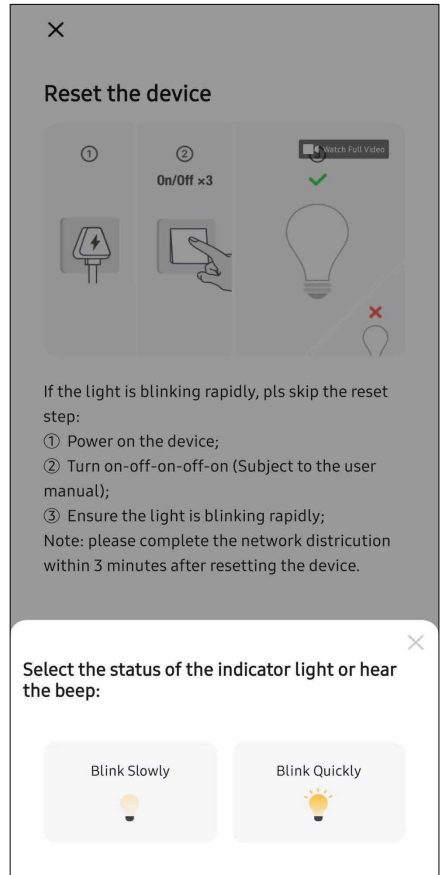

Figure 17

LUNA - INSTALLATION MANUAL

- 8 Allow the device to connect to network. (Fig.18)
- 9 Wait a few more moments and allow fan to be added. (Fig.19)

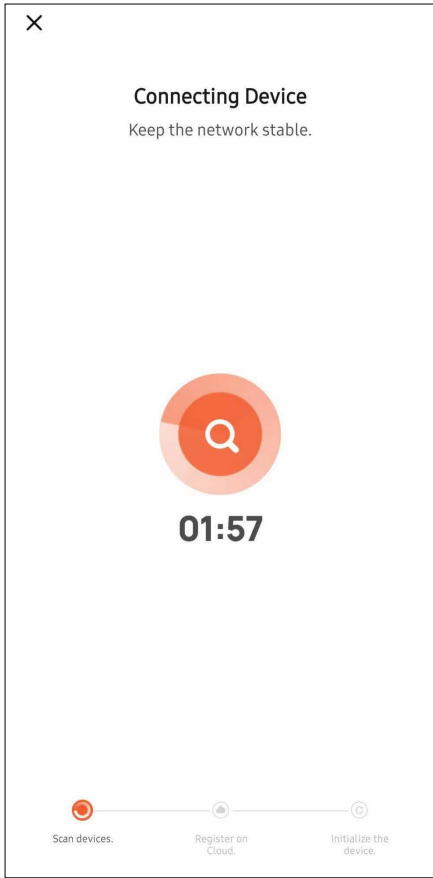

Figure 18

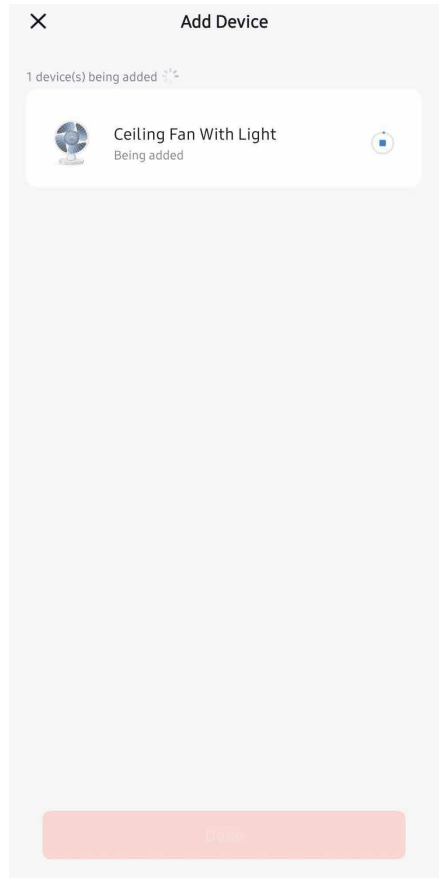

Figure 19

LUNA - INSTALLATION MANUAL

- 10 Once fan has been added successfully, you may select done and now operate the unit from your mobile device. (Fig.20)

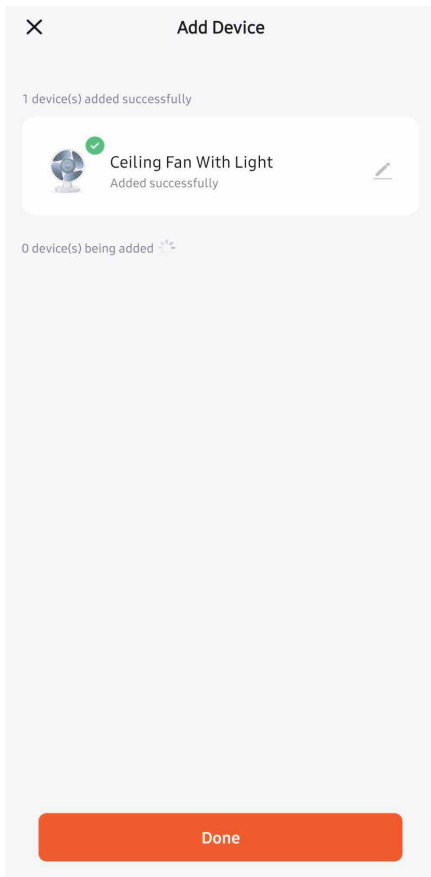

Figure 20

CEILING FAN MAINTENANCE

- 1 Ceiling fan is a rotating product. Make regular inspections on the hanging system, blade holders, blades and various parts of this product to prevent them getting loose. Recommendation is inspection twice a year to ensure safety.
- 2 Regularly clean the ceiling fan, wipe lightly with a soft brush or cleaning cloth. Avoid using a damp cloth or destructive cleaning detergents.
- 3 Do not use lubricating oil on any parts of the ceiling fan.

WARNING

If unusual oscillating movement is observed, immediately stop using the ceiling fan and contact the manufacturer, its service agent or suitably qualified persons.

The replacement of parts of the safety suspension system device shall be performed by the manufacturer, its service agent or suitably qualified persons.

If it is necessary to replace the live or neutral brushes to ensure operation of the motor then both brushes and the earth brush need to be replaced at the same time. The brushes shall only be replaced by a suitably qualified person.

MAINTENANCE TIPS

- Always switch off the main electric supply at the circuit breaker fuse box before carrying out any maintenance job to avoid any hazards.
- Do not use any detergent or corrosive acidic solution to clean the ceiling fan.
- Never oil the ceiling fan motor. The motor is created with a lubricated sealed ball bearing.
- If you are unsure of any steps, you can reach us at the email address and contact number listed on the last page of this manual.

To the best of our knowledge, the information contained herein is accurate and reliable as of the date of publication; however, Amphis Pty Ltd does not assume any liability whatsoever for the accuracy and completeness of the information.

Amphis Pty Ltd makes no warranties which extend beyond the description contained herein.

Any information given in this statement does not constitute any warranty of merchantability or fitness for a particular use. It is the customer's responsibility to inspect and to test our products in order to satisfy themselves as to the suitability of the products to their particular purpose.



Telephone 1300 LIGHTS

Email sales@amphis.com.au

amphis.com.au