

108022

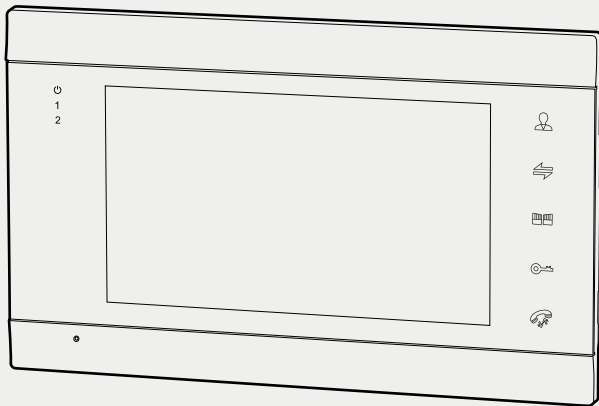

# SIGNATURE CONNECT

**WIFI VIDEO INTERCOM SYSTEM  
INDOOR MONITOR**



**USER MANUAL**

# CONTENTS

## 1. INDOOR MONITOR SPECIFICATION

## 2. SYSTEM INFO

2.1 Installation Note

2.2 Wiring Diagram

## 3. OPERATION INSTRUCTIONS

3.1 Button Instructions

3.2 Visitor Call

3.3 Call Transfer to Other Extensions

3.4 Monitoring

3.5 Motion Detection

3.6 Standby Mode

3.7 Main Menu

3.8 Parameter Settings

3.9 Digital Photo Frame

3.10 Mode Setting

3.11 Alarm

3.12 Media

3.13 Record Center

3.14 Colour Adjustment Setting

## 4. ALARM INSTRUCTIONS

## 5. INDOOR MONITOR INSTALLATION

## 6. SPECIFICATIONS AND ACCESSORIES

6.1 Specifications

6.2 Accessories

# 1. INDOOR MONITOR SPECIFICATION

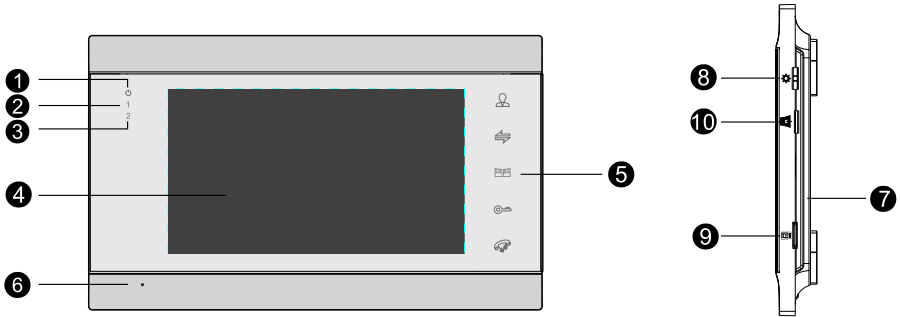

NO.	NAME	DESCRIPTION
1	Status LED 	Power indicator
2	Entry LED 1	LED indicate the status of Door Station 1
3	Entry LED 2	LED indicate the status of Door Station 2
4	TFT display	View visitor's image displayed on TFT screen
5	Operation button	Touch
6	Microphone	Transmit the voice to door station
7	Speaker	Sounds from outdoor station
8	Setting	Confirm/enter the main menu
9	SD card slot	Insert SD card for recording
10	Talking volume adjuster	Adjust indoor monitor volume during a call

## 2. SYSTEM INFO

### 2.1 INSTALLATION NOTE

- 1 Electrical locks / alarms / cameras are not included in the package. You can buy electrical locks that fit the actual requirements separately.
- 2 Factory default supports a normally open (NO), dry contact mode for door release. Dry contact is opened in the normal state, lock remains normally closed. If you press the unlock button, the dry contact will disconnect with the relay and release the lock.  
In Normally Open mode, if you unlock the door and no one comes in, the door will stay unlocked (screen will show Normally Closed (NC)) until someone walks in and shuts the door. Then the door will lock again.

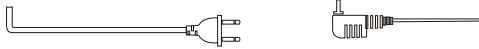

- 3 Built-in or external power supply is optional. Suitable for a wide voltage range (AC100V-240V). Unplug the AC power plug before installing the device (as shown below).
- 4 For the use and selection of wires, please refer to the following. (Cable quality influences video and voice transfer distance.)
  - a 4C ordinary unshielded wire and shielded wiring

Distance  $\leq 28\text{m}$  ( $4 \times 0.2\text{mm}^2$ ); Distance  $\leq 50\text{m}$  ( $4 \times 0.3\text{mm}^2$ ); Distance  $\leq 80\text{m}$  ( $4 \times 0.5\text{mm}^2$ )



- b 3C ordinary unshielded + video cable (RG-59) connection method

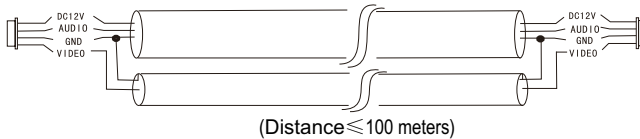

- c Category 5 network cable connection (not recommended)

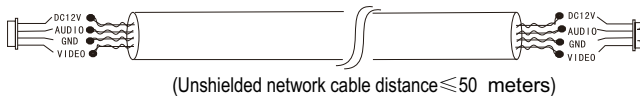

# 2. SYSTEM INFO CONT.

## 2.2 WIRING DIAGRAM

**i** First monitor must be set as **MASTER**. All other monitors must be set as **SLAVE**. This can be done in the **SETTINGS** menu.  
**MONITOR ID SETTING**  
Master=01, Slave=02 to 06

**Note:**  
HD Monitor can accept **AHD** or **CVBS** analog signals. If using HD monitor with **CVBS** analog door station, you must reboot the monitor from the menu system after connecting the camera.

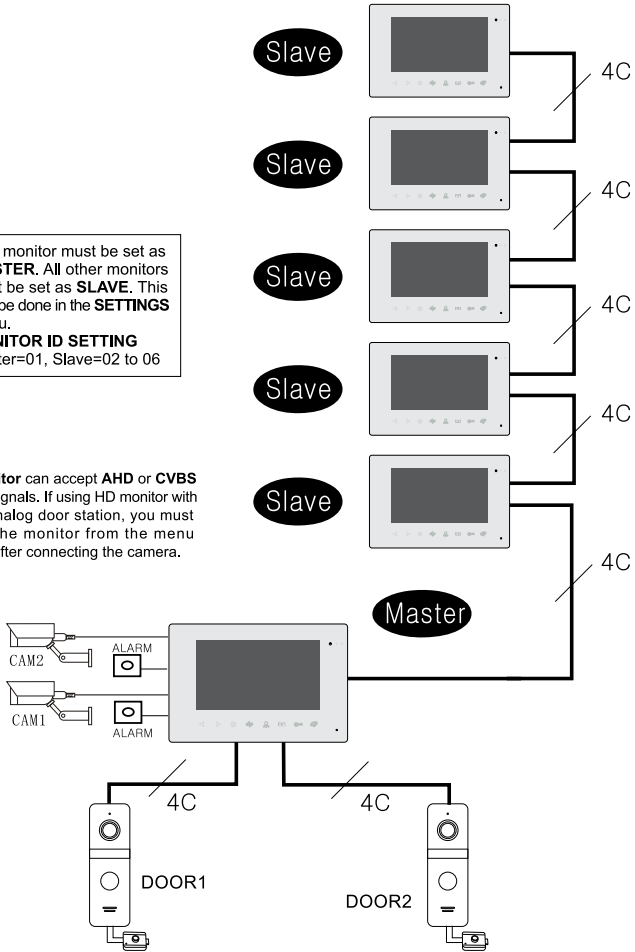



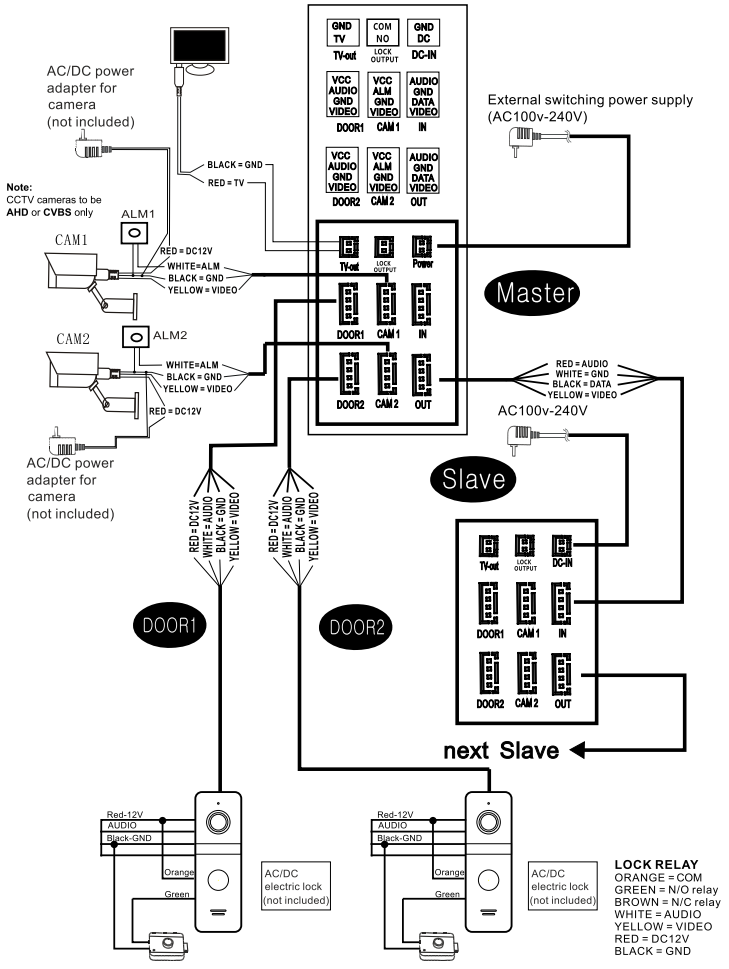





# 2. SYSTEM INFO CONT.



# 3. OPERATION INSTRUCTIONS

## 3.1 BUTTON INSTRUCTIONS

FUNCTION	BUTTON	DESCRIPTION
Transfer/ Intercom		Call Transfer/Internal Intercom/Color Contrast <b>1</b> Standby mode, long press button to start internal intercom. <b>2</b> During monitor and door station on conversation, long press button to transfer call to slave monitor. <b>3</b> During conversation or monitoring, short press button to start Colour Contrast.
Monitoring		Monitoring Door1/Door2 image.
Answer/Hang up		<b>1</b> Start conversation with door station. <b>2</b> Monitor door station, press button to start conversation with door station. <b>3</b> During conversation, press button to hang up. <b>4</b> During main menu setting, press button to exit.
Unlock		Unlock the door lock by pressing this button.
Setting	 Tap the wheel inward	Composite icon: confirm/enter main menu <b>1</b> Standby mode, press button to enter main menu. <b>2</b> Setting parameter, press button confirm. <b>3</b> During talking/monitoring mode, press button to start recording/snapshot/stop recording. <b>4</b> Playing music/video/picture mode, press button to pause/play. <b>5</b> Playing music/video, long press button to adjust volume.
"+"	 Scroll up	Up
"-"	 Scroll down	Down
Volume		Adjust talking volume with door station.
Gate Unlock		Unlock the door lock by pressing this button.

# 3. OPERATION INSTRUCTIONS

## 3.2 VISITOR CALL

### STANDBY MODE

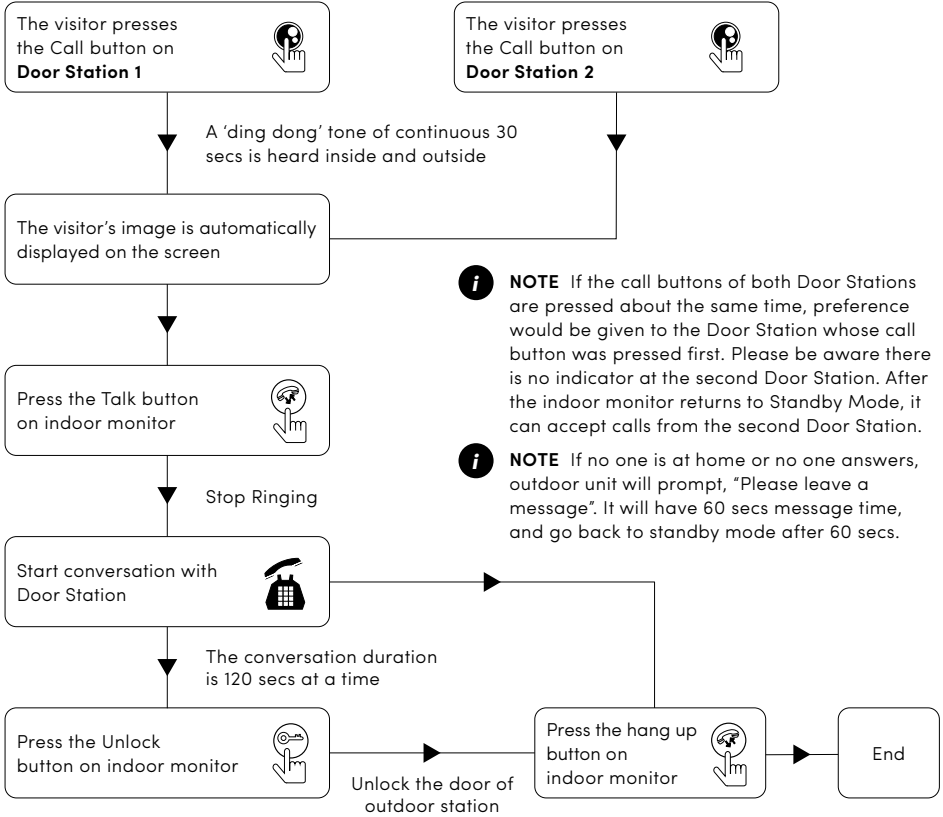

**i** **NOTE** If the call buttons of both Door Stations are pressed about the same time, preference would be given to the Door Station whose call button was pressed first. Please be aware there is no indicator at the second Door Station. After the indoor monitor returns to Standby Mode, it can accept calls from the second Door Station.

**i** **NOTE** If no one is at home or no one answers, outdoor unit will prompt, "Please leave a message". It will have 60 secs message time, and go back to standby mode after 60 secs.

- i** The Monitor will stay active for 20 seconds for the viewer to confirm that the visitor has entered the door.
- i** For models with a MicroSD card installed and Record function active: Recording will start from the beginning of a call and can be manually stopped by pressing button.
- i** For models with a MicroSD card installed and snapshot function active: A snapshot will be taken at the start of the call. The user can also press button to take another snapshot manually.
- i** In Monitoring mode, the monitor can listen to the door station. Press button to begin a conversation. Press button to unlock the door.



# 3. OPERATION INSTRUCTIONS

## 3.3 VISITOR CALL AND CALL TRANSFER TO OTHER EXTENSIONS

### 3.3.1 Call transfer to other extensions

Internal communication function requires at least two Indoor Monitors and one Door Station to be connected.

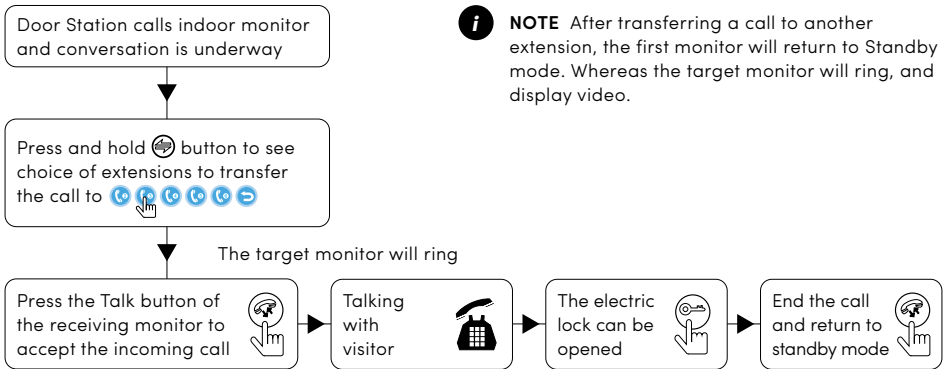

### 3.3.2 Internal communication among indoor units

At least two indoor monitors are required.

#### STANDBY MODE

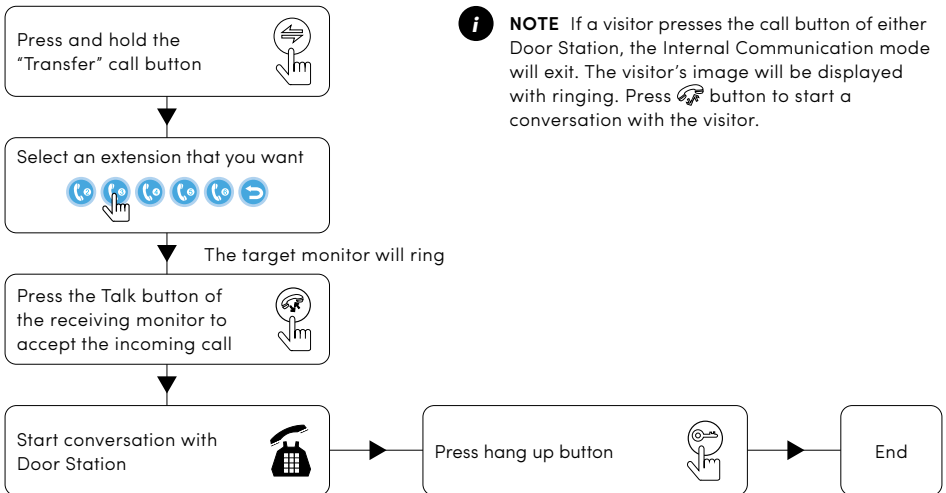

# 3. OPERATION INSTRUCTIONS

## 3.4 MONITORING

By default Door1, Door2, CAM1 and CAM2 can be monitored. To disable monitoring of Door2, set "Door2 Status" to OFF in the Mode menu. To disable monitoring of CAM1 and/or CAM2, set their corresponding "CAM1" and "CAM2" switch to OFF in the Alarm menu.

### STANDBY MODE

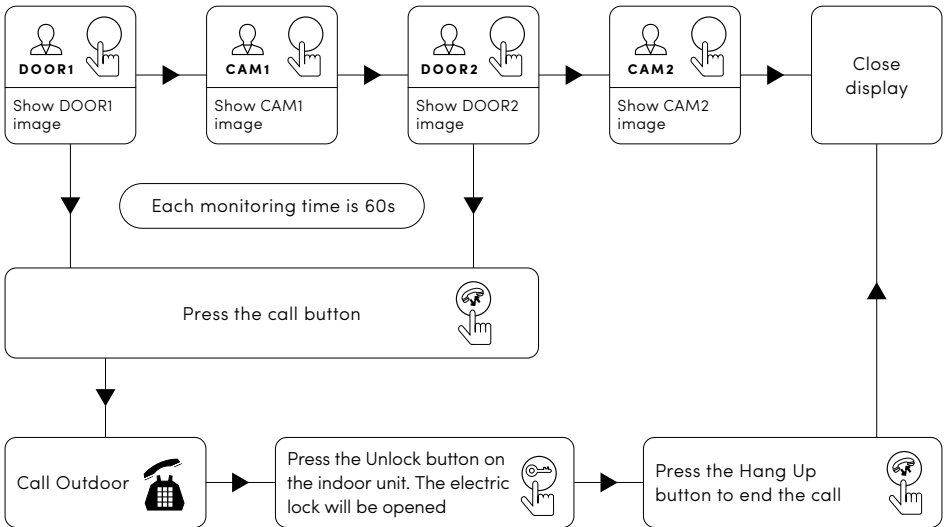

### **i** NOTE

1. When using with one door station only, you can press monitor button again to end monitoring, and can press hang up button to end monitoring. (DOOR2, CAM1, CAM2 must be OFF.)
2. If using two indoor monitors, you can turn on monitor mode on other extensions. The same image will show on different extensions.
3. When visitor presses door station call button, the system will turn off monitor mode and switch to show door station calling image.
4. When record mode is on video record, press setting button to start video recording. Press setting button again to stop recording.
5. Insert SD card and set it as snap mode. Press setting button to snap a picture and to snap additional pictures.

# 3. OPERATION INSTRUCTIONS

## 3.5 MOTION DETECTION

Door station camera detects movement, auto start motion detection and image display on monitor.



Press Setting Button > Mode > Motion Detection select, save the setting back to standby mode after 10 seconds active motion detection mode.



## 3. OPERATION INSTRUCTIONS

### 3.6 STANDBY MODE

Clock/date mode and digital photo frame mode option.

#### 3.6.1 Clock/Date Mode

Display day/month/year/week/hour/minute/second.

Clock/date display enters standby mode (black screen) within 60 seconds to protect LCD.

**NOTE** Message icon displayed on standby mode if visitor leaves a message.



#### 3.6.2 Digital photo frame mode

In digital photo frame mode, the monitor cycles through the photos in the \USER\Photo directory on the MicroSD card.



**i** **NOTE**

1. By default the clock is displayed on standby mode. If the digital photo frame is turned ON, then the images saved on the microSD card are displayed instead.
2. The \USER\photo directory on the MicroSD card must be manually created. Pictures stored in this directory will be displayed. Note: The directory name is case sensitive.

# 3. OPERATION INSTRUCTIONS

## 3.7 MAIN MENU

When in standby mode, touch screen to open the main menu. While in the main menu (see below) touch screen to navigate through the menu. Press again to choose an item. Press to go back to the previous menu or standby screen.



The monitor will automatically return to standby mode after 60 seconds of user inactivity.

## 3.8 PARAMETER SETTINGS

The system menu includes the following icons: Language, Time, System Info, Ringtone, Volume and Network Setting.



### 3.8.1 Language

The system language can be changed. In the system menu, move cursor selection to "Language", press button to enter the "Language" menu. Press button again; the arrow icons on both sides will change colour. Press selection to change the system language. Press button again to confirm change. Then press back button to return to previous menu.



# 3. OPERATION INSTRUCTIONS

## 3.8.2 Time

The Time settings adjusts the system date and time and what will be displayed in standby mode.

- 1 The Clock Switch controls whether the clock is displayed in standby mode. When turned off, the screen will be all black, without displaying either clock or digital photo frame display.
- 2 Set the display format of the clock in "Date Format". Once completed, press to return to the system menu.
- 3 The time is displayed in 24-hour format only.



## 3.8.3 Information

Select "System Information" icon to enter the "System Information" menu. This screen shows the software version, MCU version, and microSD card free space. It includes options to Restart/Reboot the monitor and format the microSD card, MAC address, ID Number.

**NOTE** Supports MicroSD cards with write speeds over 10MB/s and memory size up to 32G.



**[Reboot]** To restart the monitor, select "Confirm". Select "Yes" to the pop-up prompt to "Reboot device?". Otherwise, select "No" to exit the window without rebooting.

**[Format]** Select "Format" button and press "Yes" to start formatting SD card.

**[Get ID]** Select this to update manufacturer device ID information from a microSD card (if directed by our technical support team).

# 3. OPERATION INSTRUCTIONS

## 3.8.4 Ringtone

This menu allows you to change the ringtone on the monitor with an installed microSD card containing suitable ringtone files.



**[Mode]** There are two modes for ringtones: “Custom” and “Default”. There are 10 default in-built ringtones for selection. In “Custom” mode, user ringtones can be selected from the “\USER\Ring” directory on the microSD card.

**[Door1/2 Ring]** Sets default and custom ringtones for each door station and to adjust the two settings. Change the mode to “Custom” for custom ringtones.

### **i** NOTE

1. Create a “\USER\Ring” directory on the microSD card. Only music stored in this ring folder can be used as custom ringtones.
2. The ringtone name must be ring\_1~ring\_10.
3. The ringtone files must be in MP3 format.

## 3.8.5 Volume

Select “Volume” to adjust the ring volume of the monitor. Users can set up preferred ring volumes for three different times of day. Ring durations can be adjusted from 10 seconds to 45 seconds. Use to navigate or increase and decrease value to enter.

**NOTE** Volume setting is for calling ringtone.



**[Volume 1]** The volume level of Ring Vol 1: 01-10, Ring time 10-45 seconds.

**[Volume 2]** The volume level of Ring Vol 2: 01-10, Ring time 10-45 seconds.

**[Volume 3]** The volume level of Ring Vol 3: 01-10, Ring time 10-45 seconds.

## 3. OPERATION INSTRUCTIONS

[**Button Voice**] This turns on/off the confirmation sound when a button is pressed.

[**Ringback**] Control door station ringtone on/off.

### 3.8.6 Network Setting

Select "WiFi Set" enter "Network Set". Monitor connects to WiFi, press door station once, monitor and smart phone will ring.



#### App Download and Register

- 1 IOS: download "Tuya Smart" from Apple store  
Android: download "Tuya Smart" from Google Play
- 2 Switch on "Tuya Smart" app to start registration. Select country and region.
- 3 Login after registration is finished.

**NOTE** WiFi setting must be used with "Tuya Smart" app.

#### AP Mode Connection:

- 1 Monitor auto-create hotspot name "SmartLife-xxxxxx" when power on.
- 2 Turn on smart phone WiFi setting, search hotspot name same as monitor. If the correct name is found, go step 4. If not, go to step 3.
- 3 Monitor select "WiFi Set", enter "Network Set", choose AP auto-reboot and create hotspot name "SmartLife-xxxxxx".
- 4 Log into "Tuya Smart" app, select "Add device" and enter the page.

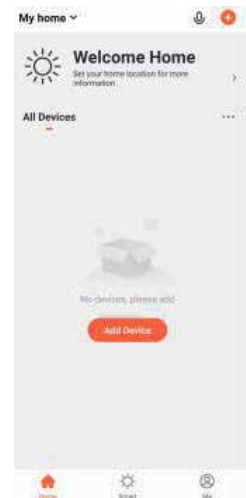



# 3. OPERATION INSTRUCTIONS

5 Press “Video Surveillance”----- “Smart Doorbell”. Enter the page.



6 Press “Net Pairing Mode”-“AP Mode”----- “Next”. Enter the page.

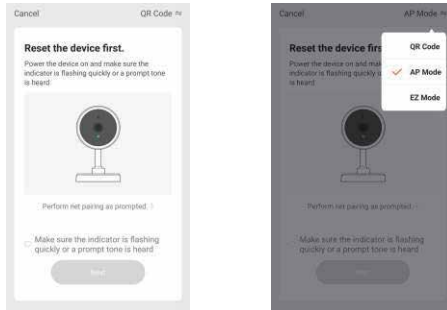

7 Input family WiFi name and password, press confirm and enter the page.

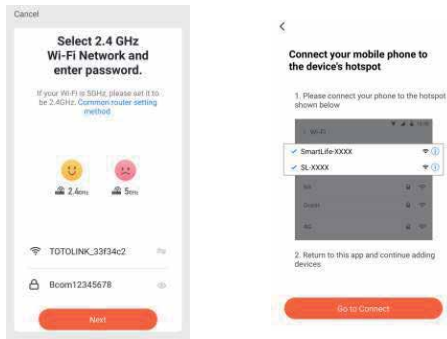

### 3. OPERATION INSTRUCTIONS

- 8 Press connect and enter smart phone WiFi setting page. Find the hotspot name "SmartLife-xxxxxx".



- 9 When connection is successful, return back to Tuya Smart app.

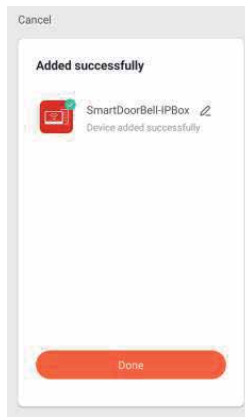

**i** **NOTE** IOS system smart phone may remember other WiFi names and passwords. This may lead to a failed connection. To prevent this, ensure 'Forget all WiFi information' has been selected.

# 3. OPERATION INSTRUCTIONS

## APP GUIDE

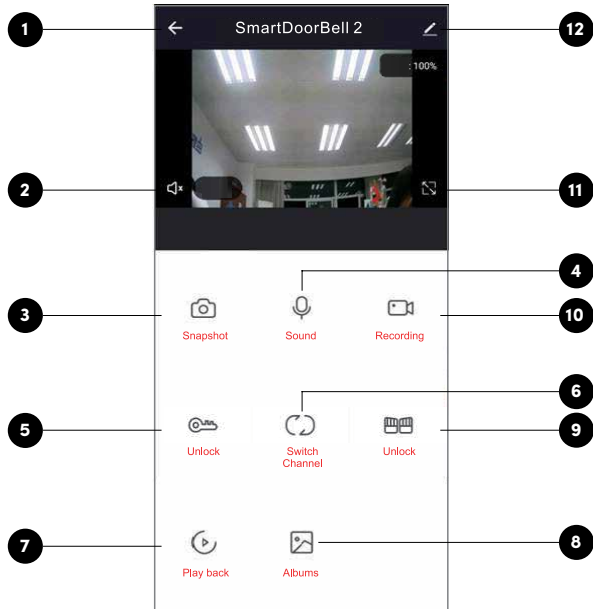

- 1 **Hang up / Exit.**
- 2 **Loudspeaker** Viewer can hear sounds from door station.
- 3 **Snapshot** During talking/monitoring mode, press the icon to snapshot image of screen. (Android system smart phone saves snapshot picture on app. IOS system smart phone saves snapshot picture on device's photo album).
- 4 **Microphone** On door station press call button. On phone get message to enter app. Only press Mic button to talk with door station. (Loudspeaker will switch on at the same time once pressed).
- 5 **Unlock** During talking/monitoring, press the button to open the lock connected at door station.
- 6 **Switch camera image** During talking/monitoring, press the button view Door1, Door2, Camera1, Camera2.
- 7 **Playback** Make sure monitor has MicroSD card inserted, and supports playback calling/monitoring video record.
- 8 **Photo albums** Android system smart phone saves snapshot picture on app. IOS system smart phone save snapshot picture on device's photo album.
- 9 **Gate unlock** During talking/monitoring, press the button to open the lock connected at monitor.
- 10 **Video record** During talking/monitoring, press the button start video recording.
- 11 **Full screen** Press the button to display full screen.
- 12 **Setting**

# 3. OPERATION INSTRUCTIONS

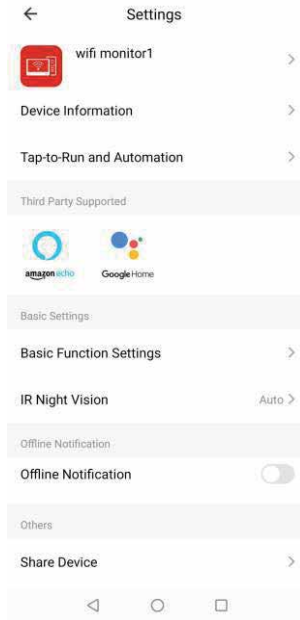

- A** Modify device name and icon.
- B** Device information.
- C** Offline remind: device offline exceeds 30 second sensor trigger.
- D** Sharing device: support sharing device with other phone user (note: user app without unlock function).
- E** Memory setting: view memory setting only, insert MicroSD card in monitor, display MicroSD card capacity space.
- F** Remove device

## Sharing with other phone user

There are two ways to share your device to other phone users:

- 1** Enter app-----All devices list-----press the device you want to share-----press monitoring mode and press top right corner setting-----Share device-----Add sharing-----input region/account and Done. (Note: second user app does not have unlock function, only admin app has unlock function).
- 2** Enter app-----All devices list-----Me-----Home Management-----Create a home-----Enter home name-----Add member-----App account-----input name/region/account and Save.
  - a** All members on same device can receive messages once visitor calls from door station.
  - b** Admin can add or remove all members from app: Enter "Me"-----Home Management-----remove members as you want.

# 3. OPERATION INSTRUCTIONS

## 3.9 DIGITAL PHOTO FRAME

In Digital Photo Frame mode, the monitor cycles through the photos in the \USER\Photo directory on the MicroSD card.

**NOTE** If the Digital Photo Frame is turned ON, then motion detection function cannot be used.



**[Photo Frame]** User can select it on/off. Default is off.

**[Play Time Interval]** Digital Photo Frame play-time control default is 6 seconds. User can select 2-10 second options.

### **i** NOTE

1. Create "Photo" folder under "USER" in MircoSD card.
2. The pictures must be below specification  
MAX\_RESOLUTION\_WIDTH ≤ 1920  
MAX\_RESOLUTION\_HEIGHT ≤ 1080  
JPEG\_FILE\_MAXSIZE ≤ 3 MB

## 3.10 MODE SETTING

Select "Mode" and enter the "Mode" menu. Can set extension number, DOOR2 status, unlock time, recording mode, motion detection, message etc.



**[Set machine ID]** Choose an ID number ranging from 01-06. An ID of "01" denotes the Master Monitor. The other IDs ("02" to "06") denote Slave Monitors.

**[Door2 status]** Enable or disable the preview of door2.

**[Door1 Unlock Time]** Sets Door1 unlock time. After the unlock duration, Door1 will be locked again. The unlock time can be set from 2 to 10 seconds. The default value is 2 seconds.

## 3. OPERATION INSTRUCTIONS

**[Door2 Unlock Time]** Sets Door2 unlock time. After the unlock duration, Door1 will be locked again. The unlock time can be set from 2 to 10 seconds. The default value is 2 seconds.

**[Record mode]** Options for recording video or taking snapshots. For "Video", when the call button of a door station is pressed, the indoor monitor with the MicroSD card will start recording video until the end of the call, or until setting button is pressed. For "Snapshot", the monitor with the MicroSD card will automatically snapshot a photo. More snapshots can be manually taken by pressing setting button.

**NOTE** Recording mode is only available for Door1, Door2.

**[Motion Detection]** Options include "Door1", "Door2", "Camera1", "Camera2" and disable.

**[Message]** Turn message reminders ON or OFF. Default is ON. If a visitor calls, they will be prompted to leave a message if the resident is not at home or fails to answer the call.

### 3.11 ALARM

In main menu, move the cursor to the "Alarm" option. Press button to enter the Alarm menu.



**[Alarm record]** Options for recording video or taking snapshots. For "Video", when an alarm is triggered, the indoor monitor with the MicroSD card will automatically start recording video from the related camera until the alarm clears, or until hang up button is pressed. For "Snapshot", when an alarm is triggered, the monitor with the MicroSD card will automatically take a picture from the linked camera. More snapshots can be manually taken by pressing setting button.

**NOTE** Supports MicroSD cards with write speeds over 10MB/s and memory size up to 32G.

**[CAM1 Sensor type]** CAM1 channel corresponds to Sensor Type state (see below description), which means when an alarm is triggered, it will activate the corresponding channel to start alarm video recording or capture a picture.

**[CAM1]** Enable or disable the preview of Camera1.

**[CAM1 ring time]** The alarm ringing time for Camera1, after its sensor has detected an alarm, ranges from 0 - 20 seconds.

**[CAM2 Sensor type]** CAM2 channel corresponds to Sensor Type state (see below description), which means when an alarm is triggered, it will activate the corresponding channel to start alarm video recording or capture a picture.

**[CAM2]** Enable or disable the preview of Camera2.

**[CAM2 ring time]** The alarm ringing time for Camera 2, after its sensor has detected an alarm, ranges from 0 - 20 seconds.

# 3. OPERATION INSTRUCTIONS

## I/O Sensor Type:

**NO** "Normally Open": when ALM and GND terminals is shorted, an alarm on the monitor will sound.

**NC** "Normally Closed": when ALM and GND terminals are disconnected, an alarm on the monitor will sound.

**Disable** If an external sensor is not used, set its Sensor Type to "Disabled".

## 3.12 MEDIA

Select "Media" and press setting button to enter "Media" menu. It includes: Music, Photo, File Management.

**TIP** Disconnect power to the monitor before inserting or removing a MicroSD card.



### 3.12.1 Music

Select "Music" and press "⚙️" to enter music playback page. After entering music page, the first music file in the list is automatically played.

**NOTE** Using a computer, create a "USER" folder and then a "Music" subfolder on the microSD card. Only MP3 music files located in the "Music" subfolder will be displayed. Important: The "\USER\ Music" directory is case sensitive.



- 1 Enter the music list, select it and press setting button start playing music.
- 2 Playing music mode: Play In Sequence, Single Play, Single Cycle, List Cycle, Random Play.

**[Play In Sequence]** Play all songs from top to bottom of list. Stop playing after the last song is played.

**[Single Play]** Stop automatically after playing the current song.

**[Single Cycle]** Play the same song repeatedly without stopping.

## 3. OPERATION INSTRUCTIONS

**[List Cycle]** Repeat all songs in sequence. Restart playback from the first song after finishing the last song.

**[Random Play]** Play all songs in random order without stopping.

**i NOTE** If visitor calls to triggers alarm during playback, the playback will stop and switch to door station or camera image.

### 3.12.2 Photos (for the models with MicroSD card)

Select "Photo" in the Media menu. Press setting icon to view the list of photos.



**i NOTE**

1. Photos must be stored in the "\USER\Photo" folder on the MicroSD card in JPG format. The directory is case sensitive.
2. Maximum display size of photos:  
MAX\_RESOLUTION\_WIDTH ≤ 1920  
MAX\_RESOLUTION\_HEIGHT ≤ 1080  
JPEG\_FILE\_MAXSIZE ≤ 3 MB

### 3.12.3 File Management (for the models with MicroSD card)

Select "File Management" option, press setting icon to enter "File Management", select SD folder, and press to enter SD card. It includes: DCIM folder, USER folder.



**[Delete file]** Press the arrow keys to highlight a file to delete. Then press setting icon and hold until a pop-up window appears with the message "Delete File?". Use the arrow keys to select "Yes" and press setting icon to delete file. Otherwise, press setting icon when "No" is selected to cancel.



# 3. OPERATION INSTRUCTIONS

**[DCIM]** This DCIM folder is automatically created by the monitor for saving files created for the Record Center. It contains the "Photo" and "Video" folders. The "Photo" folder saves the automatic snapshots and manually-captured photos. Similarly, the "Video" folder saves the automatic and manually-recorded videos by the monitor.

**[Single Play]** The USER directory contains the "Music", "Photo", "Ring" and "Update" folders.

**Note** These directories and names are case sensitive.

- "Music" folder stores the MP3 music files.
- "Photo" folder stores JPG pictures for the digital photo frame.
- "Ring" folder stores the custom ringtones.
- "Update" folder stores upgrade files.

**[Upgrade]** Put upgrade file (xxx.dd is the program file) in the Update folder, select upgrade file xxx.dd and press setting icon to pop up the window "Upgrade?". Select "Yes" and press setting icon to confirm upgrade and wait for the upgrade to succeed. Select "No" by pressing setting icon to close the window.

**[MCU Upgrade]** Put MCU file (xxx.bin is the MCU file) in the update folder. Select MCU file xxx.bin and press setting icon to pop up a window "Upgrade?". Select "Yes" and press setting icon to confirm upgrade and wait for the upgrade to succeed. Select "No" by pressing setting icon to close the window.

**NOTE** During system upgrade, do not remove SD card, power off, or disable indoor monitor. After the upgrade is complete, the device will restart.



## 3.13 RECORD CENTER (for the models with MicroSD card)

Select "Record Center" and press setting icon to enter "Record Center" submenu. This submenu includes video information and photo information icons.

**NOTE** To delete the videos and snapshot pictures in the Record Center, please delete them from the DCIM folder on the microSD card.



# 3. OPERATION INSTRUCTIONS

## 3.13.1 Video Recordings

In the Record Center menu, select "Video Info" and press setting icon to show list of recorded videos. With the arrow keys, select a video for playback, then press setting icon to start playback.

**NOTE** This submenu only displays video messages recorded by the indoor monitor.



## 3.13.2 Photo

In the Record Center menu, select "Photo Info" and press setting icon to show list of snapshot photos. With the arrow keys, select a photo for playback, then press setting icon to start playback. Press hang up button to return to the previous menu.



**NOTE** This submenu only displays monitor snapshot photos.

## 3.14 COLOUR ADJUSTMENT SETTING

In standby mode, press monitor icon to display image. When image is displayed, press transfer button to bring up colour adjustment mode. It includes: brightness, contrast, saturation, refresh, and return. Select the option and press setting button. When the setting value changes its font colour, use the arrow keys to increase or decrease its value. Then press setting button again to save the changes.

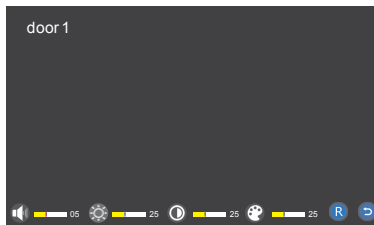

## 3. OPERATION INSTRUCTIONS

**NOTE** The colour parameters can be changed on the screen while monitoring, calling or when in alarm.

**[Talking Volume]:** During talking mode with door station, you also can adjust talking volume.

**[Brightness]** Values adjustable from 0 to 50. (Default: 25).



**[Contrast]** Values adjustable from 0 to 50. (Default: 25).

**[Saturation]** Values adjustable from 0 to 50. (Default: 25).

**[Refresh]** If monitor has registered the wrong video format for a door station or camera, no video would be displayed on the monitor. Tap "R" (Refresh) repeatedly to change the video signal format to match the door station.

**[Return]** Select return and press setting button to close colour adjustment mode.

## 4. ALARM INSTRUCTIONS

- 1 The final public terminal is shorted to ground to activate the alarm, and indoor monitor speaker rings. During this period, press  to stop alarming and enter standby mode.
- 2 When in recording mode, 120 seconds continuously display and record the image. During this period, press  to stop alarm and enter standby mode.
- 3 When in snapshot mode, a photo is taken at the beginning of alarm, and the image is continuously displayed within 120 seconds. During this period, press  to stop the alarm and enter standby mode.

### Alarm Sensor Wiring Diagram

- 1 Suitable for connecting two normally closed (NC) or normally open (NO) alarm inputs. Two alarm input channels without input limitation (can be normally open or normally closed).
- 2 The ALM terminal of alarm sensor is connected to ALM terminal of indoor monitor (the alarm sensor is powered by external power supply).
- 3 Alarm sensor GND terminal is connected to camera GND.
- 4 For NO alarm input, when GND and ALM are connected, the alarm will be triggered.
- 5 For NC alarm input, when GND and ALM are off, the alarm will be triggered.
- 6 Suitable for any alarm sensor.

## 5. INDOOR MONITOR INSTALLATION

### ⚠ NOTE

- Please keep away from strong radiation equipment: TV, DVR, etc.
- Please do not disassemble without permission to avoid electric shock.
- Do not drop, shake or strike the device, otherwise the components will be damaged.
- Select the best position for installation. The distance from the horizontal view is 150cm.
- Please shut down before installation.
- Keep a distance of more than 30cm from the AC power source to avoid interference.
- Keep away from water, magnetic fields and chemicals. Please turn off the power before installation.

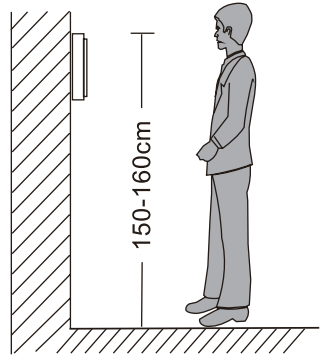

### How to install indoor monitor

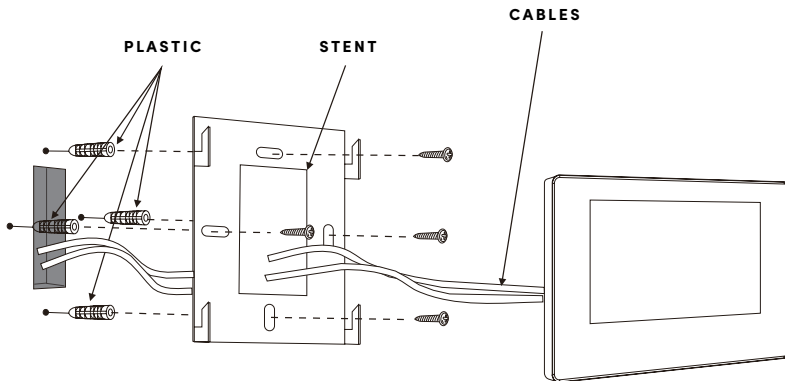

## 6. SPECIFICATIONS AND ACCESSORIES

### 6.1 SPECIFICATIONS

Product Type	AHD 720P/960P/CVBS Video Input, CVI Video Input, TVI Video Input
Screen	7" TFT LCD screen
Resolution	7" (1024 x 600px)
Standard	PAL/NTSC
Intercom Mode	Two-way intercom, Cloud intercom
Power Consumption	Maximum 500mA/600mA
Power Supply	External power DC; Built-in AC100-240V
Operating Temp.	0~+50°C
Installation	Surface mount
SD Card Max Capacity	2GB~32GB class 10 TF card (micro SD card) <b>NOTE</b> Read and write speed≥Class10
Video Input Signal	CVBS, CVI, TVI, AHD2.0
Motion Detection	Yes
System Capacity	6 indoor monitors + 2 door stations + 2 cameras
Functions	Unlock/Monitor/Intercom/Transfer Call/Record
Advantages	Digital Photo Frame/MP3/Clock and Voice Message/ Background Music /Cloud Intercom

# 6. SPECIFICATIONS AND ACCESSORIES

## 6.2 ACCESSORIES

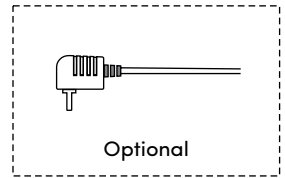
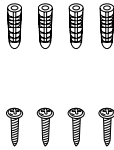
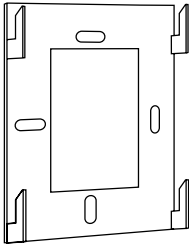
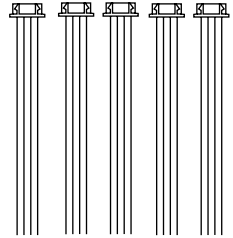
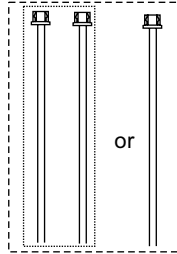
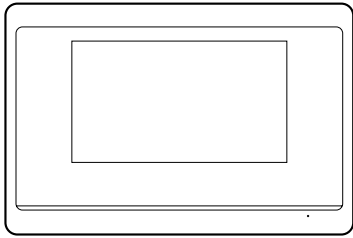

<b>Indoor unit</b>	1pcs	<b>4 Pin Line</b>	5pcs
<b>Plastic anchors</b>	4pcs	<b>2 Pin Line (optional)</b>	1pcs or 2pcs
<b>Screws</b>	4pcs	<b>User manual</b>	1pcs
<b>Bracket</b>	1pcs	<b>External power supply switch</b>	1pcs

**NOTE** If the indoor unit includes the internal power supply, there is no external power supply switch as in the picture above.

To the best of our knowledge, the information contained herein is accurate and reliable as of the date of publication; however, Amphis does not assume any liability whatsoever for the accuracy and completeness of the information.

Amphis makes no warranties which extend beyond the description contained herein.

Any information given in this statement does not constitute any warranty of merchantability or fitness for a particular use. It is the customer's responsibility to inspect and to test our products in order to satisfy themselves as to the suitability of the products to their particular purpose.



**Telephone** 1300 LIGHTS

**Facsimile** +61 3 9645 6574

**Email** sales@amphis.com.au

**amphis.com.au**