



WIRELESS DOORBELL CHIME

QUICK START GUIDE

FEATURES

1. Easy to install and use
2. 5 level volume control. Max volume: 110 decibels
3. 55 ringtones with LED indicator
4. 1000ft/300m wireless working range in open area
5. No batteries. Low power consumption
6. Compatible with smart video doorbells

PRODUCT DRAWING

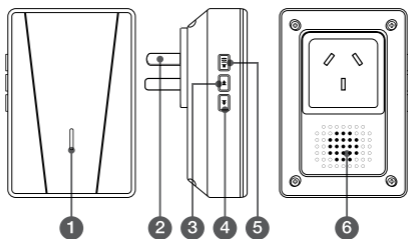

- | | |
|----------------------|--------------------------|
| 1. LED Indicator | 4. Next Ringtone |
| 2. Power Plug | 5. Volume Control Button |
| 3. Previous Ringtone | 6. Speakers |

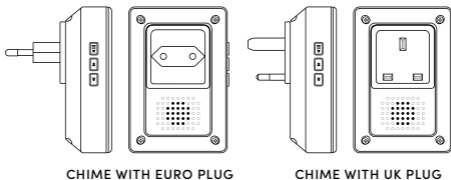

CHIME WITH EURO PLUG

CHIME WITH UK PLUG

FIRST TIME USING

1. Plug the chime to AC outlet. Device will play the default ringtone once at the maximum volume.
2. Short press on volume button to adjust the volume of speaker.
 Level 1: mute (LED indicator flashes only)
 Level 2 ~ 5: gradual increase
3. Ringtone selection.
 Press on previous/next button to select your favourite ringtone.

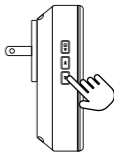

PRESS & HOLD

PAIRING IN SECONDS

1. Select favourite ringtone, press and hold the volume button for five seconds until you hear a "ding" sound from the chime.
2. The chime will be in pairing mode for eight seconds. Press the call button on the Smart Doorbell during that time, and if pairing is successful the chime will make a "ding-ding" sound.
3. Press the call button again and the chime will alert with ringtone and LED flashing.

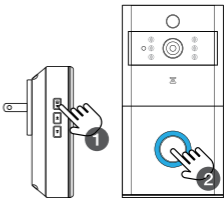

CLEARING CONNECTION

1. Press and hold the next button for five seconds to delete the pairing codes.
2. The chime will be restored to factory default.

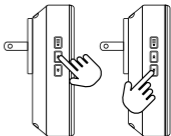



Telephone 1300 LIGHTS

Facsimile +61 3 9645 6574

Email sales@amphis.com.au

amphis.com.au