

Hobby Bench

Materials & Hardware

BASE

A Legs (4)	710 x 38 x 38
B Side Panels (2) Melamine	710 x 520 x 18
C Back Panel (1) Melamine	722 x 710 x 18
D Frame Fronts (2)	730 x 25 x 19
E Frame Sides (4)	495 x 38 x 19
F Frame Fillers (2)	500 x 68 x 10
G Top Mounting Rail (2)	505 x 38 x 19

DRAWER

H Front (1)	706 x 65 x 19
I Sides (2)	510 x 65 x 12
J Back (1)	694 x 65 x 19
K Bottom (1)	694 x 486 x 6 Ply.
L Dividers (3)	486 x 53 x 12

TOP

M Benchtop (1) Melamine	1190 x 572 x 18
N Filler Strips (2) Melamine	1190 x 150 x 18
O Edging	4m x 36 x 19 Rgh.

SHELVES

P Shelves (4) Melamine	496 x 190 x 18
Q Shelf Edging	6m x 25 x 6 Rgh.

STORAGE CABINET

R Cabinet Top/Bottom (2)	1200 x 180 x 19
S Cabinet Ends (2)	160 x 180 x 19
T Cabinet Dividers (3)	160 x 174 x 19
U Cabinet Back (1)	1174 x 160 x 6 Ply.
V Bin Supports (16)	174 x 19 x 6
W Cabinet Edging	6m x 19 x 6 Rgh.

ACCESSORIES

X Bases (3)	100 x 100 x 19
Y Keys (3)	100 x 9.5 x 8
Z Bookend Plates (2)	150 x 100 x 19
AA Braces (2)	115 x 90 x 19

- (10) 8g x 38mm c/s Woodscrews
- (14) 8g x 50mm c/s Woodscrews
- (4) 5/16" Whit T-Nuts
- (4) Plastic Leg Levellers
- (2 pr.) 600mm Shelf Standards
- (4 pr.) Shelf Supports, 200mm Long
- (2) 90mm Drawer Pulls w/Screws
- (1) 1200 x 19 x 9.5mm T-Track w/Screws
- (8) Plastic Storage Bins
- (1) Desk Light w/Screws
- (3) 1/4" Whit x 38mm Flange Bolts
- (3) 1/4" Whit Knurled Knobs

Cutting Diagram

2400 x 90 x 38mm Pine

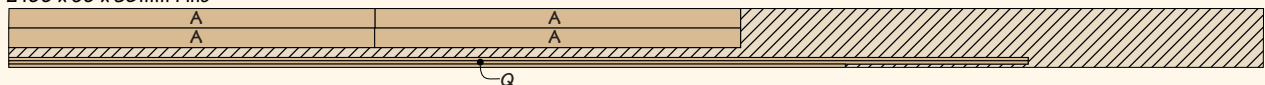

2400 x 240 x 19mm Pine

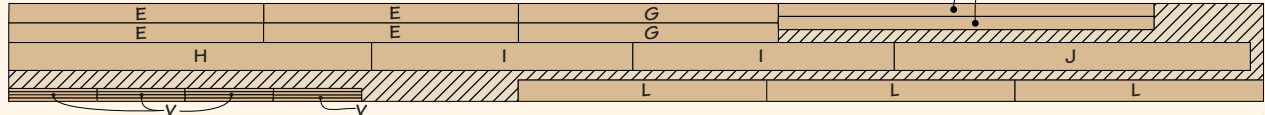

NOTE: Parts I and L are planed to 12mm thick.

2400 x 240 x 19mm Pine

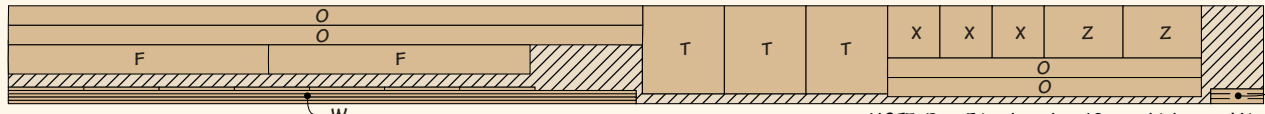

NOTE: Part F is planed to 10mm thick, part Y is planed to 8mm thick.

1500 x 190 x 19mm Pine (TWO BOARDS)



Online Extra

2400 x 1200 x 18mm Melamine Laminated Sheet Stock

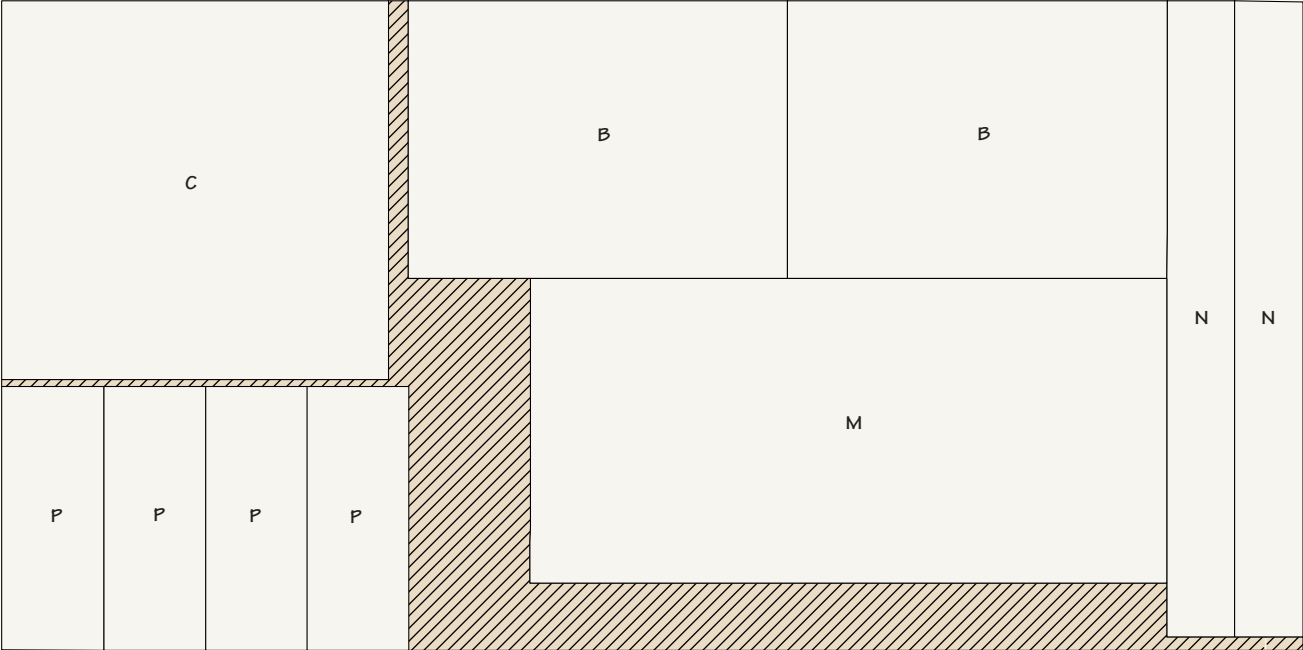

1200 x 1200 x 6mm Plywood

