

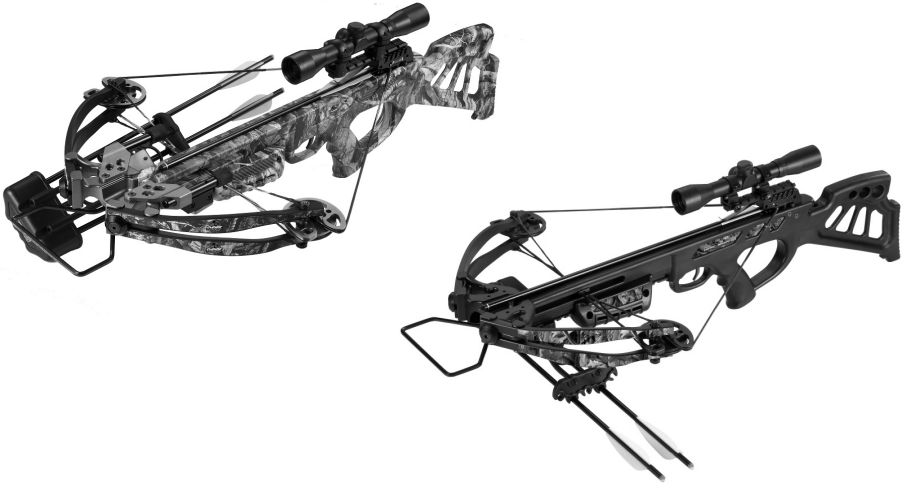

OWNER'S INSTRUCTION & SAFETY



SPECIALIZED FOR EMPIRE DRAGON & BEOWULF COMPOUND CROSSBOWS

PRESENTED BY SA SPORTS LLC.

IMPORTANT!

THIS IS NOT A TOY! Be sure to
Read AND Follow these
instructions carefully before
using this product. Save
instructions and safety manual

for future reference.

INTRODUCTION

Thank you for choosing an EMPIRE CROSSBOW. We are confident that you will enjoy the crossbow for many seasons to come. Congratulations on your purchase, good luck in your pursuits, and thank you once again!



COMPONENT GUIDE - DRAGON

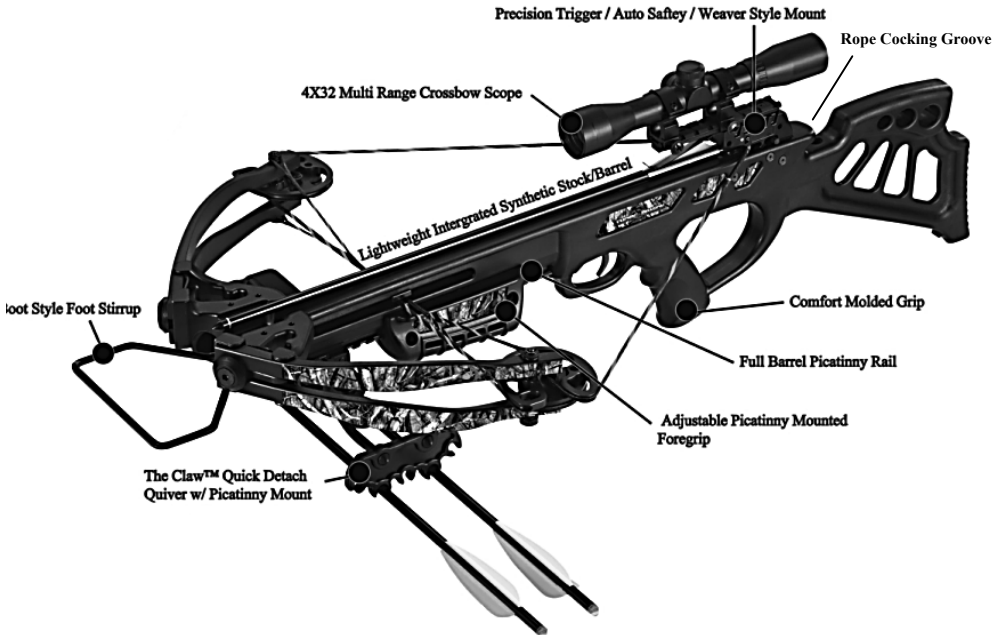

COMPONENT GUIDE - BEOWULF

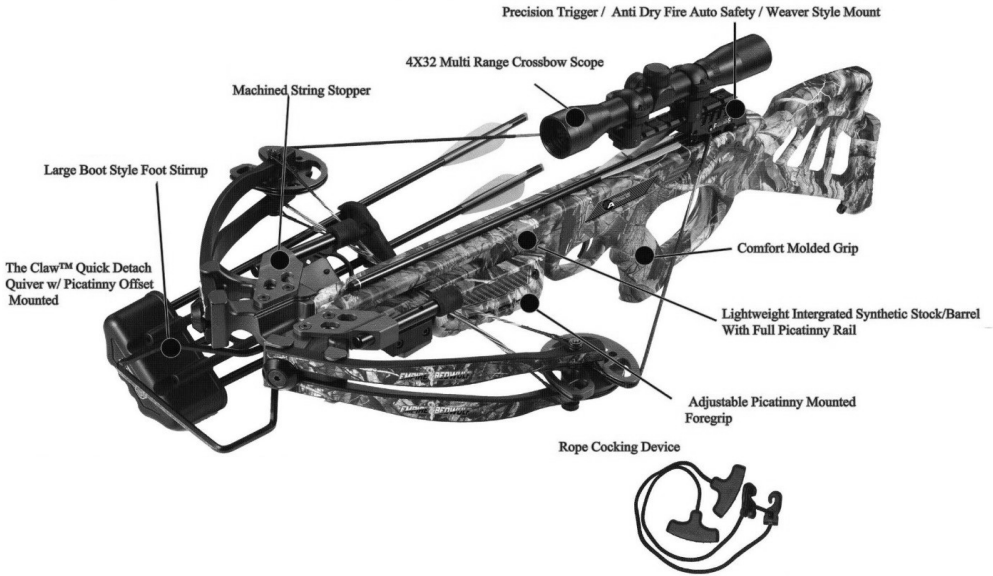

SETTING UP YOUR CROSSBOW

1. Attach the cable slide to the cables with the cable separator grooves facing down, and insert the cables in the 2 grooves as shown below. (riser, string/cables shown from underside)

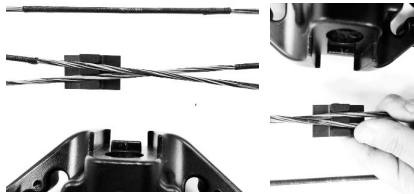

2. Connect the barrel and the riser by inserting the cable slide and cables into the slot on the barrel as shown. Be sure the

wide/slightly concave side is facing up to match with the contour of the inside of the barrel. **CABLE DAMAGE WILL OCCUR IF YOU DO NOT USE THE SLIDE and will not be covered by any warranty program.**

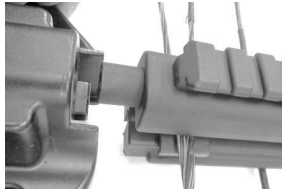

3. Push the cables into the track and position the riser for connection to the barrel. Be sure to seat the barrel and riser completely prior to using the nose bolt and washer and Allen (hex) key provided to complete the assembly.

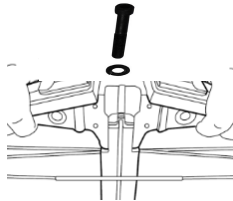

4. Tighten the center set screw on the underside of the riser, this will lock down the nose bolt to keep it from loosening.
5. Insert the foot stirrup into the two holes on the front of the riser. Make sure the 2 notches in the foot stirrup are facing towards the grub screws used to secure the stirrup, tighten securely.



WARNING!

It may cause serious injury or damage to your bow if the foot stirrup set screws are not tightened securely.

CLAW QUIVER SET UP

MOUNTING INSTRUCTION STANDARD - DRAGON

1. Screw the quick release mounting bracket on to the CLAW mounting system. (SEE PICTURE 1)
2. Attached the CLAW mount into the desired position on the picatinny rail. (SEE PICTURE 2)
3. Tighten the picatinny mounting screw from the side and make sure it's firmly attached. (SEE PICTURE 3)
4. Slide the Claw Quiver into the groove on the quick release mounting bracket. Make sure the locking lever is in the open position. (SEE PICTURE)
5. Lock the quiver by turning the locking handle, you can unlock and remove the quiver by opening the locking handle.

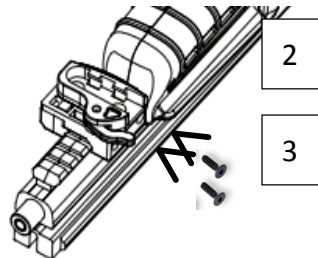
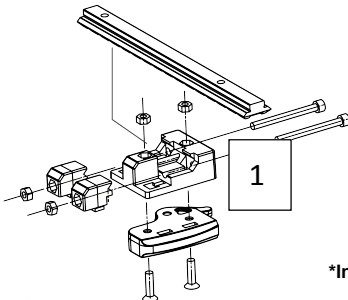

*Install the CLAW MOUNT on the picatinny (#2~#3)

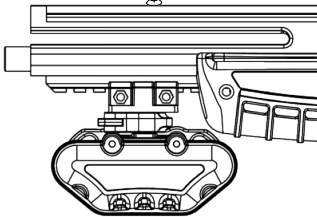

* SIDE VIEW OF THE ASSEMBLED QUIVER

WITH CLAW MOUNT SYSTEM

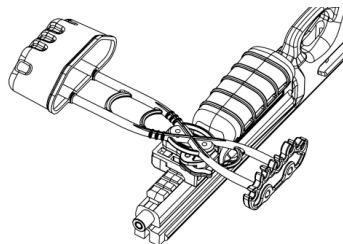

*BOTTOM VIEW OF THE ASSEMBLED

QUIVER WITH CLAW MOUNT SYSTEM

MOUNTING INSTRUCTION - BEOWULF (SIDE MOUNT)

1. Attached the Side Mount CLAW bracket assembly onto your desired position on the picatinny rail. (2 Slots Back is Suggested)
2. Tighten the CLAW mounting screw from the side and make sure it's firmly attached.
3. Slide the CLAW Quiver into the quick release mount and lock the handle (SEE PICTURE)

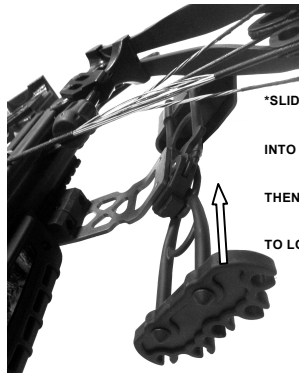
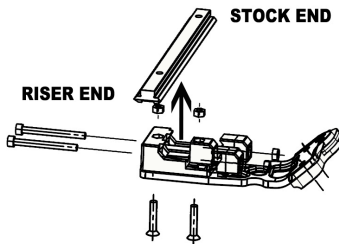

*SLIDE THE QUIVER ALL THE WAY INTO THE QUICK RELEASE MOUNT THEN TURN THE LOCKING HANDLE TO LOCK YOUR QUIVER

USING YOUR CROSSBOW SCOPE

Your crossbow package comes standard with a 4x32 multiple reticle scope that is designed to offer you multiple yardage options without having to make adjustments. Start by sighting in your crossbow at the closest yardage you plan to hunt from, using the top crosshair. A reasonable yardage to get started might be 10 yards, use the top line on the crosshairs. Once you have zeroed in on the closest range, you will need to progressively move back in yardage in order to determine the remaining yardage points that your scope will be sighted. The ONLY crosshair you will be adjusting using the elevation and windage knobs on the scope is the top line, the

yardages for the other lines will be based off your sighting of the top line at the closest range. For example, if you sight the top line at 10 yards the next line down may be approximately 20 yards, then 30 yards. This will have to be determined by progressively moving back in yardage until you are zeroed in with each line from top to bottom.

NOTE: Scope Reticle & Elevation/Windage Knob design may vary from those shown below.



COCKING YOUR CROSSBOW

Before you begin to cock your crossbow, mark your string for center while the bow is un-cocked. It is extremely important that you cock the crossbow centered each time and in the same manner to get the most accuracy possible out of the crossbow, this will be especially important if you choose to cock the bow by hand and not utilize the rope cocker (NOT RECOMMENDED). For the most consistent accuracy possible when manually cocking the crossbow mark the string on both sides of the flight rail so that you can verify it is cocked straight each shot. It is easy to cock the bow off center when manually pulling it back. Your best option is to use the rope cocking device each time you shoot for the most consistent shooting possible. The safety should always be in the Fire position before you cock the crossbow, the unit features an automatic safety which will go to the safe position once the bow is cocked each time. **THE ONLY TIME YOU SHOULD TOUCH THE SAFETY SWITCH IS TO**

SWITCH TO "FIRE" WHEN YOU ARE READY TO SHOOT YOUR TARGET, OR IN THE EVENT YOU RELEASED THE SAFETY ONCE YOU LOCATED YOUR TARGET BUT DID NOT SHOOT AND WANT TO RETURN THE SAFETY TO THE "SAFE" POSITION.

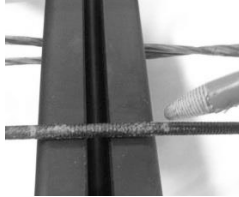

HOW TO USE THE ROPE COCKER

Use of the rope cocker reduces the effort required to cock your crossbow by 50%. This device also ensures perfectly straight cocking, a key ingredient of top accuracy.

As mentioned previously, make sure the safety is on the "Fire" position while your crossbow is facing toward ground for the cocking procedure below:

1. Place one foot securely through the foot stirrup.
2. Place the center of the cocking rope in the rope groove on the stock. The cocking handles should be positioned to the outside.
3. Pull both cocking hooks simultaneously down along the flight rail and attach them to the bowstring directly alongside the rail.

TIP: For maximum accuracy hooks must stay against the flight rail during cocking operation.

Rope Cocking Groove

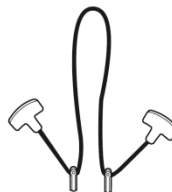

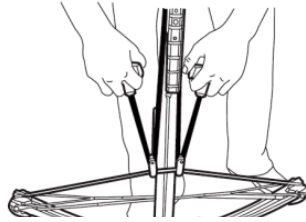
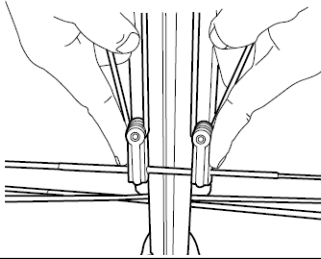

FIRING YOUR CROSSBOW

- Always point the crossbow in a safe direction.

**IMPORTANT: DO NOT POINT YOUR CROSSBOW AT ANYTHING THAT
YOU DO NOT INTEND TO SHOOT AT ANY TIME!**

- Make sure the arrow retainer spring has kept the arrow in the fully loaded position in the trigger mechanism **ALL THE WAY** against the string. (A GAP FROM STRING TO ARROW WILL RESULT IN A PARTIAL DRY FIRE)
- Please double check if your safety is on the “S (Safe)” position. Once you confirm your target. Push the safety forward to the “F(Fire)” position. (**FOR THE BEOWULF MODEL, THAT HAS THE ANTI-DRY FIRE FUNCTION TRIGGER BOX, YOU ARE ONLY ABLE TO OPEN THE SAFETY WHEN YOUR ARROW IS PROPERLY PUSHED ALL THE WAY INTO THE TRIGGER MECHANISM**).
- The crossbow will now fire when the trigger is pulled. The safety **MUST** be disengaged in this manner prior to every shot.

IMPORTANT!: BE SURE TO KEEP YOUR FINGERS AND THUMB BELOW THE TRACK SURFACE DURING FIRING AT ALL TIME.

INCORRECT FINGER POSITION





WARNING!!!

**DRY FIRING WILL VOID THE
WARRANTY FOR ALL PARTS!**

IMPORTANT: GENERAL SAFETY

EXTREME CAUTION SHOULD BE USED AT ALL TIMES WHEN HANDLING A CROSSBOW. FAILURE TO FOLLOW THESE INSTRUCTIONS COULD RESULT IN SERIOUS INJURY OR DEATH.

- Always keep your fingers below the flight track and out of the path of cables and strings when firing the crossbow.
- Never dry-fire the crossbow (shooting without an arrow or too light of an arrow).

Dry firing will void the warranty and can result in damage to the limb assembly and possibly cause personal injury.

- Never fire the crossbow until you are sure of your target.
- Always use an adequate target and backstop when target shooting. (HAY BALES, CARDBOARD, BOXES OF RAGS, ETC. ARE TOTALLY UNACCEPTABLE)
- Always use suitable crossbow arrows with half-moon nocks.
- Always inspect the crossbow and arrows before firing. **Bent or damaged arrows are not safe to fire and should be discarded.**

- Always inspect the general condition of the crossbow before cocking or shooting the crossbow.
- Please always lubricate the crossbow barrel with rail lube after every 5 shots to extend your string life and crossbow usage. (BEESWAX, PARAFFIN, ETC. ARE NOT TO BE USED AND WILL RUIN YOUR STRING)

WARRANTY

SA SPORTS, LLC

ONE YEAR LIMITED WARRANTY

All Products



SA Sports, LLC warrants its products to be free from defects in both material and workmanship under normal use and service for one (1) year from date of purchase. Not included are damages from improper use, abuse, unauthorized repairs or modifications or alteration. Specifically EXCLUDED are strings, cables, arrows, or other moving parts that are considered to be replaceable parts requiring periodic servicing. Damage resulting from a DRY FIRE (shooting without an arrow), whether intentional or accidental is not covered under warranty and repair costs will be certain. (Continued)

To obtain warranty service, the unit should be packaged securely to avoid damage in transit, it should include a description of the nature of the repair request, and it should be returned postage paid to SA Sports, LLC. At our sole discretion we will repair or replace the unit that is deemed to be under warranty upon inspection, and ship the product back to the customer at no additional cost using standard delivery service of our choice. Any product received into our facility that is deemed to have been misused, abused, altered, modified or

otherwise ineligible for coverage will be issued an estimate for repair prior to work being completed. International customers will be responsible for the transit costs both inbound and outbound and should therefore call for a return authorization prior to shipping the product.

Please feel free to contact us regarding any product issue, or assembly help or additional assembly direction. We will help in any way we can to ensure your best experience with the product.

Direct your inquiries to

SA Sports, LLC

1337 N Nelson Street – Unit B

Allentown, PA 18109

Tel 484-294-2257

email: sales@sa-sports.com

www.sa-sports.com

Please retain your original purchase receipt in the event that you need service, include a copy of the receipt from date of purchase.

**Thank you for choosing EMPIRE Product
once again!
Enjoy your adventure!**