

# LED MIRROR INSTALLATION INSTRUCTIONS

1. Before starting installation, please make sure:

The wall surface must be of suitable strength and construction

The main electricity supply has been power-off

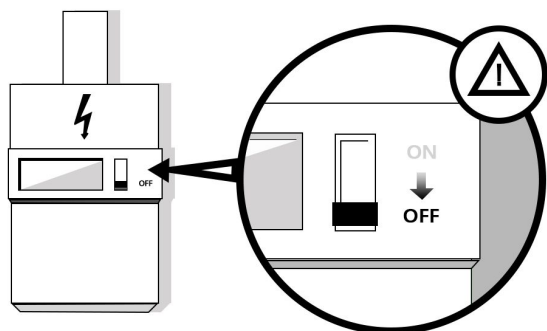

4. Make the electrical connections ensuring first that the electrical supply has been turned off.

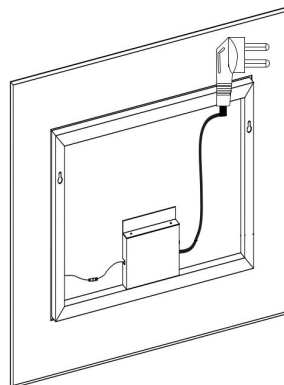

2. Open the carton and make sure all the parts listed below are present

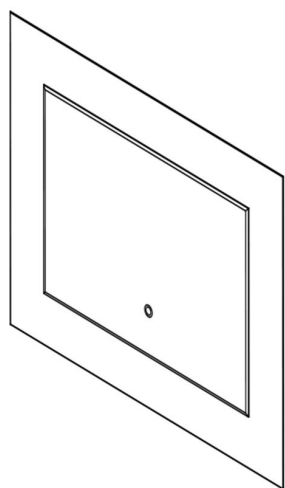

2X

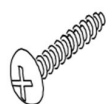

2X

1X

5. Hang the mirror onto the wall

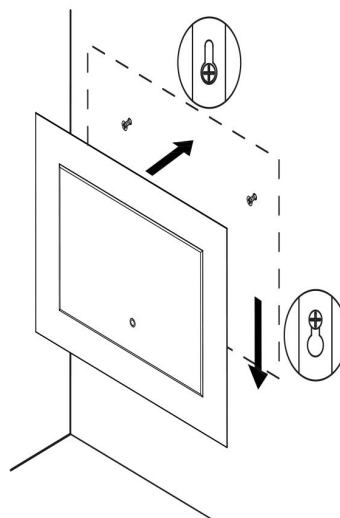

3. Mark a desired height of the mirror. Drill the required holes and insert the wall plugs.

Note: Wall plugs supplied are only suitable for solid stone/brick walls. Please ensure the screws are fully tight.

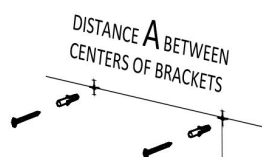
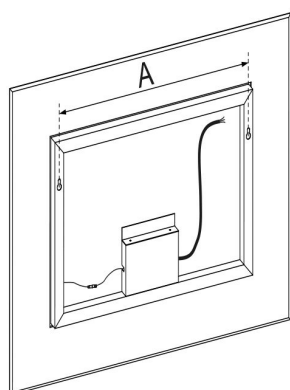

FLOOR  
FROM  
HEIGHT  
DESIRED  
CHOOSE

6. Press the touch switch to control on/off the lighting.

