

Live for freedom

# SMART TOILET



Installation Manual







**bathonomy**

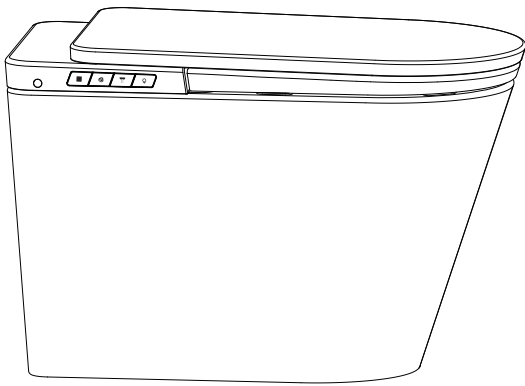

## Catalogs

1. Overview .....	1
1.1 The body of the toilet .....	1
1.2 Side button function introduction .....	2
1.3 Introduction of remote control unction .....	2
1.4 Remote control code instructions .....	2
2. Packing list .....	3
3. Explanation of symbols .....	4
4. Safety instructions .....	4
4.1 Normal use .....	4
4.2 Safety instructions .....	4
4.3 Battery use .....	6
5. Installation .....	7
5.1 Precautions before installation .....	7
5.2 Confirmation before installation .....	7
5.3 Product installation method .....	8
5.4 Instructions for acceptance after installation .....	12
6. Cleaning and maintenance .....	12
7. Product technical specifications .....	13
8. .Foot induction flushing function introduction .....	13
9. common fault diagnosis .....	14

# 1. Overview

## 1.1 Toilet

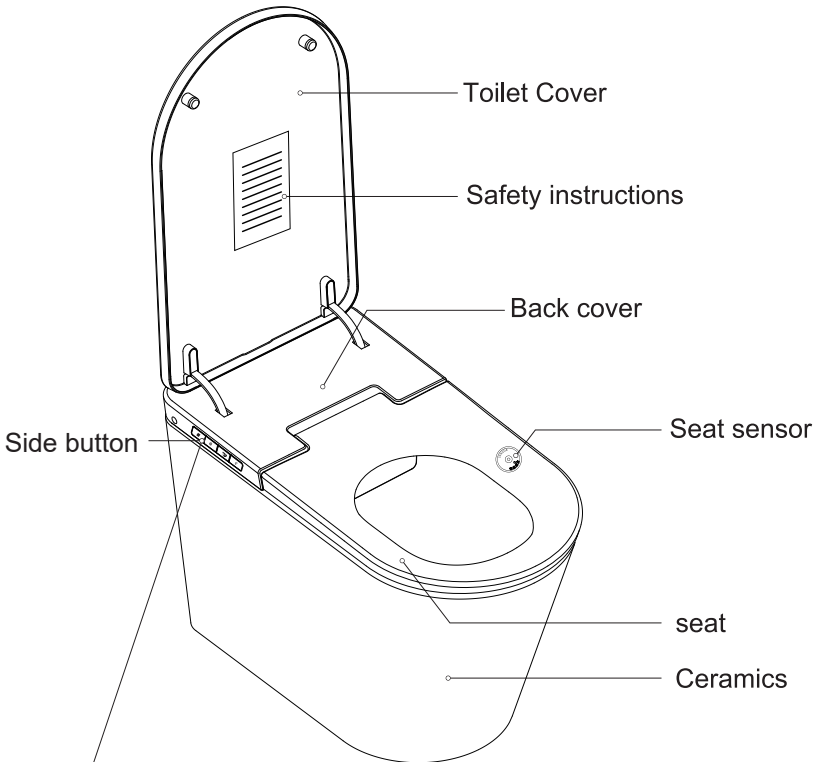

### Side button introduction

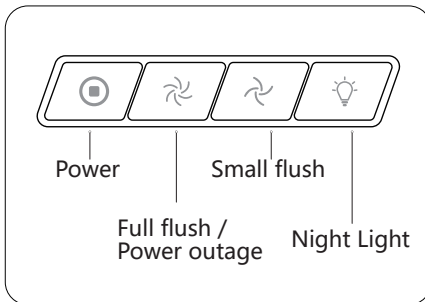

**Note:** Regarding the appearance & function, please refer to the physical goods.

## 1.2 Side button

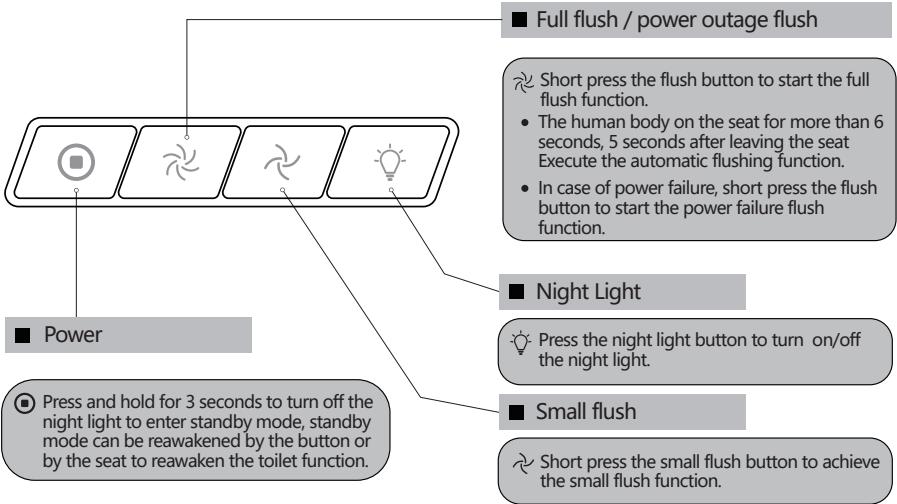

## 1.3 Remote

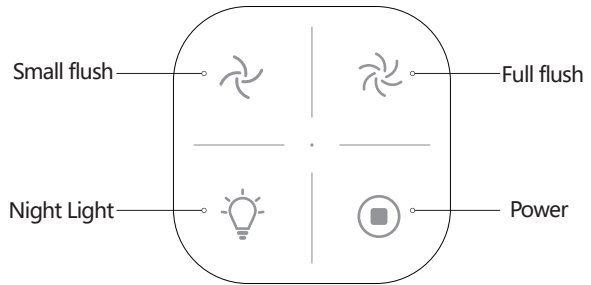

## 1.4 Pairing the remote

Smart Toilet power off and restart, long press the night light button on the remote control for 5 seconds.

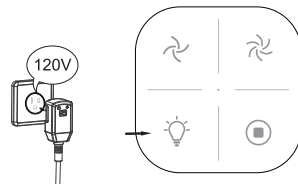



## 2. Packing list

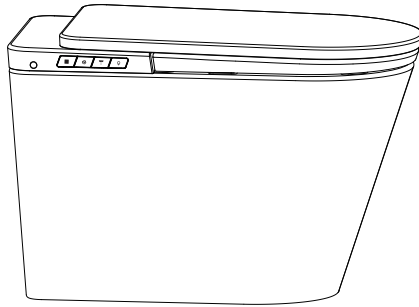

Complete machine



Remote

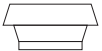

Wax ring

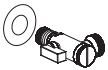

Angle valve filter & decorative cover



Backup battery

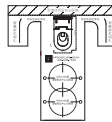









Ceramic Installation  
Positioning drawings



Battery of remote

Manual

### 3. Explanation of symbols

- |     |   |         |   |
|-----|---|---------|---|
| 3.1 |  | DANGER  | Express that you will be dead or seriously injured if not avoid the dangerous situation.            |
| 3.2 |  | WARNING | Express that you will be dead or seriously injured if not avoid the dangerous situation.            |
| 3.3 |  | CAUTION | Express that it may cause personal injury or property damage if you ignore the sign and misoperate. |
| 3.4 |  |         | Do not add foreign matter such as water or detergent to the product body.                           |
| 3.5 |  |         | Do not disassemble the product privately.   |
| 3.6 |  |         | Keep away from fire.  |
| 3.7 |  |         | Please operate according to the manual.   |
| 3.8 |  |         | It's forbidden.   |

### 4. Safety instructions

Please read the manual carefully, especially the safety instructions in order to make sure you can enjoy the service of the product. Please reserve the manual carefully. Please attach the manual if you send the product to others.

#### 4.1 Normal use

This product is a one-piece intelligent toilet with integrated flushing system. It can comfortably clean the buttocks and private place which is used only for closed space .

Any other use is considered as abnormal use. For abnormal use, we will not assume any responsibility .

#### 4.2 Safety instructions

Please read and follow the safety instructions as below!

##### Requirement of user

- For disabled, defective people in physical, sensory perception and intellectual abilities, and people who is lack of experience and common sense (including children), please use this product under supervision.
- Don't allow children to play with this product.



##### **DANGER**

- Please make sure that the ground wire has been connected.
- If the the ground wire is not connected, it may cause electric shock or leakage.
- Make sure the power cord is not damaged.
- The power cord can't be stucked or squeezed.
- Keeps the power cord away from hot surfaces and sharp edges.
- The power socket must be within the specified range(AC120V±10%).



## **DANGER**

- Do not use it in thunder weather. (Please Pull out the power plug in thunder weather.)
- Do not pull the power cord at random, break, forcibly bend and twist, stretch, curl, bundle, load or over-clang.
- Do not touch or plug and unplug the power plug with wet hands, otherwise there will have danger of electric shock.
- Do not use it when it can't work normally. Disconnect power immediately , close the angle valve to cut off the water source and ask for help from professional repair man.



## **WARNING**

Avoid product failure and damage caused by improper use.

The cold water of the intelligent electronic toilet should be connected from the main water supply pipe. Do not connect any wastewater, mixed water, industrial water, sea water or other untreated or semi-treated water.

- If the product is moved from a lower temperature position to a higher temperature place, it may have condensate water. Please turn off the product for several hours at this time.
- Do not install this product in a room where may be frosted. The room temperature can't be less than 4 °C.
- Do not put fire, candles, cigarette butts or similar items on this product.
- Do not soak the product in water or expose it to the sun.
- Do not attempt to flush debris other than human waste and toilet paper.
- Do not lean on the back cover, climb or stand on the product.
- Do not put any heavy objects on the cover.
- Repair work must be performed by relevant professionals.
- Do not disassemble the back cover, cover and seat.
- Do not modify, retrofit or repair the product.
- Incorrect repair may cause accidents, damage or operational failure.
- If the power cord is damaged, don't disassemble it by yourself. It must be replaced by the manufacturer or the repair department or a similar professionals.
- When do the cleaning and maintenance of the plastic part, please do not use unsuitable detergent(such as Sulfuric acid, nitric acid, acetic acid, carbon cyanide, chloroform, acetone, methyl ethyl ketone, benzene, hydrochloric acid, nitric acid, steam kerosene etc. )
- Please cut off the power when cleaning the product and the remote. Don't pour water or detergent into the product.
- Avoid to use this product in an environment which is humid and easily touched by water .Don't spray water to the product. Don't rinse this product with water.
- Don't block the air outlet. Don't put your hands or other things into the air outlet. Don't cover the air outlet when using it.
- Don't shoot urine into the air outlet.
- Do not put ignited cigarettes and other burning materials into this product.

## 4.3 The use of battery

If there's leakage of battery liquid, please do not let the skin, eyes and mucosa to be touched by the battery liquid. If you touch the liquid carelessly, please rinse the infected part immediately with mass water and go for a doctor immediately.



### **WARNING**

- Please put the battery out of the reach of kids. It will be life-threatening if swallowing the battery. Please request medical immediately if the battery has been swallowed.
- Do not charge the battery. It is forbidden to reactivate and disassemble the battery or put it into fire.
- Please get out the battery from the remote after running out of power .Otherwise the liquid may leak and cause damage.
- Clean the battery and contacts before assemble the battery. Pay attention to the battery polarity to be assembled in correct position during installation.
- Please take out the battery and save it correctly if the remote is not used.
- Do not keep the battery in extreme environment. Do not touch the heat source or expose to the sun, otherwise it may cause leakage.
- Do not carry and store the battery with metal products.



### **CAUTION**

- Do not use excessive force when closing the cover and seat .
- Do not intentionally soil, spray or block the cleaning nozzle.
- Please pull out the plug regularly and wipe the dust from the power plug with a dry cotton cloth.
- Keep the skin close to the seat sensor when use it, otherwise the product will stop cleaning or drying function. Children should seat back to touch the seat sensor.
- Please use the new hose parts attached with the product, the old one can't be reused.
- Please avoid closing to the heater.
- Do not connect to the power through the external switch to avoid danger from accidental resetting of the circuit breaker, such as a timer or a timed on/off circuit that is connected by a common component.
- Please close the angle valve before disassembling the filter. Be sure to tighten the angle valve to prevent water leakage when installing the filter after cleaning.
- When you will not use this product for a long time, such as going out for a business trip or travelling, be sure to pull out the power plug, turn off the water and drain the remaining water inside the product.
- The remaining water may freeze when the product is transported over long distances or stored for a long time in cold winter or alpine region. To prevent the damage caused by freezing, please take antifreeze measures.

## 5. Installation

### 5.1 Precautions before installation

Installation space:

please make sure opening and closing the door will not affect the installation and use when you are checking the installation space is big enough or not. The distance of the inlet pipe from the ground should be more than 150mm.

Please confirm the location of sewage outlet and wax seal as below picture before installation.

### 5.2 Confirmation before installation Space structure of bathroom

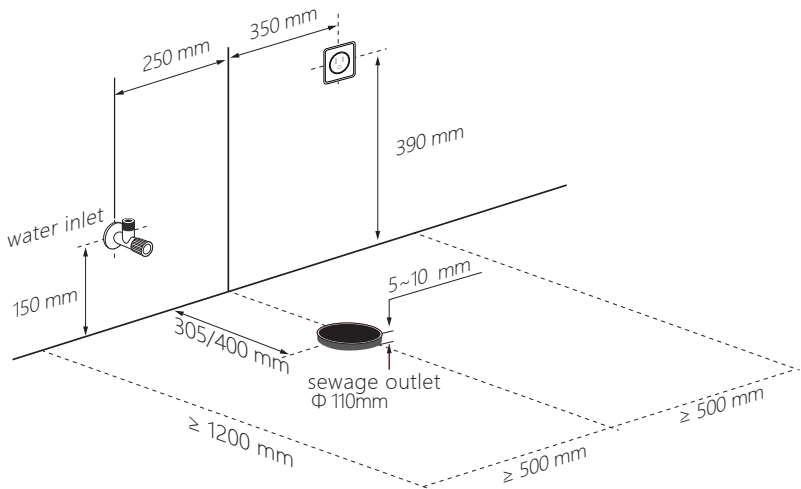

## GROUNDING INSTRUCTIONS

This product should be grounded. In the event of an electrical short circuit, grounding reduces the risk of electric shock by providing an escape wire for the electric current. This product is equipped with a cord having a grounding wire with a grounding plug. The plug must be plugged into an outlet that is properly installed and grounded.

**DANGER** – Improper use of the grounding plug can result in a risk of electric shock.

If repair or replacement of the cord or plug is necessary, do not connect the grounding wire to either flat blade terminal. The wire with insulation having an outer surface that is green with or without yellow stripes is the grounding wire. Check with a qualified electrician or serviceman if the grounding instructions are not completely understood, or if in doubt as to whether the product is properly grounded.

## Water pressure

1. Minimum static water pressure : 0.14MPa (1.4kg/cm<sup>2</sup>).
2. Minimum water flow: more than 20L per minute.
3. Please make sure to meet the two conditions above when the toilet is used parallelly with faucet or other water equipment.

## Installation drawings:(mm)

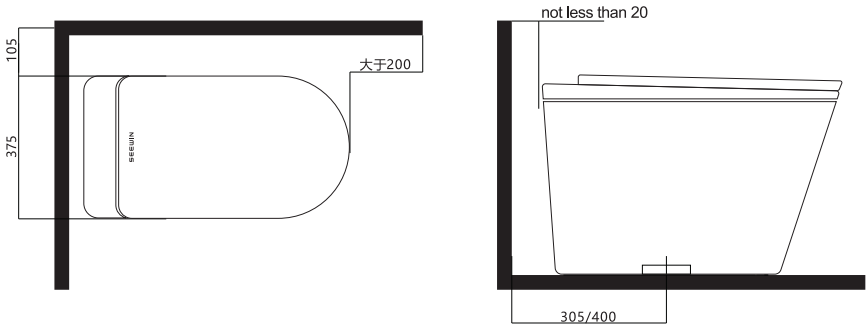

### 5.3 Installation method Installing of wax ring and ceramics

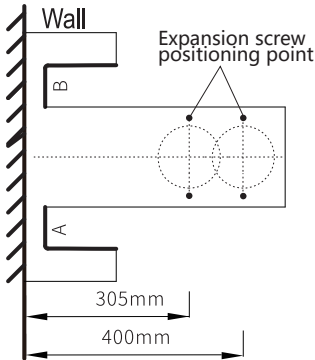

Figure 1

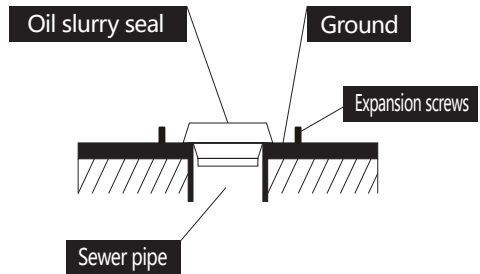

Figure 2

1. Align the mounting cardboard with the center line of the drainage port, fix it with transparent tape around, depict the corresponding contour lines according to the location of the thickened lines at the mounting cardboard A and B, and then drill holes and hit the expansion screws on the location of the corresponding expansion screws on the outside of the drainage port. Finally, remove the mounting board. (Figure 1)

2. Place the sludge seal on the drainage port and do good sealing treatment. (Figure 2)

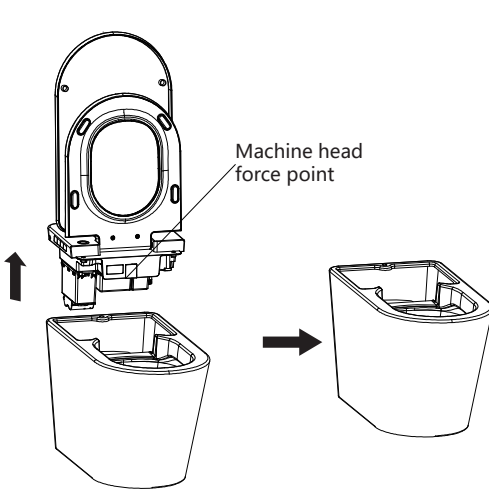

Figure 3

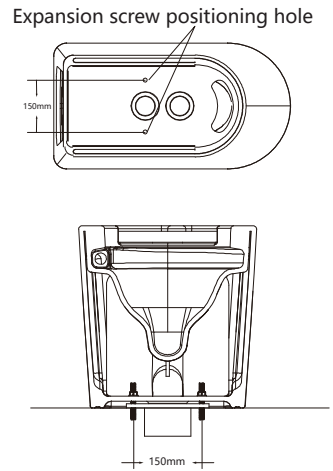

Figure 4

3、 Grab the force point of the head and lift it up with force, using the head and ceramic body separation. (Note: Please do not use force on other parts). (Figure 3)

4. Lift the toilet (ceramic) to the floor drain as a reference, align the expansion screw hole at the bottom of the toilet ceramic body with the expansion screw position on the ground, and slowly put the ceramic on it. Press down so that the sludge is in close contact with the toilet drain, and hit the fixing nut at the expansion screw. (Figure 4)

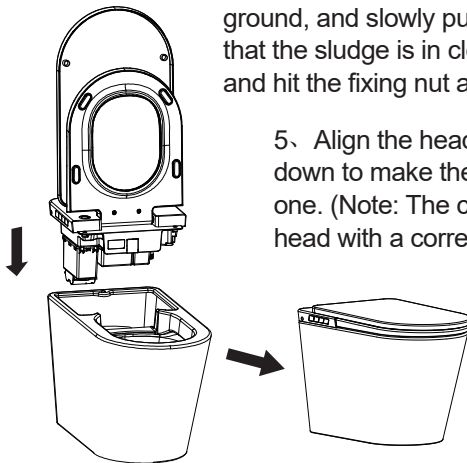

Figure 5

5、 Align the head with the ceramic body and press down to make the head and ceramic body become one. (Note: The ceramic body is connected to the head with a corresponding bayonet)

## Connect to water supply pipe

1. Close the water supply.
2. Install the angle valve filter and the decorative cover of the angle valve to the proper position, then open the angle valve switch to drain for 1 minute (using a container to do the water receiving). Drain the dirty water inside the pipe.
3. Connect the angle valve filter, water supply hose in sequence as Figure 3.
4. Tighten the connect part of the pipe and check carefully to make sure no leakage.
5. It is suggested to clean the filter every 2 months as Figure 4. Close the angle valve before cleaning and rive the filter by coin, then install and tighten the filter back after remove the dirt and impurity.

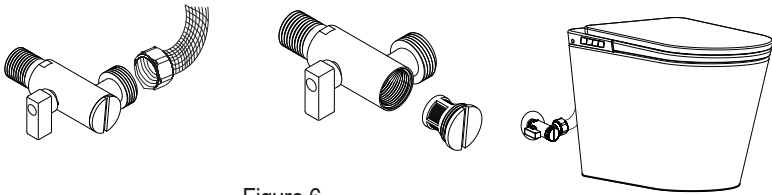
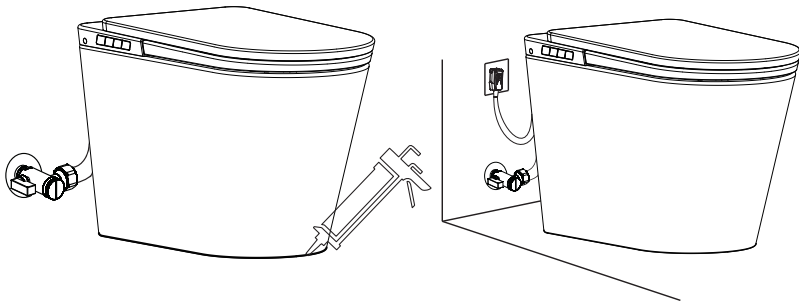

Figure 6

## Smear the glass glue

Smear the glass glue in the gap between the bottom of the ceramics and the ground after the toilet is installed to prevent water seepage.



## Connect the power cord plug

Open the angle valve filter and connect the power plug. The power cord plug must be connected to wall socket with safety grounding device in AC120V,16A,60Hz.



## Water connected confirmation

1. Open the angle valve to the maximum as picture.
  2. Make sure there is no water leakage at every joint.
- ※If water leaks, retighten the nut and install it again.

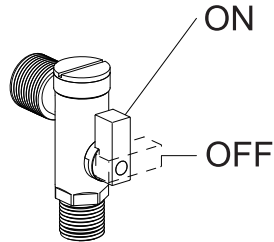

## Connect the power supply

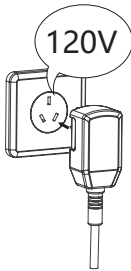

Ordinary three-plug plug

1. Connect the ground wire.
2. The power plug is connected to the 120 volt outlet.

## Backup battery installation

1. Take the cable out from the place as the illustration (the cable package is attached in the back of the product, peel it off gently).
  2. Connect the waterproof DC power plug and tighten the waterproof cap.
  3. Put the battery case in the proper position as the illustration.
- ※The battery and cable have positive and negative poles. Do not insert by force, otherwise the product will be damaged. If any doubt, please inquiry from your seller.

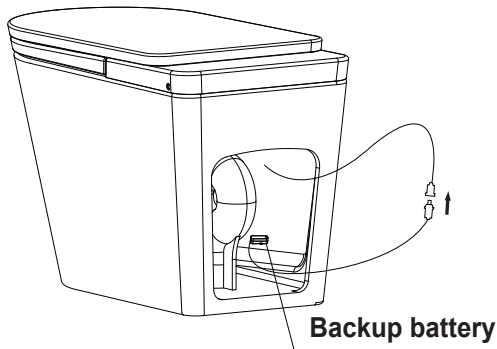

### Backup battery replacement (used for electricity-off flush)

1. Loosen the screws that secure the battery cover, remove the old battery and give it to a professional recycling agency .
2. Replace the new battery and lock the fixing screw as the shown picture.
3. Refer to the battery installation picture to install the battery in the proper location.

※Battery have to be put in a place where children can not get. Please confirm the positive and negative of battery. Do not charge, disassemble, burn the battery. Don't mix it with old batteries or different types of batteries to avoid leakage or explosion.

※The battery case has a moisture-proof function. Please tighten the fixing screws to achieve a good sealing effect.

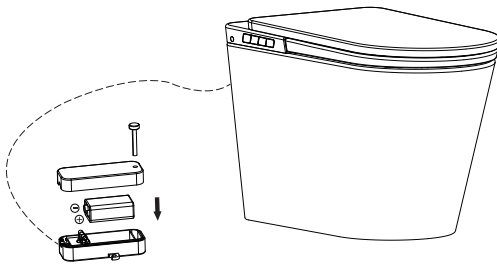

## 5.4 Acceptance instructions after installing

After installation finished, you must test run and record the installation results in the table below.

Acceptance inspection item		Conclusion	
Make sure whether it is connected to the AC120V, 16A, 60Hz grounded power supply socket.			
Is the power plug connected stably in the socket ?			
Are the water pipe joints tightened?			
Is the total inlet valve of the water pipe open?			
Whether each function is normal : Whether the function of the seat is normal; whether the function of the side button is normal; the above confirmation checks must be done completely and confirmed.			
Installation date		Store name	Installer

## 6. Cleaning and maintenance

Please clean and maintain the product regularly to make sure the normal use of product.

### Note

- Please cut off the power, close the water supply angle valve and stop the water supply before maintenance.
- Do not rinse this product with water during maintenance.

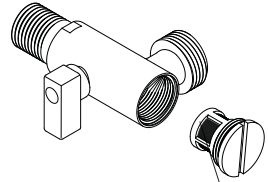

**angle valve filter**

**It is recommended to clean the filter every 1-2 months.**

## Plastic parts and ceramics's cleaning and maintenance

- Clean the toilet pan regularly, or clean it immediately if dirt filth found. If not clean it oftenly, it may become stubborn dirt filth.
- Please clean the lid, seat and back cover by non-corrosive detergent and warm water, then wipe it with a damp cloth gently. Make sure that no detergent left in the seat. The ceramics can be cleaned with neutral detergent combined with cold or warm water, using a soft brush, rag or sponge (Corrosive detergent is forbidden to use).

## 7. Product specification

Rated voltage	AC120V,16A,60Hz.
Rated power	50W
Power cable	1.5m
Applicable water pressure	0.14-0.75MPa
Water temperature	4-35°C
Ambient temperature	4-40°C
Net weight	≈ 45kg
Waterproof level	IPX4

## 8. Common Fault Diagnosis

If something goes wrong, please read the following to try to solve the problem. If can't solve, please contact to seller.

### Power switch

Fault	Failure analysis	Solutions
Product not work	Check whether the socket is electrified or not, the plug is loosened or not	Check circuit

### Ceramics

Fault	Failure analysis	Solutions
Flush uncleaned when in lower water pressure	Angle valve filter blocked	Clean the filter according to the manual
	Water pressure is too low	Measuring the water volume which is less than 10L for 30s or not (Our suggestion is to buy a booster pump)
	Water inlet pipe bended	Ensure the water supply line is smooth
Normal water pressure but flush uncleaned and no siphon	outlet has air leakage	Please ask professional repair man for help
	S pipe blocked	Using a toilet dredge
Normal water pressure, but flushing not work	Check the angle valve is closed or not	Open the angle valve again
	Flush valve failure	Please ask professional repair man for help

### Others

Fault	Failure analysis	Solutions
Cover/seat falls down too fast	Failure of Damping Slowing down Function	Clean the filter according to the manual
Orderly cyclic work of each function	Mistaken into engineering debugging mode	Pull out the plug and connect the plug after 1 minute
Night light not work	Check the night light which is close or not	Open the night light according to the manual
Leakage		Close the angle valve and disconnect the power supply then contact your installer