

**Plan Care**

**35983010051 Tip-up seat**

**PRODUCT**



**DRAWING**

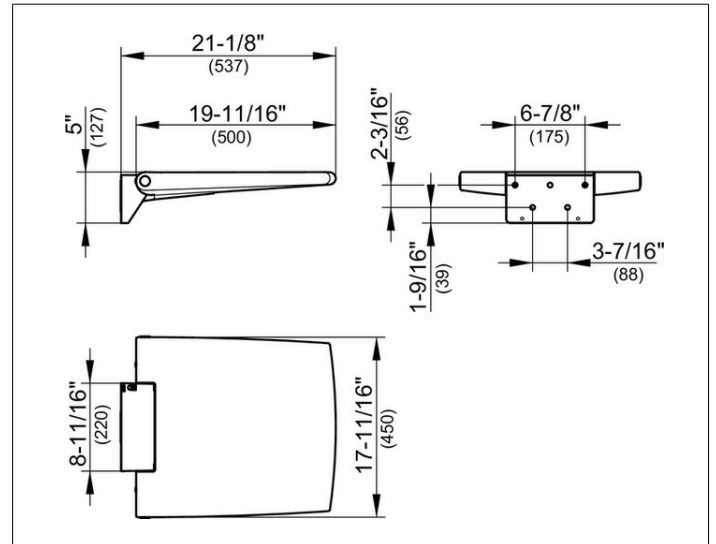

**PRODUCT ATTRIBUTES**

wall mounted  
tip-up soft seat

**SURFACE**

chrome-plated/white (RAL 9010)

**SPECIFICATIONS**

KEUCO PLAN CARE Tip-up seat 35983010051  
white (RAL 9010) tip-up seat  
made from Polyurethane-foam  
in aesthetic, functional design,  
for wall mounting for safe seats in the shower area  
Wall bracket and chromed seat support  
as design element  
anti-static,  
easy Cleaning with max. 60% Ethanol- or Propanol detergent,  
other disinfectants are not recommended  
fold-up seat up to 253 Lb  
Width 17-11/16' (450 mm),  
length of the seat 19-11/16' (500 mm),  
Projection 22-1/8' (537 mm).