

## Double Pump Illustrative Guide

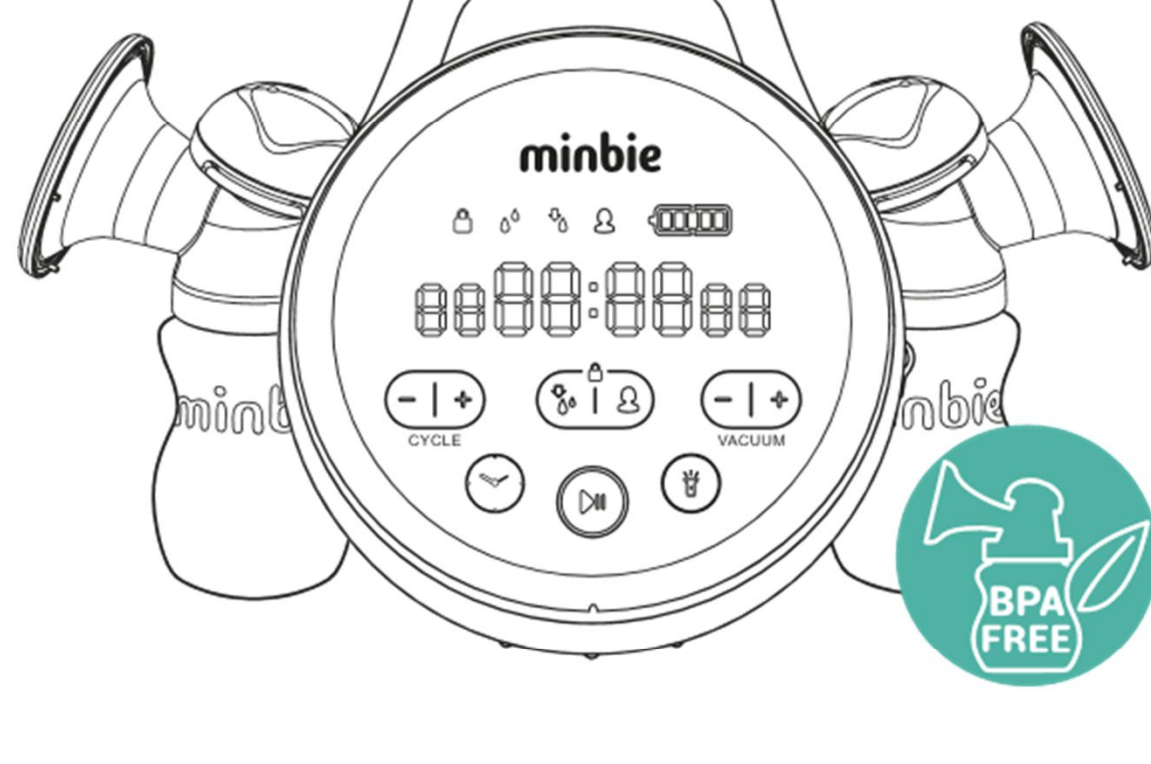

The Pump Instruction Manual must be read before using the Pump.

### CHARGE PUMP BATTERY FOR 4.5 HOURS

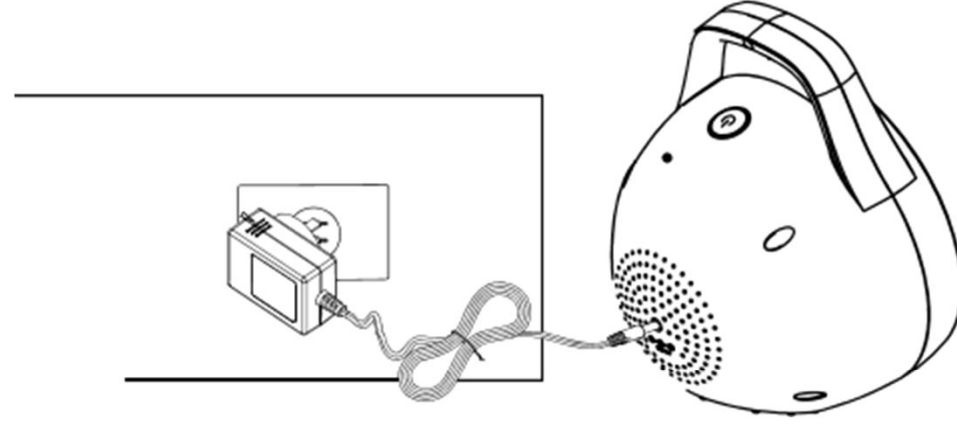

To assist the battery life: recharge the battery when possible, even after each use. Never let the battery run flat. Turn the pump off when not in use.

### PREPARATION FOR USE

Gently peel-off the thin protective layer of film that's on the face of the pump.

DO NOT WASH THESE ITEMS only wipe down with sterile wipes or clean damp cloths.

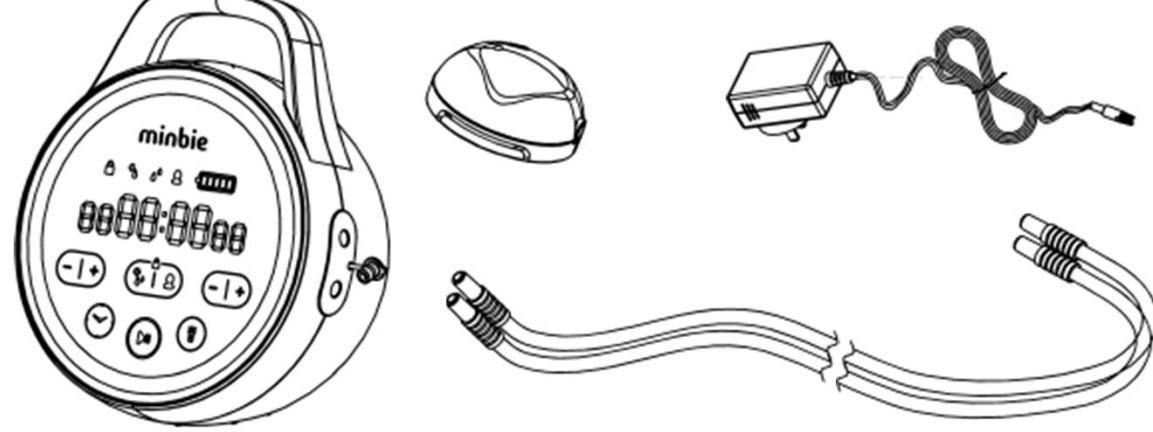

### WASH THESE ITEMS THAT COME INTO CONTACT WITH YOUR BREAST MILK

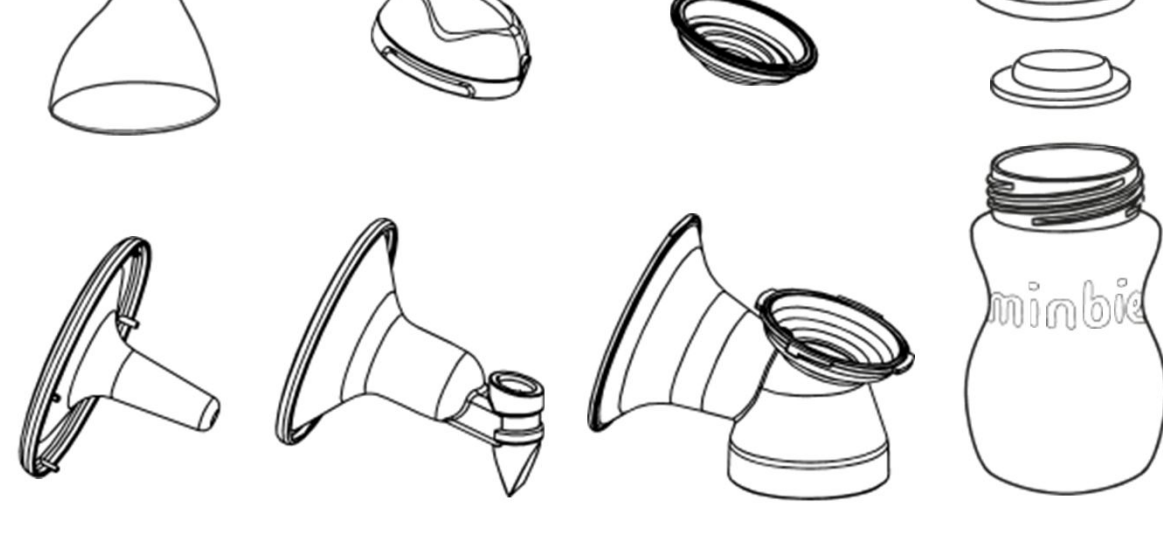

1. WASH IN WARM SOAPY WATER



2. RINSE IN FRESH WATER

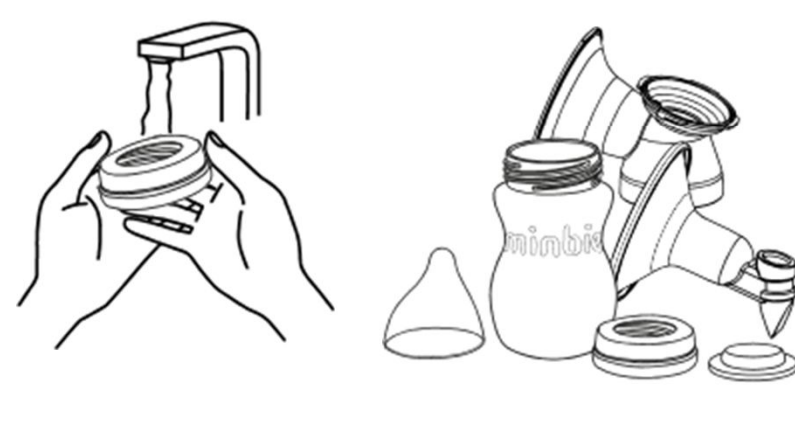

3. STERILISE & AIR DRY  
We recommend the Minbie steam Steriliser or Minbie UV Steriliser. All pump items must be sterile and completely dry before use.

### HOW TO ASSEMBLE THE SHIELDS

Push the silicone shield into the shield body. Hold the thicker part of the silicone shield above the valve and connect it inside the shield body and then connect the silicone shield around the rim.

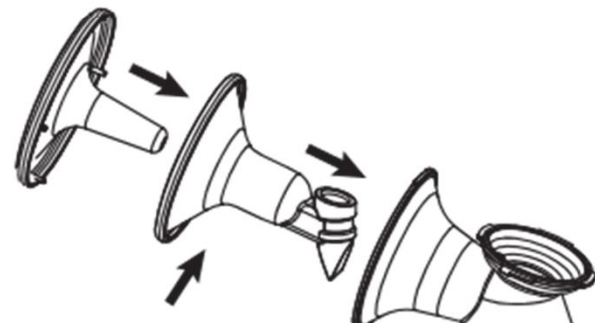

### ASSEMBLE THE DIAPHRAGM AND WHITE CAP

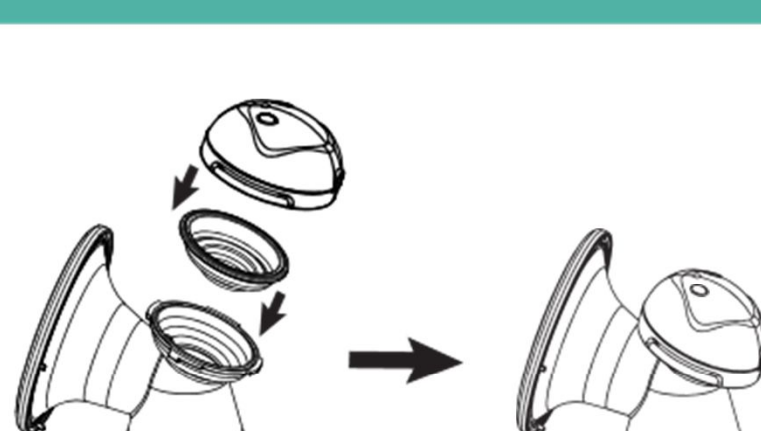

### ATTACH THE BOTTLE FIRMLY TO THE SHIELD BODY

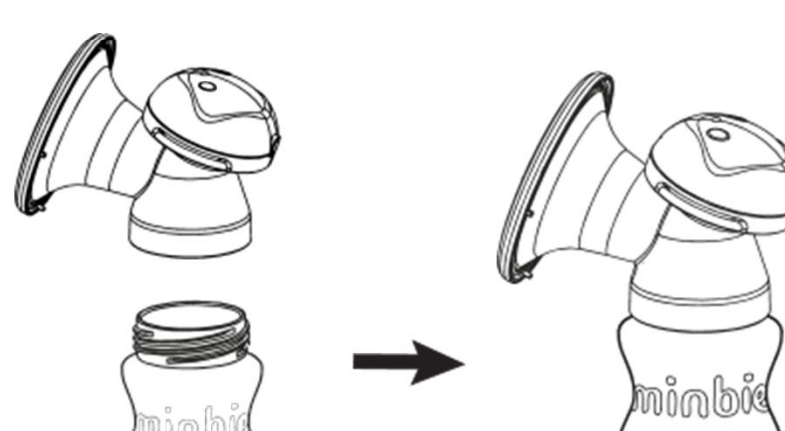

### INSERT WHITE TUBE ENDS

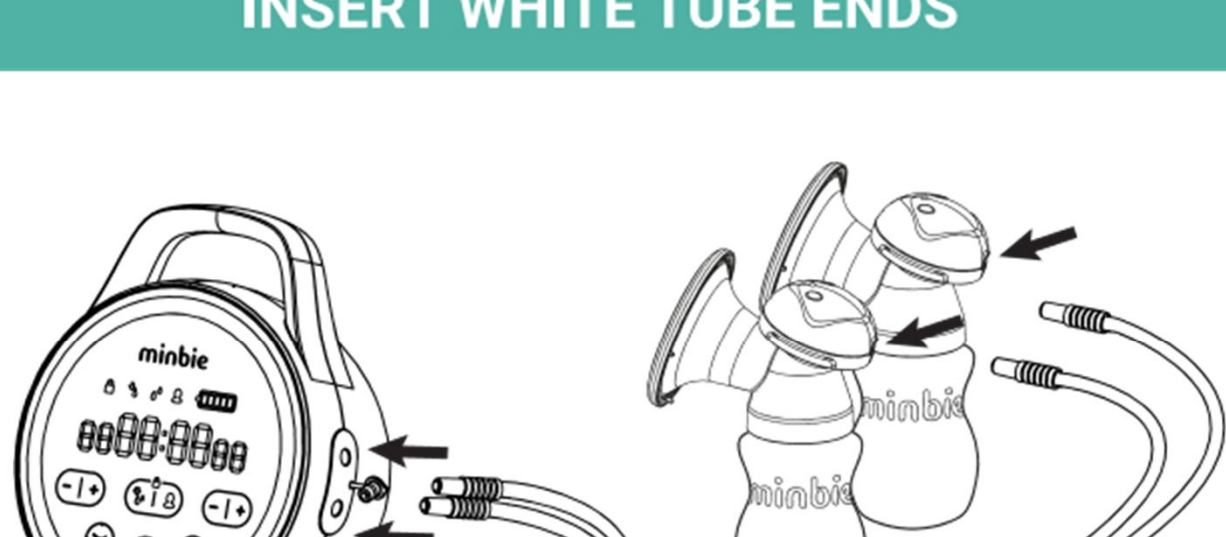

Make sure the tube connectors are attached firmly

### SINGLE PUMPING

