



X450

Quick Start Guide

Visit kaiserbaas.com for more information

Before operating your X450 please ensure you have read and understood the safety precautions

Please ensure you remove the plastic protection film from the front lens and back screen before using.

1

Remove the camera from the Waterproof case. Release latch to unlock casing.

2

Charge your X450

Connect your camera to a USB charger or computer using the included Micro USB cable. Whilst charging the red light will appear. Once fully charged it will turn off.

3

Insert your SD Card

Once your camera is fully charged, insert the Micro SD card (not supplied) into the SD card slot. We recommend using a Class UHS 3 and above Micro SD card up to 128GB for maximum performance.

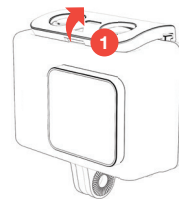

Note: Please ensure you format your SD card before you start filming with it for the first time.

3

Format your SD Card before using the camera for the first time

Tap on the Settings icon (3) in the bottom right corner of the screen. Tap to select the Settings icon on the top right of the screen. Scroll down the menu until you get to Format SD Card. Tap on Format SD Card. Tap on Confirm to format your SD Card.

NOTE: This will clear all data on the card and ensure it is ready for recording.

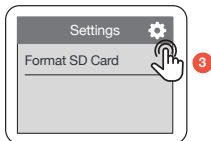
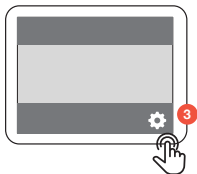
**Using your Camera**

1

To turn your camera on/off - hold the Power/Mode button on the top of your X450 for few seconds.



2

Select from the following modes to capture your footage by scrolling down on the shoot mode page: Video; Photo; Time Lapse Video; Time Lapse Photo; Slow Mo; Burst Mode; Self Timer; Photo & Video.

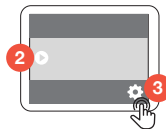

3

To access settings and change video/image resolutions, tap the settings icon on the screen.

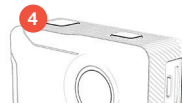

4

To start recording video, press the Record button on the top of your camera.

Reviewing your footage

5

To review footage, tap the Playback icon on the screen.

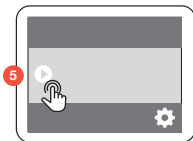

Main Menu Screen

6

Scroll through the files to select and review footage.



Playback Menu

7

Click on the back button to return to the main screen.

Connecting to the KB Capture App

1

Turn on Wi-Fi on your camera by swiping down on the screen and then tapping the Wi-Fi icon.

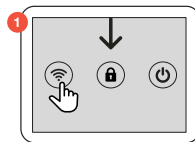

2

Go to your Smartphone settings and ensure your Wi-Fi is turned on. Select KB-X450 network. The default password is: 12345678. If your connection fails, please close down the App and relaunch it and restart the camera.

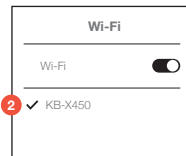

App Name: KB Capture

Scan these codes to access the KB-X450 App.

X450 Action Cam

14 Megapixels

Video Resolution Options

4K 30FPS (3840x2160) – Default
 2.7K 30FPS (2704x1520)
 1440P 60/30FPS (1920x1440)
 1080P 60/30FPS (1920x1080)
 720P 120/60/30FPS (1280x720)

Photo Resolution (Image Size)

14M, 12M, 10M, 8M, 5M, 3M

Storage

We recommend using a Class UHS 3 and above Micro SD card up to 128GB for maximum performance.

Visit www.kaiserbaas.com/support or email helpdesk@kaiserbaas.com for support. For the complete user guide, visit www.kaiserbaas.com

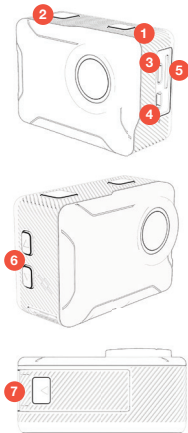

- | | |
|-----------------|-----------------------------|
| 1. Power / Mode | 5. Micro SD Slot |
| 2. Record | 6. Up / Down Scroll Buttons |
| 3. Micro USB | 7. Battery Latch |
| 4. Micro HDMI | |

KAISER BAAS



@kaiserbaas

kaiserbaas.com

#KBdiscover #captureadventure