



CALL FOR SUBMISSIONS
2022 exhibition program

Craft ACT Craft + Design Centre



craft + design centre

Craft ACT: Craft + Design Centre is supported by the ACT Government, the Visual Arts and Craft Strategy – an initiative of the Australian State and Territory Governments, and the Australia Council for the Arts – the Australian Government's arts funding and advisory body.



CRAFT ACT CRAFT + DESIGN CENTRE

Tues–Fri 10am–5pm

Saturdays 12–4pm

Level 1, North Building, 180 London

Circuit,

Canberra ACT Australia

+61 2 6262 9333

www.craftact.org.au

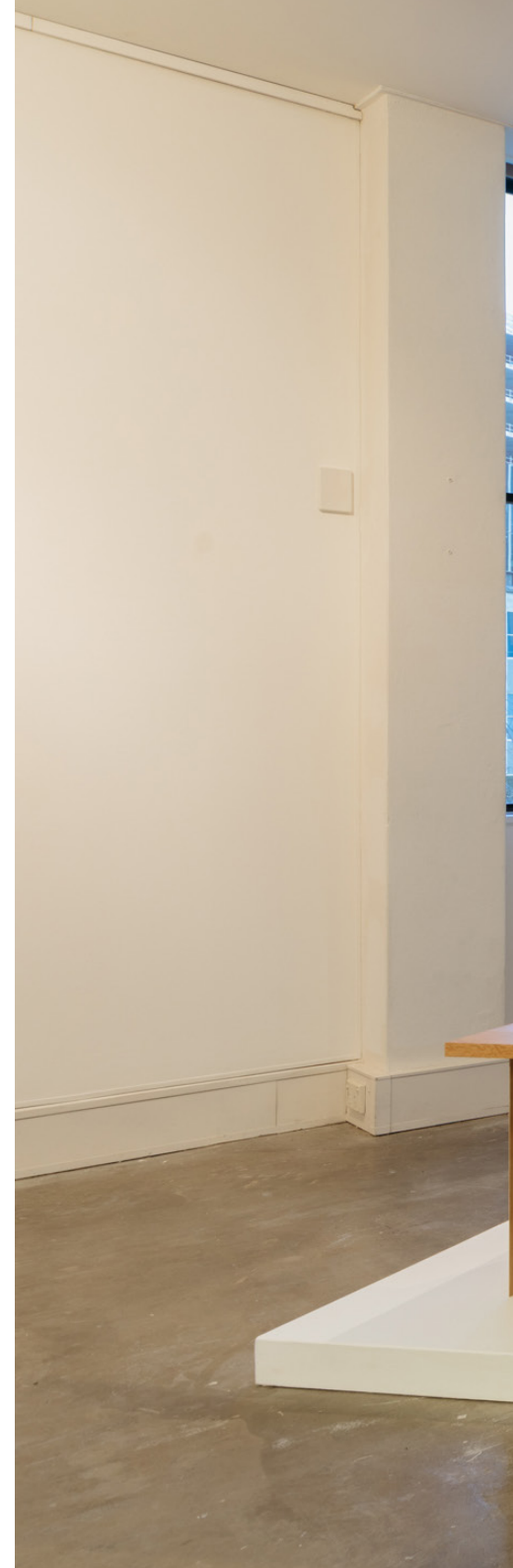

Front Cover: The Teapot Project exhibition, 2019. Photo: 5 Foot Photography
Opposite: Differing Perspectives exhibition, 2020. Photo: 5 Foot Photography



LIBRARY 20

Differing Perspectives
Colum Hurrey | Jordan Leffler

THE ART OF THE FUTURE

Craft ACT: Craft + Design Centre invites craftspeople, designers, makers and curators at all levels of experience and across a variety of mediums to propose new exhibitions for the 2022 artistic program.

ABOUT CRAFT ACT

Since 1971, Craft ACT has played a vital role in sustaining Australia's high-quality studio practice and supporting craftspeople, designers and audiences.

We are proudly one of Australia's longest continuous-running membership organisations in the visual arts and we have much to celebrate. Craft ACT is recognised as a leading centre in Australian craft and design, with a vision to strengthen the dynamic link between the arts – as encompassed in the craft sector – and the broad creative industries and design sector.

Image: Intersections exhibition, 2021. Photo: 5 Foot Photography



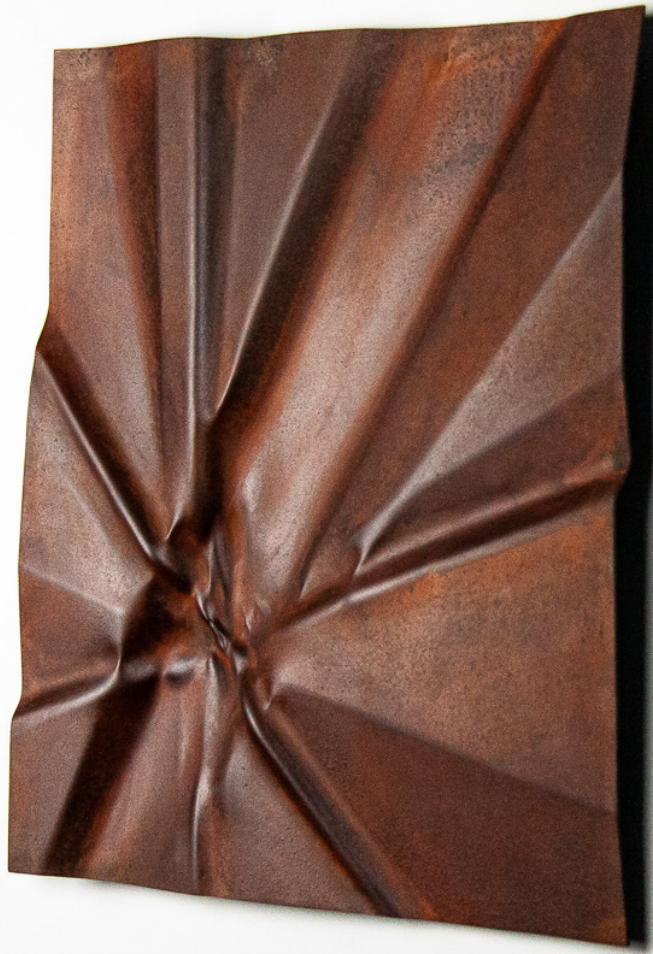

ABOUT THE EXHIBITION PROGRAM

Craft ACT promotes artistic excellence within contemporary craft and design. Each year our respected exhibition program supports recent graduates and early career artists as well as established and distinguished practitioners and researchers. Recognising the core dynamic role of Aboriginal and Torres Strait Islander culture in Australian arts and culture, Craft ACT encourages Aboriginal and Torres Strait Islander artists to apply to exhibit in our 2022 program.

Craft ACT's exhibition program is highly regarded and has received multiple awards. Artists whose work is featured in the Craft ACT artistic program place their work in view of collecting institutions, business and industry, individual collectors and audiences. It is a valued opportunity to foster innovation and excellence, and to help artists make a living from their practice. Experimental and traditional exhibitions, as well as regional, national and international projects, can be supported.

[View previous Craft ACT exhibitions here.](#)

WHO CAN APPLY?

Any artist, designer, maker, curator or craftsperson who locates their practice within contemporary craft and/or design is welcome to apply.

- All craft and design practitioners from a wide range of mediums including (but not limited to) textiles, fashion, furniture, wood, glass, design, commercial products, jewellery, metals, ceramics, graphic design, paper etc
 - You can be an early, mid-career or established artist
 - Guilds, associations and artist-run initiatives
 - Groups or solo shows

Unfortunately, we do not accept submissions from current undergraduate university students.

Image: Material Codes exhibition, 2019. Photo: 5 Foot Photography





WHAT KIND OF EXHIBITIONS ARE YOU LOOKING FOR?

- Ambitious and engaging proposals that embody contemporary craft and design practice and concepts at all levels of experience and across all mediums
- Collaborations between different disciplines, mediums, industries are encouraged
- Joint proposals and group exhibitions
- Outstanding solo exhibitions
- Exhibitions that are underpinned by a strong curatorial narrative and foundation

If your proposal forms part of an exhibition tour, please include (itinerary) details in your submission. Preference is given to exhibitors which premiere at Craft ACT.

CAN I SUBMIT MORE THAN ONE APPLICATION?

- Yes, there is no limit for the number of submissions.

Image: Valerie Kirk, Earth Indigo Fossil, 2019. Photo: courtesy of the artist

WHAT KIND OF SUPPORT DO YOU OFFER?

- Exhibition installation, demount and staffing for the duration of the exhibition
 - Insurance and public liability at Craft ACT
- An opening function (including drinks, an opening speaker and support staffing and volunteers)
- Publicity and media engagement via media release and direct contacts
 - Commissioning an essay to foster deeper critical engagement with contemporary craft practice
 - Coordination of sale of works and liaison with buyers
 - Design and production of an exhibition room sheet
- Design and production of an e-catalogue which is shared on social media and the Craft ACT website.
 - Marketing and promotion of the exhibition including design and distribution of e-invitations, an active social media campaign, website listing and electronic direct marketing to media, industry and government organisations
 - We do not offer any financial support and do not produce printed catalogues. We are happy to write a letter of recommendation to support your funding application if required.

Image: F!NK alternative jug project exhibition, 2020. Photo: 5 Foot Photography





WHAT IS THE EXHIBITOR RESPONSIBLE FOR?

- Transportation and transit insurance to and from the Gallery
- Installation assistance
- All costs relating to specific mounting requirements of the exhibition
- Supplying the work with suitable display accessories including stands, hanging materials or other aids necessary
- Delivery of promotional information including a current curriculum vitae, artist statement, high resolution images
- Exhibition works information (including captions and pricing)
- Participation in associated public programs such as a floor talk
- Assisting in the promotion of the exhibition via social media and among your networks – see more about how to make the exhibition a success, below.
- Meeting all deadlines in the development and delivery of the exhibition, as defined by Craft ACT

See indicative deadline dates on next page.

Image: Zoe Brand, YOU READ IT HERE FIRST, 2020. Photo: courtesy of the artist

Indicative dates:

June	All applicants notified of outcomes
Within 30 days of notification	<ul style="list-style-type: none">• All participating artists become Craft ACT members or pay \$1050 gallery fee in full• Exhibition contract sent, signed and returned to Craft ACT <p>Please note: If membership or payment has not been received, the offer of gallery space will be withdrawn and offered to the next proposal in order of merit.</p>
3 months before exhibition opens	<ul style="list-style-type: none">• Artists provide Craft ACT with professional standard photographs, updated exhibition and artist statements and CVs• Planning and development of the exhibition with Craft ACT and discuss installation and demount requirements
2 weeks before exhibition opens	<ul style="list-style-type: none">• All artworks delivered to the gallery• All artwork details and remaining professional images provided for roomsheet and e-catalogue
Within 1 week after exhibition closes	All artworks collected from Craft ACT
Within 1 month after exhibition closes	All payments will be made to the artists for any sold work

Image: In These Hands exhibition, 2018. Photo: 5 Foot Photography





DOES YOUR GALLERY CHARGE?

Craft ACT: Craft + Design Centre is a not-for-profit membership based organisation which supports artists, craft practitioners, designers and makers at every stage of their careers. We promote and celebrate excellence and innovation in contemporary craft in everything we do – in our retail space, exhibitions, events and membership program. To submit your exhibition proposal, you are not required to be a Craft ACT member. A fee of \$1050 per exhibition will apply for exhibitions included in the 2021 artistic program. **This fee is waived in full for current Craft ACT members.** Membership starts at \$66, and increases to include categories with professional recognition and insurance. Membership is available online from the Craft ACT website. Be a part of the creative, professional community at Craft ACT and connect into the vibrant contemporary craft and design scene locally and nationally.

For group exhibitions, the full exhibition fee will be applied if any participating artists are not members. If you don't want to pay the exhibition fee, please note that if your proposal is accepted, all participating artists (in solo or group shows) must be or become current members of Craft ACT within 30 days of accepting the offer of an exhibition and signing the exhibition contract to secure your place in the 2022 artistic program. Failure to either become a member or pay the exhibition fee in full within 30 days of the offer being made will result in the offer being withdrawn and the gallery space being offered to the next proposal on the order of merit.

To receive the contract, all exhibiting artists must be financial members.

SALE OF WORKS?

All of the work, if not the majority, should be available for sale during the exhibition. Craft ACT applies a 35% commission on the selling price of all works sold during the exhibition. We require you to inform us in your exhibition proposal if you have an existing arrangement with another gallery.

Image: Mark Making exhibition, 2018. Photo: 5 Foot Photography

HOW ARE APPLICATIONS ASSESSED?

In line with best practice, Craft ACT works in partnership with a peer review panel of leading craft practitioners and designers to review proposals for artistic rigour, diversity, a reflection of current trends in Australian craft and design practice, innovation and experimentation.

Selection is highly competitive every year. Please note Craft ACT receives more applications than we have gallery space for. At the end of the review process, we are available to give feedback to unsuccessful applicants if desired.

WHAT CAN I DO TO MAKE THE EXHIBITION A SUCCESS?

Working in partnership is the key to a successful exhibition. Craft ACT will promote the exhibitions through our marketing and social media channels and networks. Exhibiting artists should also promote their projects via social media, direct marketing and their own contacts to reach the widest audience, to generate and/or follow up sales opportunities, and to ensure success of your project.

WHEN IS SUBMISSION DATE?

Your proposal needs to be with us by 11.59 pm (AEST) Sunday 21 March 2021.
Late proposals will not be accepted.

Submit your application

Image: Distorted Trajectories exhibition, 2020. Photo: 5 Foot Photography



Craft ACT: Craft + Design Centre Gallery

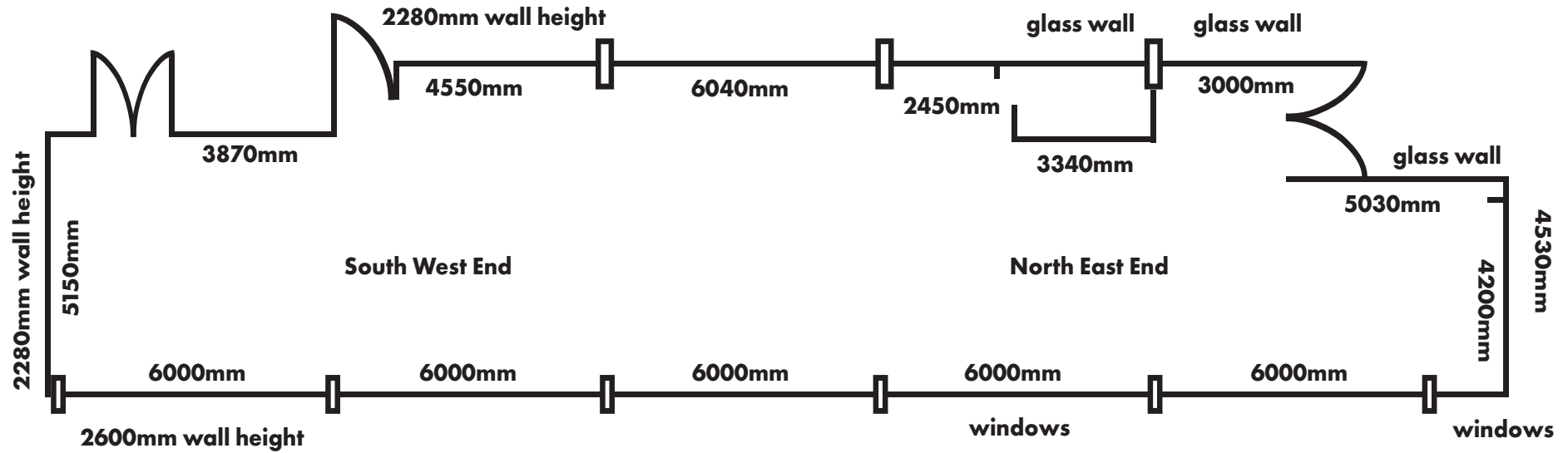

NEED FURTHER INFORMATION?

Contact Rachael Coghlan, CEO/Artistic Director, Craft ACT:
ceo@craftact.org.au or 02 6262 9333

or

Madisyn Zabel, Gallery Manager, Craft ACT:
gallery@craftact.org.au or 62629333

