

Wall Mountable UVC Air Purifier and HEPA Filter

SKU: 201075

INSTRUCTION MANUAL



DEVICE SPECIFICATIONS

SIZE	13.1" x 5.1" x 11.7"
WEIGHT	5.5 lbs
POWER SUPPLY	Plug and play hub 120V, 60 Hz
POWER WATTAGE	8.5 W
NOISE INDEX	53 dB
APPLICATION AREA	107.6 – 161.5 sq. feet
AIR VOLUME	2179 cubic feet per hour

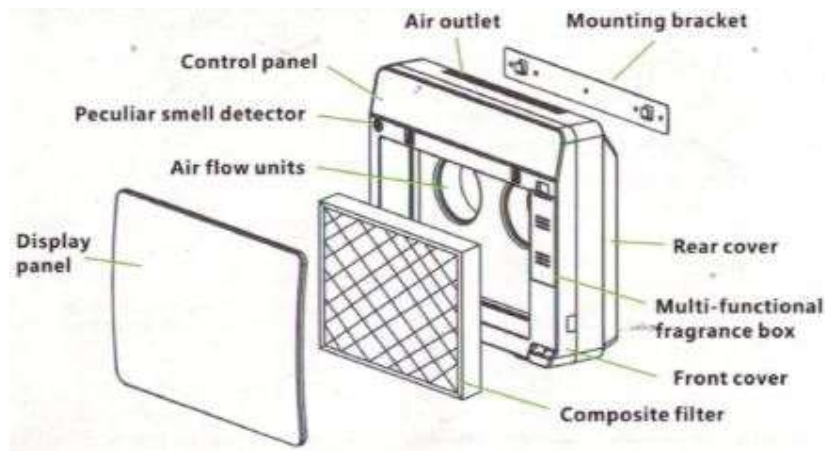

FEATURES

- Remote control.
- Smart tech features
 - Automatic air detection sensors
 - Double fan system
 - Time sleep function
 - Multi-layered filtration systems
- Fragrance box to insert fragrance of choice

SAFETY PRECAUTIONS

1. Product is designed for use in houses or similar environments. Do not use outdoors.
2. Do not use device
 - a. Under high temperature,
 - b. Under high humidity,
 - c. In excessively dusty areas

We do not recommend using in the kitchen or bathroom as it is common for the above conditions to exist.

3.
 - a. Do use device near heating equipment e.g. oven, fan heater. Do not place or use device under direct sunlight
 - b. Do not use device near water/moisture or with wet hands
4. Place the inlet and outlet are at least 30cm – 1ft from other items. Do not cover these inlets with any items

For best use avoid using in fluctuating and varying temperatures and do not use or spray aerosols/aromatherapy fumes before switching device on or while device is on

The device cannot eliminate carbon monoxide or radon.

Mounting Instructions

A mounting bracket is supplied with the unit.

1. Locate area on wall for mounting bracket between 2-5 feet from floor and ideally away from doors and corners.
2. The bracket can be mounted directly into stud or dry wall with appropriate mounting hardware (not included)
3. Once bracket is securely fastened to wall hang unit onto bracket and plug in.



HOW TO WORK THE DEVICE

DISPLAY PANEL



This display is touch sensitive, so it only requires a light touch. As can be seen for the image above the setting that is selecting is illuminated.

Start Up

After connecting the power cord to the device and plugging into outlet, lightly press the **On/Off** button on the top left of the panel, to start the purifier

To control air speed

Use the **speed** function button on the bottom left of the panel. There are three modes of air speed 1) "**sleep**" 2) "**low**" 3) "**fast**" We recommend using fast speed when using the device at irregular intervals. If you regularly use the device low speed is suitable while sleep function is suitable for night time or out of office hours.

Timing Function

You can either run this machine for **1 hour** or **3 hours** before the device goes to sleep. The **timer** button is on the bottom right of the panel.

UV Sterilization and Negative Ion

NOTE: the device is set to negative ion as a default. Therefore, when you start the machine the negative ion function will be on. The device emits negative ions for 20 minutes at a time with 5 minute intervals in between.

Automatic Air quality detection

There are three air quality detection indicators labelled "**poor**", "**moderate**", and "**good**". The device has a built-in sensor that the level of air quality. When the air quality is bad, the device will automatically switch to the fast speed mode.

It takes about 3 minutes for the sensor to warm up and acclimatise to the room once the device is turned on.

Filter replacement Warning*

After 1500 hours of operating the filters will require replacement. The three air quality indicators "**poor**", "**moderate**", "**good**" will flash at the same time. There will also be an alarm that sounds. Once you have replaced the filter to stop the alarms press the **timer** and **speed** buttons together for 5 seconds, this will reset the system.

*see removal of filter instructions below

Remote Control



The device also has a remote control that functions similarly to the panel.

To remove the filter

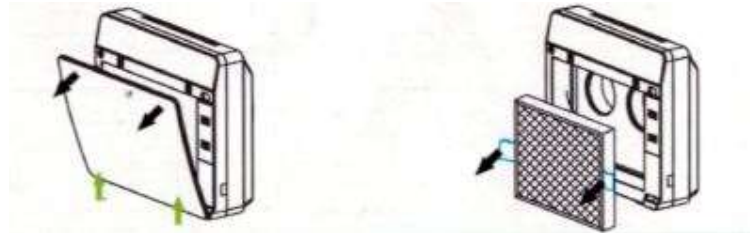

Disassemble the front panel

1. Hold the top of the panel with you left hand.
2. Place you right hand and the top edge of the front panel and pull the panel out to a 45-degree angle
3. Once at a 45-degree angle lift the panel upwards and out.

Disassemble the filter

1. There are two tabs on either side of the filter
2. Pull both tabs to remove the five in one filter
3. Then slightly pull the different filter layers apart

To Replace the Filter

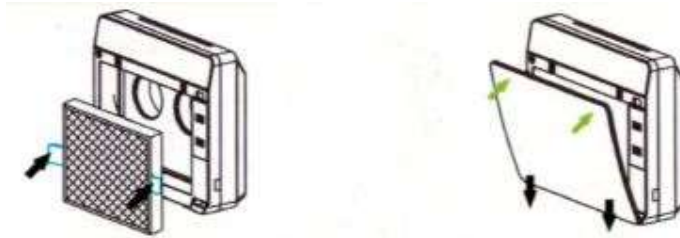

1. Align the filter back into the slot.
2. Make sure the tabs on the filter are to the front.
3. Push the filter back into place.
4. Replace front panel into bottom tabs and press to close.

PRODUCT MAINTENANCE

PROBLEM	POSSIBLE CAUSE	TROUBLESHOOTING
The unit is not working	Power cord is not plugged in or not working	Plug in cord or check working of cord
	Power button is not on	Press on/off button
The purification effect is poor	Air inlet/outlet is blocked	Clear inlet/outlet of foreign objects and parts
	Filter is too dirty	Clean and replace filters
Abnormal noise exists	Make sure all of the packaging is removed from the device	
	Check device for damage	
	Check air inlet and outlet	
	A fizz sound for the negative ion function is normal	