



**GermAway  
UV Spartan  
Model no:Spartan 201182**

**PLEASE READ AND SAVE THESE IMPORTANT SAFETY INSTRUCTIONS**

---

# Contents

1. Important safety information .....	02
2. Product Structure.....	03
3. Before first use .....	04
4. Using the GermAwayUV Spartan.....	06
5. Filter Replacement .....	08
6. UV-C bulb Replacement .....	11
7. Keep Filter Clean .....	12
8. Storage .....	12
9. Environment .....	12
10. Troubleshooting .....	13
11. Warranty Terms .....	14

## Specifications

Power Supply	120V~,60Hz
Rated Power	35W
Effective Range	15-18 m <sup>2</sup>
CADR	150 m <sup>3</sup> /h
Operating Conditions	Temperature: 14°F–104°F / -10°C–40°C
	Humidity: < 85% RH
Noise Level	28–49dB
Standby Power	< 0.8W
Dimensions	Φ8.6 x 13.6 in / Φ219 x 346.7 mm
Weight	6.4lb / 2.9kg

## Package Contents

- 1 x GermAwayUV Spartan
- 1 x H13 True HEPA 4-Stage Filter
- 1 x User Manual

# 1. Important safety information

Read this user manual carefully before you use the GermAwayUV Spartan and save it for future reference.



## Danger

- Do not let water or any other liquid or flammable detergent enter the appliance to avoid electric shock and/or a fire hazard.
- Do not clean the appliance with water or any other liquid or a (flammable) detergent to avoid electric shock and/or a fire hazard.

---

## Warning

- Check if the voltage indicated on the Spartan corresponds to the local mains voltage before you connect the Spartan.
- If the mains cord is damaged, you must have it replaced by distributor, or a service centre authorised by distributor or similarly qualified persons in order to avoid a hazard.
- Do not use the Spartan if the plug, the mains cord or the Spartan itself is damaged.
- This Spartan is not intended for use by persons (including children) with reduced physical, sensory or mental capabilities, or lack of experience and knowledge, unless they have been given supervision or instruction concerning use of the Spartan by a person responsible for their safety.
- Children should be supervised to ensure that they do not play with the Spartan.
- Do not block the air inlet and outlet, e.g. by placing items on the air outlet or in front of the air inlet.
- To reduce the risk of fire or electric shock, DO NOT use the Spartan with any solid-state speed control device.
- **Skin or eye damage may result from directly viewing the light produced by the lamp in this apparatus. Always disconnect power before relamping or servicing.** If the bulb is damaged, it needs to be replaced with a lamp manufactured by the designated manufacturer CureUV the lamp of the same specification, and the unmatched lamp cannot be used. Des lésions cutanées ou oculaires peuvent résulter de la visualisation directe de la lumière produite par la lampe dans cet appareil. Débranchez toujours l'alimentation avant de changer la lampe ou de réparer. Si l'ampoule est endommagée, elle doit être remplacée par une lampe fabriquée par le fabricant désigné CureUV modèle est 2 01182 ou la lampe de la même spécification, et la lampe sans équivalent ne peut pas être utilisée .

## Caution

- This Spartan is not a substitute for proper ventilation, regular vacuum cleaning or use of an extractor hood or fan while cooking.
- If the wall socket used to power the Spartan has poor connections, the plug of the Spartan becomes hot. Make sure you plug the Spartan into a properly connected wall socket.
- Always place and use the Spartan on a dry, stable, level and horizontal surface.
- Leave at least 40cm free space behind and on both sides of the Spartan and leave at least 40cm free space above the Spartan.
- Do not place anything on top of the Spartan and do not sit on the Spartan.
- Do not place the Spartan directly below an air conditioner to prevent condensation from dripping onto the Spartan.
- Make sure all filters are properly installed before you switch on the Spartan.
- Only use the original filters specially intended for this Spartan. Do not use any other filters.
- Avoid knocking against the Spartan (the air inlet and outlet in particular) with hard objects.
- Always lift or move the Spartan by the handle at the back of the Spartan.
- Do not insert your fingers or objects into the air outlet.
- Do not use this Spartan when you have used indoor smoke-type insect repellents or in places with oily residues, burning incense or chemical fumes.
- Do not use the Spartan near gas appliances, heating devices or fireplaces.
- Always unplug the Spartan after use and before you clean it.
- Do not use the Spartan in a room with major temperature changes, as this may cause condensation inside the Spartan.
- The Spartan is only intended for household use under normal operating conditions.
- Do not use the Spartan in wet surroundings or in surroundings with high ambient temperatures, such as the bathroom, toilet or kitchen.
- The Spartan does not remove carbon monoxide (CO) or radon (Rn) . It cannot be used as a safety device in case of accidents with combustion processes and hazardous chemicals.
- To prevent interference , should be kept at least 2 meters distance between the product and the use of radio waves electrical.

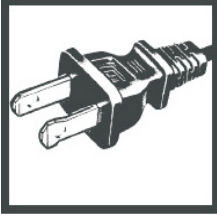

THIS GermAwayUV Spartan HAS A POLARIZED PLUG(one blade is wider than the other).To reduce the risk of electric shock,this plug is intended to fit in a polarized outlet only one way.If the plug does not fit fully in the outlet,reverse the plug.If it still does not fit,contact a qualified electrician to install the proper outlet.

**DO NOT ATTEMPT TO MODIFY THIS PLUG OR DEFEAT THIS SAFETY FEATURE IN ANY WAY.**

## 2. Product Structure

Welcome to using our GermAwayUV Spartan ,before use please read this manual carefully to operate the product correctly.

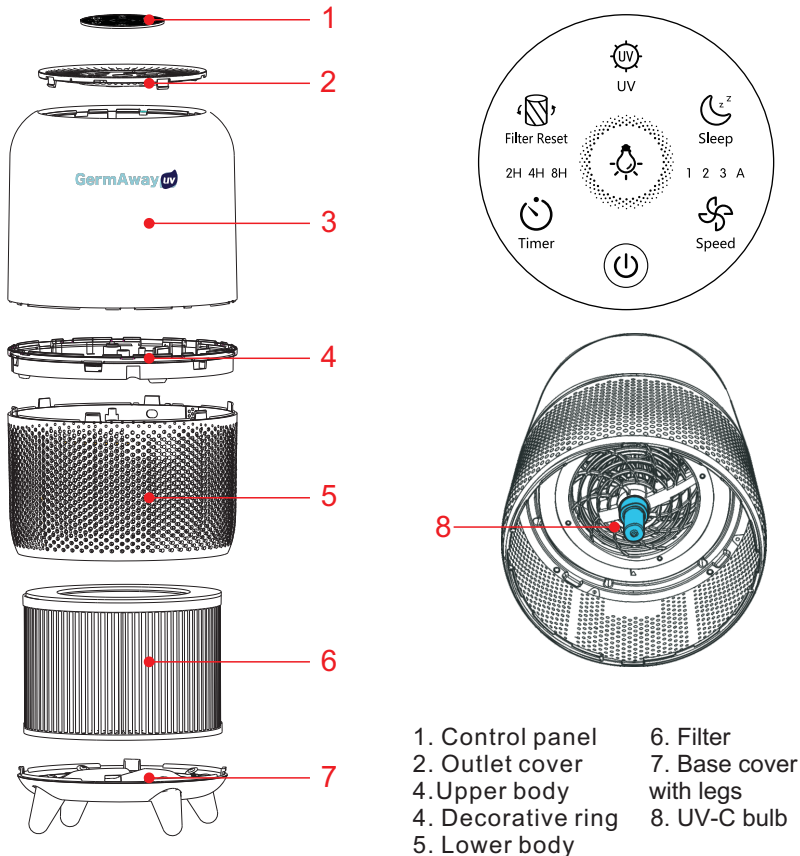

- |                    |                         |
|--------------------|-------------------------|
| 1. Control panel   | 6. Filter               |
| 2. Outlet cover    | 7. Base cover with legs |
| 4. Upper body      | 8. UV-C bulb            |
| 4. Decorative ring |                         |
| 5. Lower body      |                         |

### 3. Before first use

#### Placing the filters

The GermAwayUV Spartan comes with all filters fitted inside, but you have to remove the packaging of the filters before you can use the Spartan. Remove all filters, unpack them and place them back into the Spartan as described below.

**Note:** Make sure your filters purchased from the original manufacturer and put it in the correct position.

1. Put the GermAwayUV Spartan upside down on a soft cloth to avoid scratching, to open the base cover, you need to find an arrow point ▲ on the base cover corresponding the **CLOSE** position, turn the base cover counterclockwise from **CLOSE** to **OPEN** position, then the lock released.

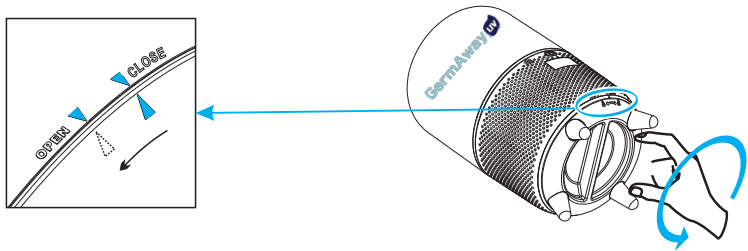

2. Remove the base cover and take out the filter.
3. Remove the packaging material from the filter.

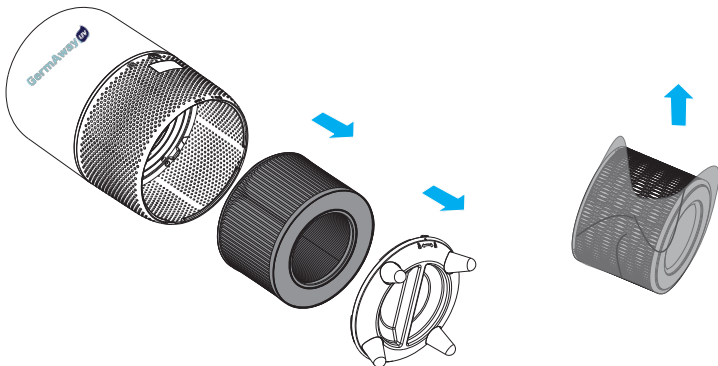

4. Put the filter back into the Spartan.

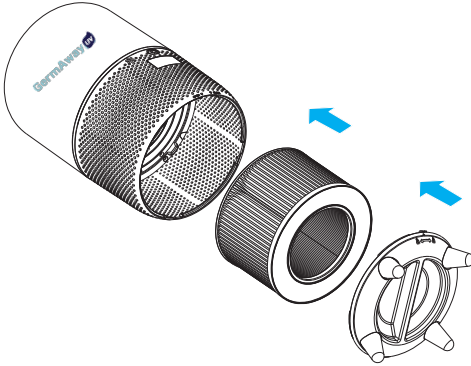

5. Turn the base cover clockwise from **OPEN** position to **CLOSE** position, you will hear a "click" sound, the base cover is fastened.

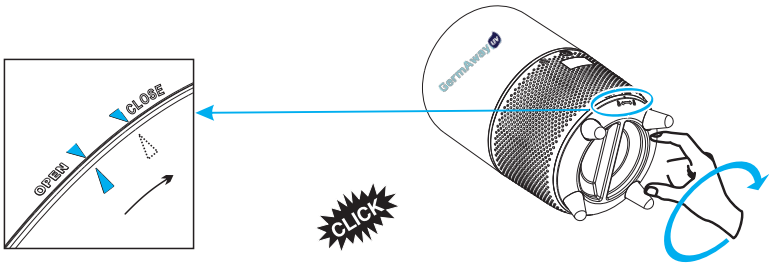

## 4. Using the GermAwayUV Spartan

### 4.1 About the control panel

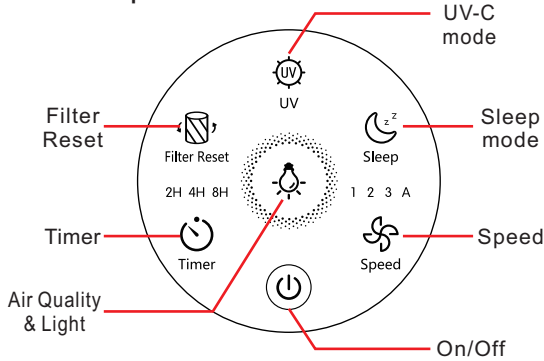

#### 1). Put the plug in the wall socket

All lights go on once and you hear a beep. Then the lights go out again.

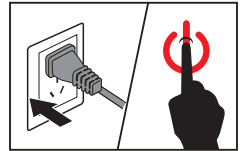

#### 2). Press the power button to switch on the Spartan.

The power  lights, AQ light on and FAN SPEED 1 light (Low) on the control panel go on.

#### 3). Fan speed adjustment



The fan speed light indicates at which fan speed the Spartan is operating. Press Speed button to adjust fan speed level, there are four levers 1~3 refers to **Low, Medium, High level** and **Auto mode**.

At Auto mode, the fan speed will be automatically adjusted according to AQI level as below:

AQ Color	Blue	Green	Orange	Red
Speed mode	Sleep	1(Low)	2(Medium)	3(High)
AQ level	Very good	Good	Unhealthy	Hazardous

#### 4). Sleep mode

Sleep mode uses lowest possible fan speed to operate quietly and the button light will be half.

Tap any buttons except  and  to wake up sleep mode.



---



## 5). AQ Light

Working status (Air quality light)



The air quality light color will automatically change according to the detecting result of sensor.

Standby status (Night light mode)

1). At standby status, press  button, the amber night lights (orange) will turn on.

2). Press  button again, the light become half brightness, to turn off the night light, just press the button  third time, the light cycles as Brightness, Half brightness , Off.

## 6). UV-C technology

The UV-C technology kills germs, viruses, and bacterial by penetrating its DNA, resulting int the microorganism's death or the inability to reproduce. Press  button to turn the UV-C technology on. The UV-C indicator will glow. Press  button again to turn the UV-C technology off.

## 6). Setting timer

1. Press  to turn on or off the timer, and to cycle through timer options (2 hours, 4 hours, or 8 hours).

2. The GermAwayUV Spartan will automatically power off once the timer is finished.

NOTE: Pressing or unplugging the air purifier will cancel the timer.

## 7). Filter replacement light

When indicator lights, it means that you should check the filter if it need to be cleaned or replaced.

**Note:** The filter's lifetime is based to your house air quality and using time. Using the Spartan in a humid environment will reduce the lifetime of the filter.

## 8). Memory Function

The GermAwayUV Spartan has the setting memory while the users turn it off, Just for fan speed. It will return to the last setting while the users turn it on again.

## 5. Filter Replacement

### When Should I Replace the Air Filter?

It is recommended to change the air filter every 6–8 months. However, you may need to change your filter sooner or later depending on how often you use your air purifier. It is important to watch out for the following signs of expired filter:

- Increased operating noise
- Decreased airflow
- Clogged filter
- Increased presence of odors

#### NOTE:

- The environment in which the GermAwayUV Spartan being used may also extend or shorten the lifetime of the the air filter. Using your GermAwayUV Spartan in an environment of relatively high pollution may mean you will need to change the air filter more often.
- If the air pollution in your environment is very high, there is a possibility that the filters may not be completely effective and may need to be replaced before lights up. 
- Remember to reset the air purifier after changing the air filter.

### How to replace the Air Filter?

1. Switch off the Spartan and unplug it. (a)
2. Put the Spartan upside down on a soft cloth to avoid scratching, to open the base cover, you need to find an arrow point ▲ on the base cover corresponding the **CLOSE** position, turn the base cover counterclockwise from **CLOSE** to **OPEN** position, then the base cover released. (b)

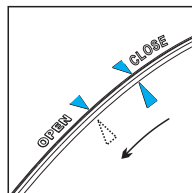
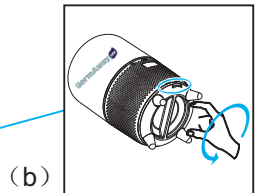
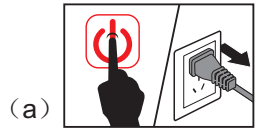

3. Remove the old filter. (c)

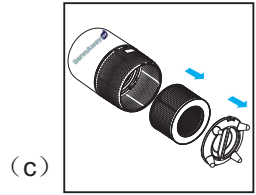

4. Remove the packaging material of the new filter. (d)

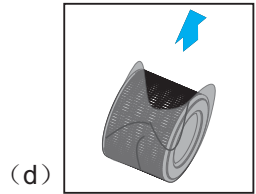

5. Put the new filter back into the Spartan. (e)

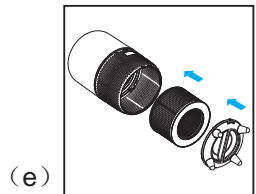

6. Turn the base cover clockwise from **OPEN** position to **CLOSE** position, you will hear a "click" sound, the base cover is fastened. (f)

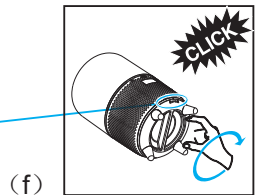
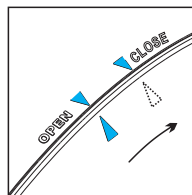

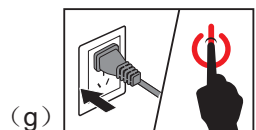

7. Put the plug in the wall socket and switch on the Spartan again. (g)



## 8. Reset Filter's lifetime.

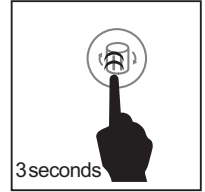

The filter lifetime should be reset if  lights up, after replacing the new filter, you need to reset filter lifetime.

- 1). Plug in the air purifier and turn it on.
- 2). Press and hold  for 3 seconds.
- 3). Release  and the light will turn off, indicating (h) that the reset is complete.



## Filter replacement force mode

When using the air purifier in an environment of heavy pollution, the lifespan of the air filter may be significantly reduced. You can change the filters even if  does not light up. Follow the steps below to perform a hard reset.

- 1). Replace the air filters as mentioned in the Filter Replacement section.
- 2). Plug in the air purifier and keep in working mode.
- 3). Press and hold  for 3 seconds, after hearing the buzzer "Ding", the  indicator will flash 3 times and then turn off, the reset is finished.

## 6. Replacing the UV-C bulb

The UV-C bulb is designed to last for approximately 5000 hours of use. The UV-C indicator on the control panel will flash RED when you use UV-C exceed 5000 hrs.

**NOTE:** The air purifier will continue to operate without UV-C function when the UV-C bulb burns out.

**CAUTION:** Do not operate the air purifier without the protective UV-C bulb cover.

1. Unplug the air purifier and remove the filter. (a)

2. Remove the cover to expose the UV-C bulb. (b)

3. Gently push from the side and rotate the UV-C bulb to remove. (c)

4. Remove and replace the UV-C bulb. Re-install the UV-C bulb cover, filter and base cover. (d)(e)

5. Put the plug in the wall socket and switch on the Spartan again. (f)

6. Press and hold the  button for 3 seconds, after hearing the buzzer "Ding", the UV-C indicator will flash 3 times and then turn off, the reset is finished. (g)

**NOTE:** You can replace the UV-C bulb ahead of time and reset the lifetime, even if the UV-C indicator light does not flash.

**WARNING:** The UV-C bulb contains mercury (Hg).  
**WARNING:** Skin or eye damage may result from directly viewing the light produced by the lamp in this apparatus.

**CAUTION:** Unplug the power cord before servicing or replacing the UV-C bulb.

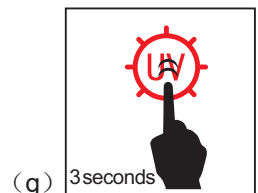
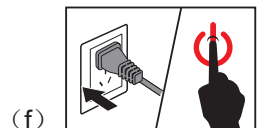
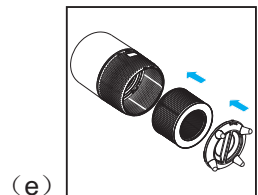
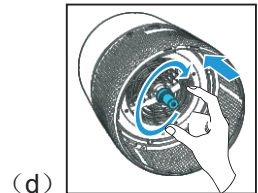
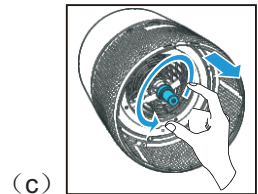
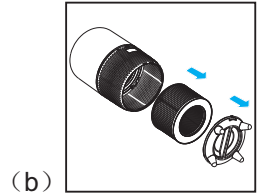
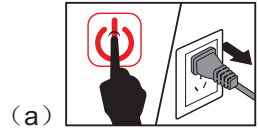

---

## 7. Keep Filter Clean

In order to keep your purifier working with more efficiency and life-time, clean the filter (pre-filter side only) every 2 weeks with the Instruction Below:

- 1). Clean out any dust, hair, or furs remain on the pre-filter by using the vacuum hose.
- 2). Clean out any dust, hair, or furs remain on the bottom cover by using the vacuum hose.
- 3). DO NOT wash the filter with any water or liquid.

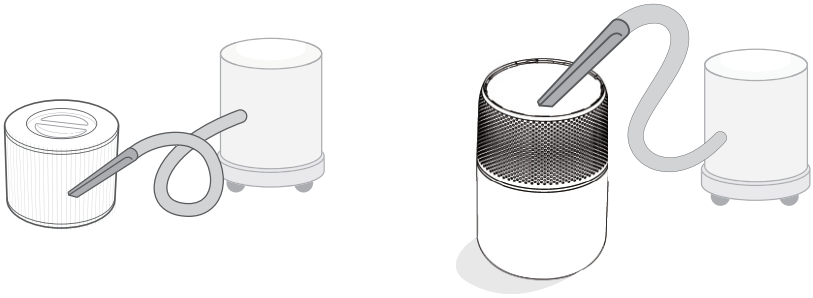

## 8. Storage

Unplug the power cord, then wipe the machine clean, put the Spartan in the packing bag, then put it in a dry place away.

## 9. Environment

Do not throw away the Spartan with the normal household waste at the end of its life, but hand it in at an official collection point for recycling. By doing this, you help to preserve the environment.

## 10. Troubleshooting

This chapter summarizes the most common problems you could encounter with the Spartan. If you are unable to solve the problem with the information below, contact the Consumer Care Centre in your country.

Problem	Cause	Solution
<i>Spartan</i> does not power on.	Unit is not plugged into an electrical outlet.	Connect the plug to a powered electrical outlet.
	Outlet is not working properly.	Try plugging the air purifier into a different outlet.
	Power button has not been pressed after plugging in the air purifier.	Press '⏻' once to turn on the air purifier.
	Power cord is damaged. Air purifier is defective or malfunctioning.	Immediately discontinue use and contact Customer Support .
<i>Spartan</i> does not respond to button controls.	Air purifier is not plugged into an outlet.	Connect the plug to a powered electrical outlet.
	Air purifier is defective or malfunctioning.	Immediately discontinue use and contact Customer Support.
<i>Spartan</i> makes an unusual noise while operating.	Filter is dirty.	Replace the air filter as instructed in the <b>Filter Replacement</b> section.
	Filter does not fit properly.	Properly place filter as noted in the <b>Before first use</b> and <b>Filter Replacement</b> sections.
	Foreign object inside the unit.	Immediately discontinue use and contact Customer Support . <b>DO NOT</b> attempt to open the air purifier.
	Filter packaging has not been removed.	Remove filter from packaging before use.
Significantly reduced airflow.	Filter packaging has not been removed.	Remove filter from packaging before use.
	Fan speed is low.	Press '⚙️' to adjust fan speed.
	Filter needs to be replaced.	Replace the air filters as instructed in the <b>Filter Replacement</b> section.
	Not enough clearance on all sides of the purifier.	Ensure there is at least 38 cm (15 inches) of clearance on all sides of the purifier.
Poor air purification quality.	Filter needs to be replaced.	Replace the air filters as instructed in the <b>Filter Replacement</b> section.
	Room is too large for the air purifier's applicable area.	Ensure the room is smaller than (200 ft <sup>2</sup> ).
	Air inlet or outlet is blocked.	Remove objects blocking air inlet or outlet.
	Filter not properly placed in housing.	Properly place filters as noted in the <b>Before first use</b> and <b>Filter Replacement</b> sections.
Filter reset button is still illuminated after replacing the air filter.	The air purifier has been reset incorrectly.	See the <b>Filter Replacement</b> section on how to properly reset the unit.
Air purifier turns on, then suddenly turns off.	Air purifier is defective or malfunctioning.	Immediately discontinue use and contact Customer Support . <b>DO NOT</b> attempt to open the air purifier for self-servicing.
Air purifier beeps repeatedly after being powered on or plugged in.		

---

## 11. Warranty Terms

- 1) This product is warranted for one year from the date of purchase (12 months, 365 days); the warranty is limited to defects in the materials of the product and manufacturing defects.
- 2) The following conditions are not in the scope of maintenance:
  - a) This product has exceeded the "12-month warranty".
  - b) Failure to provide valid purchase receipts; or alter valid purchase receipts without authorization; or the model and serial numbers on the product in purchase receipt do not match the actual product.
  - c) The label or serial number of the product is damaged or has been tampered, and the identity of this product can't be proved effectively.
  - d) Due to unexpected factors, improper use or other human factors (including water ingress, moisture, fall down, user operation errors, transportation, bumps, etc.) cause a defect or damage ; Failure or damage caused by natural disasters and force majeure so on (such as earthquakes, fires, etc.)
  - e) Disassembled, refitted or repaired by user or an unauthorized third party.
  - f) Not follow the instructions in this manual, or damage caused by not using the original parts of the product.
  - g) The purchaser has clearly be informed that the product is a disposed product, or samples that serve as commercial listings, or products that have been subjected to performance overload tests.
  - h) Wear of any part, or damage to plastics and other accessories.
- 3) All air freight and transportation costs are not covered by the warranty and must be borne by the customer.
- 4) In any case, the company or its authorized distributors will not grant any guarantee on time if it is beyond the control, or any special or indirect damage occurs, the company or its authorized distributors will not responsible for it. In addition to the above-mentioned clear warranty provisions, the company is not required to assume other forms of warranty responsibilities.

The electronic manual can be downloaded from the following website :

[www.germawayuv.com](http://www.germawayuv.com)