

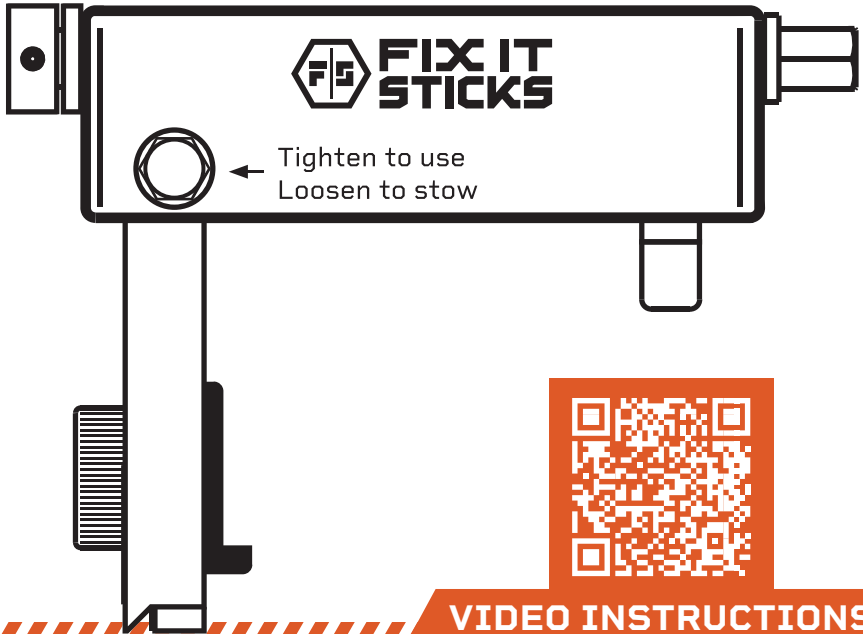

FIELD PISTOL SIGHT TOOL INSTRUCTIONS



**VIDEO INSTRUCTIONS
ALSO AVAILABLE**



This tool is intended for making range adjustments only. A bench sight pusher is required for removal/installation.



Designed for use with polymer dovetail style rear sights (e.g. Glock™) check your application for compatibility.



Fix It Sticks T-Way or 1/4 in driver required for operation.



STEP 1: SAFETY

Always make sure your firearm is safe and clear physically and visually. Store the ammo and magazine in a safe location away from your work area.

STEP 2: OPEN SIGHT TOOL

(2A) Loosening the **Drive Screw** will allow you to (2B) pull the **Cradle Arm** down, & (2C) pull out the **Press Block**.

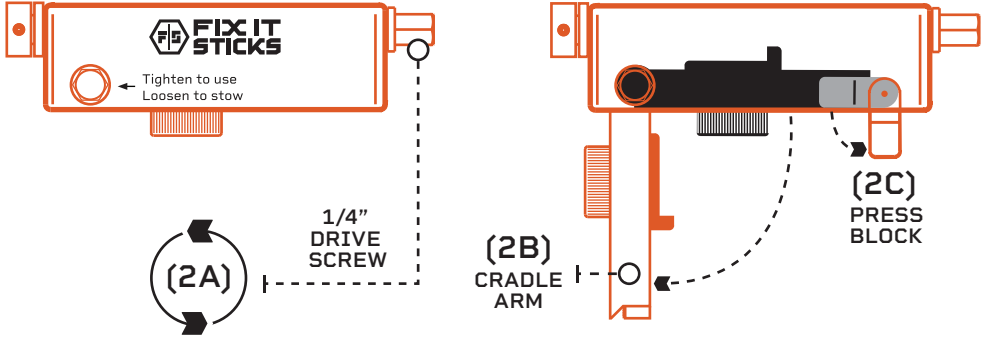

STEP 3: POSITION PREP

(3A) Position the **Slide Bracket** and snug up the **Thumbscrew** to allow for movement with friction, but not fully tightened.

(3B) Thumb adjust the **Drive Screw** to approximately position the **Press Block** for your pistol's sight.

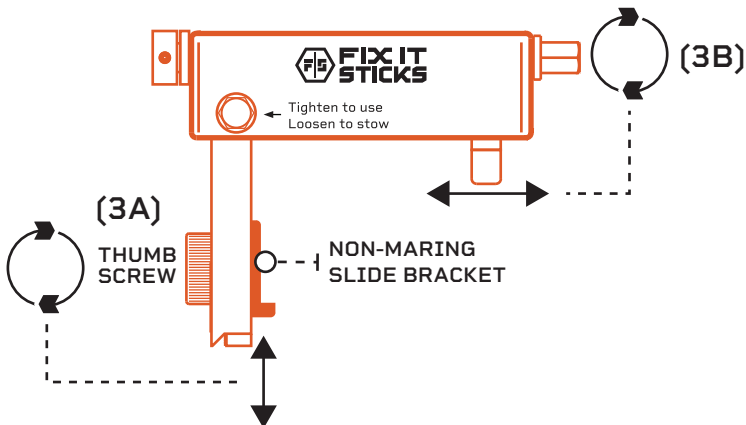

STEP 4: PISTOL INSTALL

(4A) Put the pusher on the pistol with one hand pressing against the **Thumbscrew** and holding the slide or pistol.

(4B) Adjust height of **Slide Bracket** so the sight meets up with the advancement of the **Press Block**.

(4C) Snug up the **Press Block**

(4D) Tighten the **Thumb Screw**

Your pistol is now secured.

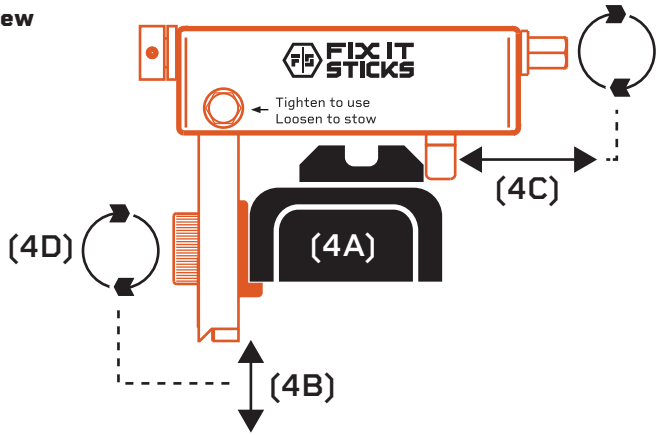

STEP 5: SIGHT ADJUSTMENT

(5A) Put a T-handle on the **Drive Screw** and advance the sight.

(5B) Once sight is centered, loosen the **Drive Screw** to remove the sight tool from the pistol.

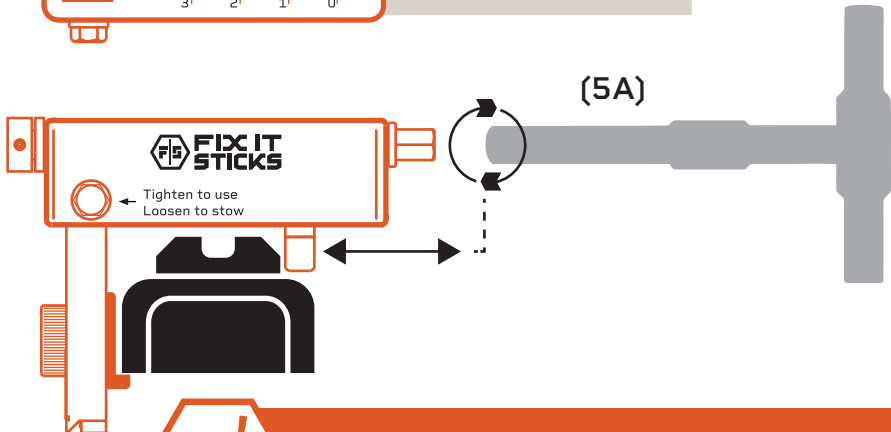
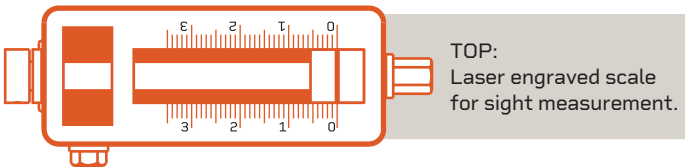

OVERSHOT THE ADJUSTMENT?

Flip the sight tool to other side of your pistol and repeat steps 3-5

STEP 6: STORAGE

(6A) Fold in the **Press Block**

(6B) Loosen the **Thumb Screw**, and let the **Slide Bracket** drop, which will allow the **Cradle Arm** to close in.

(6C) Snug the **Drive Screw** to hold all components together.

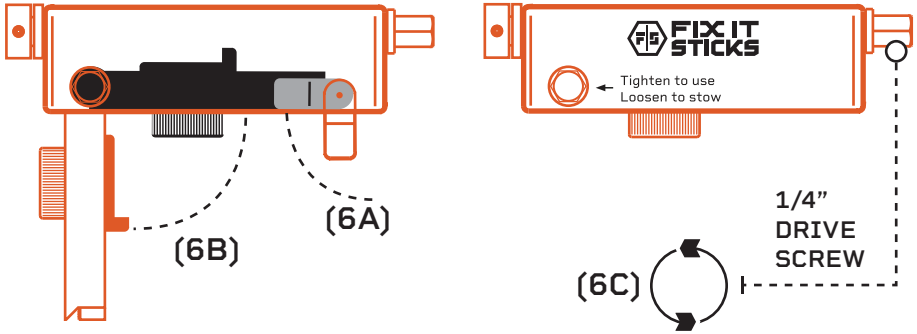

**FIND MORE INFO
& INSTRUCTIONAL
VIDEOS**



[fixitsticks.com](https://www.fixitsticks.com)