

CN80

HEVY DUTY COIL NAILER

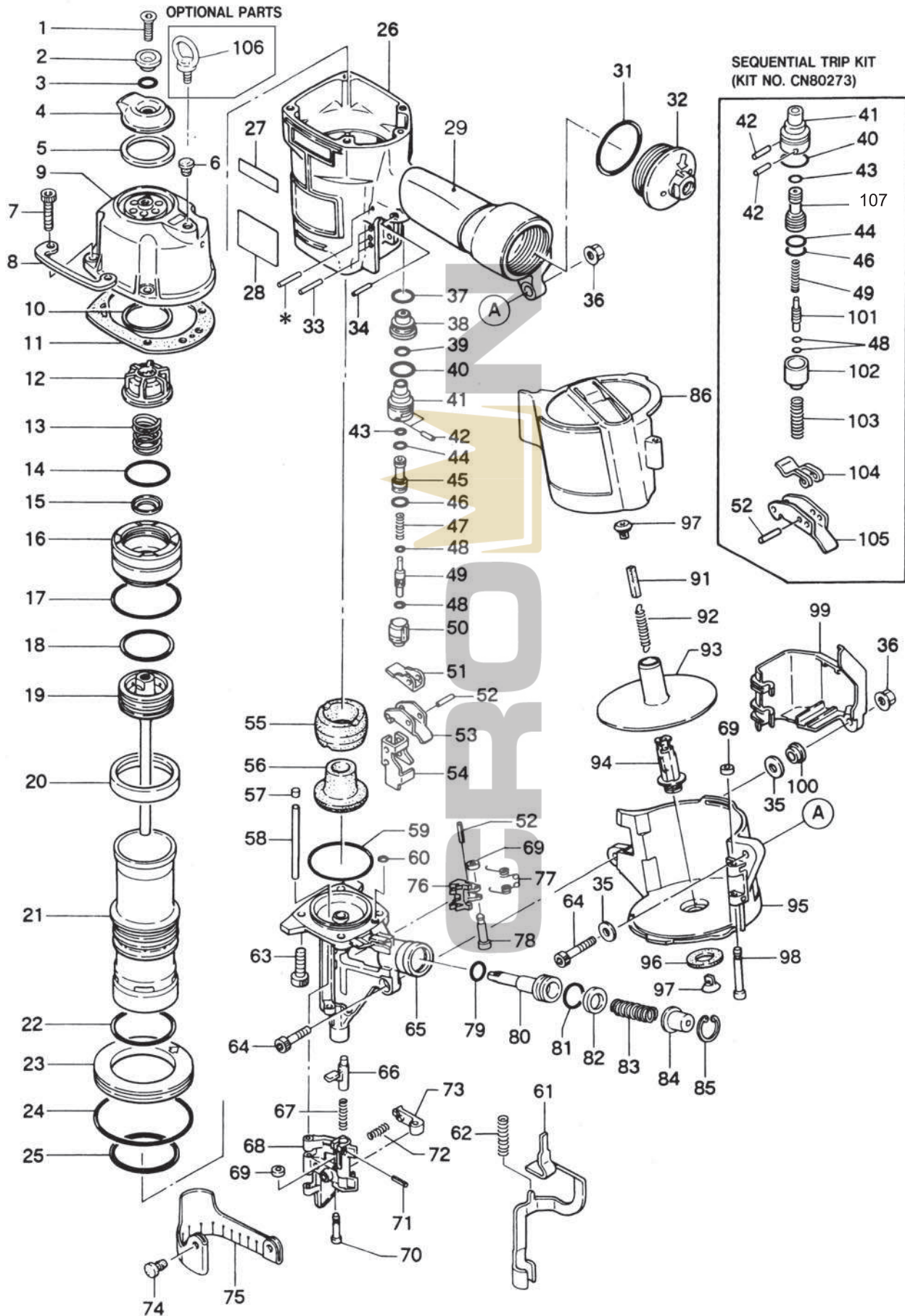

MAX PARTS PRICE LIST

JUNE 2010

Model	Part NO	Part Code	Description	List Price	Ratio
CN80	1	AA82427	SCREW M8X20	\$0.50	1
CN80	2	CN32631	EXHAUSE COVER HOLDER	\$2.02	1
CN80	3	HH11132	O-RING 1AP10A	\$0.44	5
CN80	4	CN37675	EXHAUST COVER (REPLACES CN32585)	\$4.66	1
CN80	5	CN37376	EXHAUST COVER SEAL (REPLACES CN32242)	\$2.98	1
CN80	6	TA12319	GROMMET	\$0.44	1
CN80	7	BB40422	BOLT 6X30	\$0.50	20
CN80	8	CN37550	PROTECTOR (REPLACES CN35766)	\$2.96	1
CN80	9	CN81208	CYLINDER CAP UNIT (REPLACES KN11165)	\$67.72	1
CN80	10	CN34458	SPACER EXHAUSE	\$6.74	1
CN80	11	CN37549	CYLINDER CAP SEAL (REPLACES CN34467)	\$10.44	30
CN80	12	CN37674	PISTON STOP (REPLACES CN34444)	\$8.80	30
CN80	13	KK23195	COMPRESSION SPRING -3195	\$1.96	1
CN80	14	HH19142	O-RING 1A3X56,6	\$2.04	50
CN80	15	CN37547	HEAD VALVE WASHER (REPLACES CN34453)	\$4.14	1
CN80	16	CN37673	HEAD VALVE PISTON (REPLACES CN34460)	\$25.04	5
CN80	17	HH19195	O-RING 1A3X56,8	\$3.40	50
CN80	18	HH19196	O-RING 1A4,9X43	\$2.76	50
CN80	19	CN81206	MAIN PISTON UNIT (REPLACES CN34445)	\$52.96	10
CN80	20	CN37527	CYLINDER SEAL (REPLACES CN31560)	\$2.64	50
CN80	21	CN37687	CYLINDER (REPLACES KN10853)	\$51.32	1
CN80	22	HH19192	O-RING 1A3,1X56,5	\$2.98	20
CN80	23	CN37524	CYLINDER RING (REPLACES CN31559)	\$6.98	1
CN80	24	HH12117	O-RING 1AG85	\$1.80	20
CN80	25	HH11169	O-RING 1AP56	\$2.12	5
CN80	26	CN37546	FRAME (REPLACES CN34441)	\$91.86	1
CN80	27	CN34457	"CN80" LABEL	\$1.84	1
CN80	28	CN37439	WARNING LABEL (MAGAZINE) (REPLACES CN34879)	\$2.12	1
CN80	29	CN34703	GRIP COVER	\$6.96	1
CN80	30	CN32722	GRIP TAPE	\$11.14	1
CN80	31	HH12102	O-RING 1AG50	\$1.88	1
CN80	32	CN81221	END CAP, REPLACES CN34455	\$18.36	1
CN80	33	FF21221	ROLL PIN 3X25	\$0.20	10
CN80	34	FF21229	ROLL PIN 3X20	\$0.20	10
CN80	35	EE39138	PLAIN WASHER 138	\$2.30	1
CN80	36	CC00402	ELASTIC STOP NUT M6X1	\$0.44	5
CN80	37	HH11159	O-RING ARP568-016	\$1.20	5
CN80	38	CN37529	TRIGGER VALVE CAGE (REPLACES CN31661)	\$0.92	1
CN80	39	HH11151	O-RING ARP 568-013 (CN70)	\$0.88	5
CN80	40	HH11138	O-RING 1AP20	\$0.44	20
CN80	41	CN32247	TRIGGER VALVE HOUSING	\$6.02	20
CN80	42	FF30161	STRAIGHT PIN 161	\$0.44	5
CN80	43	HH11119	O-RING 1AP6	\$0.44	50
CN80	44	HH11209	O-RING 1BP7	\$0.44	50
CN80	45	CN31589	PILOT VALVE	\$4.60	5
CN80	46	HH11113	O-RING 1AP9	\$0.44	50
CN80	47	KK24123	COMPRESSION SPRING 4123	\$1.22	5
CN80	48	HH11901	O-RING 1B1, 4X2,5	\$0.20	30
CN80	49	CN31347	TRIGGER VALVE STEM	\$1.44	20
CN80	50	CN31346	TRIGGER VALVE CAP	\$1.68	1
CN80	51	CN37424	CONTACT LEVER (REPLACES TA10506)	\$2.70	1
CN80	52	FF21220	ROLL PIN 3X16	\$0.20	10
CN80	53	CN37423	TRIGGER (REPLACES TA10505)	\$2.48	1
CN80	54	CN35855	ARM GUIDE, REPLACES PART# CN31659, CN37553	\$6.78	1
CN80	55	CN31563	BUMPER "A"	\$4.84	30
CN80	56	CN31564	BUMPER "B"	\$5.12	30
CN80	57	CN31594	PIN CAP	\$1.00	1

MAX PARTS PRICE LIST

JUNE 2010

Model	Part NO	Part Code	Description	List Price	Ratio
CN80	58	FF31127	STRAIGHT PIN 1127	\$1.58	1
CN80	59	HH19139	O-RING 1A1,5X53,5	\$2.88	5
CN80	60	HH19125	O-RING 1A1, 6X4.2	\$0.44	5
CN80	61	CN35831	CONTACT ARM,---Replaces Old# CN34454	\$21.34	1
CN80	62	KK23223	COMPRESSION SPRING 3223	\$0.86	1
CN80	63	BB40444	SCREW M8X30	\$0.56	20
CN80	64	BB40469	SCREW M6X40	\$0.56	5
CN80	65	CN37671	NOSE (REPLACES CN34459)	\$198.65	1
CN80	66	CN37371	DOOR LATCH (REPLACES CN30587)	\$11.26	1
CN80	67	KK23123	COMPRESSION SPRING 3123	\$0.44	5
CN80	68	CN37672	DOOR (REPLACES CN34450)	\$54.40	1
CN80	69	EE39602	RUBBER WASHER 7, REPLACES PART#'S EE39604, EE39623	\$0.44	20
CN80	70	FF41286	STEP IN 1286	\$1.84	1
CN80	71	FF21234	ROLL PIN 3X12	\$0.20	5
CN80	72	KK23109	COMPRESSION SPRING 3109	\$0.44	5
CN80	73	CN37523	CHECK PAWL (Replaces CN30584)	\$26.22	1
CN80	74	CN31083	DUST COVER HOOK	\$0.44	5
CN80	75	CN34456	DUST COVER	\$3.32	1
CN80	76	CN34448	FEED PAWL	\$22.18	1
CN80	77	KK33058	TORSION SPRING 3058	\$4.70	20
CN80	78	FF41263	STEP PIN 1263	\$5.44	1
CN80	79	HH11124	O-RING 1AP10, REPLACES TA15283	\$0.44	50
CN80	80	CN37678	FEED PISTON (REPLACES CN34449)	\$31.88	1
CN80	81	HH11143	O-RING 1AP21	\$0.64	50
CN80	82	CN37528	FEED PISTON STOP (REPLACES CN31570)	\$2.12	1
CN80	83	KK23225	COMPRESSION SPRING 3225	\$0.44	1
CN80	84	CN37538	SPRING COLLAR (REPLACES CN31571)	\$4.36	1
CN80	85	JJ22407	RETAINING RING C26	\$1.54	5
CN80	86	CN37684	MAGAZINE COVER (REPLACES CN35832)	\$10.86	1
CN80	91	CN30601	SPACER	\$0.20	1
CN80	92	KK13144	TENSION SPRING 3144	\$1.20	1
CN80	93	CN35833	NAIL SUPPORT, REPLACES PART# CN32719	\$13.58	1
CN80	94	CN37382	MAGAZINE POST (REPLACES CN34407)	\$2.44	1
CN80	95	CN37682	MAGAZINE (REPLACES CN34469)	\$19.20	5
CN80	96	EE39603	POST RETAINER--Replaces Old# EE39606	\$0.94	1
CN80	97	CN37383	RECEIVER SPRING (REPLACES CN30602)	\$0.84	1
CN80	98	FF41287	STEP PIN 1287	\$1.40	1
CN80	99	CN37535	CONTACT ARM COVER (REPLACES CN31566)	\$4.48	1
CN80	100	CN32170	COLLAR	\$1.14	1
CN80	101	CN31715	TRIGGER VALVE STEM	\$5.44	20
CN80	102	CN31716	TRIGGER VALVE CAP	\$25.54	1
CN80	103	KK23228	COMPRESSION SPRING 3228	\$0.98	1
CN80	104	CN34300	CONTACT LEVER	\$23.44	1
CN80	105	CN30276	TRIGGER	\$4.52	1
CN80	106	BB10401	HANGER	\$6.22	1
CN80	107	CN33627	PILOT VALVE	\$3.70	
CN80	108	CN80611	O-RING KIT FOR CN70/80/SN90	\$29.76	
CN80	109	CN80548	TRIGGER VALVE KIT (SN90A)	\$20.54	
CN80	111	FF21611	ROLL PIN 3X32 AW	\$0.20	